

REMSED: 5/6/10 - RLOWE  
 H:\Projects\Addison\2002102\PHASE1\Sheet\_Sheets-Ae-Built\2002102c22\_XSec.dwg  
 PLOT SCALE: 1:1.0101  
 PLOT STYLE: 11x17.ctb  
 PLOTTED BY: RLOWE ON 5/14/2010

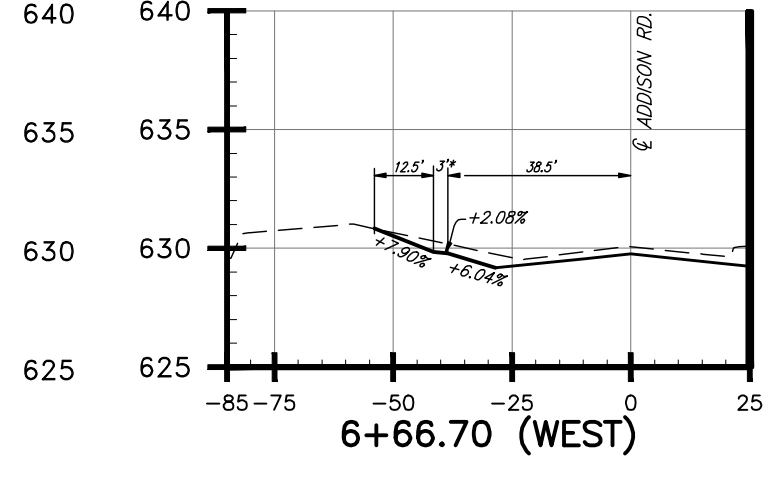
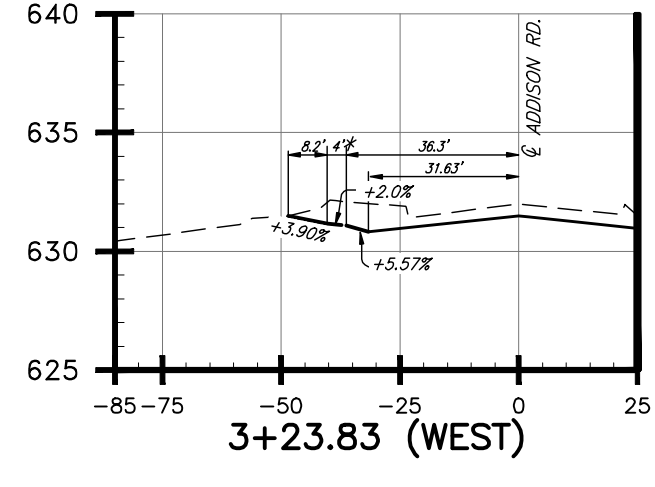
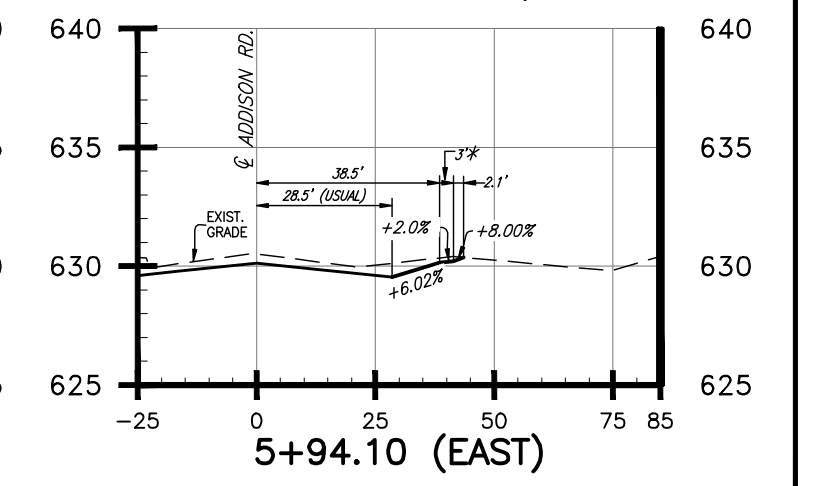
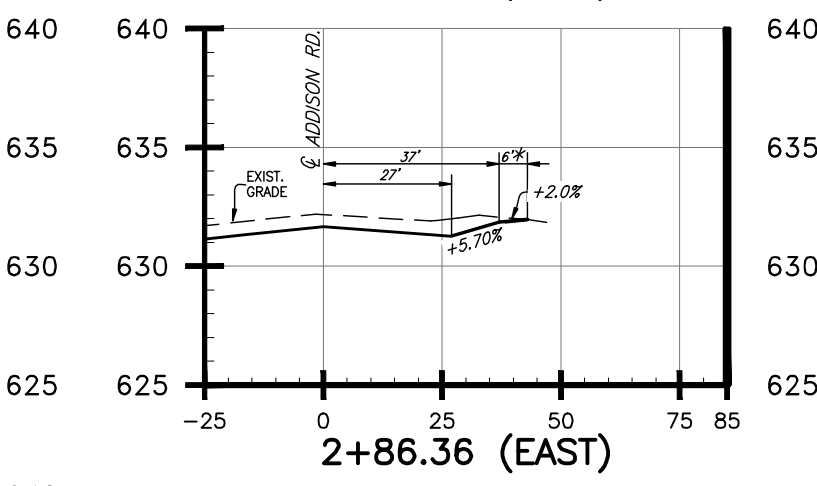
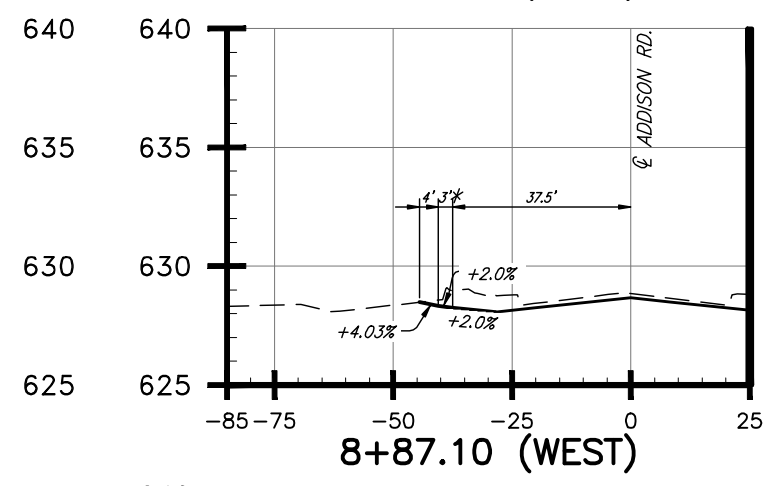
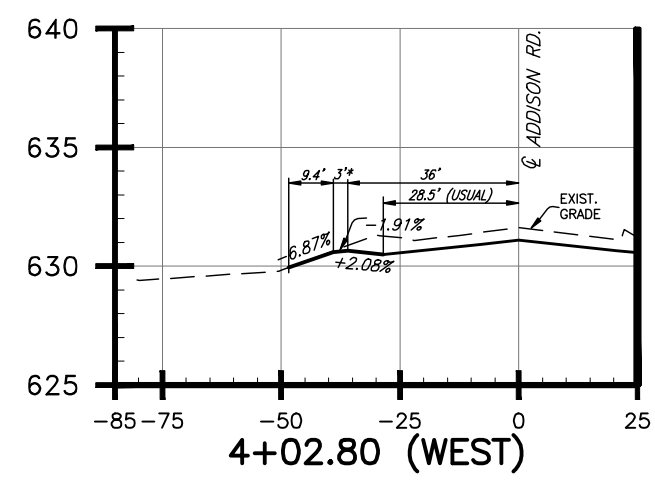
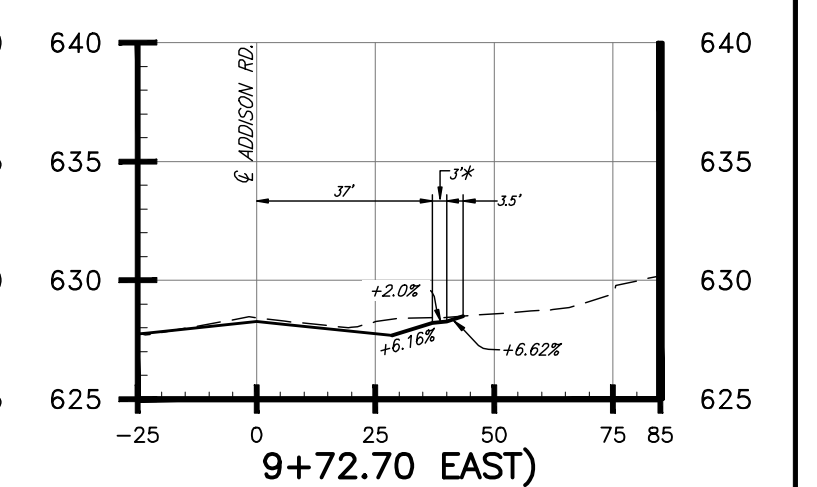
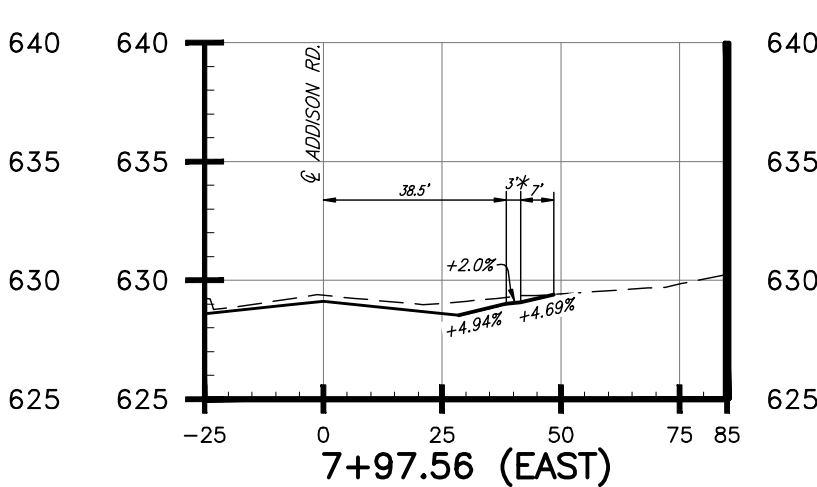
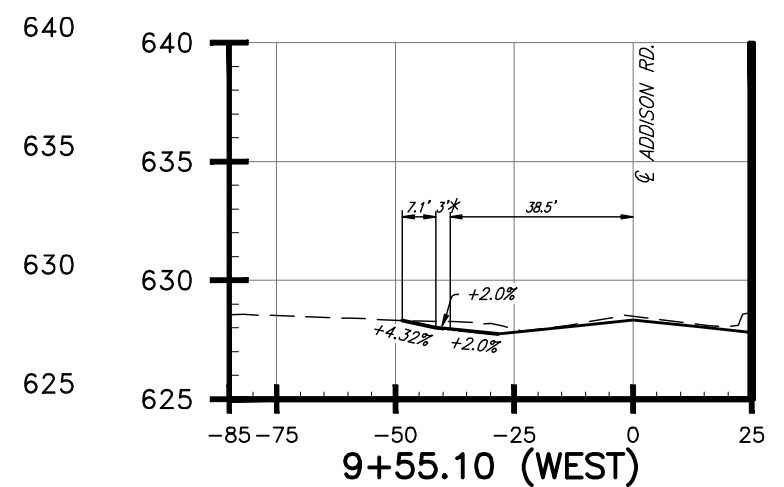
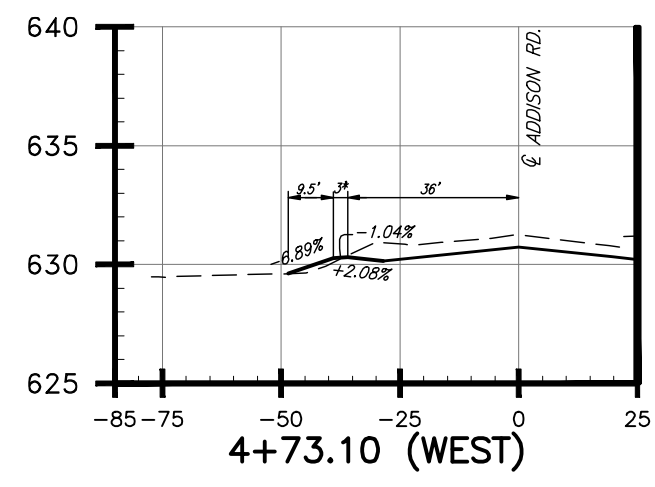
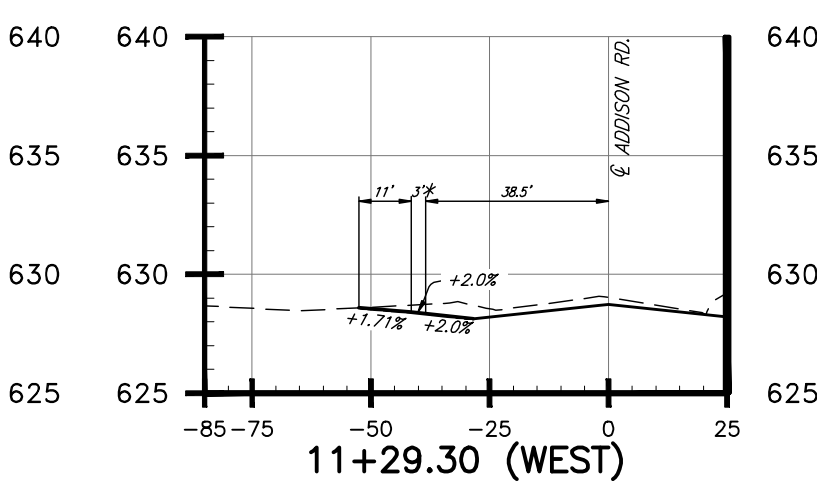
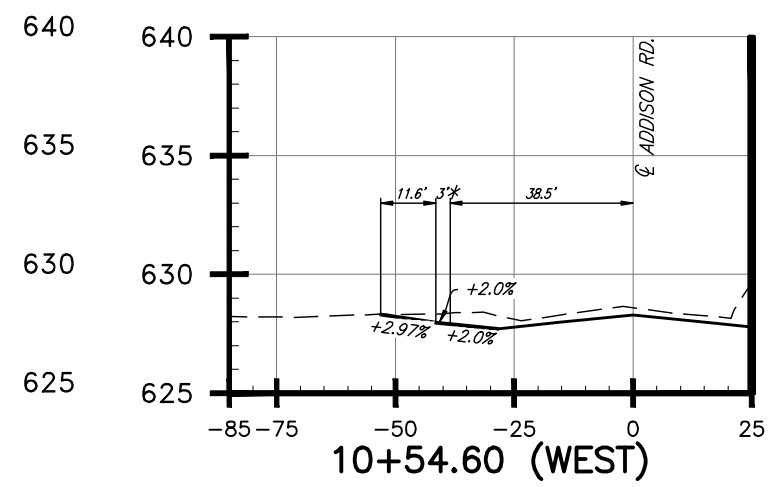
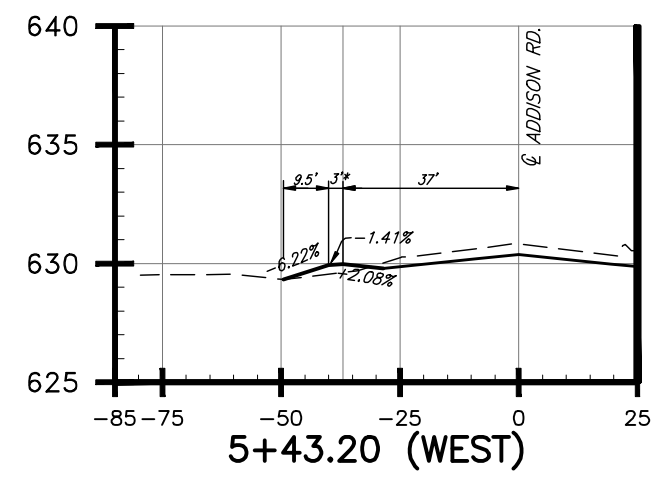

*This record drawing is a compilation of the sealed engineering drawing for this project; modified by addenda, change orders and information furnished by the contractor. The information shown on the record drawings that was provided by the contractor or others not associated with the design engineer cannot be verified for accuracy or completeness. This original sealed drawings are on file at the offices of Birkhoff, Hendricks & Carter, L.L.P.*

*These plans and related specifications were prepared for construction of this specific project only. Reuse of these documents is not permitted without written authorization of Birkhoff, Hendricks, & Conway, L.L.P.*

\*SIDEWALK CROSSING AT DRIVEWAY : BY J.W.B. DATE 05/04/2010

THESE DOCUMENTS ARE FOR BIDDING, CONSTRUCTION, AND PERMIT PURPOSES.  
*John W. Birkhoff*  
 DATE: 10/31/06

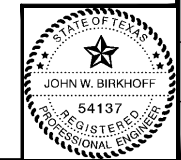

<b>TOWN OF ADDISON, TEXAS</b>		
<b>ADDISON ROAD IMPROVEMENTS BELT LINE ROAD TO ARAPAHO ROAD PHASE 1 CROSS SECTIONS AT DRIVEWAY CENTER LINE</b>		
<b>BIRKHOFF, HENDRICKS &amp; CONWAY L. L. P.</b> CONSULTING ENGINEERS Dallas, Texas		
DESIGNED BY: <u>J.W.B.</u>	PROJECT: <u>2002 102</u>	SHEET NO. <u>22</u>
DRAWN BY: <u>R.J.L.</u>	DATE: <u>SEPTEMBER 2006</u>	OF <u>68</u> SHEETS