

PLotted BY: RLOWE ON 5/14/2010
PLOT SCALE: 1:1,010
H:\Projects\Addison\2002\02\PHASE1\Sheet\Sheets-As-Built\2002\02C42_SISew.dwg
REVISED: 5/12/10 - RLOWE

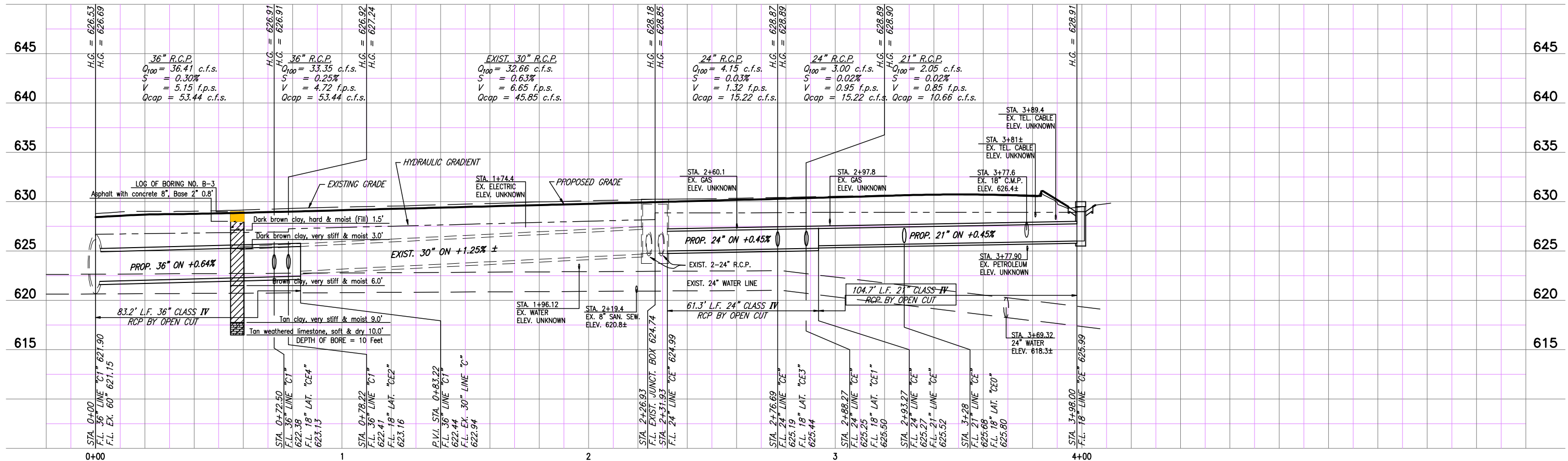

STORM SEWER LINE C1 & PROPOSED CE

T.B.M. AR-2 "C" CUT IN CENTER OF INLET EAST SIDE OF ADDISON RD., @ STA. 9+87, 52 FEET RT. ELEV. 628.79

These plans and related specifications were prepared for construction of this specific project only. Reuse of these documents is not permitted without written authorization of Birkhoff, Hendricks, & Conway, L.L.P.

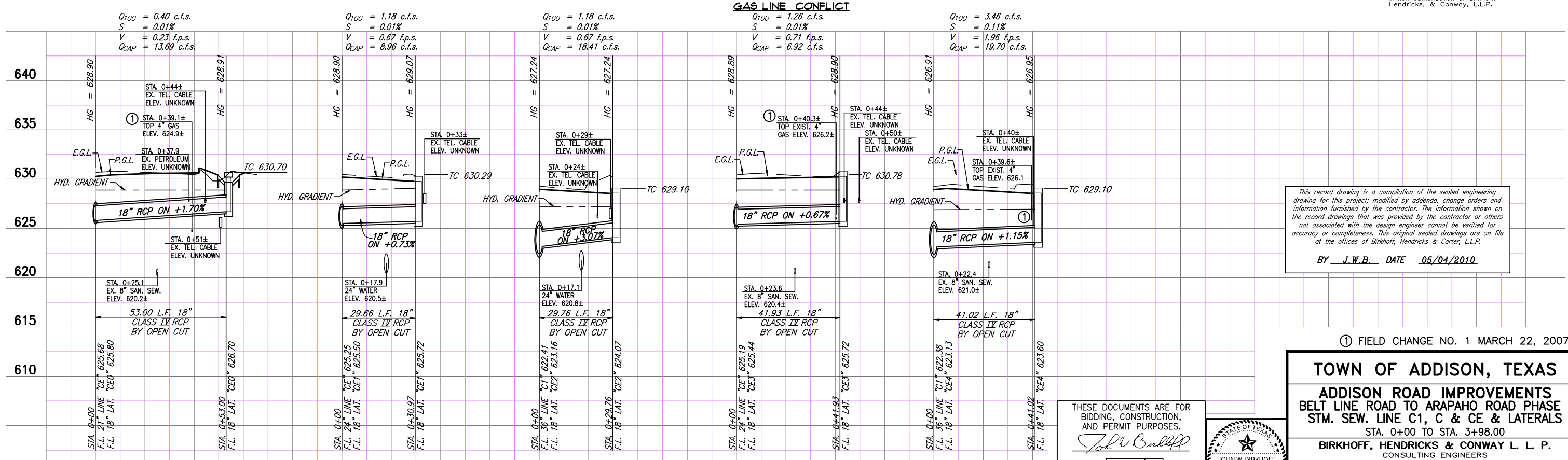

This record drawing is a compilation of the sealed engineering drawing for this project, modified by addenda, change orders and information furnished by the contractor. The information shown on the record drawings that was provided by the contractor or others not associated with the design engineer cannot be verified for accuracy or completeness. This original sealed drawings are on file at the offices of Birkhoff, Hendricks & Carter, L.L.P.

BY J.W.B. DATE 05/04/2010

① FIELD CHANGE NO. 1 MARCH 22, 2007

TOWN OF ADDISON, TEXAS
ADDISON ROAD IMPROVEMENTS
BELT LINE ROAD TO ARAPAHO ROAD PHASE I
STM. SEW. LINE C1, C & CE & LATERALS
STA. 0+00 TO STA. 3+98.00

BIRKHOFF, HENDRICKS & CONWAY L. L. P.
CONSULTING ENGINEERS
Dallas, Texas

THESE DOCUMENTS ARE FOR BIDDING, CONSTRUCTION, AND PERMIT PURPOSES.

John W. Birkhoff
DATE: 3/22/07



DESIGNED BY: J.W.B. PROJECT: 2002 102 SHEET NO. 42
DRAWN BY: R.J.L. DATE: SEPTEMBER 2006 OF 68 SHEETS