

PLOTTED BY: RLOWE ON 5/14/2010
PLOT STYLE: 11x17.ctb
PLOT SCALE: 1:1,000
H:\Projects\Addison\2002102\PHASE1\Sheet\as-Built\2002102\043_SISew.dwg
REVISED: 5/12/10 - RLOWE

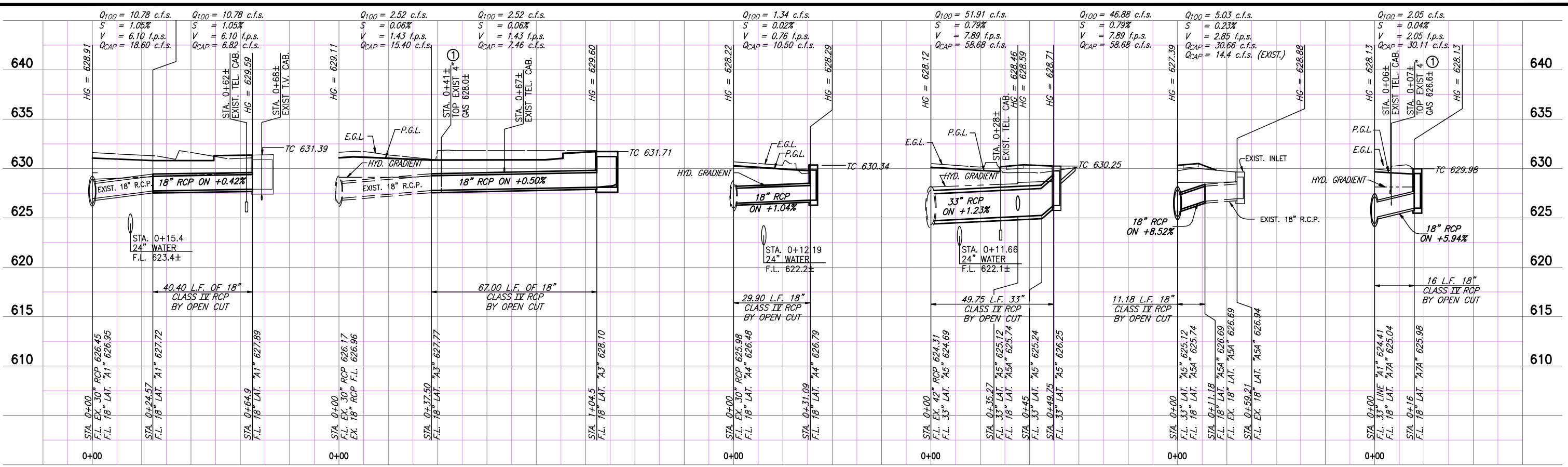

LATERAL "A1"

LATERAL "A3" GAS LINE CONFLICT

LATERAL "A4"

LATERAL "A5"

LATERAL "A5A"

LATERAL "A7A" GAS LINE CONFLICT

B.M.#19 "□" CUT IN CENTER OF INLET 150 FEET SOUTH OF BELT LINE RD., EAST OF INWOOD RD. ELEV. 630.59

T.B.M. AR-1 "□" CUT IN TOP OF VAULT NORTHEAST CORNER OF ADDISON RD. AND BELT LINE RD. ELEV. 634.80

T.B.M. AR-2 "□" CUT IN CENTER OF INLET EAST SIDE OF ADDISON RD., C STA. 9+87, 52 FEET RT. ELEV. 628.79

These plans and related specifications were prepared for construction of this specific project only. Reuse of these documents is not permitted without written authorization of Birkhoff, Hendricks, & Conway, L.L.P.

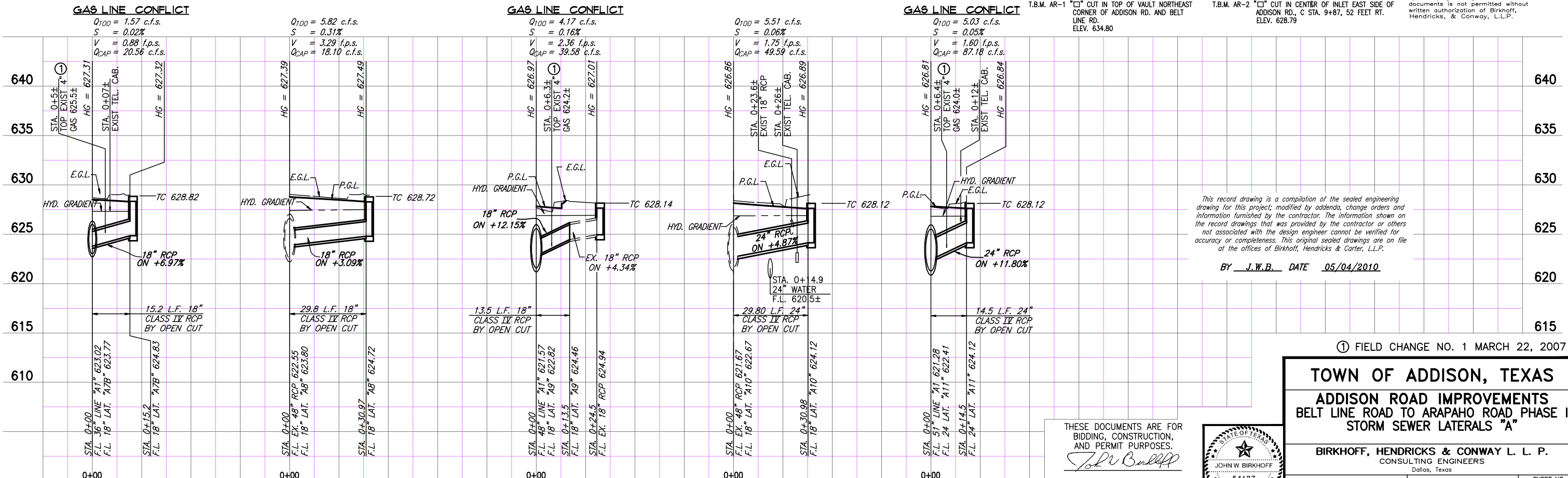

LATERAL "A7B"

LATERAL "A8"

LATERAL "A9"

LATERAL "A10"

LATERAL "A11"

This record drawing is a compilation of the sealed engineering drawing for this project; modified by addenda, change orders and information furnished by the contractor. The information shown on the record drawings that was provided by the contractor or others not associated with the design engineer cannot be verified for accuracy or completeness. This original sealed drawings are on file at the offices of Birkhoff, Hendricks & Carter, L.L.P.

BY J.W.B. DATE 05/04/2010

FIELD CHANGE NO. 1 MARCH 22, 2007

TOWN OF ADDISON, TEXAS
ADDISON ROAD IMPROVEMENTS
BELT LINE ROAD TO ARAPAHO ROAD PHASE I
STORM SEWER LATERALS "A"

BIRKHOFF, HENDRICKS & CONWAY L. L. P.
CONSULTING ENGINEERS
Dallas, Texas



THESE DOCUMENTS ARE FOR BIDDING, CONSTRUCTION, AND PERMIT PURPOSES.
John W. Birkhoff

DATE: 3/22/07

DESIGNED BY: J.W.B.
DRAWN BY: R.J.L.
PROJECT: 2002 102
DATE: SEPTEMBER 2006
SHEET NO. 43 OF 68 SHEETS