

MATCH LINE B-B

MATCH LINE B1-B1

STEAK HOUSE
ADDISON RD.

SAMBUCA
15207 ADDISON RD.

7+00
8+00
9+00
ADDISON ROAD
PROPOSED
14 CRAPES - TUSCORORA

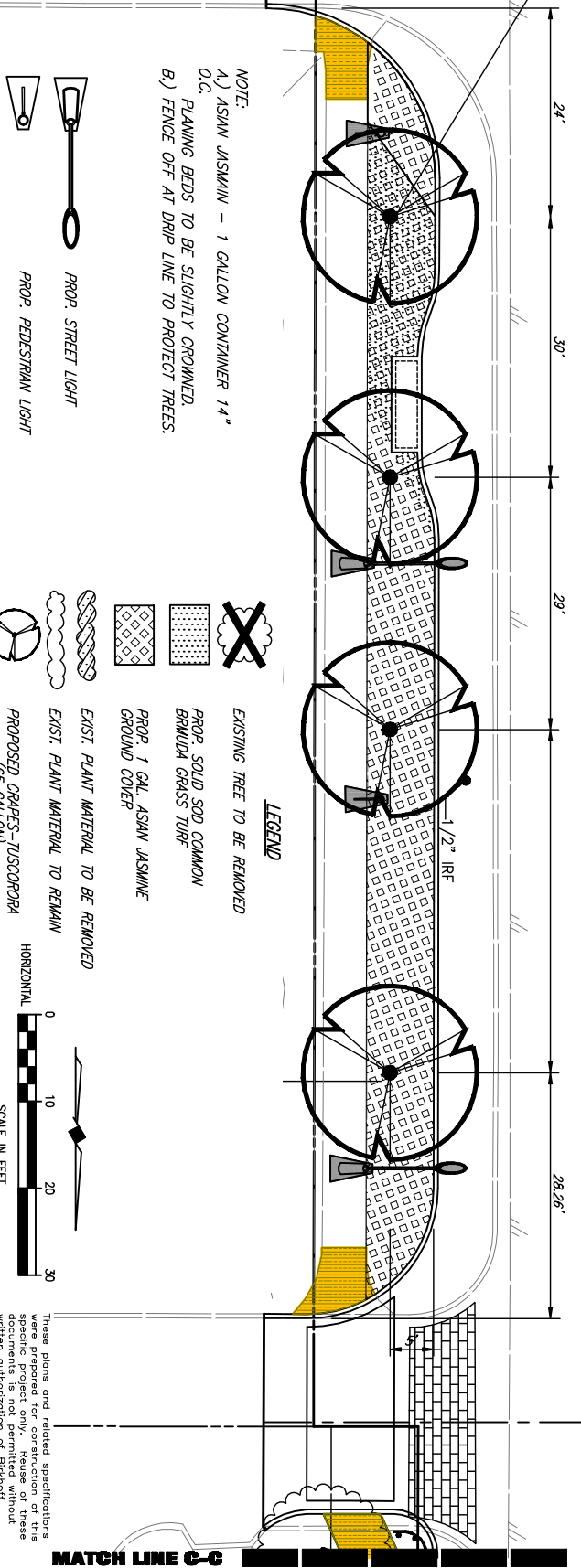
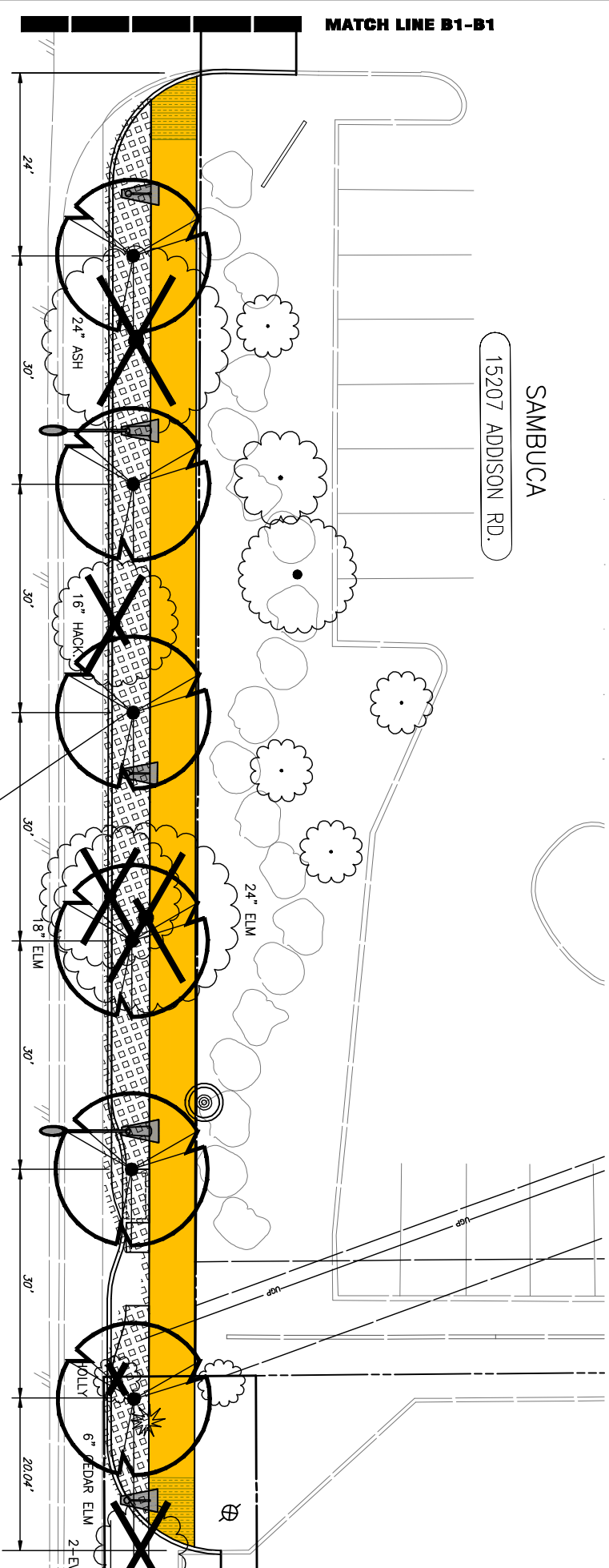
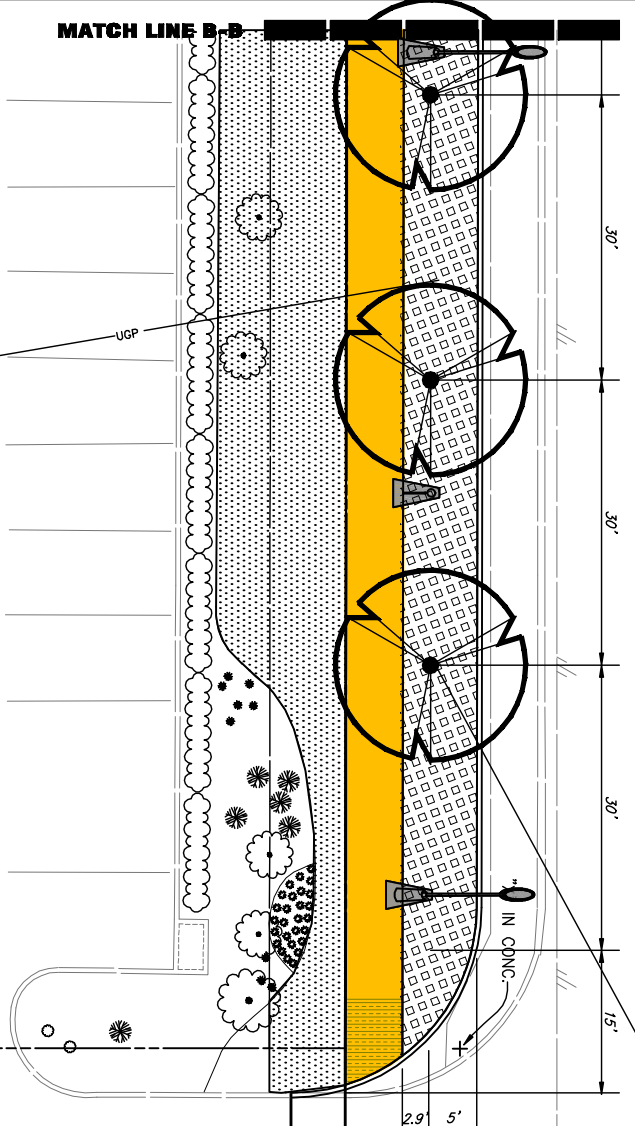

- GENERAL NOTES**
1. ALL DIMENSIONS ARE FROM CENTER OF TREE TRUNK AND / OR BACK OF CURB.
 2. REFERENCE ENGINEER'S DRAWINGS FOR IDENTIFICATION OF HARDSCAPE MATERIALS.
 3. CONTRACTOR TO VERIFY ALL AND STAKE ALL TREE DIMENSIONS PRIOR TO INITIATING WORK.
 4. CONTRACTOR TO LOCATE AND VERIFY ALL BURIED UTILITIES AND PROPOSED UTILITIES PRIOR TO INITIATING ANY EXCAVATION.
 5. ALL NEWLY PLANTED LANDSCAPE AREAS TO HAVE A FULLY AUTOMATIC SUBSURFACE IRRIGATION SYSTEM EQUIPPED WITH FREEZE SENSOR AND RAIN SENS. SEE IRRIGATION PLANS.
 6. ANY PLACE LANDSCAPE BED ABUTS TURF AREA, REQUIRE STEEL EDGING FOR SEPARATION. EXISTING LANDSCAPE MATERIALS LOCATED ON CITY PROPERTY THAT CONFLICT WITH ROAD EXPANSION OR PROPOSED CITY SIDEWALK CONSTRUCTION TO BE REMOVED. REPAIR WITH SOLID SOD GRASS TO MATCH EXIST. OR NOTED OTHERWISE.
 7. EXISTING PLANT MATERIAL TO REMAIN. CONTRACTOR TO COORDINATE WITH PROPERTY OWNER ON MAINTAINING EXISTING LANDSCAPE IRRIGATION.
 8. CONTRACTOR TO NOTIFY CITY OF ADDISON PRIOR TO REMOVAL OF EXISTING TREES TO VERIFY EXACT TREES TO BE REMOVED.
 9. MAINTAIN ANY EXISTING TREE AS DIRECTED BY THE CITY OF ADDISON.

- NOTE:**
- A.) ASIAN JASMINE - 1 GALLON CONTAINER 14" O.C.
 - B.) FENCE OFF AT DUMP LINE TO PROTECT TREES.

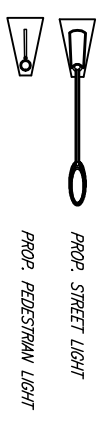

- LEGEND**
- EXISTING TREE TO BE REMOVED
 - PROP. SOLID SOD COMMON BROWALD GRASS TURF
 - PROP. 1 GAL. ASIAN JASMINE GROUND COVER
 - EXIST. PLANT MATERIAL TO BE REMOVED
 - EXIST. PLANT MATERIAL TO REMAIN
 - PROPOSED CRAPES-TUSCORORA (65 GALLON)
 - EXIST. TREE TO REMAIN
 - PROP. SIDEWALK

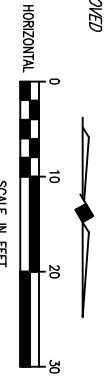

These plans and related specifications were prepared for construction of this specific project only. Reuse of these documents is not permitted without the written consent of Birkhoff, Hendricks & Conway, L.L.P.

BIDJARR BOUTIQUE HOTELS, LTD.
15200 ADDISON RD., SUITE

THESE DOCUMENTS ARE FOR BIDDING, CONSTRUCTION, AND PERMIT PURPOSES.

John W. Birkhoff

DATE: 10/3/10



TOWN OF ADDISON, TEXAS

ADDISON ROAD IMPROVEMENTS
BELT LINE ROAD TO ARAPAHO ROAD PHASE I
ADDISON ROAD LANDSCAPE

BIRKHOFF, HENDRICKS & CONWAY L.L.P.
CONSULTING ENGINEERS
Dallas, Texas

DESIGNED BY: B.H.C.
DRAWN BY: B.H.C.

PROJECT: 2002_102
DATE: SEPTEMBER 2006

SHEET NO. 54
OF 68 SHEETS

This record drawing is a compilation of the sealed engineering drawing for this project, modified by addenda, change orders and information furnished by the contractor. The information shown on the record drawings that was provided by the contractor or others not associated with the design engineer cannot be verified for accuracy or completeness. This original sealed drawings are on file at the offices of Birkhoff, Hendricks & Conway, L.L.P.

BY: J.W.B. DATE: 05/04/2010