

Note: For Continuation of Storm Sewer Construction and Right of Way, See "Off-Site" Sheet No. 38

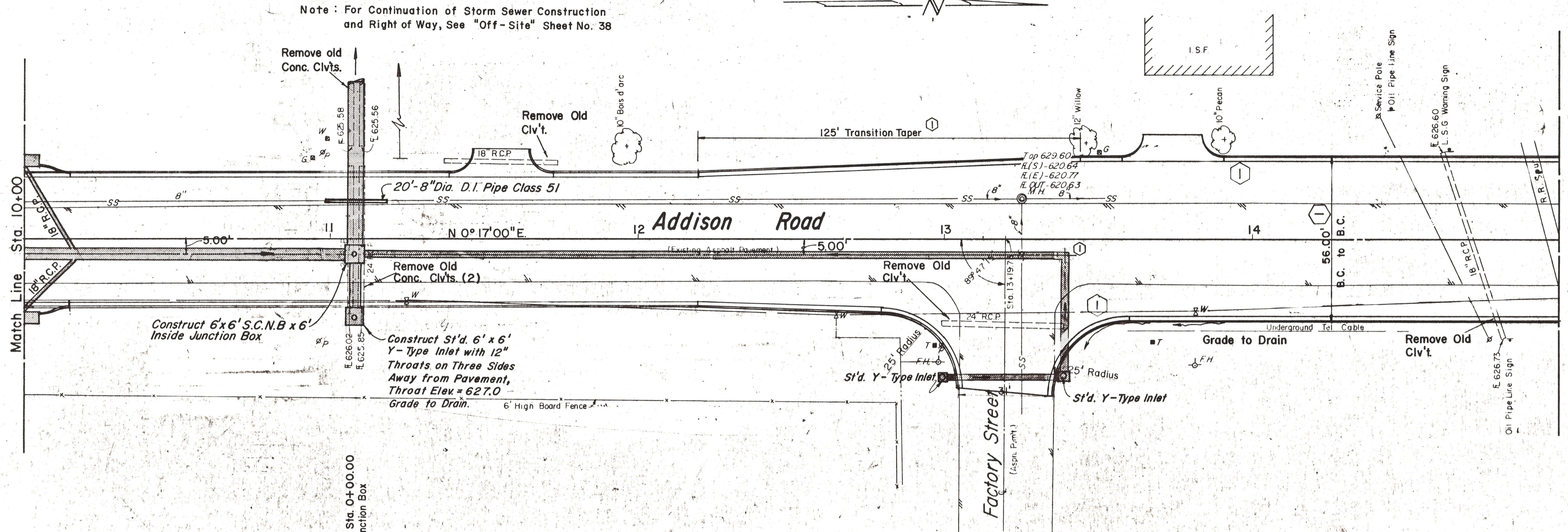

ESTIMATED QUANTITIES		UNIT	QUANTITY
37	6" P.V.C. Pipe SDR 18	L.F.	150
32	18" R.C.P.	L.F.	95
31	24" R.C.P.	L.F.	150
30	30" R.C.P.	L.F.	271
29	36" R.C.P.	L.F.	15
27	48" R.C.P.	L.F.	109
17	Y-Type Inlets	EA.	
21	Junction Box	EA.	2 (1)
1	Remove Old Conc. (Clvt.)	EA.	5
13	Misc. Conc.	C.Y.	9
34	Adjust M.H.	EA.	1
36	Adjust Valve Boxes	EA.	3

LEGEND

- Bench Mark
- ⊕ Hub and Tack
- ⊕ Monument
- ⊕ Gas Meter
- ⊕ Gas Valve
- ⊕ Gas Line
- ⊕ Power Pole (typical pole symbol)
- ⊕ Power Line
- ⊕ Guy Wire and Anchor
- ⊕ Telephone Cable Box, or Riser
- ⊕ Telephone Line
- ⊕ Water Meter
- ⊕ Water Valve
- ⊕ Water Line
- ⊕ Fire Hydrant
- ⊕ Water Spigot
- ⊕ Manhole
- ⊕ Cleanout
- ⊕ Drainage Inlet
- ⊕ Sanitary Sewer Line
- ⊕ Storm Sewer Line
- ⊕ Fence Line
- ⊕ Flow Direction Indicator
- ⊕ Property or Right-of-Way Line
- ⊕ Easement Line

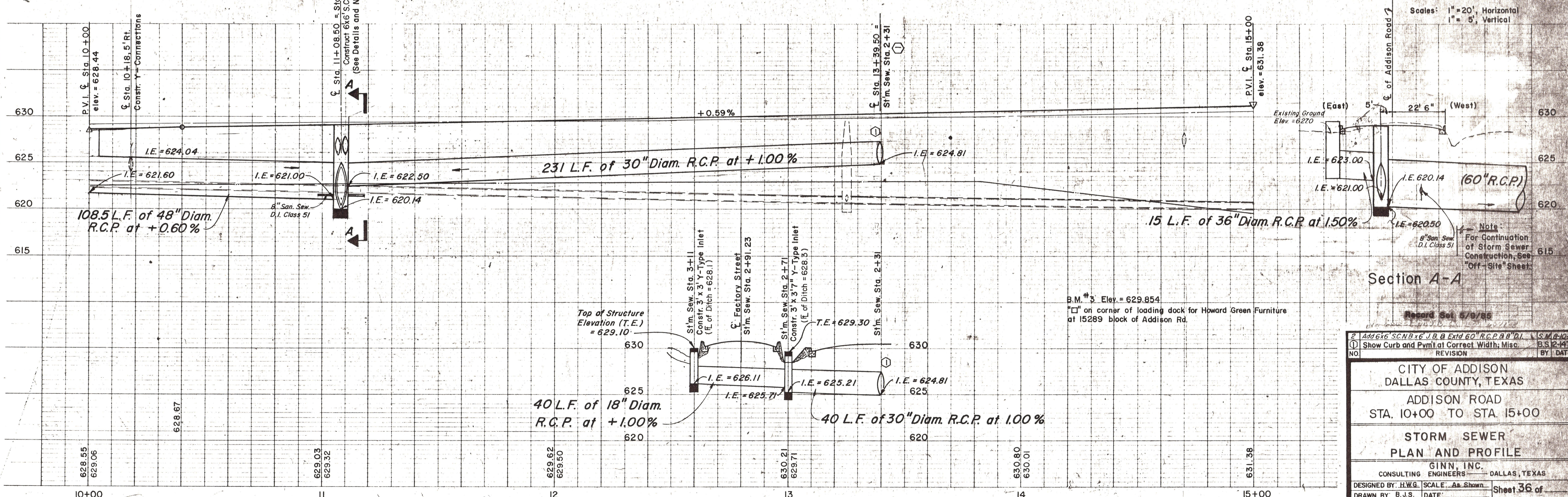

Scales: 1" = 20', Horizontal
1" = 5', Vertical

Section A-A

Record Set 6/9/85

2 Add 6' x 6' S.C.N.B. x 6' J.B. & Ext'd 60' R.C.P. 8' D.I. S.M.A. 1077
 (1) Show Curb and Pvm't at Correct Width; Misc. B.S. 12-1476
 NO. REVISION BY DATE

CITY OF ADDISON
 DALLAS COUNTY, TEXAS

ADDISON ROAD
 STA. 10+00 TO STA. 15+00

STORM SEWER
 PLAN AND PROFILE

GINN, INC.
 CONSULTING ENGINEERS - DALLAS, TEXAS

DESIGNED BY: H.W.G. SCALE: As Shown
 DRAWN BY: B.J.S. DATE: Sheet 36 of