

Relocate 8" Water Line: Lower W.L. Below Storm Sewer with Bends and Thrust Blocks. See Specifications for Details.

⊙ Mildred Street Intersection Sta. 26+86.71, Survey Base Line

ESTIMATED QUANTITIES			
ITEM	DESCRIPTION	UNIT	QUANTITY
32	18" R.C.P.	L.F.	205
29	36" R.C.P.	L.F.	343
28	42" R.C.P.	L.F.	157
17	Y-Type Inlets	EA.	2
19	Recessed Curb Inlets	EA.	2
38	Adjust 8" Water Line	L.F.	30
36	Adjust Valve Boxes	EA.	1
1	REMOVE CONC.	EA.	7
34	ADJUST. M.H.	EA.	1
13	MISC. CONC.	C.Y.	5

LEGEND

- Bench Mark
- ⊙ Hub and Teck
- I.P.S. Iron Pin
- ⊙ O.D.M. Minimum
- ⊙ Gas Meter
- ⊙ Gas Valve
- ⊙ Gas Line
- ⊙ Power Pole (typical pole symbol)
- ⊙ Power Line
- ⊙ Guy Wire and Anchor
- ⊙ Telephone Cable Box, or Riser
- ⊙ Telephone Line
- ⊙ Water Meter
- ⊙ Water Valve
- ⊙ Water Line
- ⊙ Fire Hydrant
- ⊙ Water Spigot
- ⊙ Manhole
- ⊙ Cleanout
- ⊙ Drainage Inlet
- ⊙ Sanitary Sewer Line
- ⊙ Storm Sewer Line
- ⊙ Fence Line
- ⊙ Flow Direction Indicator
- ⊙ Property or Right-of-Way Line
- ⊙ Easement Line

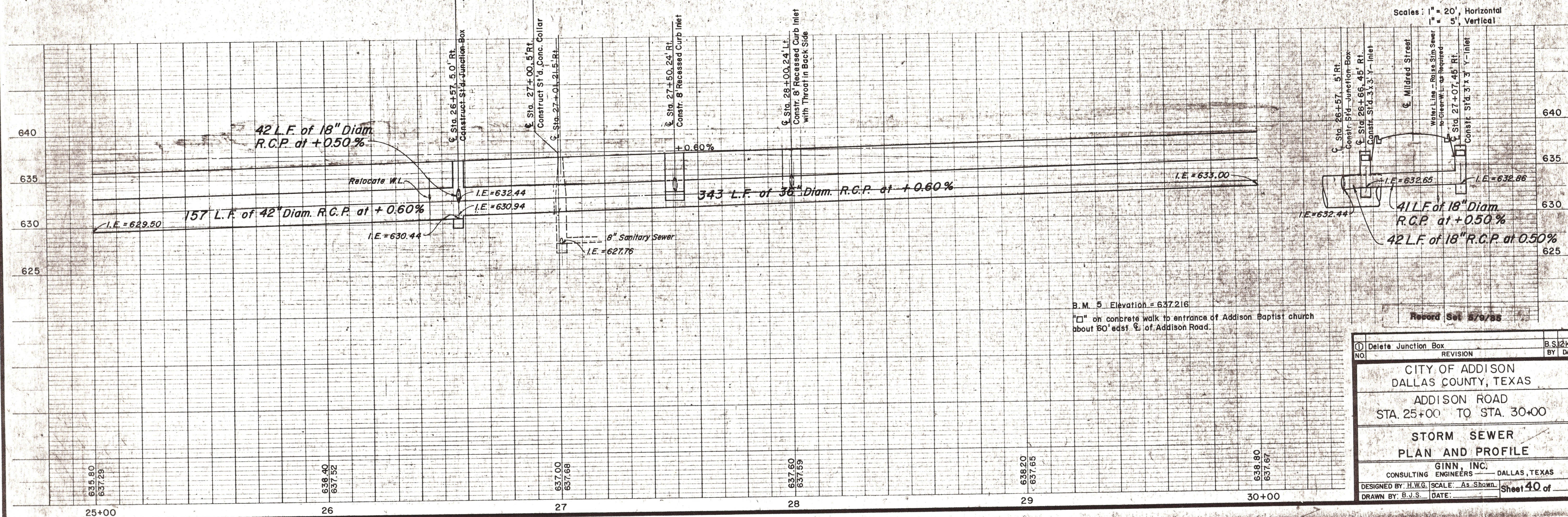

Scales: 1" = 20' Horizontal
1" = 5' Vertical

B.M. 5 Elevation = 637.216
"□" on concrete walk to entrance of Addison Baptist church about 60' east of Addison Road.

NO.	REVISION	BY	DATE
1	Delete Junction Box	B.S.	12/4/78

CITY OF ADDISON
DALLAS COUNTY, TEXAS

ADDISON ROAD
STA. 25+00 TO STA. 30+00

**STORM SEWER
PLAN AND PROFILE**

GINN, INC.
CONSULTING ENGINEERS - DALLAS, TEXAS

DESIGNED BY: H.W.G. SCALE: As Shown
DRAWN BY: B.J.S. DATE: _____

Sheet 40 of _____