

ESTIMATED QUANTITIES			
ITEM	DESCRIPTION	UNIT	QUANTITY
32	18" R.C.P.	L.F.	48 (2)
31	24" R.C.P.	L.F.	200 (2)
18	Std. Curb - Type Inlet	EA	2 (2)
0			
36	Adjust Valve Boxes	EA	3
39	Relocate F.H.	EA	1

- LEGEND**
- Bench Mark
 - I.P. Hub and Tack
 - Iron Pin
 - ⊙ Monument
 - ⊗ Gas Meter
 - ⊕ Gas Valve
 - ⊛ Gas Line
 - ⊞ Power Pole (typical pole symbol)
 - ⊟ Power Line
 - ⊠ Guy Wire and Anchor
 - ⊡ Telephone Cable Box, or Riser
 - ⊣ Telephone Line
 - ⊤ Water Meter
 - ⊥ Water Valve
 - ⊦ Water Line
 - ⊧ Fire Hydrant
 - ⊨ Water Spigot
 - ⊩ Manhole
 - ⊪ Cleanout
 - ⊫ Drainage Inlet
 - ⊬ Sanitary Sewer Line
 - ⊭ Storm Sewer Line
 - ⊮ Fence Line
 - ⊯ Flow Direction Indicator
 - ⊰ Property or Right-of-Way Line
 - ⊱ Easement Line

Scales: 1" = 20', Horizontal
 1" = 5', Vertical

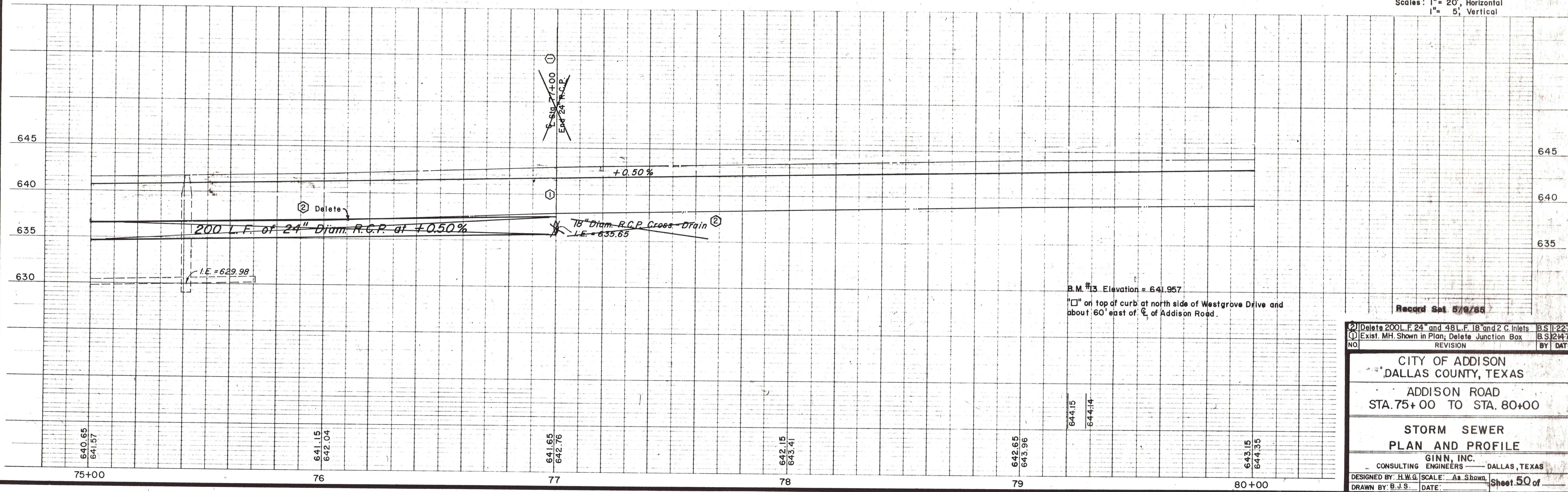

B.M. #13 Elevation = 641.957
 □ on top of curb at north side of Westgrove Drive and about 60' east of C of Addison Road.

NO	REVISION	BY	DATE

Record Set 5/9/86

CITY OF ADDISON
DALLAS COUNTY, TEXAS
ADDISON ROAD
STA. 75+00 TO STA. 80+00
STORM SEWER PLAN AND PROFILE
 GINN, INC.
 CONSULTING ENGINEERS - DALLAS, TEXAS
 DESIGNED BY: H.W.G. SCALE: As Shown
 DRAWN BY: B.J.S. DATE: Sheet 50 of