

|      |                  | ESTIMATED QUANTITIES |          |
|------|------------------|----------------------|----------|
| ITEM | DESCRIPTION      | UNIT                 | QUANTITY |
| 36   | Adjust Valve Box | Ea.                  | 2        |
| 1    | Remove Old Conc. | Ea.                  | 2        |
|      |                  |                      |          |
|      |                  |                      |          |
|      |                  |                      |          |
|      |                  |                      |          |
|      |                  |                      |          |
|      |                  |                      |          |
|      |                  |                      |          |
|      |                  |                      |          |
|      |                  |                      |          |
|      |                  |                      |          |
|      |                  |                      |          |
|      |                  |                      |          |
|      |                  |                      |          |
|      |                  |                      |          |
|      |                  |                      |          |
|      |                  |                      |          |
|      |                  |                      |          |
|      |                  |                      |          |

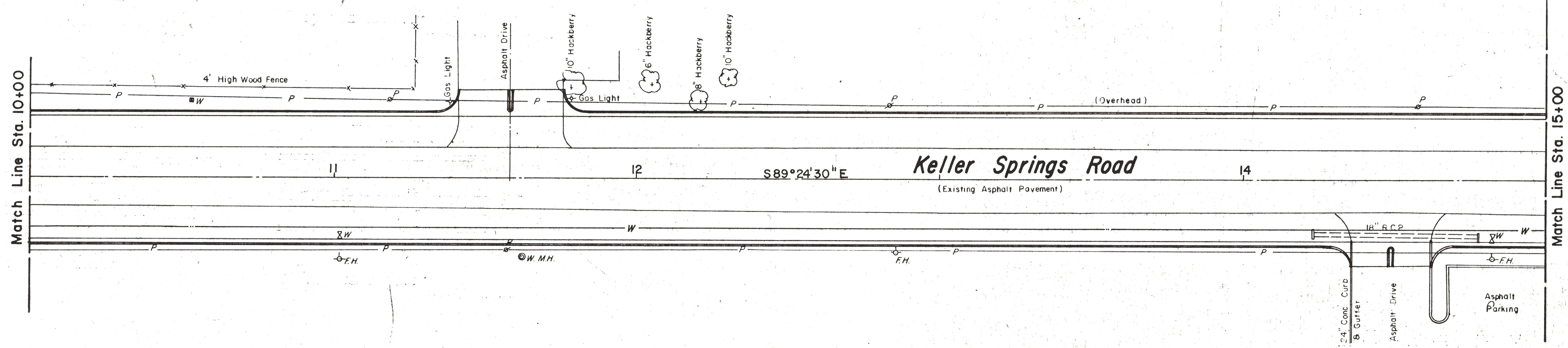

**Keller Springs Road**  
 (Existing Asphalt Pavement)  
 S89°24'30" E

Scales: 1" = 20', Horizontal  
 1" = 5', Vertical

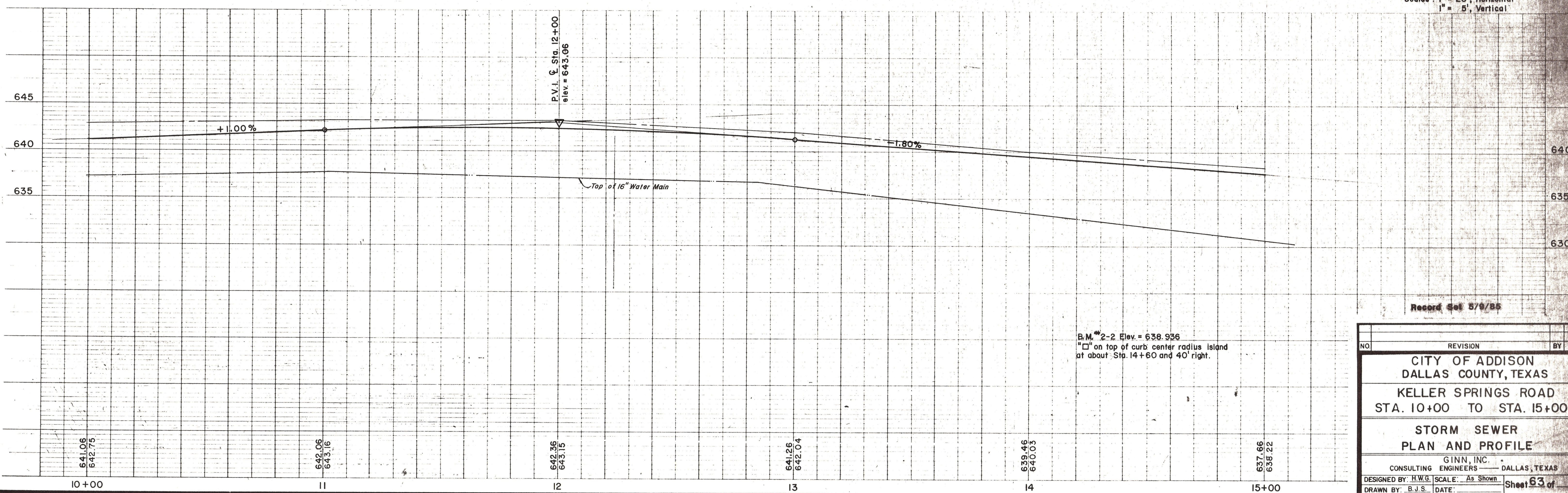

B.M. 2-2 Elev. = 638.936  
 "□" on top of curb center radius island at about Sta. 14+60 and 40' right.

Record Set 5/9/85

| NO. | REVISION | BY | DATE |
|-----|----------|----|------|
|     |          |    |      |
|     |          |    |      |
|     |          |    |      |

**CITY OF ADDISON**  
**DALLAS COUNTY, TEXAS**  
**KELLER SPRINGS ROAD**  
**STA. 10+00 TO STA. 15+00**  
**STORM SEWER**  
**PLAN AND PROFILE**  
 GINN, INC.  
 CONSULTING ENGINEERS — DALLAS, TEXAS  
 DESIGNED BY: H.W.G. SCALE: As Shown  
 DRAWN BY: B.J.S. DATE: Sheet 63 of