

ESTIMATED QUANTITIES		UNIT	QUANTITY
ITEM	DESCRIPTION		
	None		

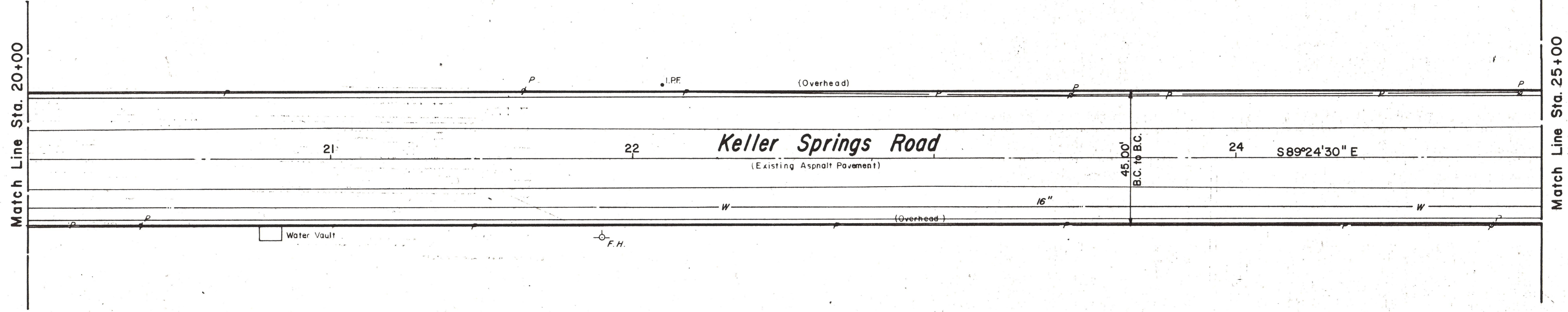

Scales : 1" = 20' Horizontal
 1" = 5' Vertical

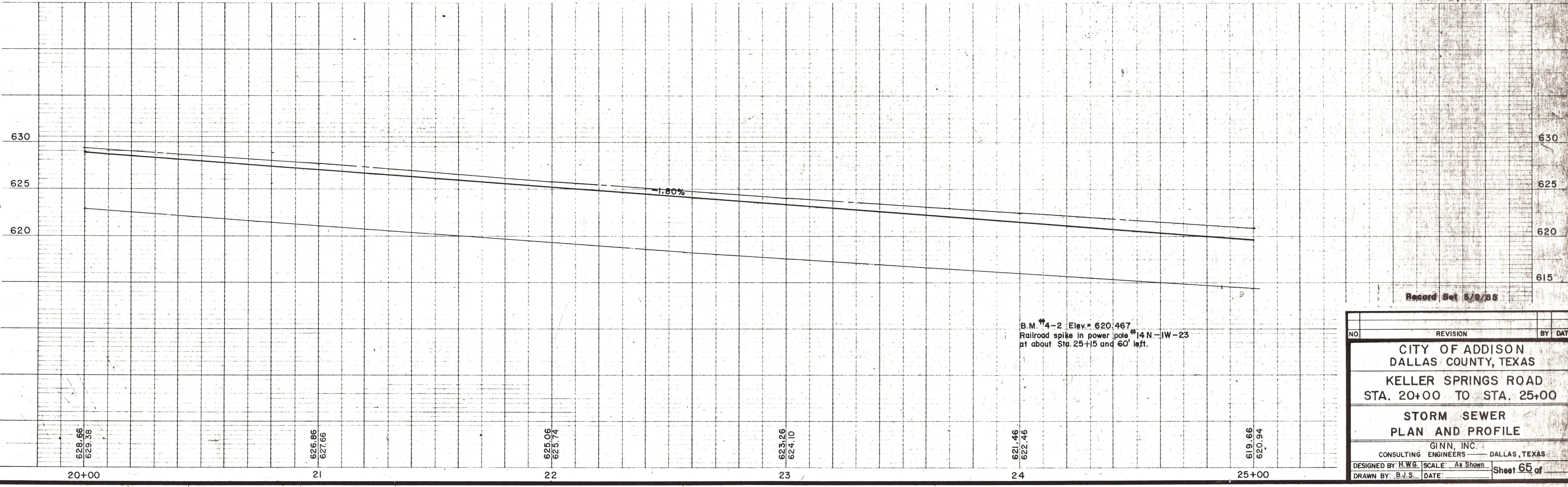

Record Set 5/9/88

B.M. #4-2 Elev. = 620.467
 Railroad spike in power pole #14 N-1W-23
 at about Sta. 25+15 and 60' left.

NO.	REVISION	BY	DATE

**CITY OF ADDISON
 DALLAS COUNTY, TEXAS**

**KELLER SPRINGS ROAD
 STA. 20+00 TO STA. 25+00**

**STORM SEWER
 PLAN AND PROFILE**

GINN, INC.
 CONSULTING ENGINEERS - DALLAS, TEXAS

DESIGNED BY: H.W.G. SCALE: As Shown
 DRAWN BY: B.J.S. DATE: Sheet 65 of