

Addison!

CONSTRUCTION PLANS FOR ADDISON ROAD AND EXCEL PARKWAY INTERSECTION IMPROVEMENTS

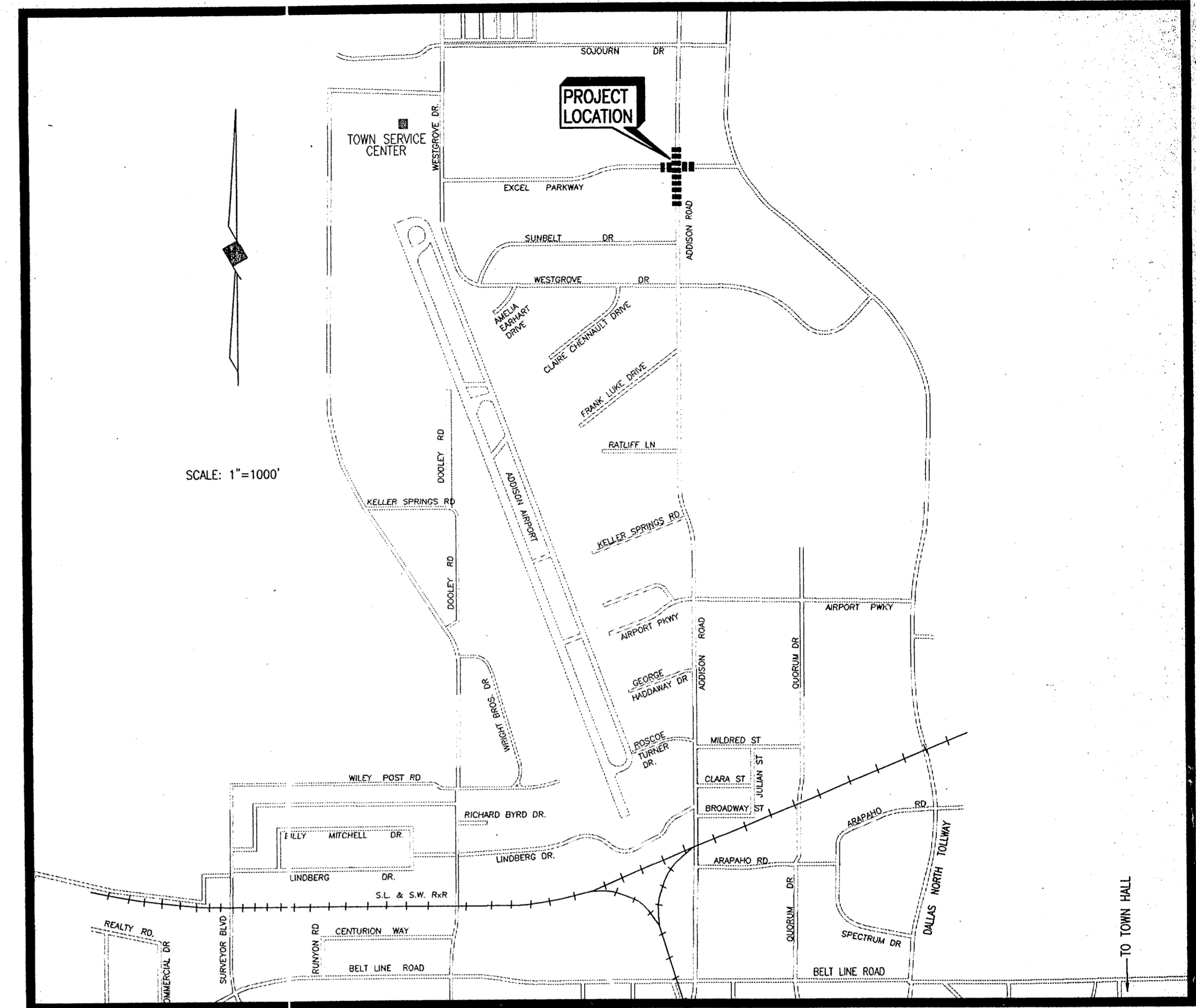

SHEET INDEX

SHEET DESCRIPTION	SHEET NO.
CONSTRUCTION PLAN	1
CONTOUR PLAN	2
PAVING MARKING PLAN	3
PROFILES	4
CROSS SECTIONS	5
PAVING DETAILS	6
SIGNAL LAYOUT PLAN	7
SIGNAL LAYOUT TABLES	9-13
SIGNAL DETAILS	14-15
LANDSCAPE PLAN	16

SHIMEK, JACOBS & FINKLEA, L.L.P.
CONSULTING ENGINEERS
Dallas, Texas

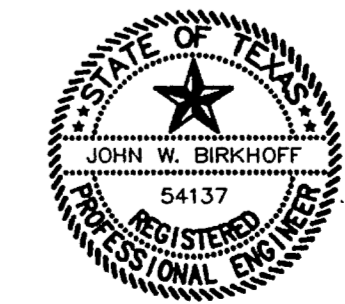

THESE DOCUMENTS ARE FOR
BIDDING, CONSTRUCTION,
AND PERMIT PURPOSES.
John W. Birkhoff
DATE: 1/26/98

JANUARY, 1998

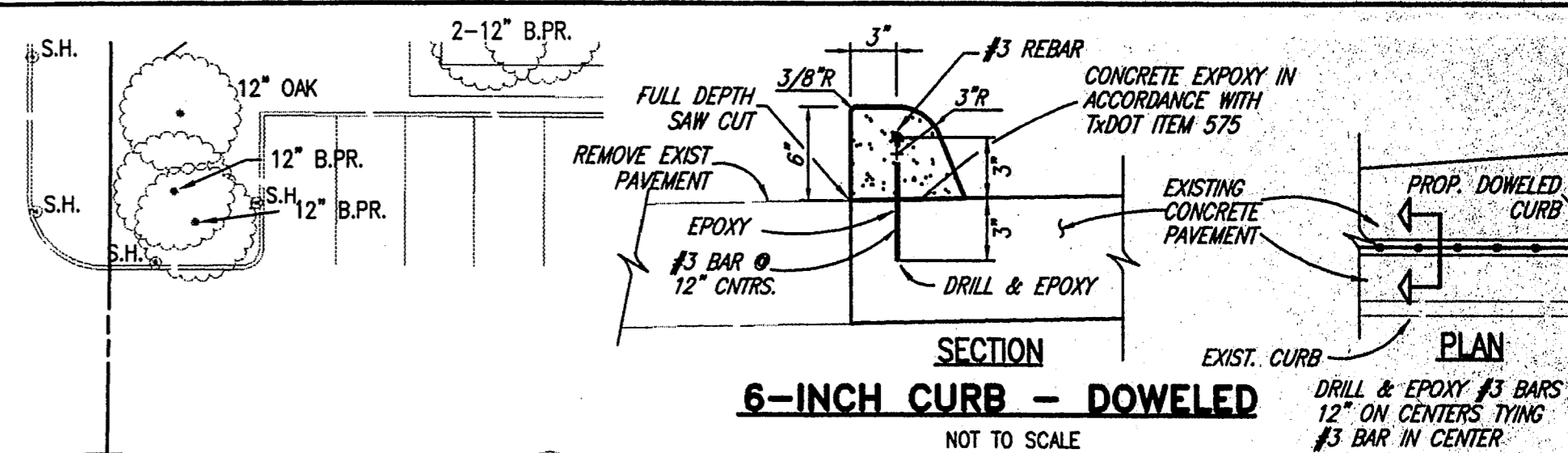
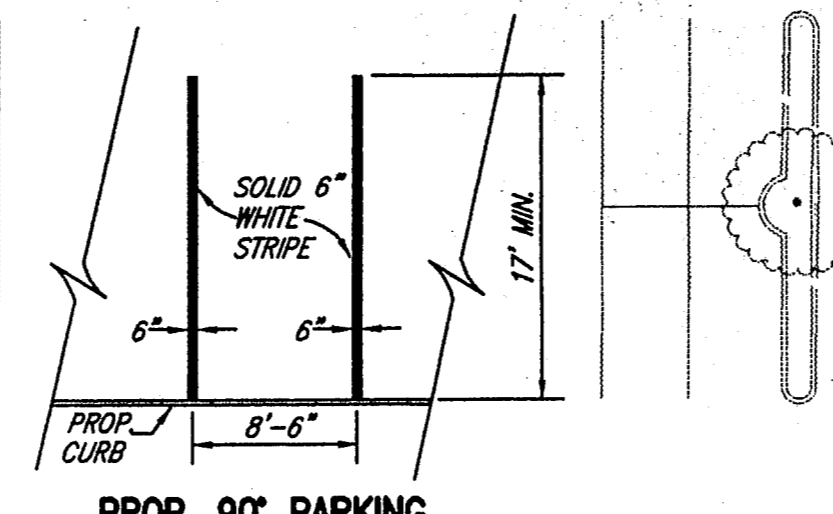
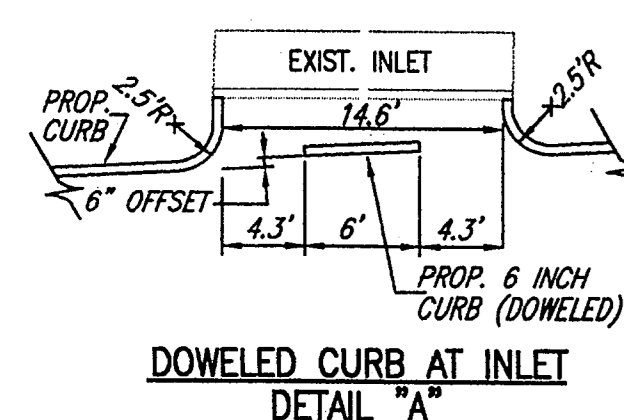
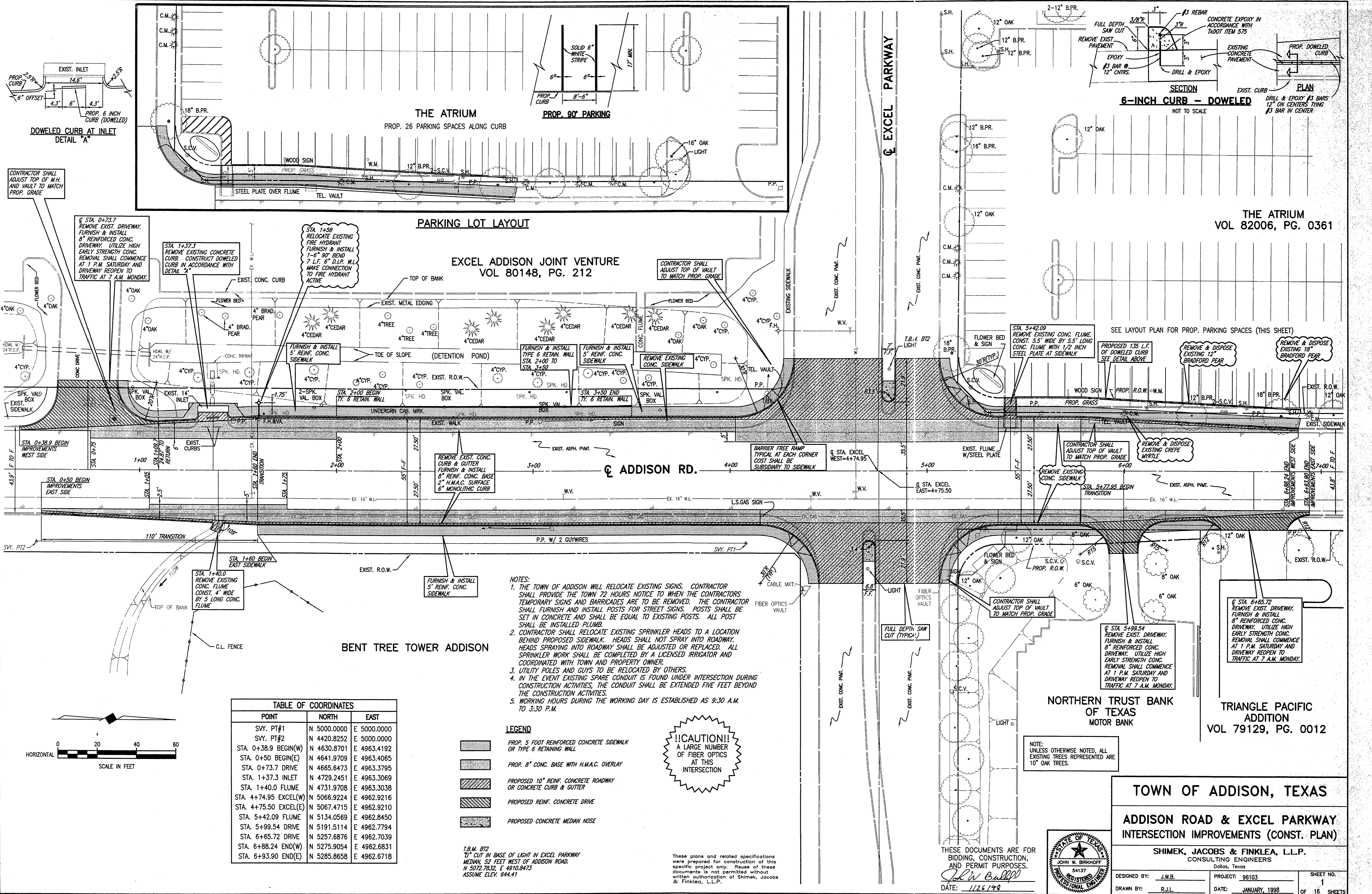

CONTRACTOR SHALL ADJUST TOP OF U.H. AND VAULT TO MATCH PROP. GRADE

@ STA. 0+73.7 REMOVE EXIST. DRIVEWAY. FURNISH & INSTALL 8" REINFORCED CONC. DRIVEWAY. UTILIZE HIGH EARLY STRENGTH CONC. REMOVAL SHALL COMMENCE AT 1 P.M. SATURDAY AND DRIVEWAY REOPEN TO TRAFFIC AT 7 A.M. MONDAY.

STA 1+37.3 REMOVE EXISTING CONCRETE CURB. CONSTRUCT DOVELED CURB IN ACCORDANCE WITH DETAIL "A"

STA 1+58 RELOCATE EXISTING FIRE HYDRANT FURNISH & INSTALL 1-6" 90° BEND 7 L.F. 8" D.I.P. W.L. MAKE CONNECTION TO FIRE HYDRANT ACTIVE

CONTRACTOR SHALL ADJUST TOP OF VAULT TO MATCH PROP. GRADE

STA 5+42.09 REMOVE EXISTING CONC. FLUME. CONST. 5.5' WIDE BY 5.5' LONG CONC. FLUME WITH 1/2" INCH STEEL PLATE AT SIDEWALK

REMOVE & DISPOSE EXISTING 12" BRADFORD PEAR

REMOVE & DISPOSE EXISTING 18" BRADFORD PEAR

REMOVE EXIST. CONC. CURB & GUTTER FURNISH & INSTALL 6" REINF. CONC. BASE 2" H.M.A.C. SURFACE 6" MONOLITHIC CURB

BARRIER FREE RAMP TYPICAL AT EACH CORNER COST SHALL BE SUBSIDIARY TO SIDEWALK

CONTRACTOR SHALL ADJUST TOP OF VAULT TO MATCH PROP. GRADE

REMOVE & DISPOSE EXISTING CREPE MYRTLE

STA 0+38.9 BEGIN IMPROVEMENTS WEST SIDE

STA 0+50 BEGIN IMPROVEMENTS EAST SIDE

STA 1+40.0 REMOVE EXISTING CONC. FLUME CONST. 4' WIDE BY 5' LONG CONC. FLUME

STA 1+60 BEGIN EAST SIDEWALK

STA 1+80 BEGIN EAST SIDEWALK

STA 1+80.0 REMOVE EXISTING CONC. FLUME CONST. 4' WIDE BY 5' LONG CONC. FLUME

STA 1+80.0 REMOVE EXISTING CONC. FLUME CONST. 4' WIDE BY 5' LONG CONC. FLUME

STA 1+80.0 REMOVE EXISTING CONC. FLUME CONST. 4' WIDE BY 5' LONG CONC. FLUME

STA 1+80.0 REMOVE EXISTING CONC. FLUME CONST. 4' WIDE BY 5' LONG CONC. FLUME

POINT	NORTH	EAST
SVY. PT#1	N 5000.0000	E 5000.0000
SVY. PT#2	N 4420.8252	E 5000.0000
STA. 0+38.9 BEGIN(W)	N 4630.8701	E 4963.4192
STA. 0+50 BEGIN(E)	N 4641.9709	E 4963.4065
STA. 0+73.7 DRIVE	N 4665.6473	E 4963.3795
STA. 1+37.3 INLET	N 4729.2451	E 4963.3069
STA. 1+40.0 FLUME	N 4731.9708	E 4963.3038
STA. 4+74.95 EXCEL(W)	N 5066.9224	E 4962.9216
STA. 4+75.50 EXCEL(E)	N 5067.4715	E 4962.9210
STA. 5+42.09 FLUME	N 5134.0569	E 4962.8450
STA. 5+99.54 DRIVE	N 5191.5114	E 4962.7794
STA. 6+65.72 DRIVE	N 5257.6876	E 4962.7039
STA. 6+88.24 END(W)	N 5275.9054	E 4962.6831
STA. 6+93.90 END(E)	N 5285.8658	E 4962.6718

- NOTES:
- THE TOWN OF ADDISON WILL RELOCATE EXISTING SIGNS. CONTRACTOR SHALL PROVIDE THE TOWN 72 HOURS NOTICE TO WHEN THE CONTRACTORS TEMPORARY SIGNS AND BARRICADES ARE TO BE REMOVED. THE CONTRACTOR SHALL FURNISH AND INSTALL POSTS FOR STREET SIGNS. POSTS SHALL BE SET IN CONCRETE AND SHALL BE EQUAL TO EXISTING POSTS. ALL POST SHALL BE INSTALLED PLUMB.
 - CONTRACTOR SHALL RELOCATE EXISTING SPRINKLER HEADS TO A LOCATION BEHIND PROPOSED SIDEWALK. HEADS SHALL NOT SPRAY INTO ROADWAY. HEADS SPRAYING INTO ROADWAY SHALL BE ADJUSTED OR REPLACED. ALL SPRINKLER WORK SHALL BE COMPLETED BY A LICENSED IRRIGATOR AND COORDINATED WITH TOWN AND PROPERTY OWNER.
 - UTILITY POLES AND GUYS TO BE RELOCATED BY OTHERS.
 - IN THE EVENT EXISTING SPARE CONDUIT IS FOUND UNDER INTERSECTION DURING CONSTRUCTION ACTIVITIES, THE CONDUIT SHALL BE EXTENDED FIVE FEET BEYOND THE CONSTRUCTION ACTIVITIES.
 - WORKING HOURS DURING THE WORKING DAY IS ESTABLISHED AS 9:30 A.M. TO 3:30 P.M.

- LEGEND
- PROP. 5 FOOT REINFORCED CONCRETE SIDEWALK OR TYPE 6 RETAINING WALL
 - PROP. 8" CONC. BASE WITH H.M.A.C. OVERLAY
 - PROPOSED 10" REINF. CONCRETE ROADWAY OR CONCRETE CURB & GUTTER
 - PROPOSED REINF. CONCRETE DRIVE
 - PROPOSED CONCRETE MEDIAN NOSE

!!CAUTION!!
A LARGE NUMBER OF FIBER OPTICS AT THIS INTERSECTION

T.B.M. B72
1" CUT IN BASE OF LIGHT IN EXCEL PARKWAY MEDIAN, 52 FEET WEST OF ADDISON ROAD.
N 5072.7832, E 4910.8473
ASSUME ELEV. 644.41

These plans and related specifications were prepared for construction of this specific project only. Reuse of these documents is not permitted without written authorization of Shimek, Jacobs & Finklea, L.L.P.

THESE DOCUMENTS ARE FOR BIDDING, CONSTRUCTION, AND PERMIT PURPOSES.
DATE: 1/24/98

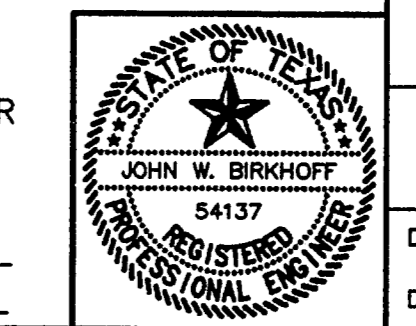

TOWN OF ADDISON, TEXAS
ADDISON ROAD & EXCEL PARKWAY INTERSECTION IMPROVEMENTS (CONST. PLAN)

SHIMEK, JACOBS & FINKLEA, L.L.P.
CONSULTING ENGINEERS
Dallas, Texas

DESIGNED BY: J.W.B. PROJECT: 96103 SHEET NO. 1
DRAWN BY: R.J.L. DATE: JANUARY, 1998 OF 16 SHEETS

TRIANGLE PACIFIC ADDITION
VOL 79129, PG. 0012

NORTHERN TRUST BANK OF TEXAS MOTOR BANK

THE ATRIUM
VOL 82006, PG. 0361

01/27/98 R.L. 96103-01.DWG

EXCEL ADDISON JOINT VENTURE
VOL 80148, PG. 212

THE ATRIUM
VOL 82006, PG. 0361

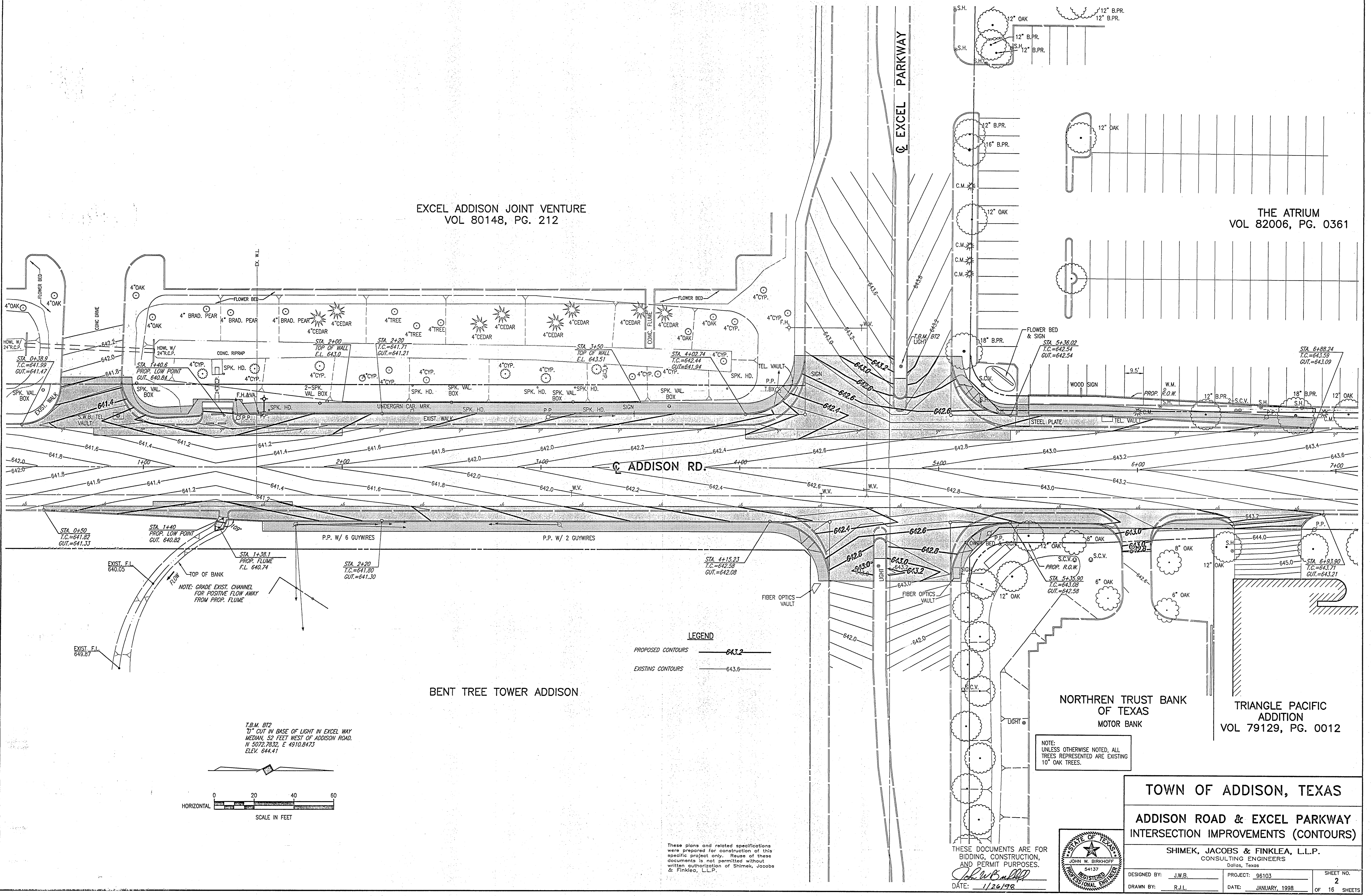

LEGEND

- PROPOSED CONTOURS ——— 643.2
- EXISTING CONTOURS ——— 643.6

BENT TREE TOWER ADDISON

NORTHREN TRUST BANK
OF TEXAS
MOTOR BANK

TRIANGLE PACIFIC
ADDITION
VOL 79129, PG. 0012

T.B.M. B72
"I" CUT IN BASE OF LIGHT IN EXCEL WAY
MEDIAN, 52 FEET WEST OF ADDISON ROAD.
N 5072.7832, E 4910.8473
ELEV. 644.41

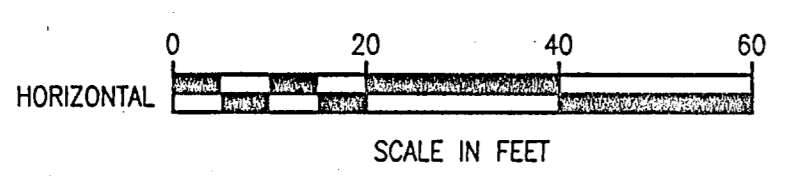

These plans and related specifications were prepared for construction of this specific project only. Reuse of these documents is not permitted without written authorization of Shimek, Jacobs & Finklea, L.L.P.

THESE DOCUMENTS ARE FOR
BIDDING, CONSTRUCTION,
AND PERMIT PURPOSES.
John W. Bullard
DATE: 1/26/98

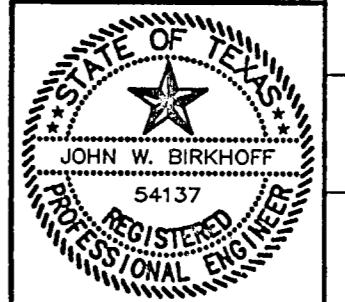

TOWN OF ADDISON, TEXAS
ADDISON ROAD & EXCEL PARKWAY
INTERSECTION IMPROVEMENTS (CONTOURS)

SHIMEK, JACOBS & FINKLEA, L.L.P. CONSULTING ENGINEERS Dallas, Texas		
DESIGNED BY: J.W.B.	PROJECT: 96103	SHEET NO. 2
DRAWN BY: R.J.L.	DATE: JANUARY, 1998	OF 16 SHEETS

07/19/97 R.L. 96103-02.DWG

EXCEL ADDISON JOINT VENTURE
VOL 80148, PG. 212

THE ATRIUM
VOL 82006, PG. 0361

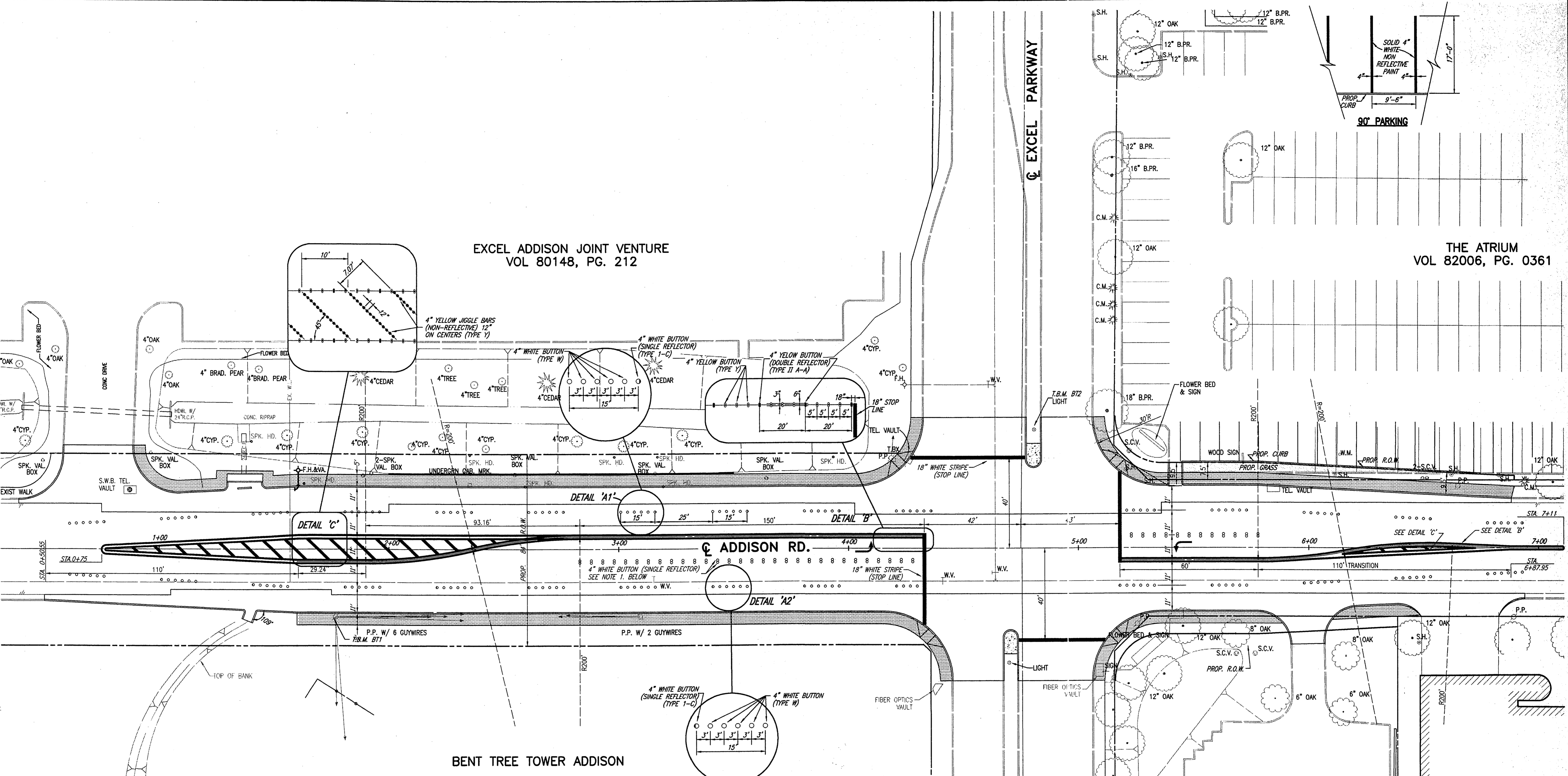

BENT TREE TOWER ADDISON

TRAFFIC MARKINGS, BUTTONS & JIGGLE BARS QUANTITIES

18" WIDE SOLID WHITE THERMOPLASTIC STRIPE	4" WIDE SOLID WHITE NON-REFLECTIVE PARKING PAINT	4" WHITE SINGLE REFLECT. BUTTON (TY. 1-C) LT. TURN	4" WHITE SINGLE REFLECT. BUTTON (TY 1-C) MAIN LANES	4" WHITE BUTTON TYPE W	4" YELLOW BUTTON TYPE Y	4" YELLOW DOUBLE REFLECT. BUTTON	4" JIGGLE BAR YELLOW TYPE Y	8 FT. LONG WHITE THERMOPLASTIC TURN ARROW
168 L.F.	550	84 EA.	30 EA.	148 EA.	270 EA.	92 EA.	166 EA.	2 EA.

- NOTES:
- LEFT TURN LANE CHANNELIZING BUTTONS SHALL CONSIST OF A DOUBLE ROW OF 4 INCH WHITE REFLECTIVE BUTTONS ON 5 FOOT CENTERS. (TYPE 1-C)
 - TRAFFIC BUTTONS & JIGGLE BARS SHALL BE FROM A SINGLE MANUFACTURER.
 - TRAFFIC BUTTONS & JIGGLE BARS SHALL SIT ON EPOXY "CUSHION". BUTTONS SHALL NOT BE IN DIRECT CONTACT WITH THE PAVEMENT.
 - EPOXY SHALL BE IN ACCORDANCE WITH TxDOT ITEM 575 TYPE I & I-M.
 - CARE SHOULD BE USED WHEN REMOVING EXISTING BUTTONS TO MINIMIZE DAMAGE TO ASPHALT PAVEMENT. DAMAGE TO ASPHALT PAVEMENT SHALL BE REPAIRED BY CONTRACTOR AT HIS EXPENSE.
 - CONTRACTOR SHALL FURNISH AND INSTALL TRAFFIC BUTTONS AND JIGGLE BARS THAT ARE THE SAME AS THE EXISTING ONES ON ADDISON ROAD. THE PROPOSED LAYOUT PATTERN SHALL MATCH THE EXISTING LAYOUT PATTERN ON ADDISON ROAD.

These plans and related specifications were prepared for construction of this specific project only. Reuse of these documents is not permitted without written authorization of Shimek, Jacobs & Finklea, L.L.P.

THESE DOCUMENTS ARE FOR BIDDING, CONSTRUCTION, AND PERMIT PURPOSES.
DATE: 1/26/98

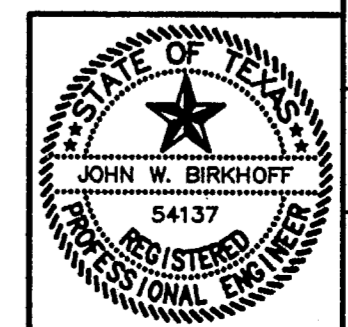

TOWN OF ADDISON, TEXAS

ADDISON ROAD & EXCEL PARKWAY INTERSECTION IMPROVEMENTS (MARKINGS)

SHIMEK, JACOBS & FINKLEA, L.L.P.
CONSULTING ENGINEERS
Dallas, Texas

DESIGNED BY: J.W.B. PROJECT: 96103 SHEET NO. 3
DRAWN BY: R.J.L. DATE: JANUARY, 1998 OF 16 SHEETS

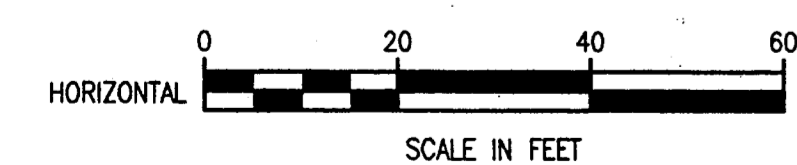

01/27/98 RIL 96103-03.DWG

