

**SIGNAL INSTALLATION NOTES:**

1. PAVEMENT CONFIGURATION SHOWN FOR W.B. KELLER SPRINGS IS BEING CONSTRUCTED UNDER A SEPARATE PAVING CONTRACT.
2. EXISTING CONDUIT RUN #1 TO BE REUSED FOR PULLING NEW CABLE.
3. EXISTING POLES T3(E) AND T5(E) AND THE EXISTING CONTROLLER TO BE REMOVED.
4. EXISTING POLE T2(E) TO BE REPLACED BY NEW POLE T2.
5. EXISTING STREET NAME SIGNS TO BE RELOCATED TO NEW SIGNAL POLES.

**PAVEMENT MARKING NOTES:**

1. ALL NEW STOP LINES SHALL BE 24". STOP LINE ON W.B. KELLER SPRINGS WILL BE AN 11' LF EXTENSION OF THE EXISTING STOP LINE.
2. WHEN REMOVING EXISTING STOP LINES, ALL BUTTONS WHICH EXTEND BEYOND THE NEW STOP LINE SHALL BE REMOVED.
3. EXISTING CHANNELIZED ISLAND BUTTONS ON SOUTHEAST CORNER TO BE REMOVED.

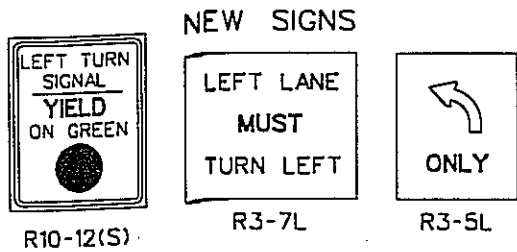

**LEGEND**

FIRE HYDRANT	⊕	EXISTING QUADRAPOLE LOOP DETECTOR	⊞
POWER POLE	○	TRAFFIC SIGNAL ON ARM W/POLE	⊞
TELEPHONE LINE U.G.	—T—	COMB. ST. LIGHT/SIGNAL POLE	⊞
STORM LINE	—S—	SIGNAL HEAD IDENTIFIER	①
SANITARY SEWER LINE	—SAN—	SIGNAL CONDUIT	—
GAS LINE	—G—	CONDUIT IDENTIFIER	ⓐ
WATER LINE	—W—	INSTALL PULL BOX TYPE A	□
MANHOLE	○	INSTALL PULL BOX TYPE C	■
LIGHT STANDARD WITH PHOTOCELL	⊙	PEDESTRIAN SIGNAL WITH BUTTONS, AND R10-4b SIGNS	⊞
EXISTING RIGHT-OF-WAY	---	PEDESTAL POLE W/SIGNALS WITH BUTTONS, AND R10-4b SIGNS	⊞
EXISTING SIGNAL POLE IDENTIFIER	T3(E)	INSTALL CONTROLLER FOUNDATION/CABINET	⊞
EXISTING PULL BOX	□	INSTALL SIGN PLATE	⊞
		PROPOSED SIGNAL POLE IDENTIFIER	T3
		OPTICOM DETECTOR	⊞
		SIGN PLATE AND POLE TO BE INSTALLED	⊞

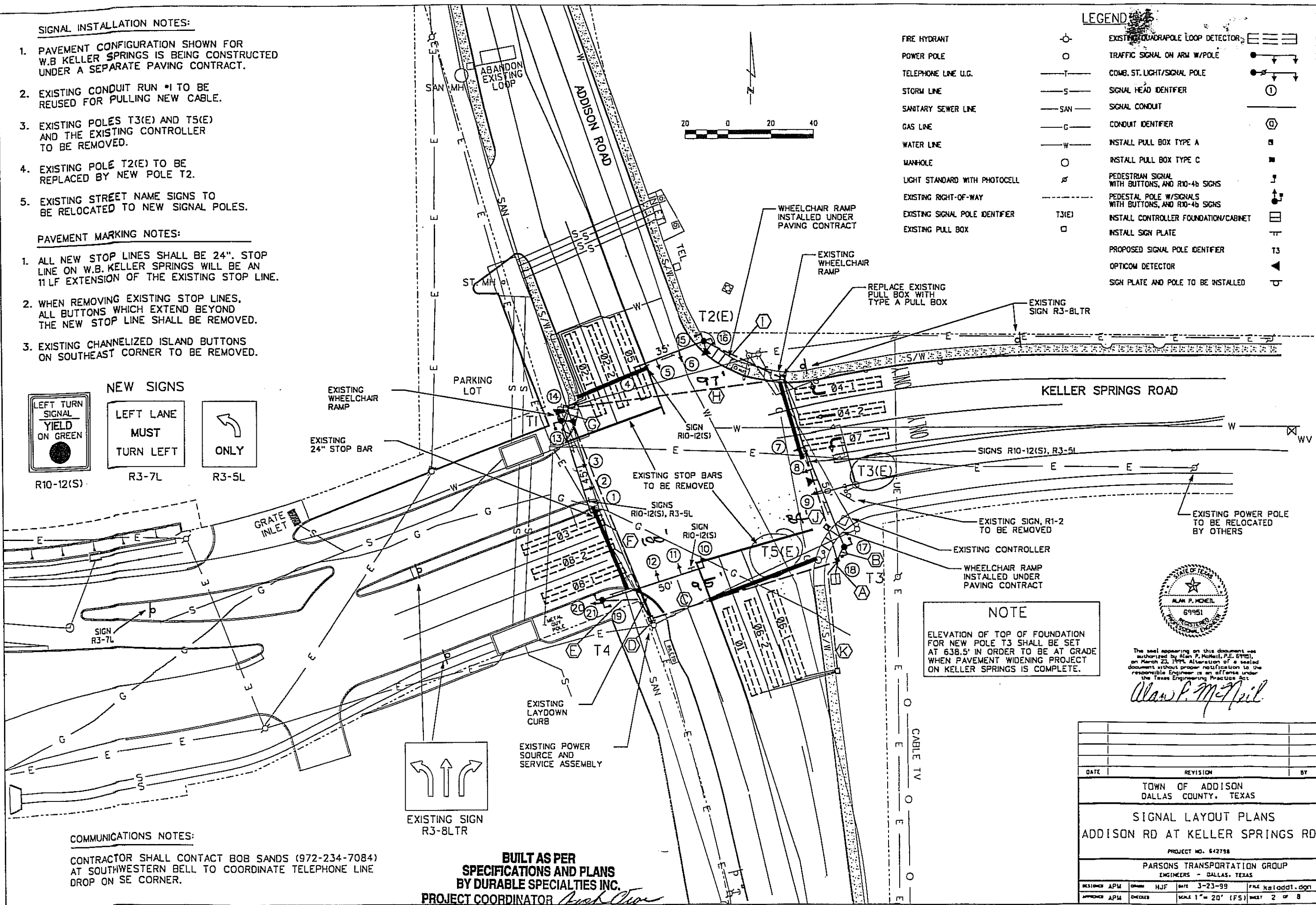

**NOTE**  
 ELEVATION OF TOP OF FOUNDATION FOR NEW POLE T3 SHALL BE SET AT 638.5' IN ORDER TO BE AT GRADE WHEN PAVEMENT WIDENING PROJECT ON KELLER SPRINGS IS COMPLETE.



The seal appearing on this document was authorized by Alan P. McNeil, P.E. (69951) on March 23, 1994. Alteration of a sealed document without proper notification to the responsible Engineer is an offense under the Texas Engineering Practice Act.

*Alan P. McNeil*

**COMMUNICATIONS NOTES:**

CONTRACTOR SHALL CONTACT BOB SANDS (972-234-7084) AT SOUTHWESTERN BELL TO COORDINATE TELEPHONE LINE DROP ON SE CORNER.

**BUILT AS PER SPECIFICATIONS AND PLANS BY DURABLE SPECIALTIES INC.**  
 PROJECT COORDINATOR *[Signature]*

DATE	REVISION	BY
TOWN OF ADDISON DALLAS COUNTY, TEXAS		
SIGNAL LAYOUT PLANS ADDISON RD AT KELLER SPRINGS RD		
PROJECT NO. 642798		
PARSONS TRANSPORTATION GROUP ENGINEERS - DALLAS, TEXAS		
DESIGNED APM	DRAWN HJF	DATE 3-23-99
APPROVED APM	CHECKED	SCALE 1" = 20' (FS)
		FILE kb1add1.dgn
		SHEET 2 OF 8