

LEGEND:

- EXISTING TRACKAGE
- SHIFTED TRACKAGE
- NEW TRACKAGE
- INSULATED JOINT (APPROXIMATE LOCATIONS ONLY)
- EXISTING POINT OF SWITCH
- POINT OF SWITCH FOR RELOCATED TURNOUT

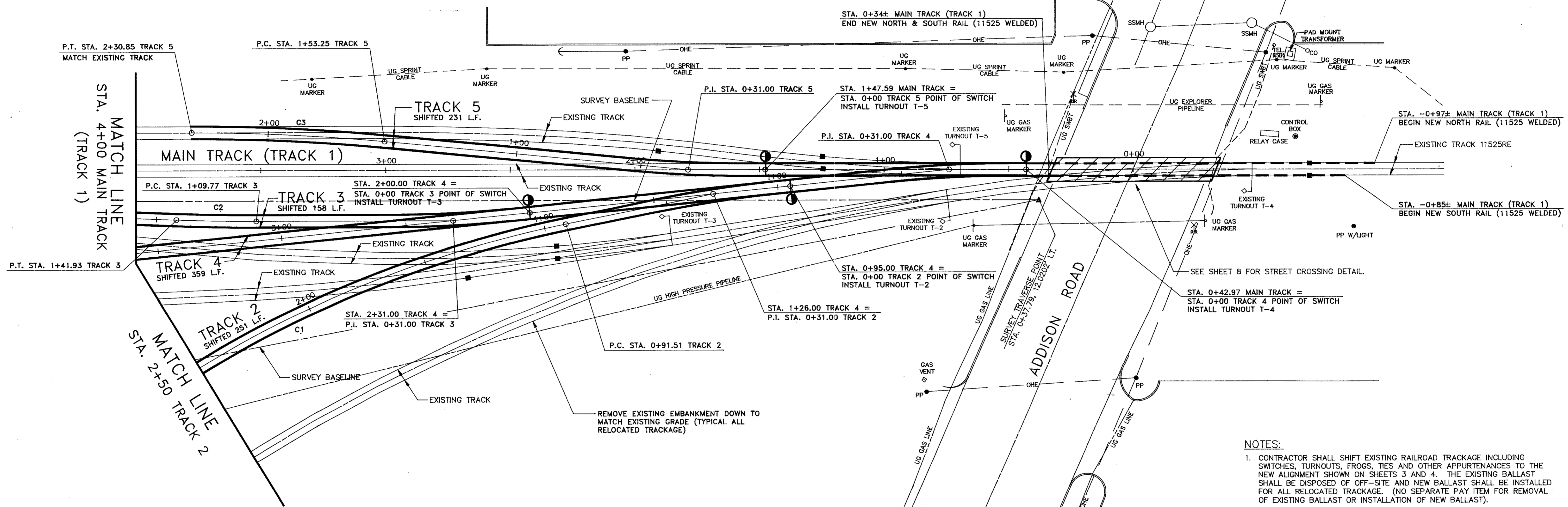

BENCHMARK LIST (TOWN OF ADDISON)

FOUND "□" CUT ON SOUTHEAST CORNER OF CONCRETE WALK AT FRONT ENTRANCE TO 4805 ARAPAHO ROAD. ELEV. 630.66

FOUND "□" CUT 6± EAST AND 8± SOUTH OF GARAGE ENTRANCE FACING SOUTH AT PROFESSIONAL AUTOBODY & GLASS 15293 ADDISON ROAD. ELEV. 629.85

CURVE DATA

CURVE	RADIUS	ARC LENGTH	TANGENT	DELTA	DEGREE OF CURVE
C1	460.05'	402.25'	215.00'	50°05'49"	12°28'44"
C2	819.02'	32.16'	16.08'	02°15'00"	07°00'00"
C3	819.02'	77.60'	38.83'	05°25'44"	07°00'00"

!! WARNING !!

EXISTING UTILITIES IN OR NEAR CONSTRUCTION WORK AREA ARE SHOWN IN THEIR APPROXIMATE LOCATIONS. CONTRACTOR SHALL CONTACT THE FOLLOWING COMPANIES TO DETERMINE ACTUAL FIELD LOCATIONS PRIOR TO CONSTRUCTION.

TOWN OF ADDISON (WATER,SEWER)	450-2840
LONE STAR GAS	263-DIGG
SP TELECOM	1-800-283-4237
US SPRINT	1-800-521-0579
EXPLORER PIPELINE CO.	1-918-493-5100
CONOCO PIPELINE CO.	1-800-833-6012
SOUTHWESTERN BELL	234-7084
T.U. ELECTRIC	323-8907
STORER CABLE	647-5711

NOTE: PETROLEUM PIPELINE. DIGGING PERMIT REQUIRED. CONTACT:
ADDISON FIRE DEPARTMENT 450-7157

- NOTES:**
- CONTRACTOR SHALL SHIFT EXISTING RAILROAD TRACKAGE INCLUDING SWITCHES, TURNOUTS, FROGS, TIES AND OTHER APPURTENANCES TO THE NEW ALIGNMENT SHOWN ON SHEETS 3 AND 4. THE EXISTING BALLAST SHALL BE DISPOSED OF OFF-SITE AND NEW BALLAST SHALL BE INSTALLED FOR ALL RELOCATED TRACKAGE. (NO SEPARATE PAY ITEM FOR REMOVAL OF EXISTING BALLAST OR INSTALLATION OF NEW BALLAST).
 - RELOCATE COMPLETE TURNOUTS T-2, T-3, T-4 AND T-5 AS SHOWN ON THE PLANS.
 - CONTRACTOR SHALL REPLACE ALL SUBSTANDARD TIES, BALLAST AND OTHER TRACK APPURTENANCES AS REQUIRED BY THE SOUTHERN PACIFIC TRANSPORTATION COMPANY (NO SEPARATE PAY ITEM).
 - NEW TRACK AT ADDISON ROAD CROSSING SHALL BE 11525 WELDED RAIL INCLUDING NEW TIES, PLATES, BALLAST, UNDERDRAINS AND OTHER APPURTENANCES.
 - CONTRACTOR SHALL FIELD VERIFY ALL NEW TRACK AND EXISTING TRACK RELOCATION DIMENSIONS PRIOR TO STARTING CONSTRUCTION. THE ENGINEER SHALL BE CONTACTED IMMEDIATELY IF ANY DISCREPANCY IS FOUND.
 - CONTRACTOR SHALL DISPOSE OF ALL UNUSED RAILROAD TRACKAGE AND APPURTENANCES OFF-SITE (NO SEPARATE PAY ITEM).
 - ALL RAILROAD CONSTRUCTION SHALL BE PERFORMED IN ACCORDANCE WITH SOUTHERN PACIFIC TRANSPORTATION COMPANY STANDARDS. REFER TO TECHNICAL SPECIFICATIONS FOR DETAILS. ALL TRACKAGE WORK INCLUDING TURNOUTS AND APPURTENANCES IS SUBJECT TO APPROVAL BY THE RAILROAD.
 - ALL FILL AREAS SHALL BE COMPACTED IN MAXIMUM 8" LIFTS TO 95% STANDARD PROCTOR DENSITY AS DEFINED BY THE STANDARD COMPACTION TEST (ASTM D-698) AT A MOISTURE CONTENT WITHIN ±3% O.T.M.

NO.	REVISION	BY	DATE

DESIGNED BY: J. WALDBAUER
 DRAWN BY: EH&A
 CHECKED BY: B. GRANTHAM
 SCALE: 1" = 20'
 DATE: JULY 1992
 FILE: \ADRR\TRPLAN1

ESPEY, HUSTON & ASSOCIATES, INC.
 Engineering & Environmental Consultants
 13800 Montfort Drive Suite 230 Dallas, Texas 75240
 (214) 387-0771

TRACK REALIGNMENT PLAN

RAILROAD CROSSING IMPROVEMENTS AND
 TRACK REALIGNMENT FOR ADDISON ROAD

for
 THE TOWN OF ADDISON

SHEET NO. **3**
 OF 15 SHEETS
 JOB NO. 14163