

DRIVE / PARKING LOT MODIFICATIONS

FOR

ADDISON TOWN CENTER

3740 BELTLINE ROAD
 ADDISON, DALLAS COUNTY, TEXAS

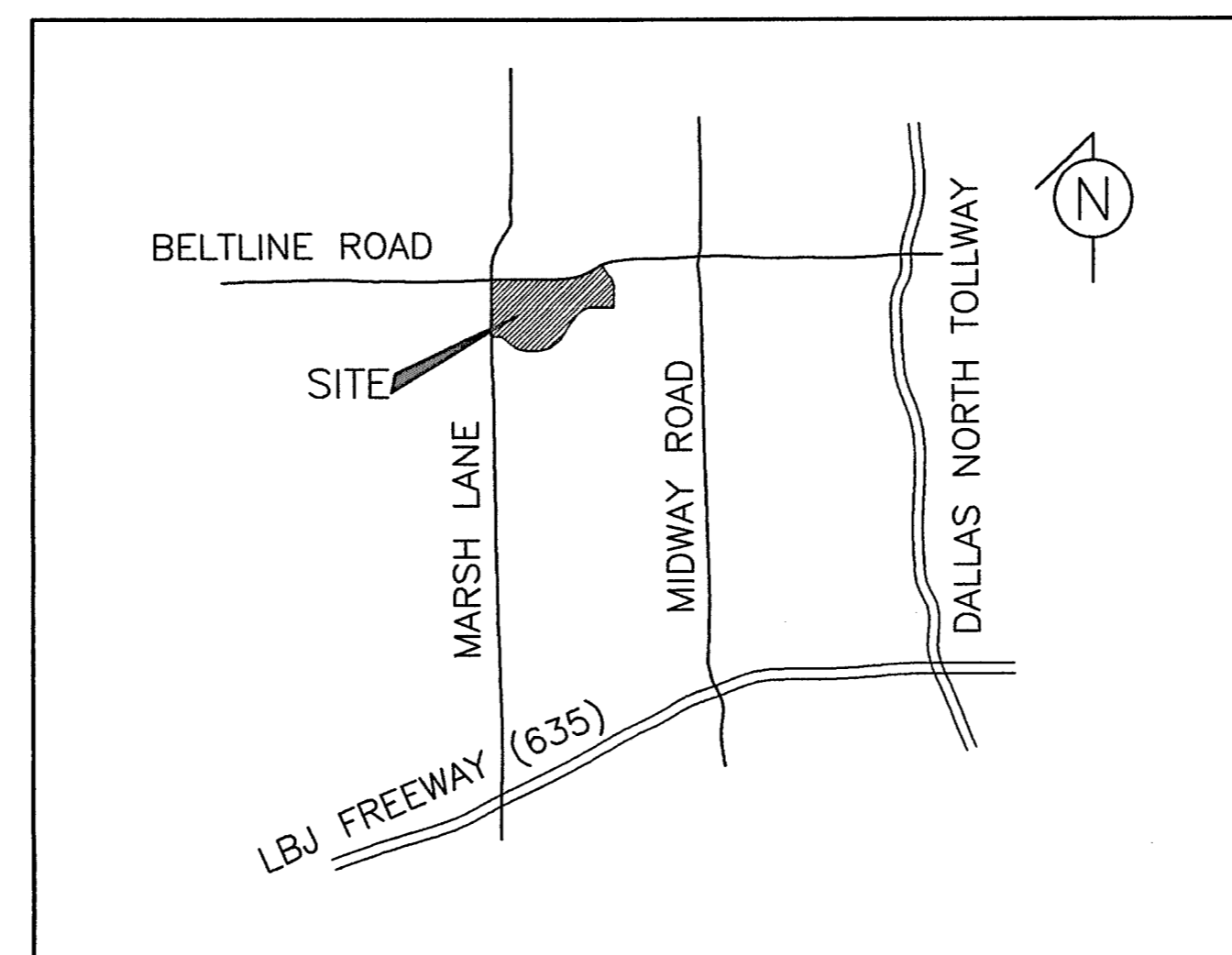

VICINITY MAP
 NO SCALE

SHEET INDEX

Sheet No.	Description
C-1	COVER SHEET
C-2	DEMOLITION / GRADING PLAN
C-3	PAVING DETAILS
C-4	EROSION CONTROL PLAN

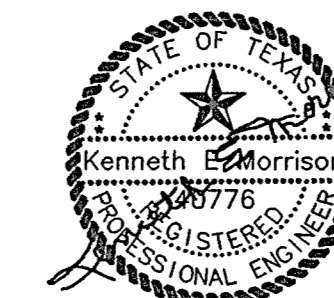

The seal appearing on this document was authorized by Kenneth E. Morrison, P.E. on August 27, 2010. FIRM NO. F-8950

DEVELOPER

ADDISON TOWN CENTER RETAIL, L.P.
 C/O CENCOR REALTY SERVICES, INC.
 3102 MAPLE AVENUE, SUITE 500
 DALLAS, TEXAS 75202
 (214) 954-0300

ARCHITECT

JORDAN ARCHITECTS, LLC
 402 W. WHEATLAND RD., SUITE 102
 DUNCANVILLE, TEXAS 75116
 (972) 572-6777

ENGINEER:

MORRISON & ASSOCIATES
 FIRM NO. ~ F-8950
 8911 LAKEWOOD DRIVE
 IRVING, TEXAS 75063
 (972)831-0044

SURVEYOR:

M.L. MITCHELL, RPLS
 2922 ESQUIRE LANE
 GARLAND, TEXAS 75044
 (972) 231-4551

All responsibility for the adequacy of these plans remains with the Engineer who prepared them. In approving these plans, the Town of Addison makes no representation of adequacy of the work of the Design Engineer.

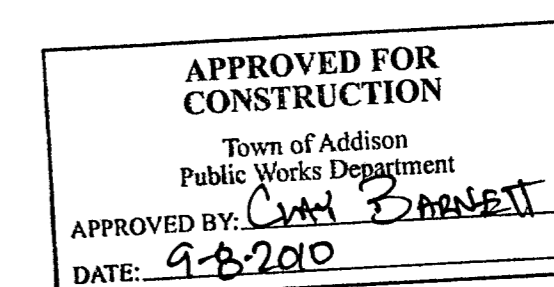

51022KYS