

GENERAL NOTES FOR STORM WATER BEST MANAGEMENT PRACTICES PLAN

- All operators and/or contractors shall conform to the terms and conditions of the Texas Pollution Discharge Elimination System (TPDES) General Permit Number TXR 150000 as well as the rules of the Texas Commission on Environmental Quality (TCEQ), the laws of the State of Texas and other orders of the TCEQ, if applicable.
- The Notice of Intent (NOI), as required by the General Permit or City, must be properly displayed on site at all times by each operator. The filing requirements vary by project size. Additional information and forms are available on-line at <http://www.tnrc.state.tx.us/permitting/waterperm/wpermm/construct.html>
- All releases of reportable quantities of hazardous substances shall be reported immediately to the facility operator and EPA.
- Qualified operator personnel must inspect the site at least once every seven days and within 24 hours of a 1/2 - inch or greater rainfall event. The inspector shall document the results.
- Modifications to the Storm Water Best Management Practices Plan shall be implemented and be in-place within a seven calendar day period.
- If any contractor sees a violation by an operator or another contractor, he shall notify the operator and contractor in violation, as well as the facility operator.
- Erosion control shall be installed prior to any grading.
- Accumulated silt deposits shall be removed from silt fences and hay bale dikes when silt depth reaches six inches. Removal of silt deposits by the contractor shall be incidental to the performance of the contract and a separate bid item shall not be included.
- The contractor shall add or delete erosion protection at the request and direction of the Operator or the City.

- After installation of pavement, final grading, and general cleanup, the Contractor shall establish grass groundcover in all disturbed areas. Materials shall be as specified in Item 2.15 and seeding shall be in accordance with Item 3.10 of the NCTCOG Standard Specifications.
- It shall be the contractor's responsibility to control and limit silt and sediment leaving the site. Specifically, the contractor shall protect all public streets, alleys, streams and storm drainage systems from erosion deposits.
- It shall be the contractor's responsibility to provide a covered dumpster (or equal) to collect solid waste materials during construction.
- It is anticipated that some, but not necessarily all, of the following non-storm water discharges will be associated with this project. These discharges are authorized through the construction general permit:
 - Fire hydrant flushings
 - Water used to wash vehicles and to control dust
 - Potable water sources including waterline flushings
 - Irrigation drainage
 - Pavement washdown
 - Uncontaminated ground water
 - Construction water
- Construction waste disposal containers shall be provided on the site for disposal of all non-hazardous construction waste materials. The containers shall be hauled to landfill by the Contractor.
- All hazardous materials shall be handled and disposed of by the Contractor in accordance with Federal, State and Local regulations.

CONSTRUCTION NOTES:

- Silt fences shall be installed a minimum of 6" into the ground.
- Contractor will install additional erosion control where erosion protection is needed as per the owners engineers, or the City inspector.
- The existing vegetation along existing parkways and medians shall be replaced to its original condition or better.
- All drainage swales shall be grassed as per City Standards, prior to the City acceptance of project.
- All construction erosion control shall meet City Ordinance.
- Erosion construction shall be completed in the following PHASES:

PHASE 1 (Prior To Start Of Rough Grading)

- Silt fences shall be placed as shown on plan.

PHASE 2 (After utility construction & prior to paving const.)

- Silt Fences shall be placed around top of inlets, where applicable, to prevent erosion material from entering storm sewer system.

PHASE 3 (After paving construction)

- Silt fences shall be placed along pavement, where indicated.
- All disturbed areas to be seeded and/or vegetation otherwise established both on-site and off-site in adjacent R.O.W., easements, detention ponds, etc.

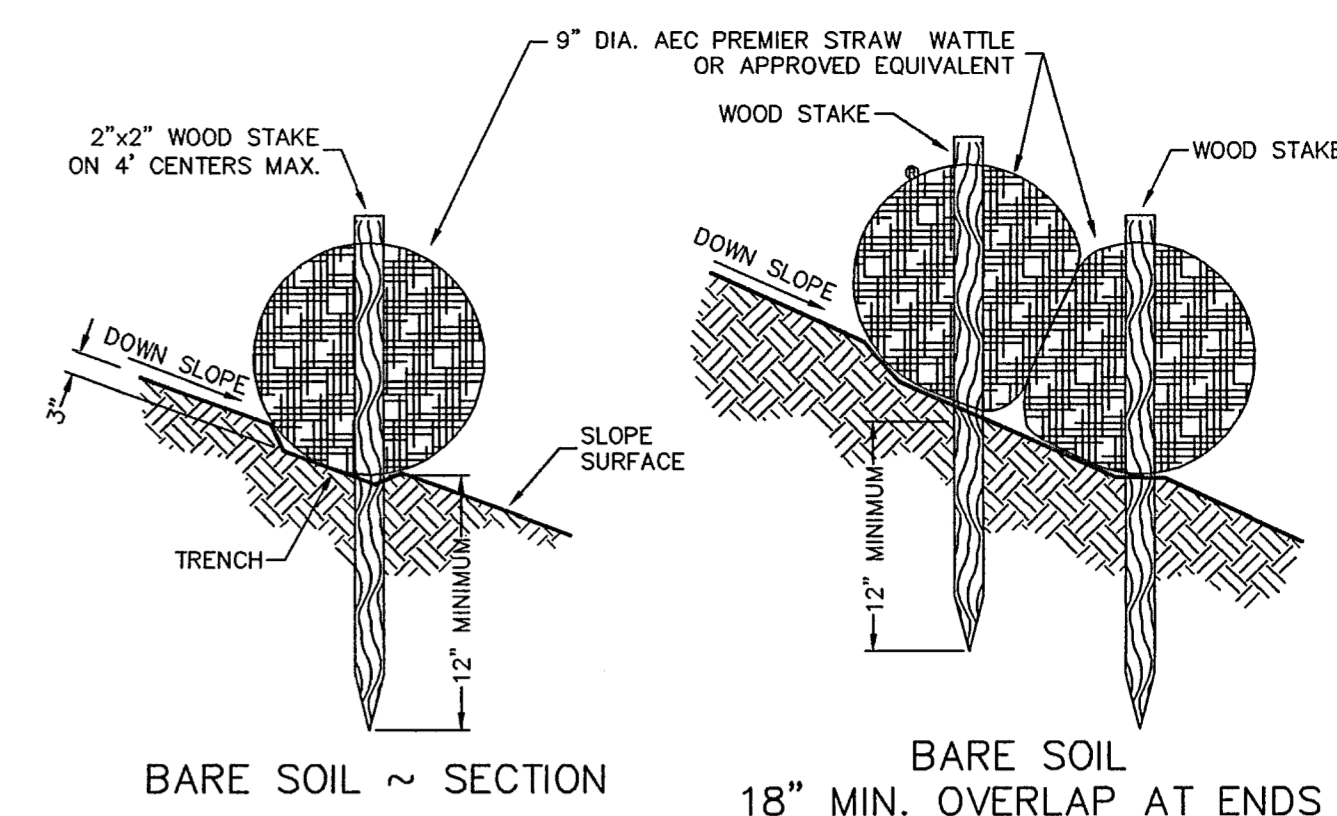

ORGANIC FILTER TUBE DETAIL

- Sand bags shall be placed along the downstream side of filter tube where filter tubes are used on pavement.
- Sand bags to be Polythylene, Polyamide or Cotton Burlap woven fabric, 24" to 30" in length and 16" to 18" wide, filled to a thickness weight of 40 pounds, filled with coarse grade sand.

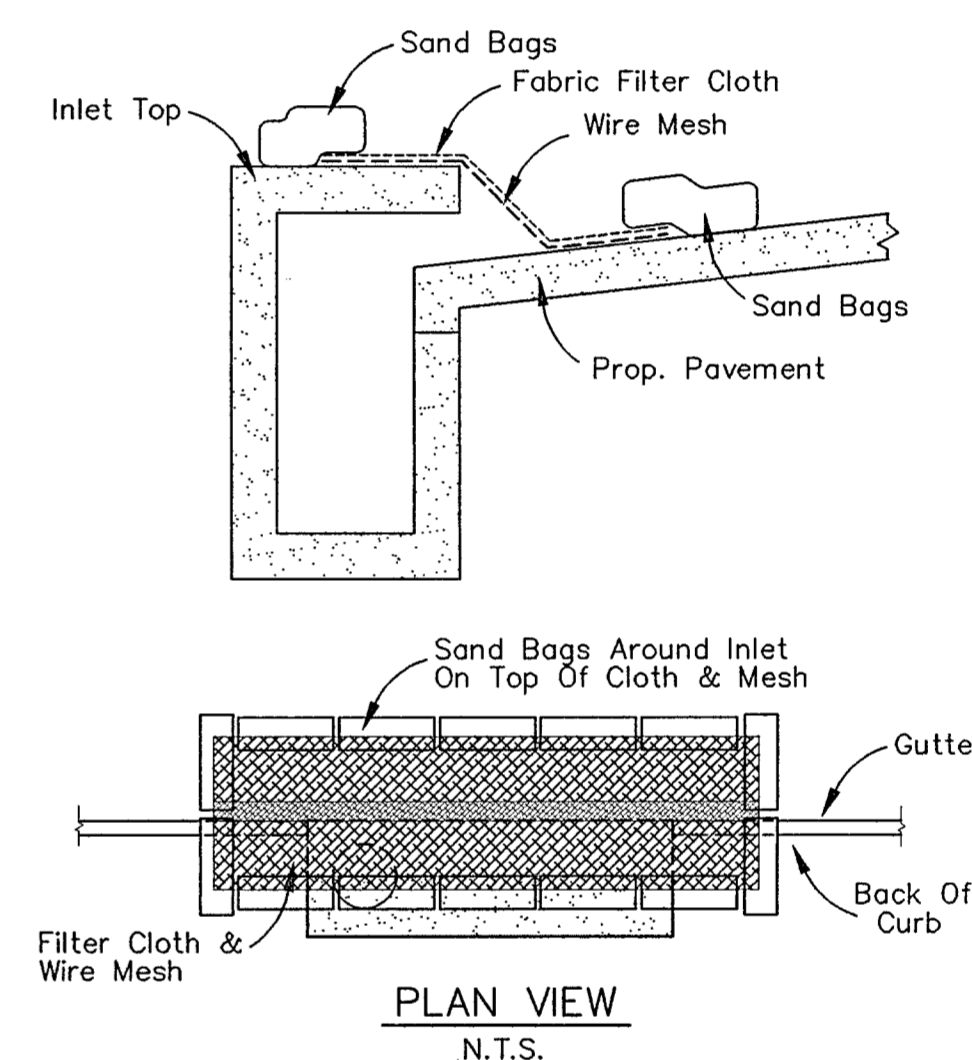

SEDIMENT BARRIER AT CURB INLET

- Wire Mesh, ASTM D4632 w/opening not to exceed 1/2".
- Filter Fabric as per ASTM D4833.
- Sand bags to be Polythylene, Polyamide or Cotton Burlap woven fabric, 24" to 30" in length and 16" to 18" wide, filled to a thickness weight of 40 pounds, filled with coarse grade sand.

LEGEND

- ORGANIC FILTER TUBE
- INLET PROTECTON

NOTE:
THESE DOCUMENTS AND/OR SPECIFICATIONS MAY BE USED FOR PURPOSES AS INDICATED BELOW:

<input type="checkbox"/> COORDINATION / PRELIMINARY	<input type="checkbox"/> PERMITTING
<input type="checkbox"/> BIDDING ONLY	<input checked="" type="checkbox"/> CONSTRUCTION

08/27/10
UNDER THE AUTHORITY OF KENNETH E. MORRISON
PROFESSIONAL ENGINEER

THESE DRAWINGS VALID FOR PERMITTING OR CONSTRUCTION ONLY WHEN DATED AND BEARING PROFESSIONAL'S SEAL, SIGNATURE, AND INDICATED IN THE APPROPRIATE BOXES ABOVE. ELECTRONIC FILES, IF PROVIDED, ARE NOT OFFICIAL DOCUMENTS AND ARE NOT WARRANTED AS TO ACCURACY OR COMPLETENESS.

OWNER:
ADDISON TOWN CENTER RETAIL, LP
C/O CENCOR REALTY SERVICES
3102 MAPLE, SUITE 500
DALLAS, TEXAS 75202

CONTACT:
MARSHALL MILLS
(972) 954-0600

TOTAL SITE AREA: 1.55 ACRES
ESTIMATED DISTURBED AREA: 0.2± ACRES

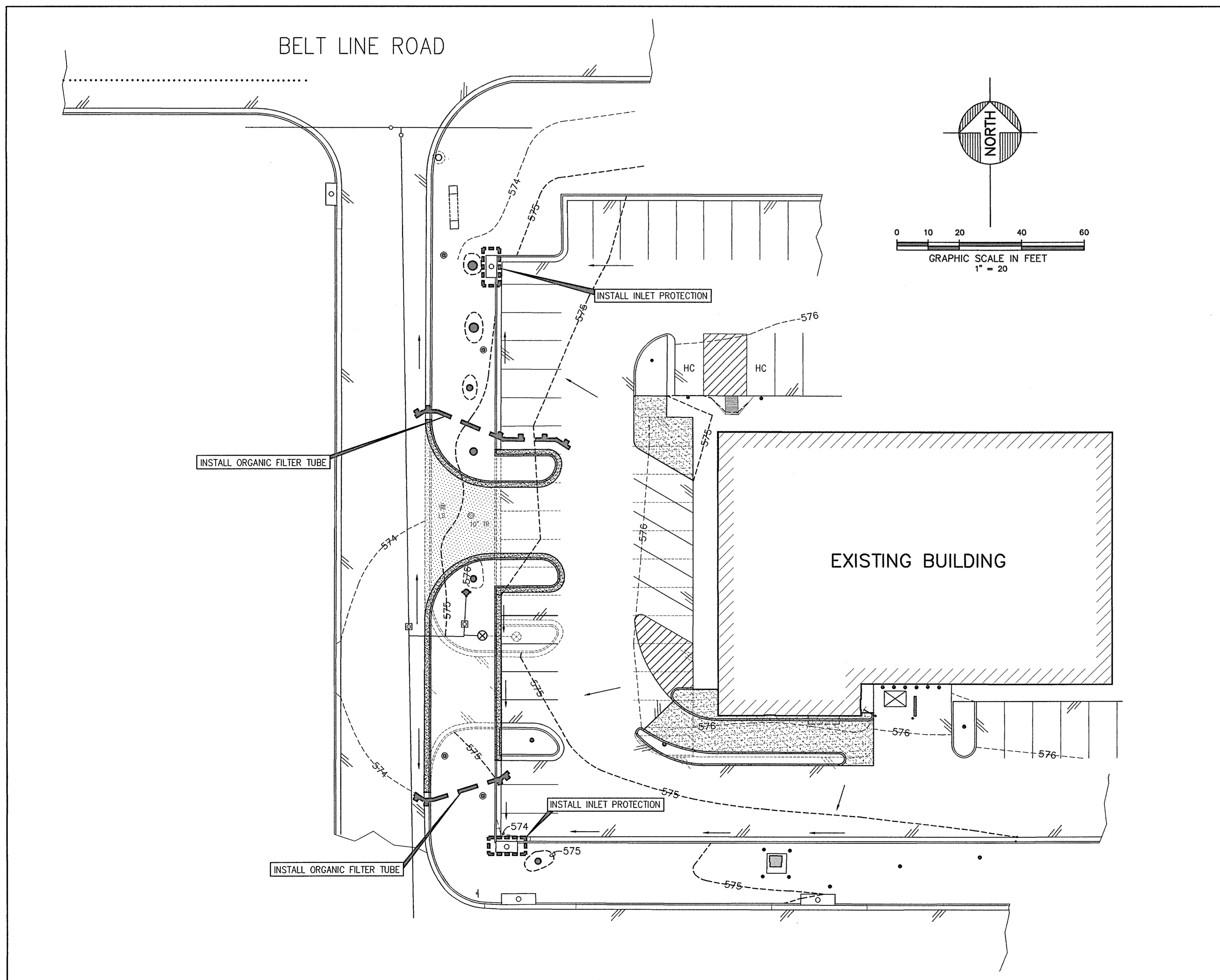

MORRISON AND ASSOCIATES
CONSULTING CIVIL ENGINEERS & SURVEYORS
8911 LAKEWOOD DRIVE
IRVING, TX 75063 (972) 831-0044

EROSION CONTROL

SCHLOTZSKY'S FRANCHISE, LLC
LOT 1, BLOCK D, ADDISON TOWN CENTER
3740 BELT LINE ROAD, ADDISON, TX 75001
JORDAN ARCHITECTS, L.L.C.
402 WEST WHEATLAND ROAD, SUITE 102
DUNCANVILLE, TEXAS 75116
VOICE 972.572.6777 FAX 972.572.6888

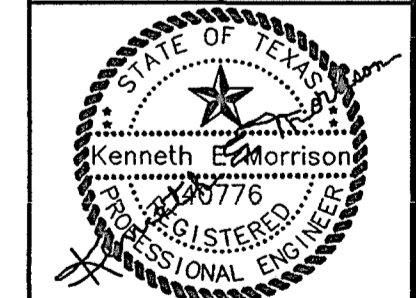

The seal appearing on this document was authorized by Kenneth E. Morrison, P.E. on August 27, 2010. FIRM NO. F-8950

Scale: 60 & AS NOTED
Date: 06/15/10
Designed By: KEM
Drawn By: KEM
CAD File:
Project No.:

SHEET C-4
OF 4