

BENCHMARK:
 N.W. CORNER OF EXISTING SOUTH SIDE OF BELT LINE 575' WEST OF THE INTERSECTION OF BELT LINE ROAD AND BUSINESS AVENUE
 ELEV. 573.00

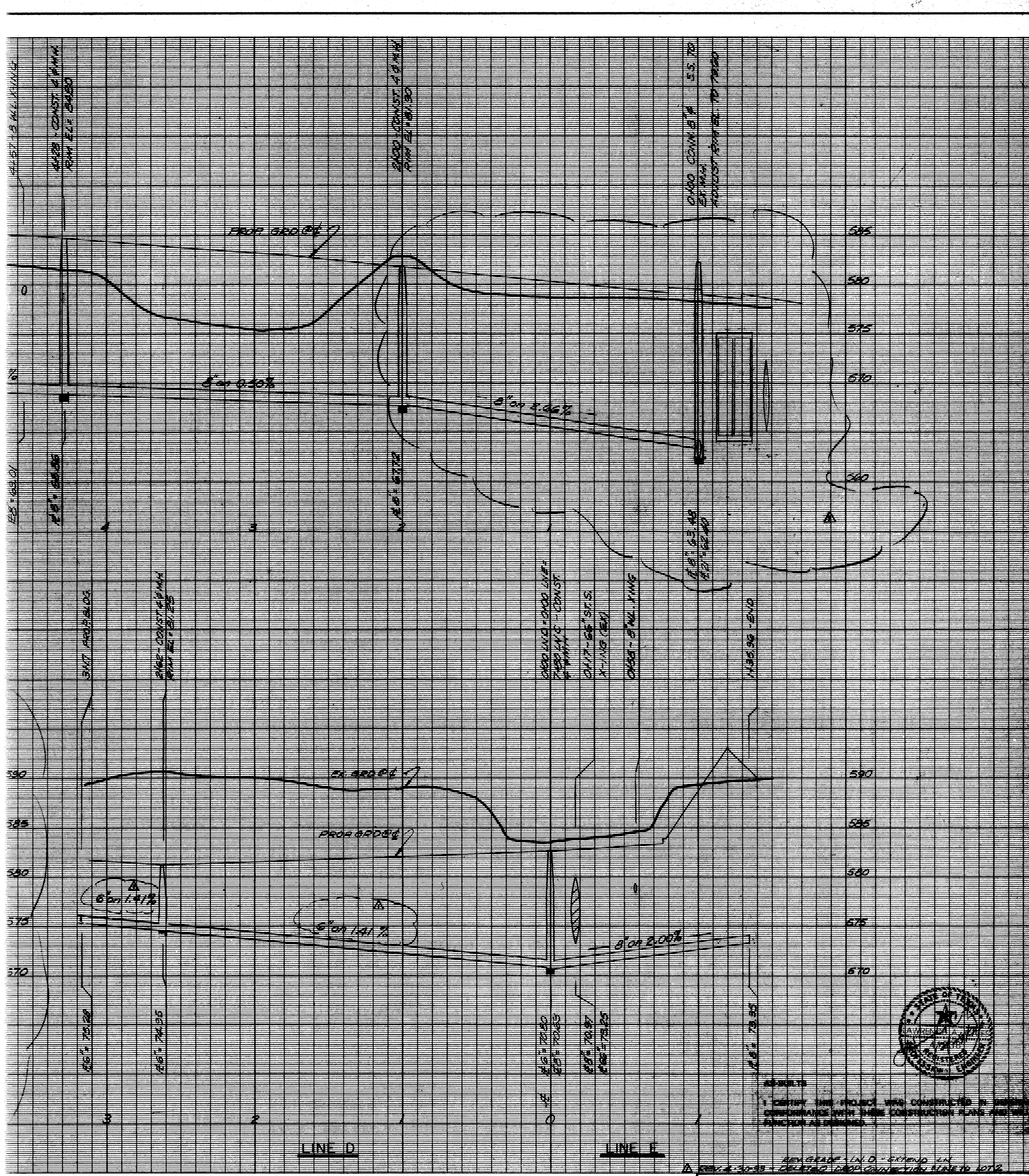

BENCHMARK:
 " " CUT ON STORM SEWER INLET ON SOUTH SIDE OF BELT LINE ROAD 70' WEST OF COMMERCIAL DRIVE.
 ELEV. 580.56'

LINES C, D & E						
SANITARY SEWER PROFILES						
ADDISON TOWN CENTER						
TOWN OF ADDISON, TEXAS						
LAWRENCE A. CATES & ASSOC. CONSULTING ENGINEERS DALLAS, TEXAS						
DESIGN	DRAWN	DATE	SCALE	NOTES	FILE	NO.
LAC	LAC	4/7/93	H: 1"=40' V: 1"=6'	D.P.	9102	C-10

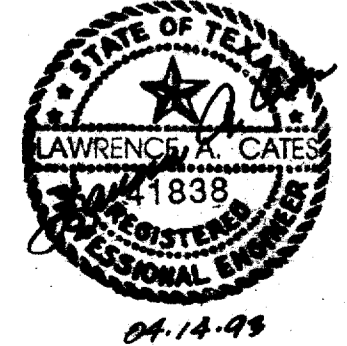

I CERTIFY THIS PROJECT WAS CONSTRUCTED IN STRICT COMPLIANCE WITH THESE CONSTRUCTION PLANS AND ALL FUNCTION AS SHOWN.