



CORDELL & ASSOCIATES, INC.
consulting engineers
Dallas, Texas

SEPT. 1970

70-3-9

Revised 11-9-70
2-26-71
3-1-71 Grade
4-19-71 As built

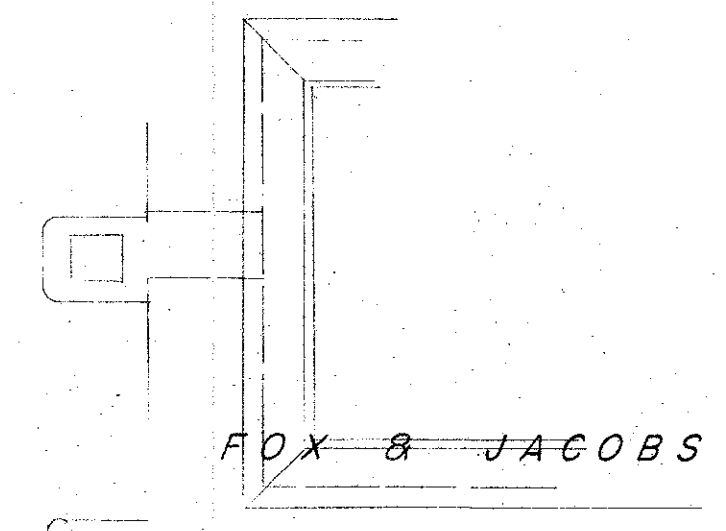
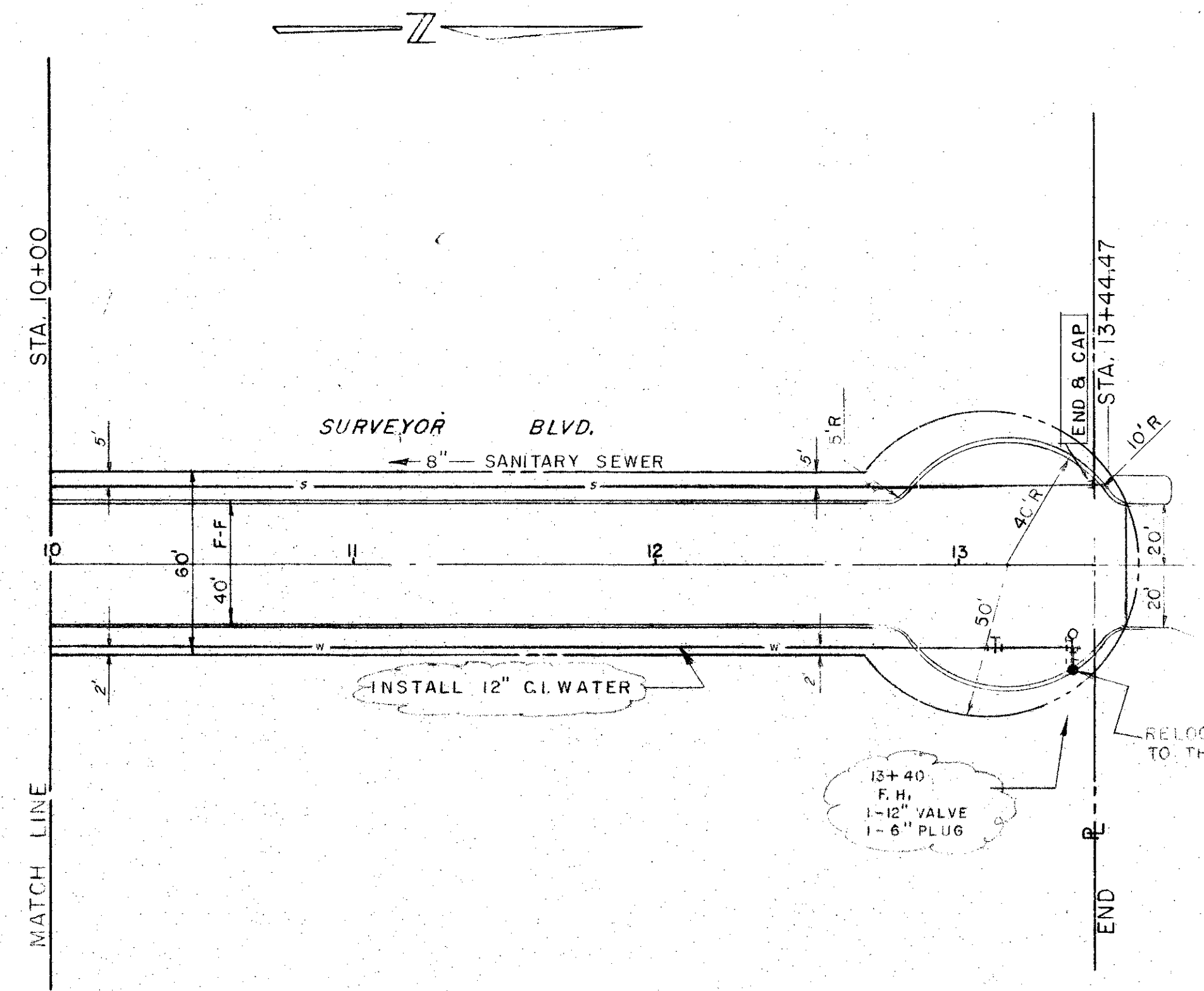
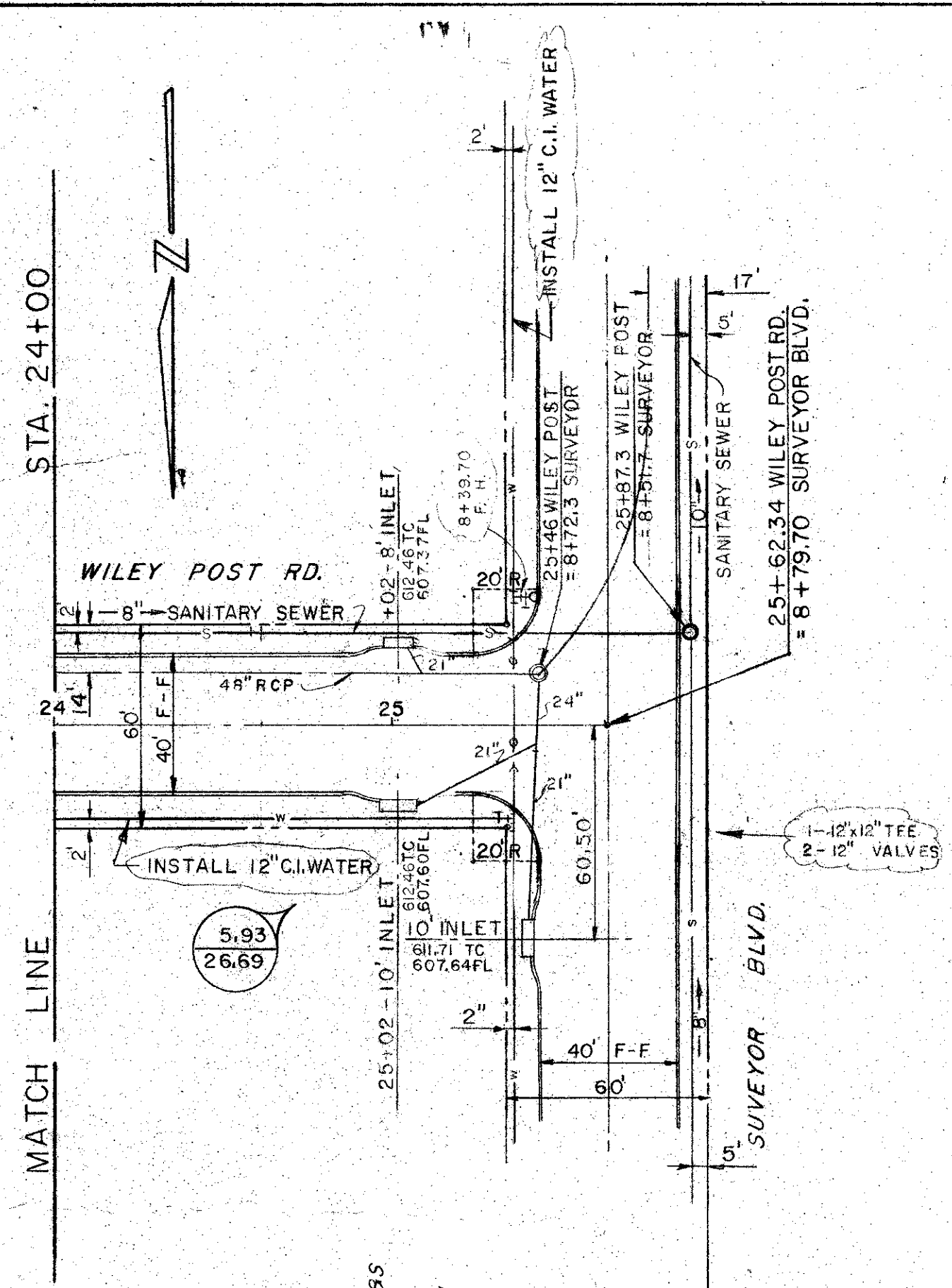

B.M. MULTI NAIL IN T.R. & L. TRANS. TWR. FOOTING, NE. COR., 3RD TWR. NO. OF RR. ELEV. 605.00

B.M. 60d NAIL SET IN 2ND POWER POLE NO. OF WILEY POST RD., WEST SIDE OF DOOLEY RD. ELEV. 633.30

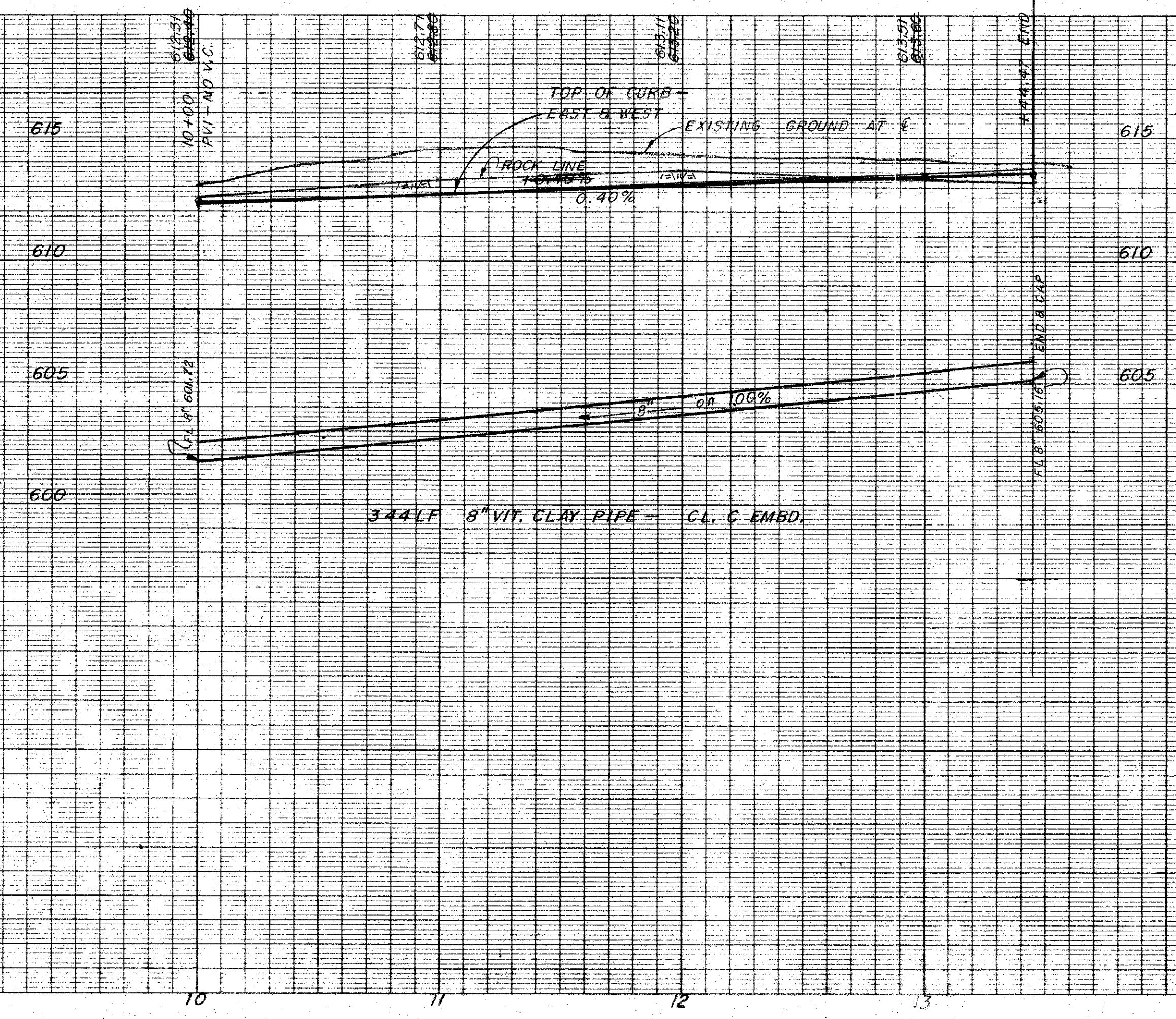
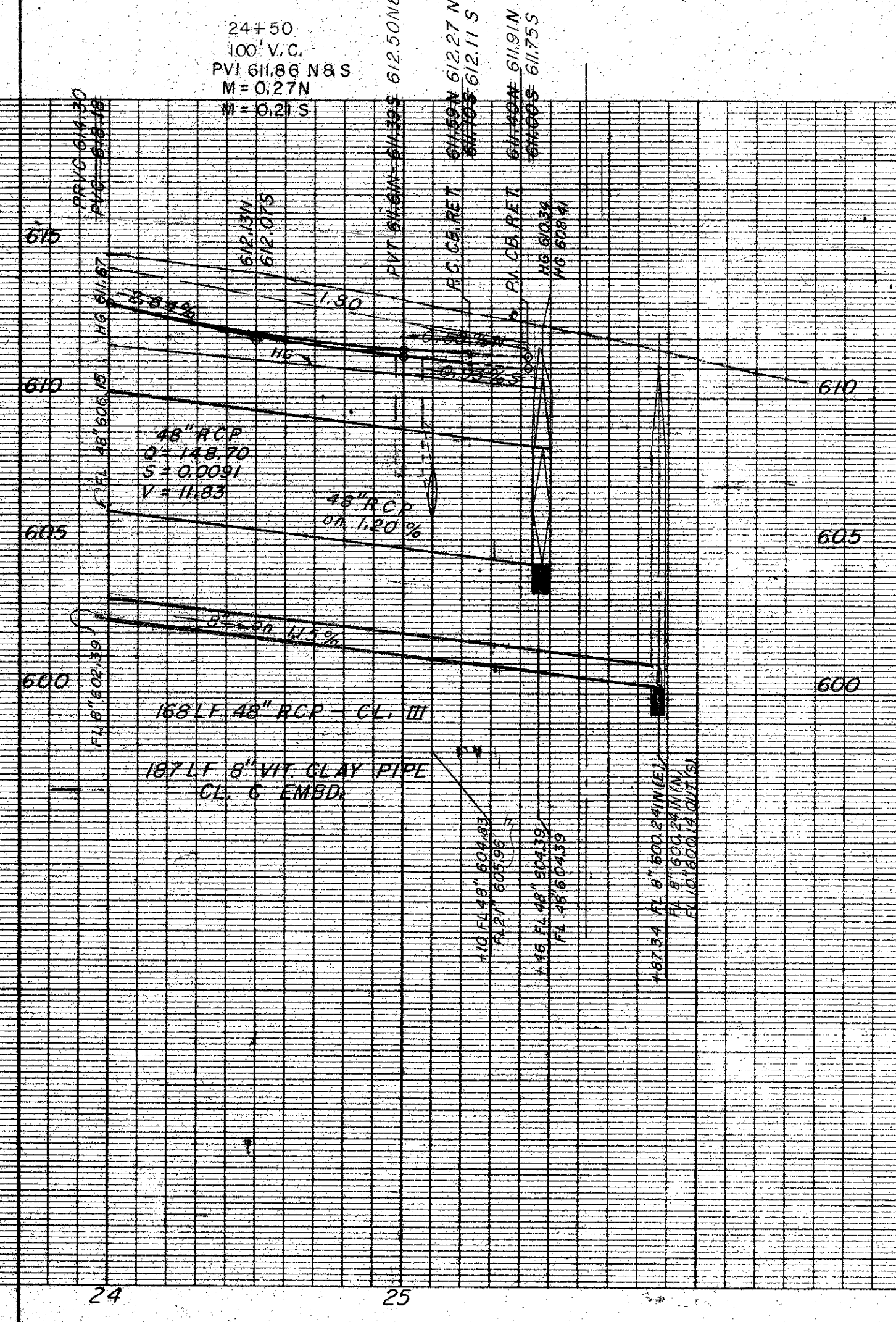

CORDELL & ASSOCIATES, INC.
consulting engineers
Dallas, Texas