

REVISIONS BY	
1	JK

**WOLVERTON & ASSOCIATES, INC.**  
5600 OAKBROOK PARKWAY / SUITE 00 / NORCROSS, GEORGIA 30093  
770 447-8888 PHONE / 770 447-9070 FAX

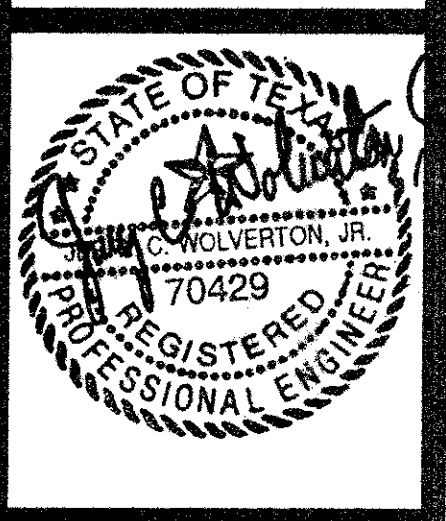

**PROPOSED MAIN POST OFFICE**  
ADDISON, TEXAS  
UNITED STATES POSTAL SERVICE

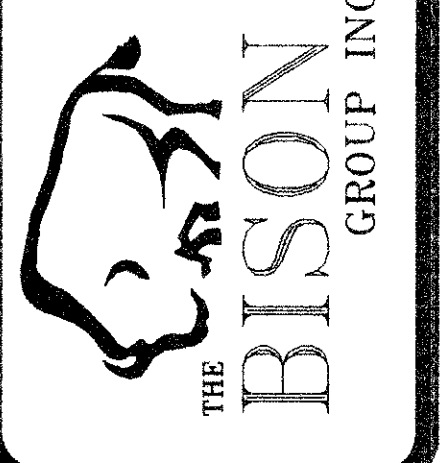

DRAWN	JK
CHECKED	JCW
DATE	01/18/97
SCALE	1" = 20'
JOB No.	96164
SHEET	C-1

OF SHEETS

## AIRPORT PARKWAY

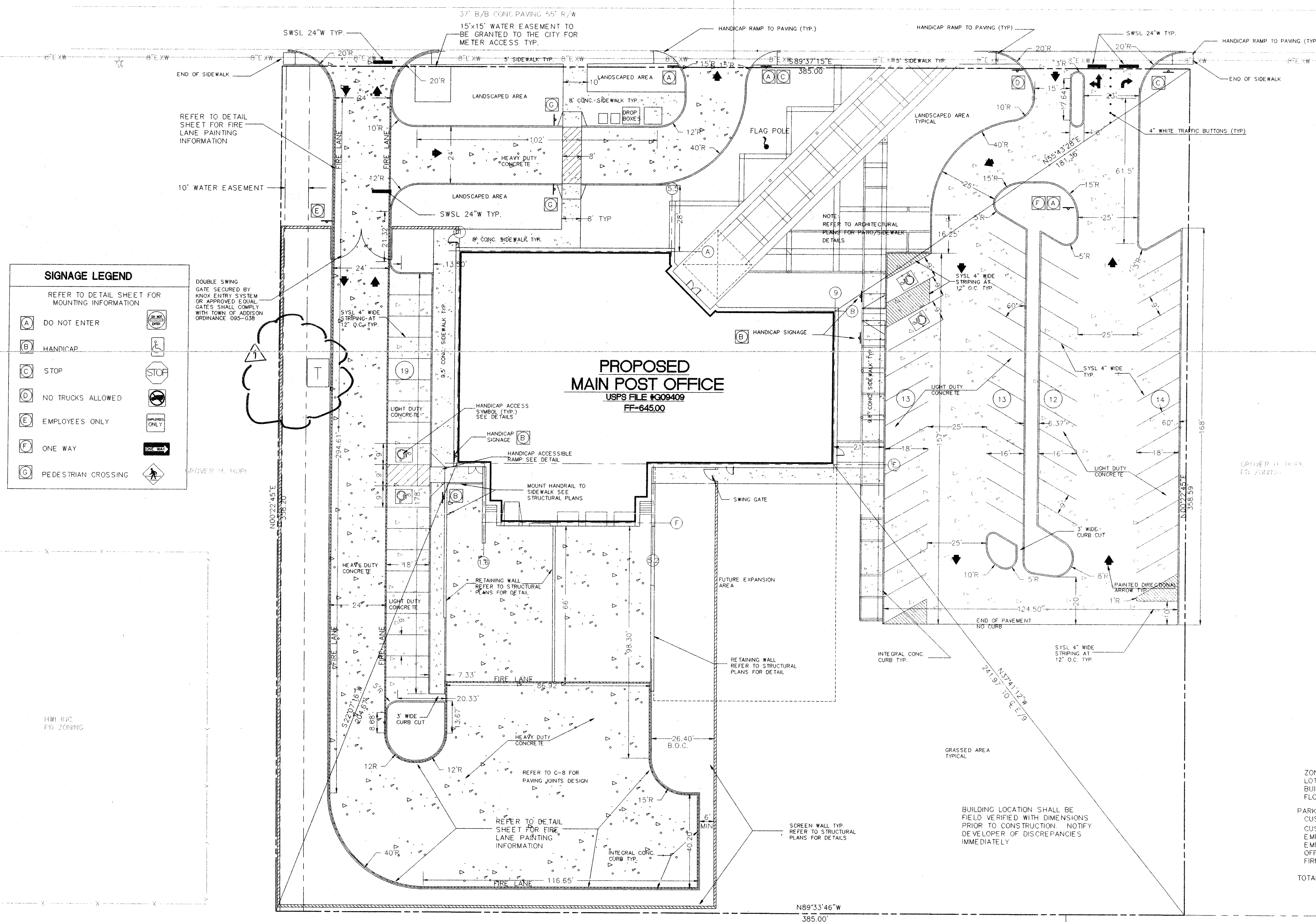

### SITE PLAN NOTES

- ALL WORK AND MATERIALS SHALL COMPLY WITH CITY OF ADDISON TEXAS REGULATIONS AND CODES AND O.S.H.A. STANDARDS.
- CONTRACTOR SHALL REFER TO THE ARCHITECTURAL PLANS FOR EXACT LOCATIONS AND DIMENSIONS OF VESTIBLES, SLURP PAVING, SIDEWALKS, EXIT PORCHES, TRUCK DOCKS, PRECISE BUILDING DIMENSIONS AND EXACT BUILDING UTILITY ENTRANCE LOCATIONS.
- THE SITE WORK FOR THIS PROJECT SHALL MEET OR EXCEED US POSTAL SERVICE STANDARD SITE WORK SPECIFICATIONS.
- ALL DISTURBED AREAS ARE TO RECEIVE FOUR INCHES OF TOPSOIL, SEED, MULCH AND WATER UNTIL A HEALTHY STAND OF GRASS IS OBTAINED.
- ALL CURBED OR STRIPED RADII ARE TO BE 5' UNLESS OTHERWISE NOTED.
- ALL DIMENSIONS AND RADII ARE TO THE FACE OF CURB UNLESS OTHERWISE NOTED.
- PYLON SIGNS SHALL BE CONSTRUCTED BY OTHERS. CONTRACTOR SHALL STUB CONDUIT AND WIRING TO PYLON SIGN LOCATIONS AS PART OF THIS CONTRACT.
- CONTRACTOR IS RESPONSIBLE FOR OBTAINING APPROVAL FROM THE POWER AND TELEPHONE COMPANIES FOR THE LOCATION AND HEIGHT OF THE PYLON SIGNS BEFORE CONDUIT AND WIRING IS INSTALLED.
- EXISTING STRUCTURES WITHIN CONSTRUCTION LIMITS ARE TO BE ABANDONED, REMOVED OR RELOCATED AS NECESSARY. ALL COST SHALL BE INCLUDED IN BASE BID.
- CONTRACTOR SHALL BE RESPONSIBLE FOR ALL RELOCATIONS. INCLUDES BUT NOT LIMITED TO: ALL UTILITIES, STORM DRAINAGE, SIGNS, TRAFFIC SIGNALS & POLES, ETC. AS REQUIRED FOR WIDENING OF ALL ROADWAYS. ALL WORK SHALL BE IN ACCORDANCE WITH GOVERNING AUTHORITIES SPECIFICATIONS AND SHALL BE APPROVED BY SUCH. ALL COST SHALL BE INCLUDED IN BASE BID.
- THE DIMENSIONS SHOWN ARE TO FACE OF BUILDING UNLESS OTHERWISE SHOWN.
- THE CONTRACTOR SHALL REFER TO THE ARCHITECTURAL PLANS FOR STAIR DETAILS AND BOLLARD PROTECTION OF THE STAIRS. REFER TO THESE DRAWINGS FOR THE BOLLARD DETAILS.
- REFER TO THE STRUCTURAL PLANS FOR THE COLUMN GRID LAYOUT AND INFORMATION REQUIRED TO LAYOUT THE BUILDING WITHIN THE FOUNDATIONS.
- THE SURVEY OF EXISTING CONDITIONS IS SHOWN WITHIN THESE PLANS. ALL EXISTING CONDITIONS SHALL BE VERIFIED TO BE TRUE AND ACCURATE PRIOR TO BEGINNING WORK.
- REFER TO THE LANDSCAPING PLANS FOR PLANTING LOCATIONS AND ISLAND DETAILS.
- PAINTED STRIPING SHALL BE BRIGHT AND CLEAR. STRIPES SHALL BE PER PLAN AND PAINTED ON CLEAN CONCRETE APPLIED IN TWO COATS.
- CURBING SHALL BE FORMED AND POURED CONCRETE UNLESS OTHERWISE DETAILED WITHIN THE DRAWINGS. CONCRETE FOR CURBING SHALL BE 3000 PSI.
- HANDICAP RAMPS AND PARKING STALLS SHALL BE PER ADA REQUIREMENTS AND LOCAL REGULATIONS.

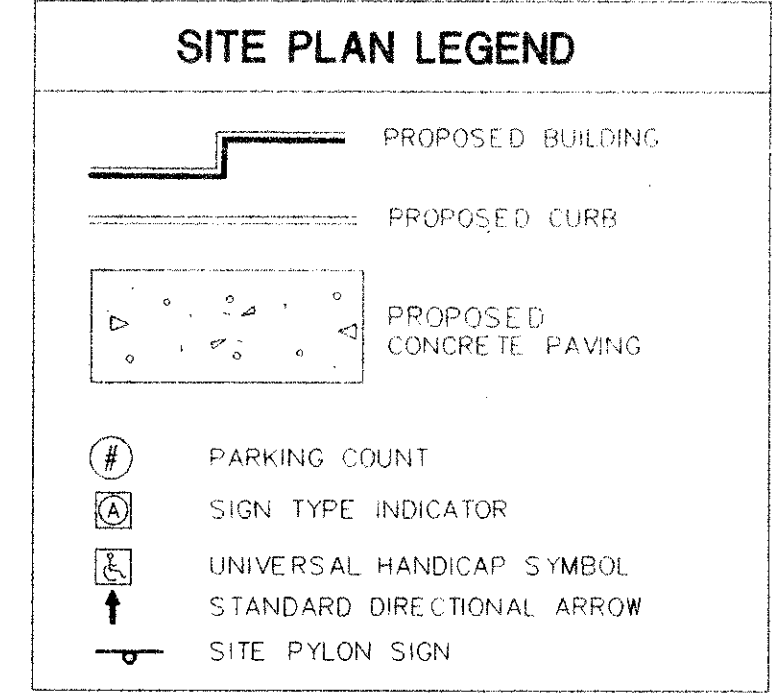

### SITE INFORMATION

ZONING:	C-1, 2002
LOT AREA:	137,982.275 F./3.17 AC.
BUILDING AREA:	16,868.76 S.F.
FLOOR AREA RATIO:	13.05%

PARKING:		51
CUSTOMER:		8
CUSTOMER ACCESSIBLE:		2
EMPLOYEE:		2
EMPLOYEE ACCESSIBLE:		2
OFFICIAL:		2
FIRM MAILERS:		7
TOTAL SPACES:		71

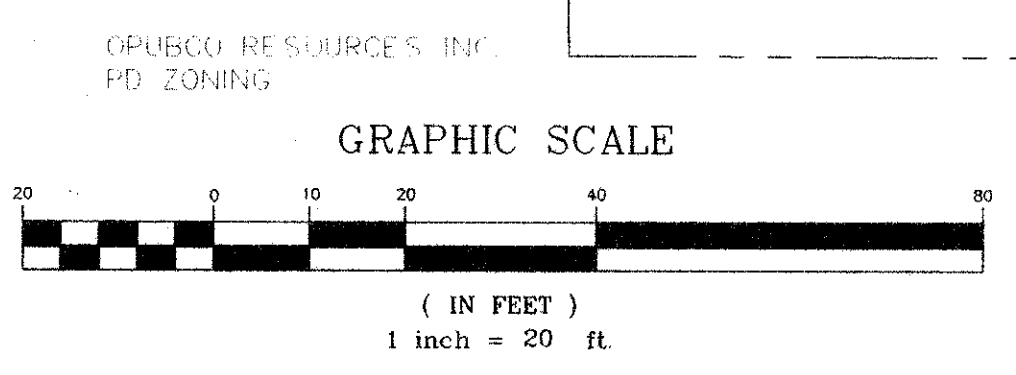

## SITE PLAN

GRUBCO RESOURCES, INC.  
PD. ZONING

GRUBCO RESOURCES, INC.  
PD. ZONING

### SIGNAGE LEGEND

REFER TO DETAIL SHEET FOR MOUNTING INFORMATION

(A) DO NOT ENTER	
(B) HANDICAP	
(C) STOP	
(D) NO TRUCKS ALLOWED	
(E) EMPLOYEES ONLY	
(F) ONE WAY	
(G) PEDESTRIAN CROSSING	

DOUBLE SWING GATE SECURED BY KNOX ENTRY SYSTEM OR APPROVED EQUAL GATES SHALL COMPLY WITH TOWN OF ADDISON ORDINANCE 095-038

BUILDING LOCATION SHALL BE FIELD VERIFIED WITH DIMENSIONS PRIOR TO CONSTRUCTION. NOTIFY DEVELOPER OF DISCREPANCIES IMMEDIATELY.