

GENERAL NOTES

- 1- ALL EXISTING UTILITIES ARE SHOWN SCHEMATICALLY AND ARE FOR THE CONTRACTORS GUIDANCE ONLY. THE CONTRACTOR SHALL VERIFY THE LOCATION SIZE AND MATERIAL OF ALL UTILITIES EFFECTED BY CONSTRUCTION PRIOR TO BEGINNING CONSTRUCTION. CONTRACTOR SHALL CONTACT ALL EFFECTED UTILITIES 48 HRS PRIOR TO CONSTRUCTION.
- 2- ALL WORK AND MATERIAL SHALL BE IN ACCORDANCE WITH CITY OF ADDISON STANDARD SPECIFICATIONS AND DESIGN STANDARDS, AND STANDARD SPECIFICATIONS FOR PUBLIC WORKS CONSTRUCTION PREPARED BY NORTH CENTRAL TEXAS C.O.G. (LATEST REVISION)
- 3- PAVEMENT IN ALL AREAS SHALL BE REINFORCED CONCRETE PAVEMENT WITH #3 REINFORCING STEEL BARS SPACED AT 18 INCHES ON CENTER. SUBGRADE SHALL BE COMPACTED TO A MINIMUM DRY DENSITY OF 95% OF THE MAXIMUM DENSITY AND AT A MOISTURE CONTENT AT LEAST TWO PERCENTAGE POINTS ABOVE THE OPTIMUM MOISTURE CONTENT.

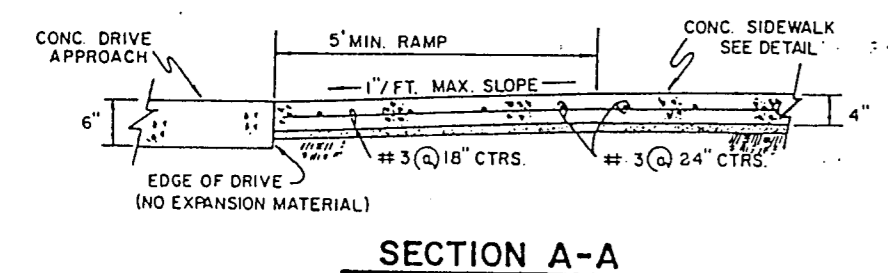

HANDICAP RAMP DETAIL

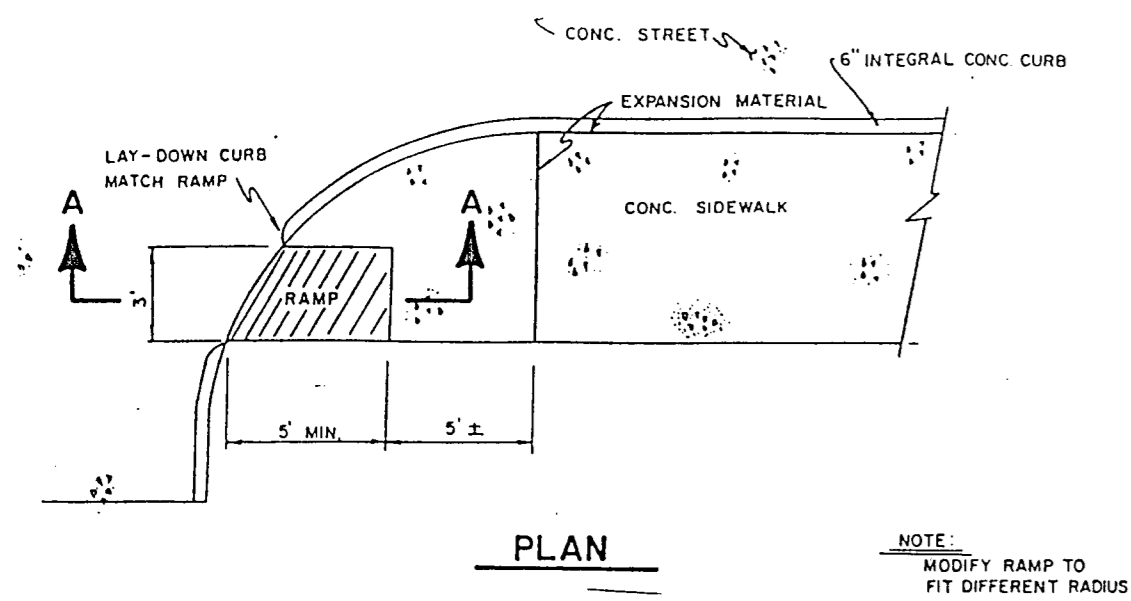
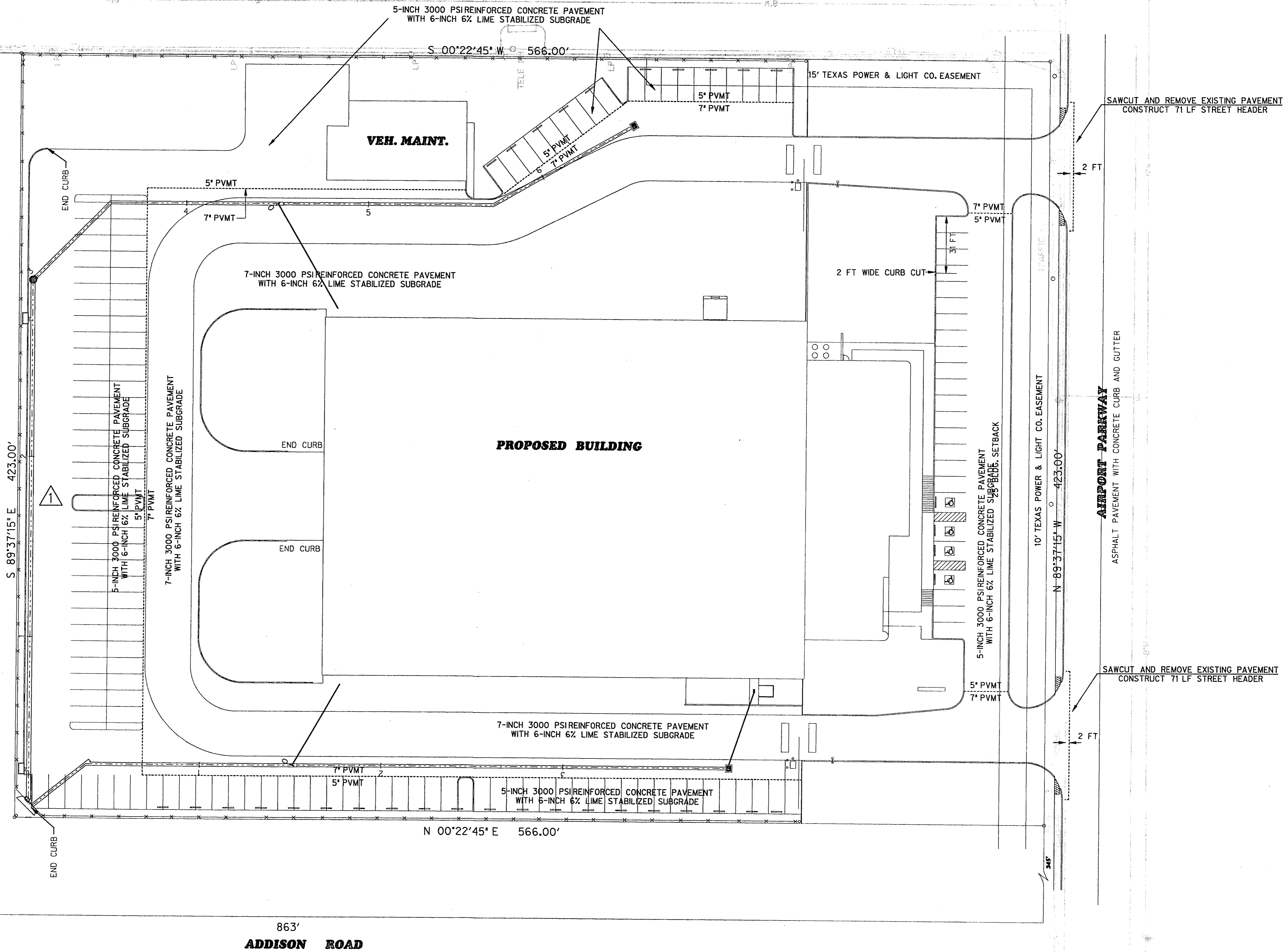

"AS BUILT PLANS"

All improvements shown on these plans and placed within the Town of Addison's right-of-way or easement were constructed in compliance to the Town of Addison Standards and Specifications and functions as designed.

PAVING PLAN

△ EXTEND PARKING TO NORTH-11/11/94

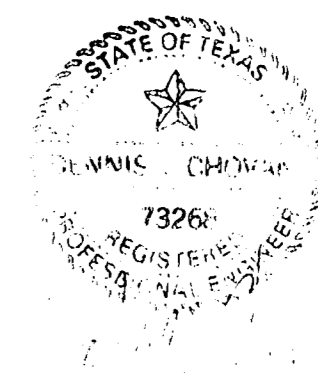

DIENNA / SIMPKINS COMPANY
 REAL ESTATE DEVELOPMENT
 1400 POST OAK BLVD., SUITE 1100
 HOUSTON, TEXAS 77056
 713/686-1222

62 VAN CITY STATION FACILITY

FOOTEX

ADDISON, TEXAS

PROJECT	94/G
DATE	11-11-94
REVISIONS	1
SHEET	P-1
PAGE	3 OF 49

MUNSON KENNEDY PARTNERSHIP

HALF ASSOCIATES, INC.
 ENGINEERS • ARCHITECTS • PLANNERS • ESTIMATORS