

AIRPORT ELEVATION 643.8 FEET

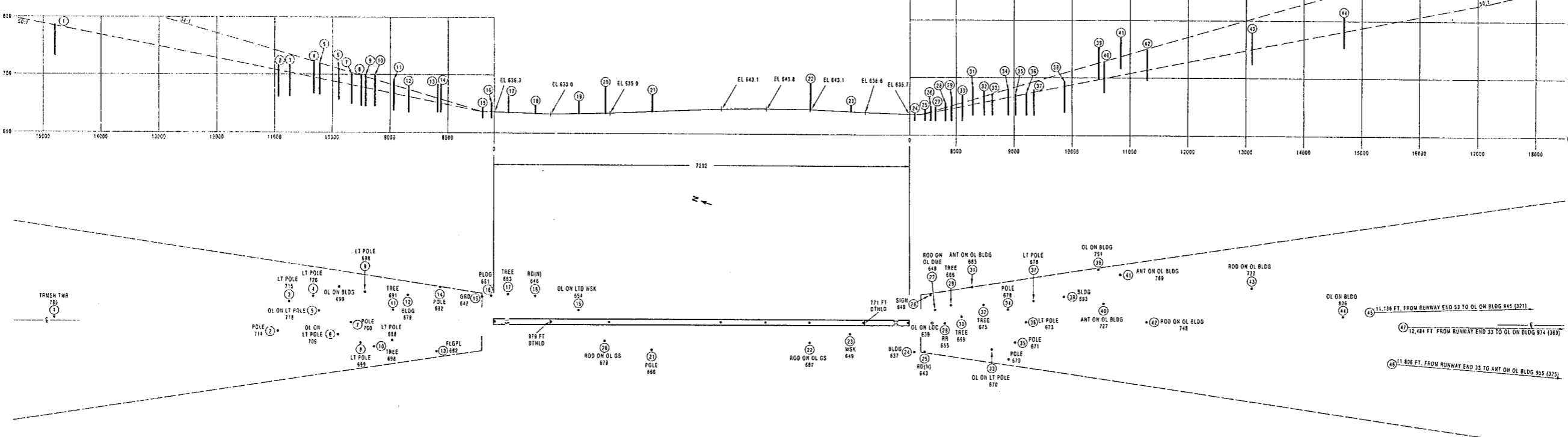

RUNWAY PLANS AND PROFILES

PROFILE SCALE
HORIZONTAL: 1 INCH EQUALS 100 FEET
VERTICAL: 1 INCH EQUALS 100 FEET



AIRPORT PLAN

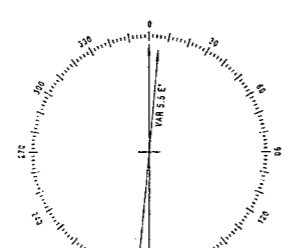
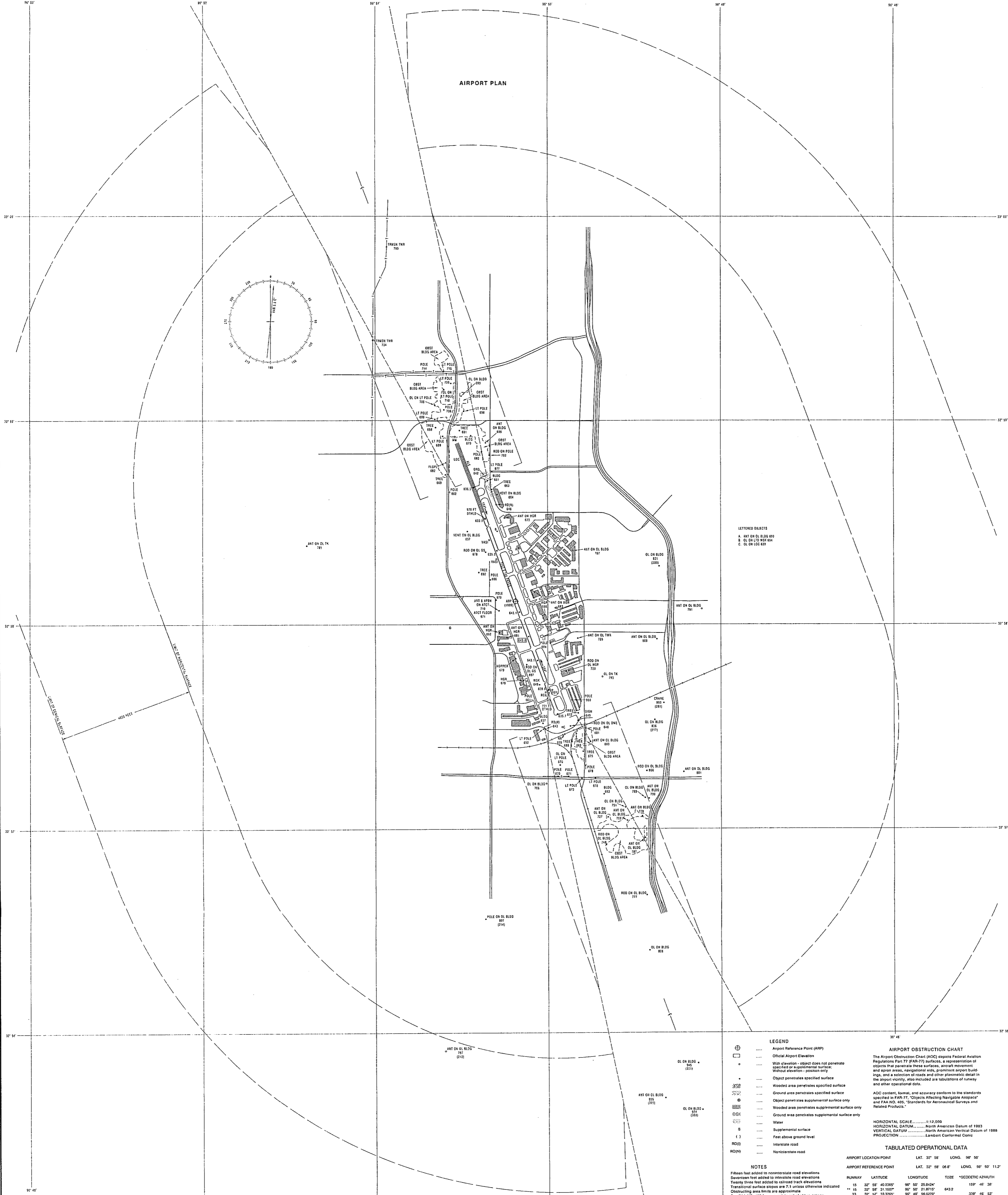

LETTERED OBJECTS
A. ANT ON OL BLDG 800
B. OL ON BLDG 800
C. OL ON BLDG 800

LEGEND

- Antenna Reference Point (ARP)
- Obst Airport Elevation
- With elevation - object does not penetrate specified or supplemental surface
- Without elevation - position only
- Cloud penetrates specified surface
- Wooded area penetrates specified surface
- Ground area penetrates supplemental surface only
- Object penetrates supplemental surface only
- Wooded area penetrates supplemental surface only
- Ground area penetrates supplemental surface only
- Water
- Supplemental surface
- Feet above ground level
- Interstate road
- Noninterstate road

AIRPORT OBSTRUCTION CHART
The Airport Obstruction Chart (AOC) depicts Federal Aviation Regulations Part 77 (FAR 77) surfaces, a representation of objects that penetrate these surfaces, aircraft movement and apron areas, navigational aids, prominent airport buildings, and a selection of trees and other obstructions in the airport vicinity. Also included are substitutions of runway and other operational data.

AOC content, format, and accuracy conform to the standards specified in FAR 77, "Objects Affecting Navigable Airspace" and FAA NO. 405, "Standards for Aeronautical Surveys and Related Products."

HORIZONTAL SCALE: 1:19,000
HORIZONTAL DATUM: North American Datum of 1983
VERTICAL DATUM: North American Vertical Datum of 1988
PROJECTION: Lambert Conformal Conic

TABULATED OPERATIONAL DATA

AMPHOT LOCATION POINT	LAT.	LONG.	NO.
AIRPORT REFERENCE POINT	32° 58' 06.4"	106° 50' 11.2"	
RUNWAY	LATITUDE	LONGITUDE	TOUSE
15	32° 58' 40.2500"	106° 50' 25.8244"	180° 45' 30"
16	32° 58' 31.1687"	106° 50' 21.8710"	643.2
33	32° 57' 33.9262"	106° 49' 58.9270"	643.8
33	32° 57' 40.5391"	106° 49' 58.7582"	643.8

NOTES

Filices feet added to noninterstate road elevations
Obstruction feet added to interstate road elevations
Twenty three feet added to railroad track elevations
Transition surface slopes are 7:1 unless otherwise indicated
Obstruction area limits are approximate
See FAA NO. 405 for a complete set of abbreviations
Unlighted elevations determined photogrammetrically with a vertical accuracy +/- 40 feet

AMENDMENT DATA

NO.	DATE	DESCRIPTION

DIMENSIONS AND ELEVATIONS ARE IN FEET

Published at Washington, D.C.
U.S. Department of Commerce
National Oceanic and Atmospheric Administration
National Ocean Survey

ADDISON AIRPORT, DALLAS, TEXAS