

SCALE 1"=20'

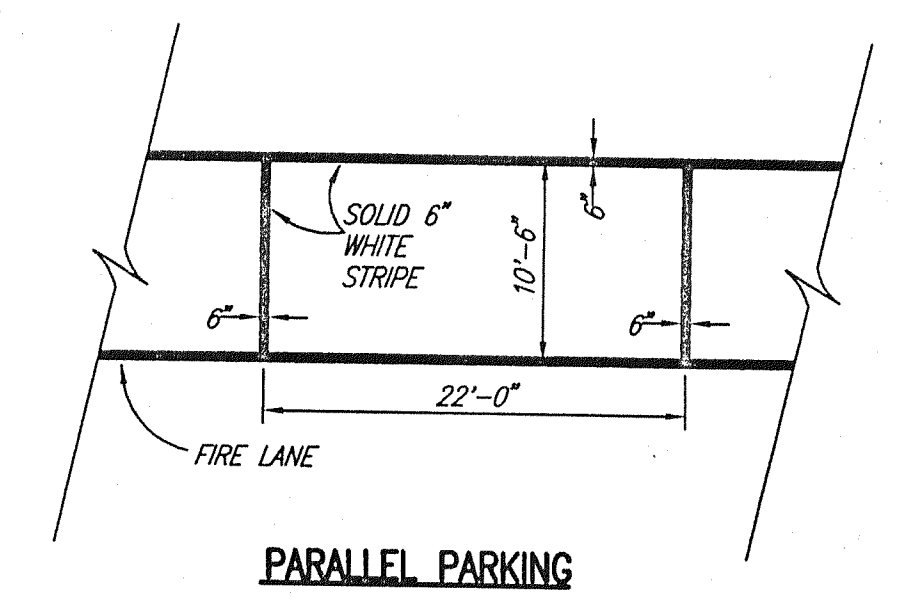

- LEGEND**
- EXISTING
 - - - PROPOSED BOUNDARY
 - PROPOSED CURB KELLER SPRINGS
 - PROPOSED IMPROVEMENTS TO PARKING
 - PROPOSED FENCE
 - E EXISTING NUMBER OF SPACES
 - P PROPOSED NUMBER OF SPACES

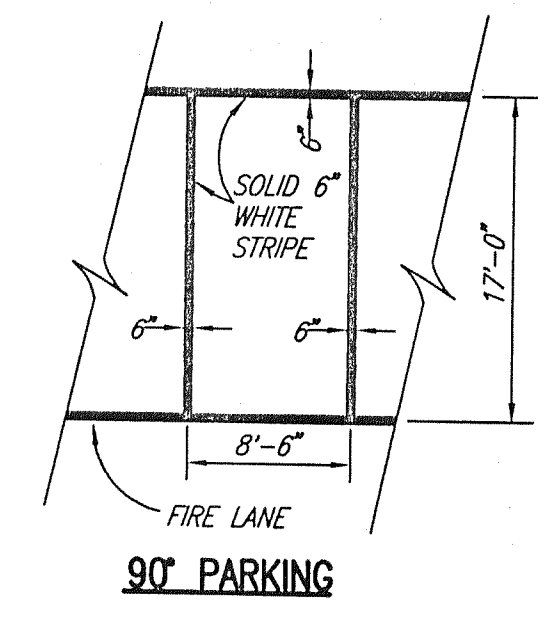
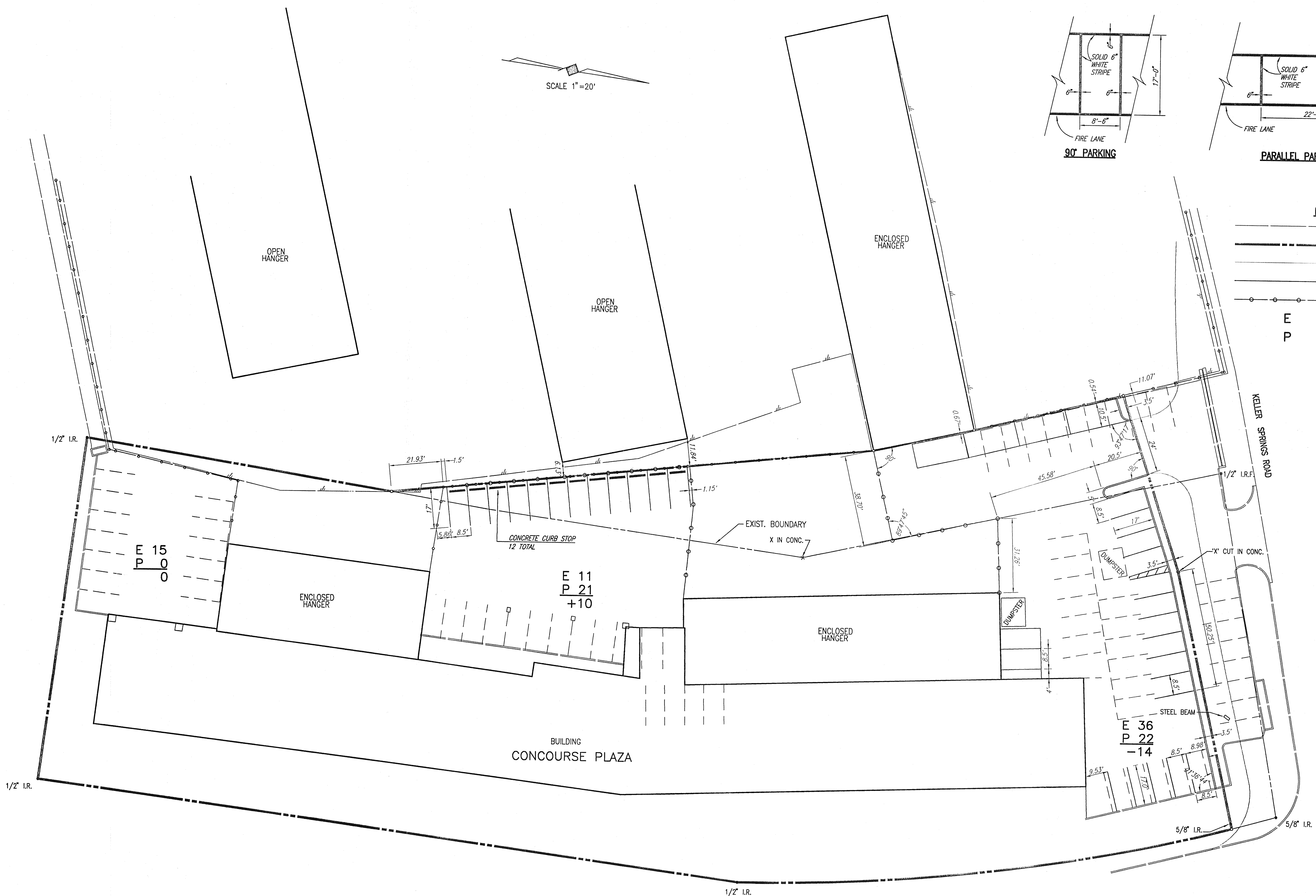

TOWN OF ADDISON, TEXAS

ADDISON AIRPORT - PARKING
AT KELLER SPRINGS RD. & ADDISON RD.

SHIMEK, JACOBS & FINKLEA, L.L.P.
CONSULTING ENGINEERS
Dallas, Texas

DESIGNED BY: J.W.B. PROJECT: 96126 SHEET NO. 1
DRAWN BY: R.J.L. DATE: AUG. 1996 OF 1 SHEETS

John W. Birkhoff
DATE: 8/22/96

