

MATCH LINE - SEE SHEET 4

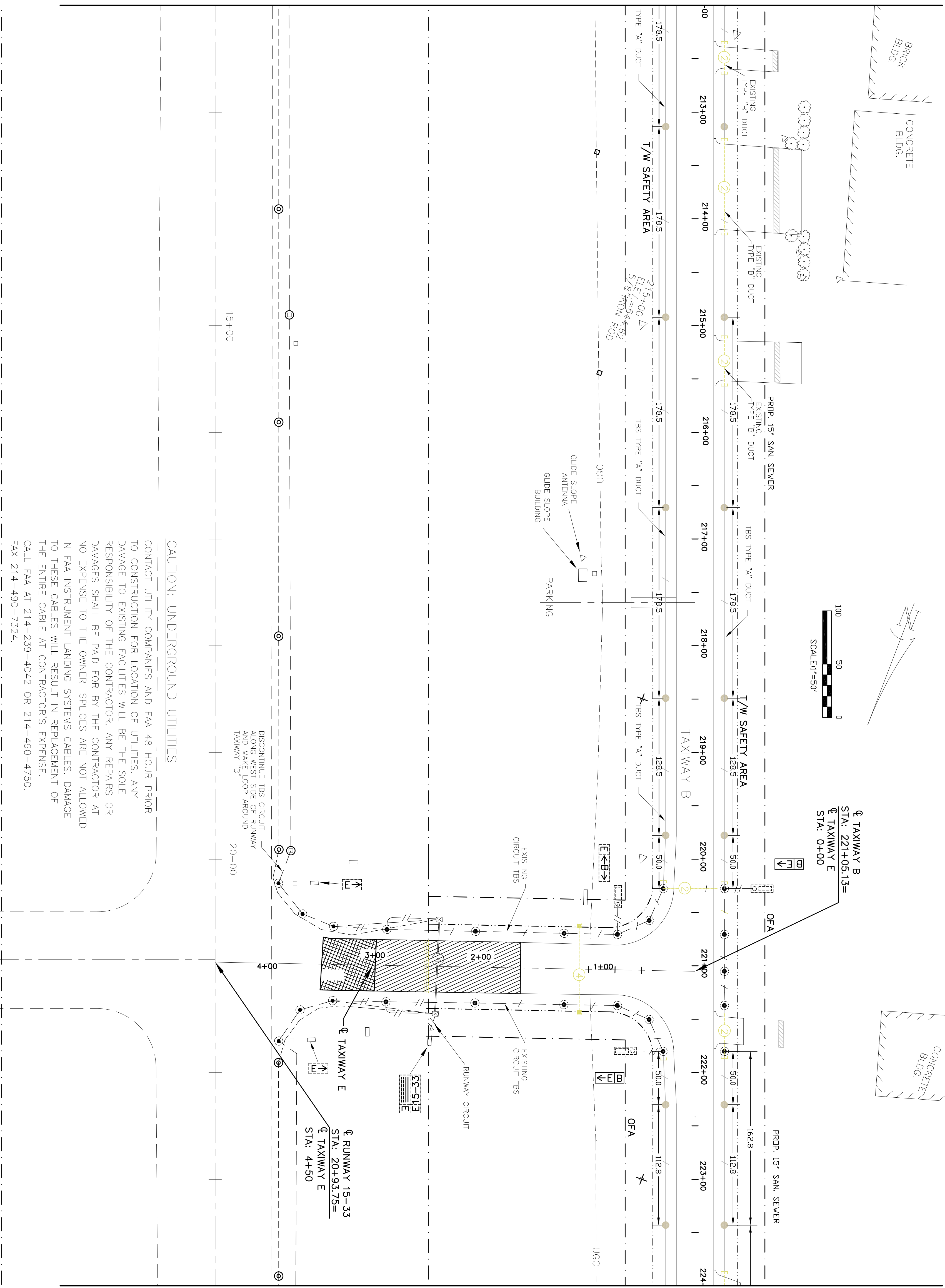

MATCH LINE - SEE SHEET 6

LEGEND	
○	POWER POLE
⊕	FIRE HYDRANT
*	STROBE LIGHT
—E—	OVERHEAD ELECTRIC
Δ	WATER VALVE
←	GUY WIRE
⊠	ELECTRIC BOX
⊥	SIGN
□	UNDER GRD CABLE MKRK
+	BORING HOLE LOCATION
□	DISTANCE TO GO SIGN
□	CONC. PAD
□	CONCRETE PAVEMENT
⊠	EXIST GUIDANCE SIGN
---	NEW T/W CIRCUIT
---	EXISTING R/W CIRCUIT
---	EXISTING T/W CIRCUIT
○	EXISTING T/W LIGHT
○	EXISTING RUNWAY LIGHT
○	EXISTING MANHOLE
○	L-581T MTL(BLU/TAXIWAY LIGHT BASE MOUNTED/NEW)
○	NEW HANDHOLE
○	L-580C R/W (N/PAYT LT) (WHITE/WHITE-YELLOW)
⊠	EXISTING HANDHOLE
⊠	EXISTING DUCT BANK
④	2-4" PVC DUCTS *
②	1-2" PVC DUCT *
■	DUCT MARKER
■	5' STUBOUT & CAP

* NUMBER IN CIRCLE INDICATES SIZE OF CONDUIT. LINES INDICATE NUMBER OF DUCTS.

CAUTION: UNDERGROUND UTILITIES

CONTACT UTILITY COMPANIES AND FAA 48 HOUR PRIOR TO CONSTRUCTION FOR LOCATION OF UTILITIES. ANY DAMAGE TO EXISTING FACILITIES WILL BE THE SOLE RESPONSIBILITY OF THE CONTRACTOR. ANY REPAIRS OR DAMAGES SHALL BE PAID FOR BY THE CONTRACTOR AT NO EXPENSE TO THE OWNER. SPLICES ARE NOT ALLOWED IN FAA INSTRUMENT LANDING SYSTEMS CABLES. DAMAGE TO THESE CABLES WILL RESULT IN REPLACEMENT OF THE ENTIRE CABLE AT CONTRACTOR'S EXPENSE.

CALL FAA AT 214-239-4042 OR 214-490-4750.
CALL FAA AT 214-490-7324.

90% SUBMITTAL

FOR INTERIM REVIEW ONLY

PSA ENGINEERING
PANSUK SRIBHEN
NO. 40320
DATE: 4/26/95

DESIGN: R.W.C.
DRAWN: M.C.K.
CHECKED: E.S.A.
SCALE: 1" = 50'

A.P. NO.: 3-48-0063-07
BID NO.: 95-18
JOB NO.: E708024.70

Date: _____

REVISIONS

By: _____

Greiner, Inc.
Greiner, Inc.
Fort Worth, Texas

ASA ENGINEERING
DALLAS, TEXAS 75287

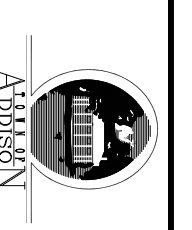

ADDISON AIRPORT

TAXIWAY "B" LIGHTING LAYOUT - STA. 212+00 TO 224+00

SHEET 5
DATE: APR., 1995