

--- EXISTING CONTOURS (6" INCREMENTS)
 - - - FINAL CONTOURS

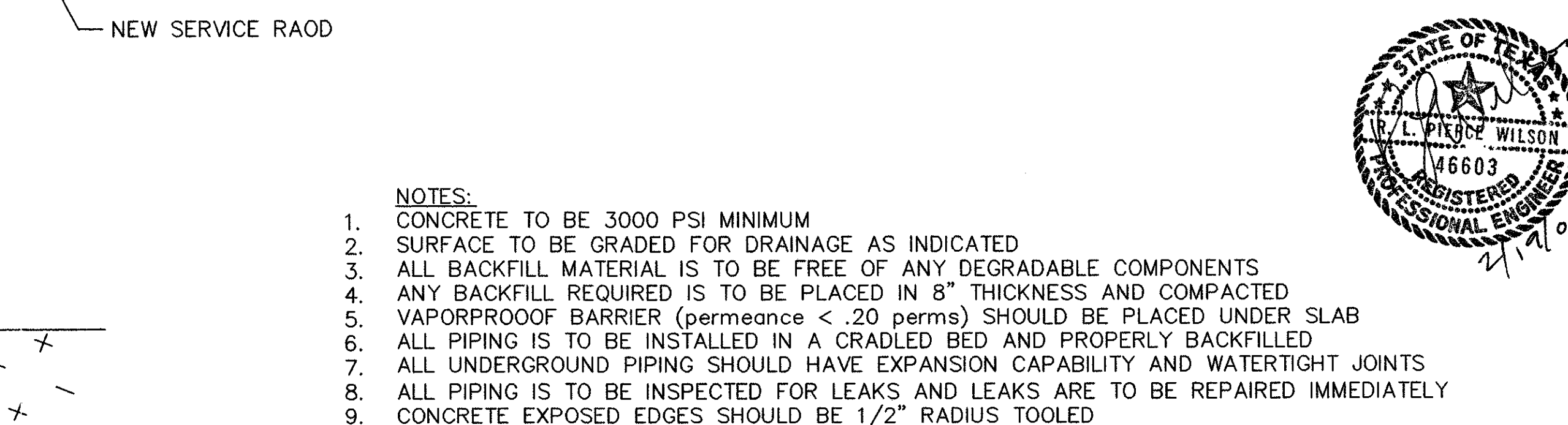
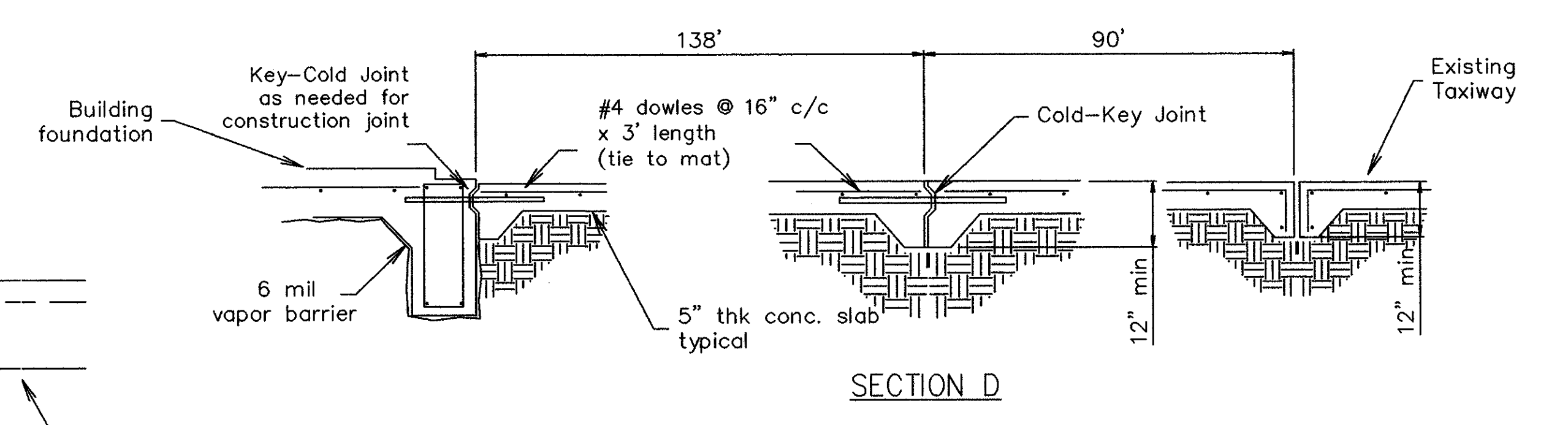
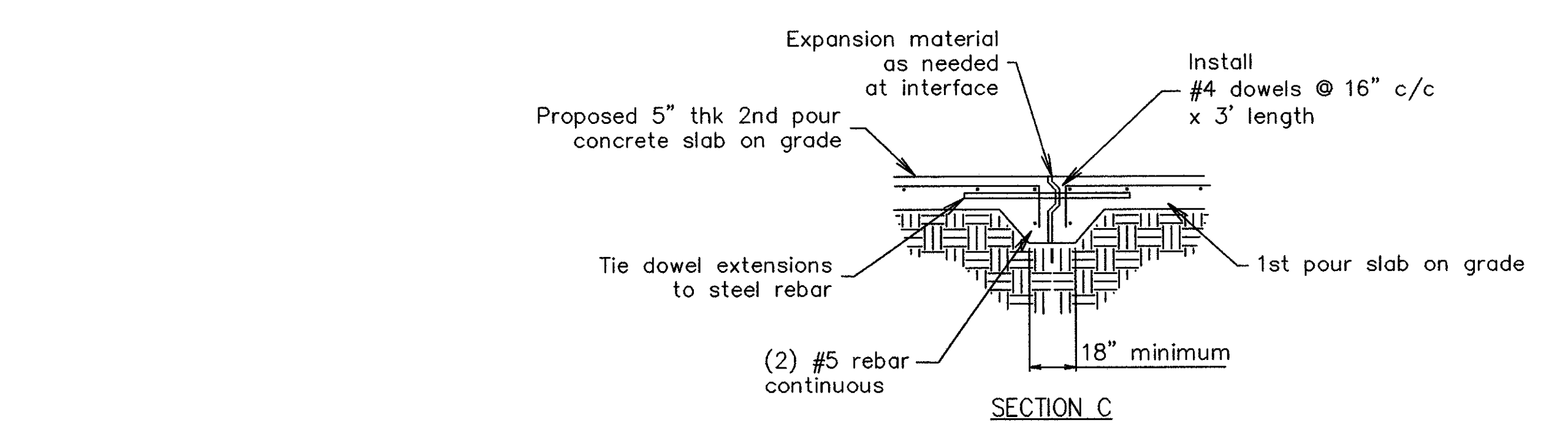
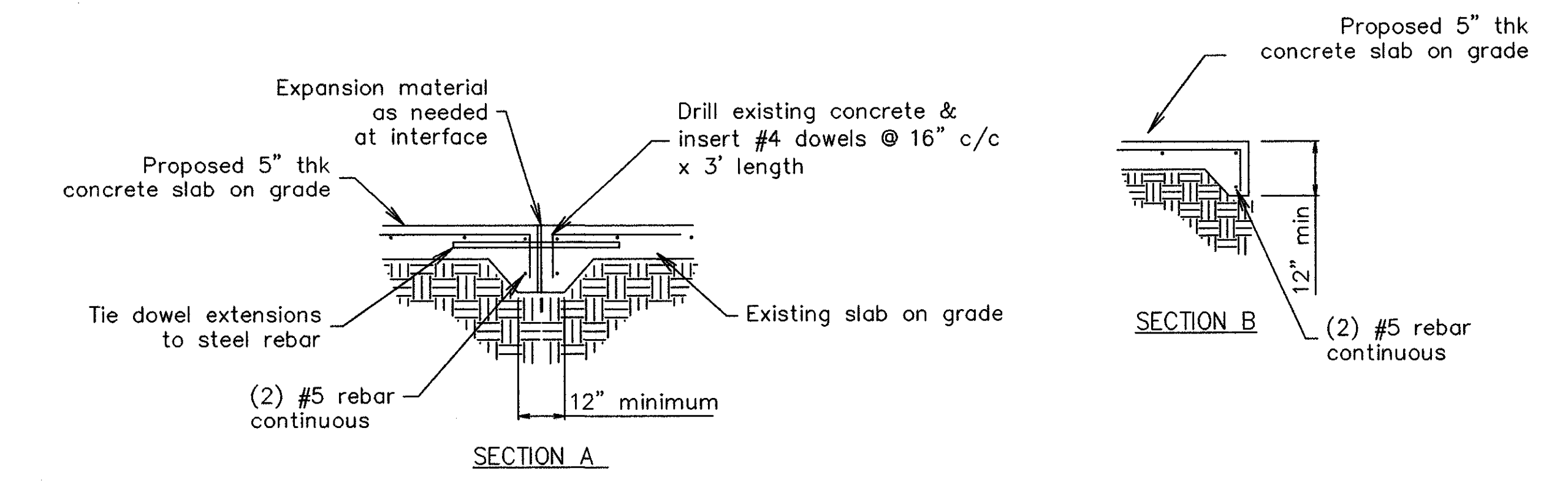

- NOTES:
1. CONCRETE TO BE 3000 PSI MINIMUM
 2. SURFACE TO BE GRADED FOR DRAINAGE AS INDICATED
 3. ALL BACKFILL MATERIAL IS TO BE FREE OF ANY DEGRADABLE COMPONENTS
 4. ANY BACKFILL REQUIRED IS TO BE PLACED IN 8" THICKNESS AND COMPACTED
 5. VAPORPROOF BARRIER (permeance < .20 perms) SHOULD BE PLACED UNDER SLAB
 6. ALL PIPING IS TO BE INSTALLED IN A CRADLED BED AND PROPERLY BACKFILLED
 7. ALL UNDERGROUND PIPING SHOULD HAVE EXPANSION CAPABILITY AND WATERTIGHT JOINTS
 8. ALL PIPING IS TO BE INSPECTED FOR LEAKS AND LEAKS ARE TO BE REPAIRED IMMEDIATELY
 9. CONCRETE EXPOSED EDGES SHOULD BE 1/2" RADIUS TOOLED
 10. FINISH CONCRETE BY FLOATING AND POWER TROWELING
 11. SURFACE FINISH AS REQUIRED BY OWNER
 12. HEAVY EQUIPMENT TRAFFIC MAY CREATE PUMPING - STABILIZE THESE AREAS
 13. ALL CONSTRUCTION IS TO BE IN ACCORD WITH APPROPRIATE CONSTRUCTION TECHNIQUES
 14. REBAR IS TO BE 40,000 PSI YIELD STRENGTH, MINIMUM
 15. CONCRETE SURFACE MOISTURE TO BE MAINTAINED FOR PROPER CURING
 16. CUSHION SAND, 4" MINIMUM, TO BE USED UNDER SLAB
 17. PROPER WATER-CEMENT RATIO SHOULD BE MAINTAINED

Notes
 Runway lighting must be modified at entry tie-in to FAA Standards - flush
 All work is to be performed by qualified craftsmen.
 All work is to be performed according to safety standards
 These drawings reflect the basic intent of the project, however,
 if in doubt, contact the supervisor on this project
 for verification of the required outcome.
 All components and labor shall be guaranteed for a minimum of one year.
 Contractor shall verify all dimensions prior to beginning work.
 All work is to be in accordance with local codes and UBC

ADDISON EXPRESS
 HANGER ADDITION
 4500 Claire Chennault
 Addison, Texas

PLAN VIEW
 APRON PLAN & DETAILS
 (as built)

WECO ENGINEERING CO
 406 Erie Street
 Cleburne, Texas 76031
 (817) 645-1160



REV.	DATE	DESCRIPTION

DWG NO. addison4
 G-3
 DATE: 05-27-00