

*SBS Project For
Transcontinental Realty, Inc.
Aircraft Hangar
16321 Addison Rd.*

H L M ARCHITECTS, INC.

HENSLEY LAMKIN MARTINEZ RACHEL
7557 RAMBLER ROAD
DALLAS, TEXAS
PH 214 369-2150
SUITE 706
75231
FAX 214 369-2166

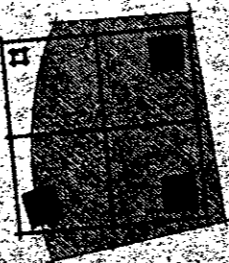

© 2000 H L M ARCHITECTS, INC.
DOCUMENTS AS INSTRUMENTS OF
SERVICE ARE GIVEN IN CONFORMANCE
AND REMAIN THE PROPERTY OF
H L M ARCHITECTS, INC. THE
DOCUMENT AND THE INFORMATION
CONTAINED HEREIN MAY NOT BE
DUPLICATED, USED OR REPRODUCED
WITHOUT WRITTEN CONSENT OF
H L M ARCHITECTS, INC.

ISSUED: 06-02-2000

DRAWN BY: DJ

REVISIONS

00032

MP2

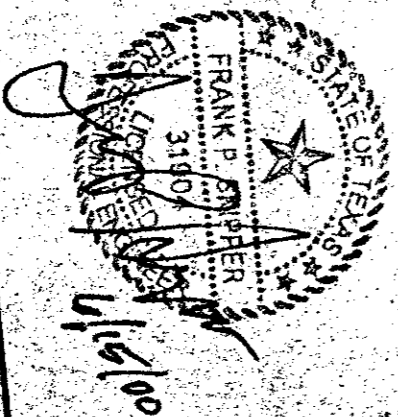

SKIPPER + ROBINSON

CONSULTING ENGINEERS INC.
2351 W. NORTHWEST HWY., SUITE 2215
DALLAS, TEXAS 75220

TEL: (214) 802-1900
FAX: (214) 802-8598

S+R
CONSULTING ENGINEERS INC.

ENCLOSURE # 2501

DESIGN FS

QC FS

rod found for
rod found for
each iron rod
each iron rod
OF BEGINNING

of the
of the
as follows:

Road, 670.40 feet
seconds West

rod found for corner;

rod found for corner;

rod found for corner;

RECKONING,

feet,

otic facilities.
lines as set forth
Kerny dated
Dallas County,
McKamy to
of Dallas
& and Volume

of taxiway

Road

in the

45.01
West

for

feet