

LINE "ST-1" PROFILE

292 LF 24" CLASS III RCP

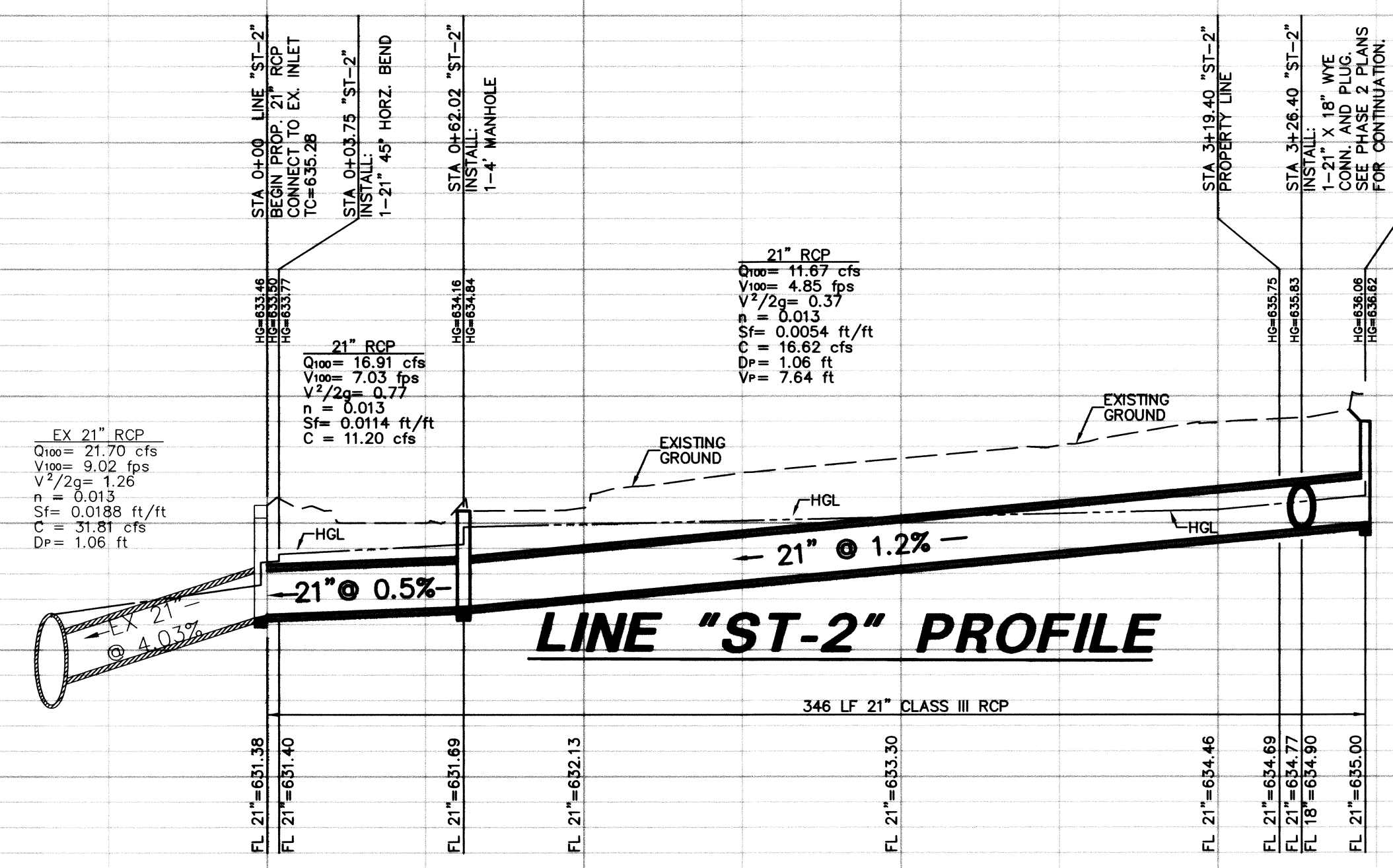

LINE "ST-2" PROFILE

346 LF 21" CLASS III RCP

RECORD DRAWING
 THIS DRAWING HAS BEEN REVISED TO REFLECT CONSTRUCTION RECORDS MAINTAINED AND PROVIDED BY THE CONTRACTOR FOR THIS PROJECT.
 CONTRACTOR: PINION CONSTRUCTION
 DATE REVISED: 06/24/2010

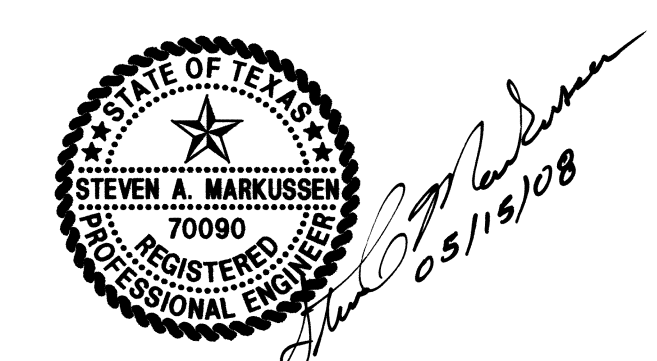

THE SEAL APPEARING ON THIS DOCUMENT WAS AUTHORIZED BY STEVEN A. MARKUSSEN, P.E. 70090 ON 05/15/2008. ALTERATION OF A SEALED DOCUMENT WITHOUT PROPER NOTIFICATION TO THE RESPONSIBLE ENGINEER IS AN OFFENSE UNDER THE TEXAS ENGINEERING PRACTICE ACT.

PW# 2007-002

NO.	DATE	REVISION
	06/12/2008	REVISED ST-1
Pacheco Koch Consulting Engineers		
8350 N. CENTRAL EXPWY. SUITE 1000 DALLAS, TX. 75206 972.235.3031		
STORM SEWER PROFILES		
JW OPERATING - PHASE 1		
ADDISON AIRPORT INDUSTRIAL DISTRICT		
LOT 7A, BLOCK B		
TOWN OF ADDISON, TEXAS		
DESIGN	DRAWN	DATE
CPM	CPM	FEB 2008
SCALE	NOTES	FILE
1"=40'		
NO.	C2.3	

C:\COLLUSKEY\06/24/2010 - 8:50AM
 M: DWG-2792-07.089\DWG\2792-07.089CV-PHASE 1.DWG

JW OPERATING - PHASE 1