

Source : U.S. Weather Bureau Sta.
 Love Field, Dallas
 Period : Sept. 1957 to Aug. 1962
 Scale : 1" = 20 m.p.h.
 15 m.p.h. Crosswind Coverage
 R/W 15/33 = 93.84%

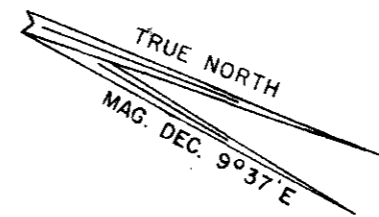
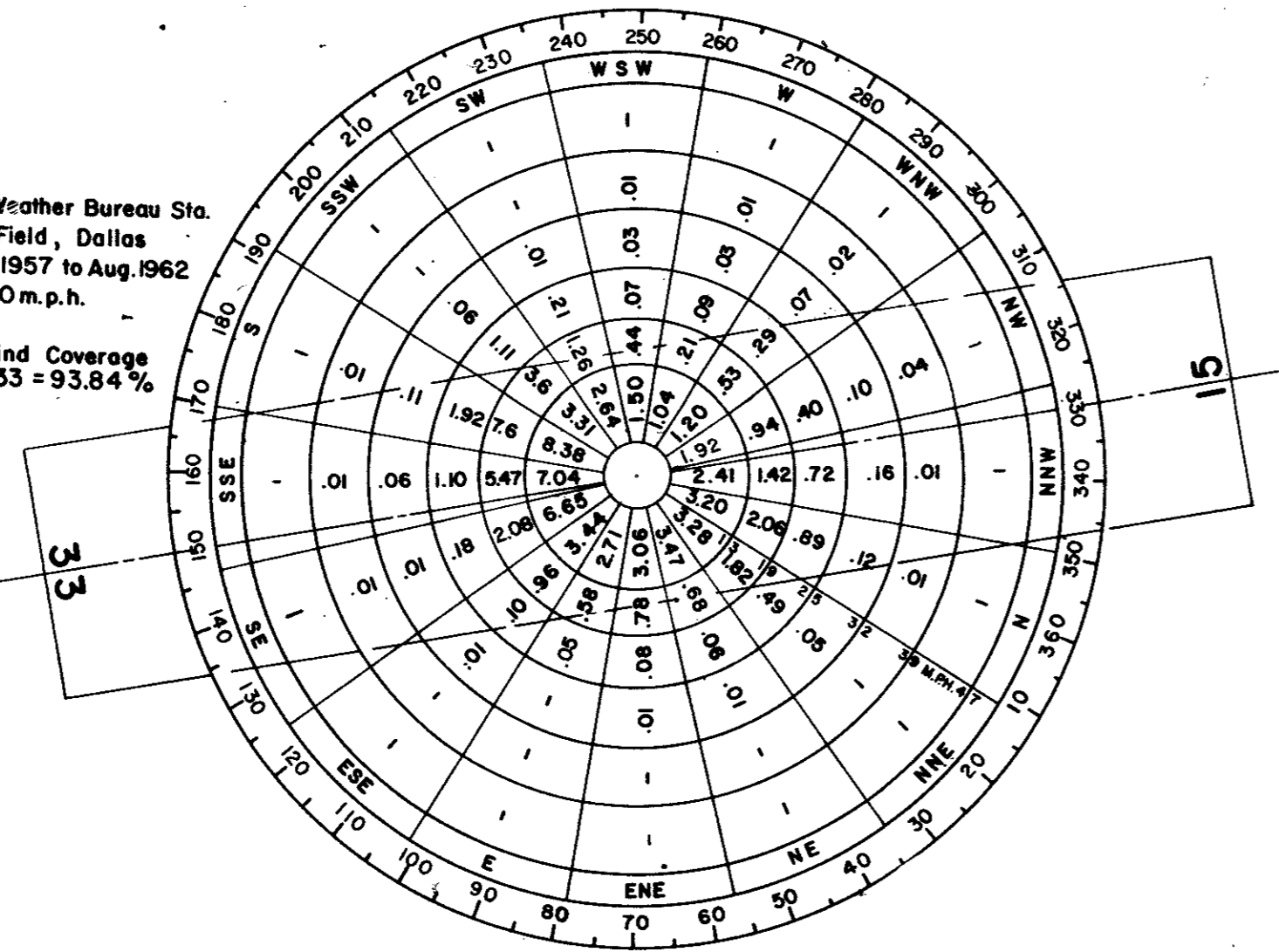

BASIC RUNWAY DATA TABLE		
	RUNWAY 15/33	
	EXISTING	ULTIMATE
EFFECTIVE GRADIENT(IN%)	0.03	SAME
% WIND COVERAGE	93.84	SAME
INSTRUMENT RUNWAY	YES	YES
PAVEMENT STRENGTH	805,100D	SAME
APPROACH SURFACE	50:1 BOTH	SAME
RUNWAY LIGHTING	MIRL	SAME
RUNWAY MARKINGS	ALL WEATHER	SAME
NAVIGATIONAL AIDS	ILS	SAME

BASIC AIRPORT DATA TABLE		
	EXISTING	ULTIMATE
AIRPORT ELEVATION, M.S.L.	643.00	
AIRPORT REFERENCE POINT (ARP) COORDINATES	LAT. 32° 58' 10.585"	SAME
	LNG. 96° 50' 08.482"	
MEAN MAX. TEMP. OF HOTTEST MONTH	96.1° F	SAME
AIRPORT AND TERMINAL NAVIGATIONAL AIDS	ILS	SAME

LEGEND	
EXISTING	
-X-X-X-	FENCE
.....	RUNWAY LIGHTS
.....	GROUND CONTOURS
.....	BUILDINGS PERTAINING TO AIRPORT
.....	EXISTING PROPERTY LINE
.....	PROPERTY ACQUIRED THIS PROJECT
.....	BUILDING RESTRICTION LINE (BRL)
.....	EASEMENTS
.....	ASPHALT PAVEMENT
.....	GRAVEL

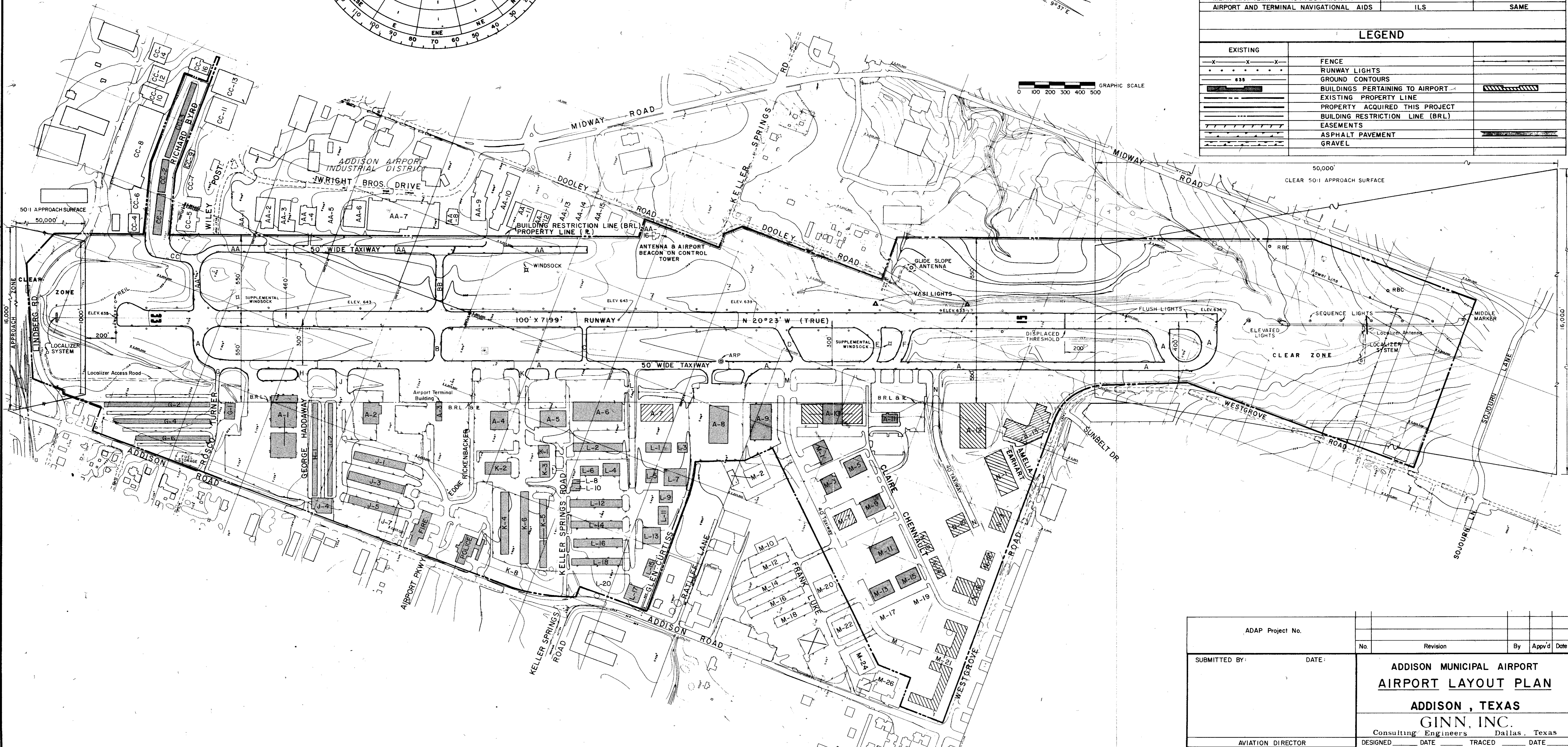

APPROVED BY F.A.A.
 R.L. RODEN
 15 JUNE 63

ADAP Project No.				
NO.	Revision	By	App'd	Date
SUBMITTED BY:	DATE:	ADDISON MUNICIPAL AIRPORT AIRPORT LAYOUT PLAN ADDISON, TEXAS GINN, INC. Consulting Engineers Dallas, Texas		
DESIGNED	DATE			
AVIATION DIRECTOR	DATE	DRAWN	DATE	CHECKED
APPROVED FOR F.A.A.	DATE	APRIL 1963	DATE	
CONTRACT NUMBER	FILE No.	SCALE	1" = 300'	
CHIEF - AIRPORTS BRANCH			SHEET 1 of	