

BUILDING LEGEND

#	TENANT OR OWNER	TOP ELEVATION	#	TENANT OR OWNER	TOP ELEVATION	#	TENANT OR OWNER	TOP ELEVATION	#	TENANT OR OWNER	TOP ELEVATION	#	TENANT OR OWNER	TOP ELEVATION
1.	T-HANGAR CITY (300)	648.7	16.	AIRCRAFT REPAIR SPECIALTY/AVIATION FLYING SCHOOL/CLASSIC OMAHA SPORTSMAN/AVIATION/PILOT SHOP/BOATY	655.7	31.	T-HANGAR CITY (100)	654.7	46.	HERDICK BEECHCRAFT 2	672.2	61.	ADS AIRCRAFT & SERVICES, INC./AEROSPACE INSTRUMENT SUPPORT/AVIATION	662.7
2.	T-HANGAR CITY (400)	648.7	17.	PAVO HANGAR (1500)	657.8	32.	HILL & HAYES (1300)	658.3	47.	PERSONAL VAPOR	667.8	62.	MONARCH AIR	675.6
3.	T-HANGAR CITY (500)	650.8	18.	PAVO HANGAR (1400)	657.8	33.	ULTIMATE SPORTS GIRLS/ESPARANZA ENERGY	665.0	48.	FRIENDLY AVIATION	668.4	63.	MONARCH AIR	675.6
4.	CRASH AVIATION SERVICES	669.5	19.	ARCOLUMBA, INC.	661.7	34.	AMERICAN FLIGHTS	665.4	49.	FRIENDLY AVIATION	668.4	64.	MONARCH AIR	675.6
5.	AGGROUP/AVIATION, INC.	708.9	20.	WALTER FULLER AIRCRAFT SALES/AIRCRAFT WELDING & SHEET METAL CO./BURBANK AVIATION/SYNAPTIC AVIATION	668.8	35.	TOY BOX	663.9	50.	FRIENDLY AVIATION	668.3	65.	REDEM	682.9
6.	T-HANGAR CITY (TO BE REMOVED)	653.1	21.	JET 10 HANGAR	664.2	36.	LENDREX HANGAR	663.2	51.	FRIENDLY AVIATION	668.3	66.	REDEM	682.9
7.	T-HANGAR CITY (TO BE REPAIRED)	653.1	22.	JET 1 & 2 HANGAR	667.2	37.	NORTH TEXAS AIRCRAFT SERVICES, INC.	663.8	52.	LEONARD THOMAS	675.4	67.	ROCKWELL	678.4
8.	BORG, TEX.	667.4	23.	ALTERNATE AIR/AVIATION/AVIATION/INTERMOUNTAIN	667.4	38.	AR-O SPECIALISTS	672.8	53.	LEONARD THOMAS	672.8	68.	ADDITION AIRPORT OF TEXAS INC./TRANS-TEXAS, INC.	684.6
9.	OMNIFLITE HELICOPTERS, INC.	667.5	24.	PAVO HANGAR (1500)	657.8	39.	B & C AIRMOTIVE	668.1	54.	LEONARD THOMAS	672.8	69.	UNITED STATES CUSTOMS OFFICE	676.4
10.	PAVO HANGAR	667.2	25.	JET 3 & 4 HANGAR	665.2	40.	PIGAR PROP.	667.4	55.	LEONARD THOMAS	672.8	70.	DIR INSTRUMENTS, INC./AVIATION/AVIATION/AVIATION	671.3
11.	CHUCK WAGLEY (700)	666.8	26.	JET PROP EXPRESS/AVIATION/AVIATION/AVIATION	664.4	41.	VERETTA HANGAR	664.9	56.	LEONARD THOMAS	672.8	71.	DIR INSTRUMENTS, INC./AVIATION/AVIATION/AVIATION	671.3
12.	CHUCK WAGLEY (800)	667.8	27.	PORT-A-PORT	668.2	42.	WATFIELD	669.1	57.	LEONARD THOMAS	672.8	72.	DIR INSTRUMENTS, INC./AVIATION/AVIATION/AVIATION	671.3
13.	FLITE ELECTRONICS/HENLEY AIRCRAFT SERVICES	667.0	28.	BOY WOODS AVIATION (PORT-A-PORT)	666.8	43.	ADDITION, INC./AMERICAN JET CENTER/CHL AIR PATROL/STRAWEL AVIATION/TED HEDEL & CO./UNDERWOOD INSTRUMENT SERVICES/UNITED BEECHCRAFT	668.9	58.	CHANNARD FLIGHT MUSEUM	667.7	73.	CO-OP HANGAR	674.7
14.	AR BEN AVIATION/CENTER-LINE AVIATION	662.4	29.	1000 SERVICES HANGAR	654.4	44.	HERDICK BEECHCRAFT 2	672.2	59.	CHANNARD FLIGHT MUSEUM	667.7	74.	CO-OP HANGAR	674.7
15.	ADDITION FLIGHT TRAINING CENTER	669.2							60.	HOVUS, INC.	674.7	75.	AR TRAFFIC CONTROL TOWER	687.4

SPONSOR APPROVAL

TOWN OF ADDISON	DATE
FEDERAL AVIATION ADMINISTRATION	DATE

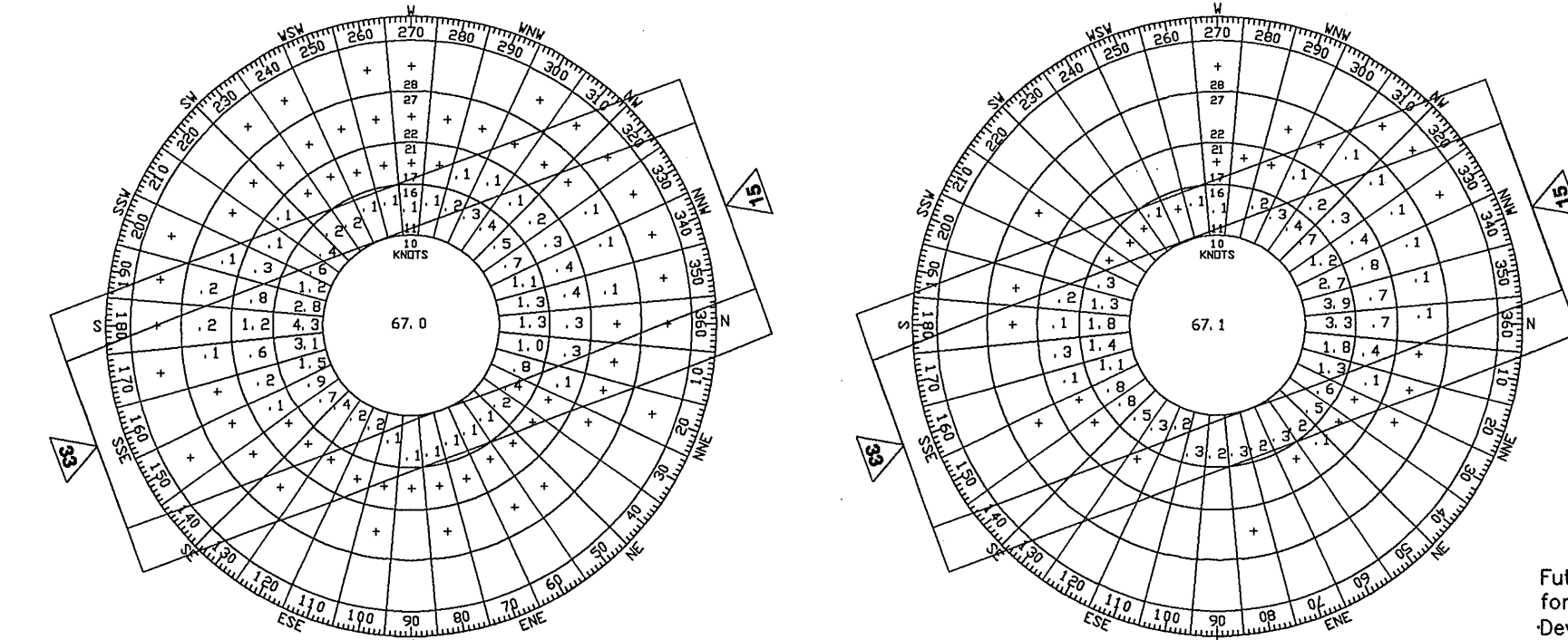

IFR WIND COVERAGE SUMMARY

WIND COVERAGE PROVIDED UNDER FAR CONDITIONS (10-KNOT MAXIMUM CROSSWIND, 5-1000' VISIBILITY)	WIND COVERAGE PROVIDED UNDER FAR CONDITIONS (10-KNOT MAXIMUM CROSSWIND, 10-1000' VISIBILITY)
R/W 15/33	62.2%
R/W 33/33	79.9%
R/W 15 & 33	86.6%
	90.1%
	93.1%

SOURCE: NATIONAL OCEANIC AND ATMOSPHERIC ADMINISTRATION, NATIONAL CLIMATE DATA CENTER, STATION: DALLAS, TEXAS PERIOD OF RECORD: 1986-1995

ALL WEATHER WINDROSE
10.5-KNOT CROSSWIND 16-KNOT CROSSWIND
R/W 15/33 95.6% 99.6%

SOURCE: NATIONAL OCEANIC AND ATMOSPHERIC ADMINISTRATION, NATIONAL CLIMATE DATA CENTER, STATION: DALLAS, TEXAS PERIOD OF RECORD: 1986-1995

IFR WINDROSE

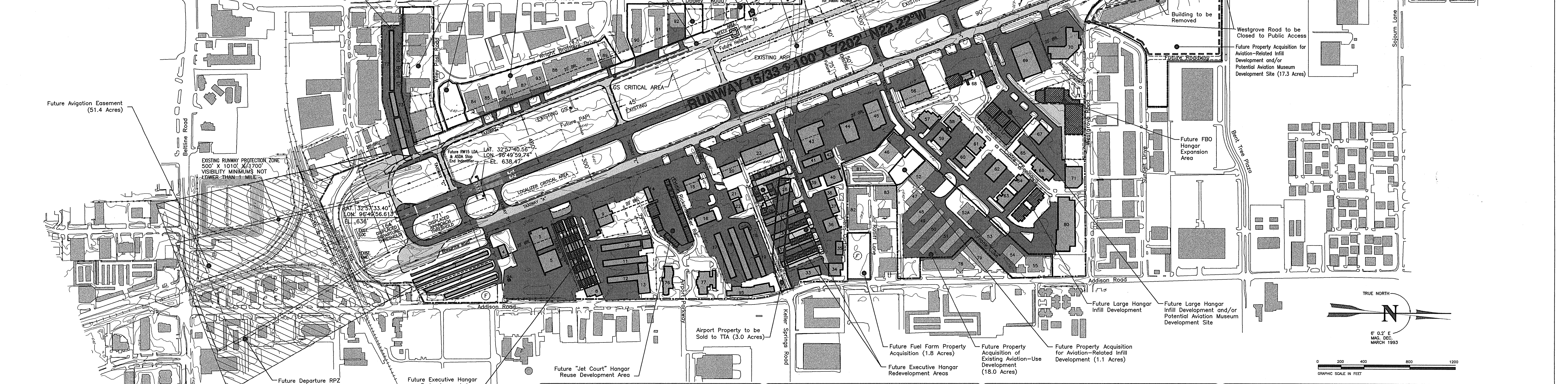

NON-STANDARD CONDITIONS

ITEM	AIRPLANE DESIGN GROUP		STANDARD		NON-STANDARD COND.		REMARKS	APPROVAL DATE
	EXISTING	FUTURE	EXISTING	FUTURE	EXISTING	FUTURE		
RUNWAY 33 SAFETY AREA LENGTH	D-II	D-II	1000'	1000'	1000'	1000'	IMPLEMENT DECLARED DIST. STD.	
RUNWAY 33 OBJECT FREE AREA LENGTH	D-II	D-II	1000'	1000'	300'	1000'	IMPLEMENT DECLARED DIST. STD.	
RUNWAY 15 SAFETY AREA LENGTH	D-II	D-II	1000'	1000'	120'	1000'	IMPLEMENT SUBSIDIARY DRAINAGE/GRADING PROJECT	

PROPOSED MODIFICATION OF STANDARDS

ITEM	AIRPLANE DESIGN GROUP		STANDARD		MODIFICATION		REMARKS	APPROVAL DATE
	EXISTING	FUTURE	EXISTING	FUTURE	EXISTING	FUTURE		
RUNWAY CENTERLINE TO HOUSING	D-II	D-II	250'	250'	200'	200'		

DECLARED DISTANCES

ITEM	RUNWAY 15	RUNWAY 33
TAKEOFF RUN AVAILABLE (TORA)	7038'	7100'
TAKEOFF DISTANCE AVAILABLE (TODA)	7038'	7100'
ACCELERATE-STOP DISTANCE AVAILABLE (ASDA)	6507'	7202'
LANDING DISTANCE AVAILABLE (LDA)	5528'	6431'

REVISIONS

No.	Date

RUNWAY DATA

ITEM	EXISTING		FUTURE	
	15/33	100' X (')	15/33	100' X (')
RUNWAY WIDTH AND LENGTH	844'	100' X (')	844'	100' X (')
RUNWAY LIGHTING	MRL	MRL	MRL	MRL
RUNWAY MARKING	PRECISION	PRECISION	PRECISION	PRECISION
RUNWAY SAFETY AREA	500' X 863'	500' X 863'	500' X 863'	500' X 863'
RUNWAY OBJECT FREE AREA	800' X 8510'	800' X 8510'	800' X 8510'	800' X 8510'
RUNWAY OBSTACLE FREE ZONE	NO OBST. PENETRATIONS	NO OBST. PENETRATIONS	NO OBST. PENETRATIONS	NO OBST. PENETRATIONS
INSTRUMENT RUNWAY	YES	YES	YES	YES
NAVIGATIONAL AIDS	ILS/LOC/NDVR	ILS/LOC/NDVR	ILS/LOC/NDVR	ILS/LOC/NDVR
LANDING AIDS	VAS/MALS/R	VAS/MALS/R	VAS/MALS/R	VAS/MALS/R
APPROACH SURFACES	50:1/50:1	50:1/50:1	50:1/50:1	50:1/50:1
APPROACH VISIBILITY MINIMUMS	1 MILE/1 MILE	1/4 MILE/3/4 MILE	1 MILE/1 MILE	1/4 MILE/3/4 MILE
THRESHOLD STOPPING CRITERIA	NO OBST. PENETRATIONS	NO OBST. PENETRATIONS	NO OBST. PENETRATIONS	NO OBST. PENETRATIONS
PAVEMENT STRENGTH (IN 1000 LBS.)	R02, 100S, 160S	R02, 100S, 160S	R02, 100S, 160S	R02, 100S, 160S
PAVEMENT TYPE	ASPHALT	ASPHALT	ASPHALT	ASPHALT
EFFECTIVE RUNWAY GRADIENT %	0.03	0.03	0.03	0.03
± ALL WEATHER WIND COVERAGE (16/103 KNOTS)	98.8/95.6	98.8/95.6	98.8/95.6	98.8/95.6
FAR PART 77 CATEGORY	P/PI	P/PI	P/PI	P/PI
AIRCRAFT REFERENCE CODE (ARC)	D	D	D	D
RUNWAY LINE-OF-SIGHT	CRITERIA MET	CRITERIA MET	CRITERIA MET	CRITERIA MET
CRITICAL AIRCRAFT	CRITERIA MET	CRITERIA MET	CRITERIA MET	CRITERIA MET
TOUCHDOWN ZONE ELEVATION	645/644'	645/644'	645/644'	645/644'

AIRPORT DATA

ITEM	EXISTING	FUTURE
AIRPORT ELEVATION (AMSL)	644'	644'
AIRPORT REFERENCE POINT (ARP)	LAT. 32° 58' 06.81" N LONG. 96° 50' 11.21" W	LAT. 32° 58' 06.81" N LONG. 96° 50' 11.21" W
MEAN MAX. TEMP. HOTTEST MONTH	96.1°F	96.1°F
AIRPORT PROPERTY (ACRES)	368	445.3
UNICOM (MHz)	122.950	122.950
NPAS CATEGORY	RELEVER	RELEVER
CONTROL TOWER (MHz)	126.0	126.0

LAYOUT PLAN LEGEND

ITEM	EXISTING	FUTURE
BUILDING RESTRICTION LINE	---	---
AIRPORT PROPERTY LINE	---	---
FENCE	---	---
AVIGATION EASEMENT	---	---
RUNWAY PROTECTION ZONE	---	---
BUILDINGS	---	---
AIRFIELD PAVEMENT	---	---
FUEL STORAGE	---	---
ROTATING BEACON	---	---
LIGHTED WIND CONE & SEGMENTED CIRCLE	---	---
PRECISION APPROACH PATH INDICATOR (PAPI)	---	---
RUNWAY END IDENTIFIER LIGHTS (REILS)	---	---
VISUAL APPROACH SLOPE INDICATOR (VASI)	---	---
THRESHOLD LIGHTS (DISPLACED THRESHOLD LIGHTS)	---	---
HELICOPTER TOUCHDOWN AND LIFT-OFF AREA (TLOF)	---	---
WINDCONE	---	---

NOTE: 1. THIS DRAWING SHOULD NOT BE USED AS A STANDARD FOR PLANNING OR DESIGN.
2. BASE MAP PROVIDED BY AERIAL DATA SERVICE, TULSA, OKLAHOMA (SEPT. 1995).
3. MAGNETIC DECLINATION TAKEN FROM 1993 AIRPORT LAYOUT PLAN BY GREINER, INC., FORT WORTH, TEXAS.
4. HORIZONTAL COORDINATE DATUM IS BASED ON NAD83.
5. RUNWAY THRESHOLD LAT/LONG INFORMATION TAKEN FROM OC 768 ADDISON AIRPORT, DALLAS, TEXAS (DEC. 1993).
6. RUNWAY PAVEMENT END LAT/LONG INFORMATION CALCULATED USING "GEODES V2.52" COMPUTER PROGRAM.
7. RUNWAY PROTECTION ZONE (RPZ) PLAN & PROFILE DRAWINGS FOR ROADWAY/RAILROAD CLEARANCE INFORMATION.

ADDISON AIRPORT
ADDISON, TEXAS

AIRPORT LAYOUT PLAN

Barnard Dunkelberg & Company
Tulsa, Oklahoma

DATE: MARCH, 1997
DRAWING NUMBER: []

FF-16
BD 3/97