

**BUILDING LEGEND**

#	TENANT OR OWNER	TOP ELEVATION	#	TENANT OR OWNER	TOP ELEVATION	#	TENANT OR OWNER	TOP ELEVATION	#	TENANT OR OWNER	TOP ELEVATION
1.	T-HANGAR CITY (300)	648.0'	16.	AIRCRAFT REPAIR SPECIALTY/AVIATION FLYING SCHOOL/CLASSIC OMAHA SPORTSMAN/AVIATION/PILOT SHOP/PILOT	655.7'	31.	T-HANGAR CITY (100)	654.1'	46.	HERDICK BEECHCRAFT 2	672.2'
2.	T-HANGAR CITY (400)	648.1'	17.	PAVO HANGAR (1500)	657.8'	32.	HILL & HAVES (1300)	658.3'	47.	PERSONAL VAPOR	667.0'
3.	T-HANGAR CITY (500)	650.0'	18.	PAVO HANGAR (1400)	657.8'	33.	ULTIMATE SPORTS GIRL/ESPARANZA ENERGY	665.0'	48.	FRIENDLY AVIATION	662.7'
4.	CRASH AVIATION SERVICES	669.0'	19.	ARCOLUMBER, INC.	661.7'	34.	AMERICAN FLIGHTS	665.4'	49.	FRIENDLY AVIATION	658.4'
5.	AGGROUP/AVIATION, INC.	708.0'	20.	WALTER FULLER AIRCRAFT SALES/AIRCRAFT WELDING & SHEET METAL CO./BURBANK AVIATION/SYNAPTIC AVIATION	668.0'	35.	TOY BOX	663.0'	50.	FRIENDLY AVIATION	668.3'
6.	T-HANGAR CITY (TO BE REMOVED)	653.1'	21.	JET 10 HANGAR	664.2'	36.	LEONARD THOMAS	663.2'	51.	FRIENDLY AVIATION	662.7'
7.	T-HANGAR CITY (TO BE REPAIRED)	653.1'	22.	JET 1 & 2 HANGAR	667.2'	37.	NORTH TEXAS AVIATION SERVICES, INC.	663.0'	52.	LEONARD THOMAS	675.4'
8.	BORG, TEX.	667.4'	23.	ALTERNATE AIR/AVIATION/AVIATION/THUNDER INTERMOUNTAIN	667.4'	38.	B & C AIRMOTIVE	668.1'	53.	LEONARD THOMAS	672.8'
9.	OWNFUTE HELICOPTERS, INC.	667.0'	24.	PAVO HANGAR (1500)	657.8'	39.	PIGAR PAPER	667.4'	54.	FRIENDLY AVIATION	675.2'
10.	PAVO HANGAR	667.2'	25.	JET 3 & 4 HANGAR	665.2'	40.	VISETTA HANGAR	664.9'	55.	PHAT & WHITNEY	678.0'
11.	CHUCK WAGLEY (700)	666.0'	26.	JET PROP EXPRESS/AVIATION/AVIATION SERVICES, INC.	664.4'	41.	WARFIELD	669.1'	56.	AVIATION AIR TRAVEL/AVIATION HELICOPTERS/DASH-BLANK HIRE, INC./AVIATION TECHNOLOGY CORP./CHICKS AIRCRAFT INTERIORS/CLUB EXECUTIVE AVIATION/CLUB AVIATION/SPIRIT CORP.	667.0'
12.	CHUCK WAGLEY (800)	665.0'	27.	PORT-A-PART	668.2'	42.	UNIONVILLE, INC./AMERSTAR JET CENTER/CHL AIR PATROL/STRAWEL AVIATION/TED HEIDEL & CO./UNDERWOOD INSTRUMENT SERVICES/UNITED BEECHCRAFT	668.0'	57.	WEST PRODUCTS	668.7'
13.	FLITE ELECTRONICS/HENLEY AIRCRAFT SERVICES	667.0'	28.	BOY WOOD AVIATION (PORT-A-PART)	668.0'	43.	HERDICK BEECHCRAFT 2	672.2'	58.	SHANAHAN FLIGHT MUSEUM	667.7'
14.	AIR BEN AVIATION/CENTER-LINE AVIATION	662.4'	29.	1000 SERVICES HANGAR	654.4'						
15.	ADDISON FLIGHT TRAINING CENTER	669.2'									

**SPONSOR APPROVAL**

TOWN OF ADDISON \_\_\_\_\_ DATE \_\_\_\_\_

FEDERAL AVIATION ADMINISTRATION \_\_\_\_\_ DATE \_\_\_\_\_

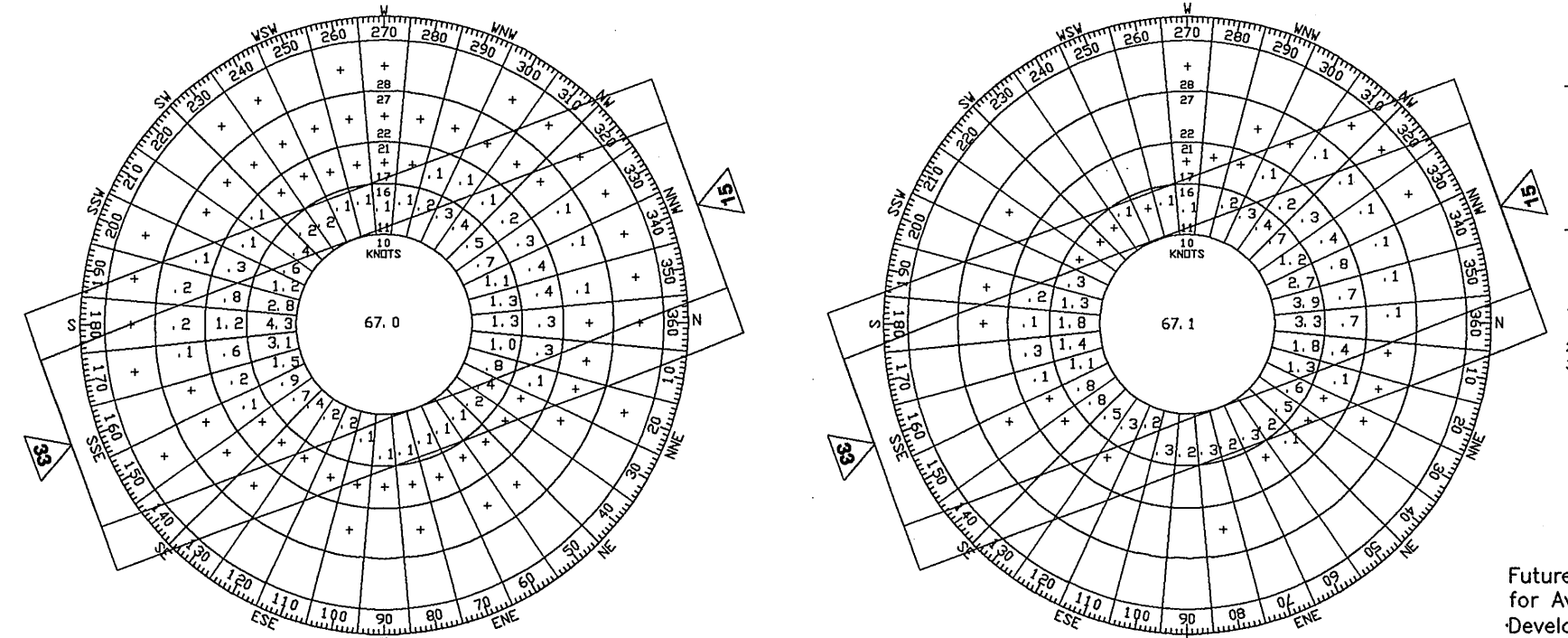

**ALL WEATHER WINDROSE**  
 10.5-KNOT CROSSWIND 16-KNOT CROSSWIND  
 R/W 15/33 95.6% 99.6%

**IFR WINDROSE**  
 10.5-KNOT CROSSWIND 16-KNOT CROSSWIND  
 R/W 15/33 95.6% 99.6%

SOURCE: NATIONAL OCEANIC AND ATMOSPHERIC ADMINISTRATION, NATIONAL CLIMATIC DATA CENTER  
 STATION: DALLAS, TEXAS  
 PERIOD OF RECORD: 1986-1995

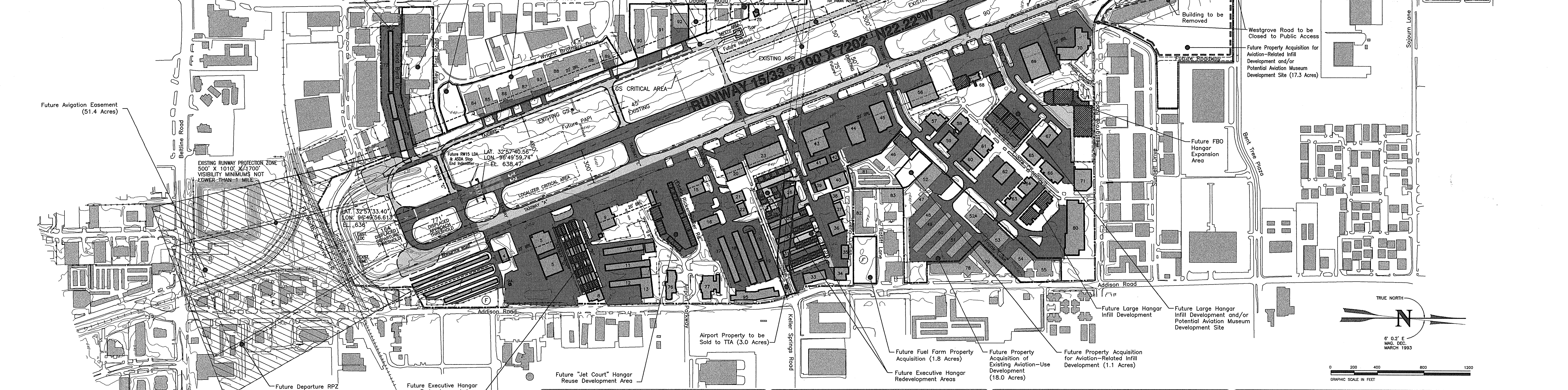

**NON-STANDARD CONDITIONS**

ITEM	AVIATION DESIGN GROUP	STANDARD	NON-STANDARD COND.	REMARKS	APPROVAL DATE
RUNWAY 33 SAFETY AREA LENGTH	D-II	1000'	1000'	IMPLEMENT DECLARED DIST. STD.	
RUNWAY 33 OBJECT FREE AREA LENGTH	D-II	1000'	1000'	IMPLEMENT DECLARED DIST. STD.	
RUNWAY 15 SAFETY AREA LENGTH	D-II	1000'	120'	IMPLEMENT SUBSURFACE DRAINAGE/GRADING PROJECT	

**PROPOSED MODIFICATION OF STANDARDS**

ITEM	AVIATION DESIGN GROUP	STANDARD	MODIFICATION	REMARKS	APPROVAL DATE
RUNWAY CENTERLINE TO HOLDLINE	D-II	250'	250'		

**DECLARED DISTANCES**

ITEM	RUNWAY 15	RUNWAY 33
TAKEOFF RUN AVAILABLE (TORA)	7038'	7100'
TAKEOFF DISTANCE AVAILABLE (TODA)	7038'	7100'
ACCELERATE-STOP DISTANCE AVAILABLE (ASDA)	6507'	7202'
LANDING DISTANCE AVAILABLE (LDA)	5528'	6431'

**REVISIONS**

No.	Date

**RUNWAY DATA**

ITEM	EXISTING	FUTURE
RUNWAY WIDTH AND LENGTH	844' x 100'	844' x 100'
RUNWAY LIGHTING	MRL	MRL
RUNWAY MARKING	PRECISION	PRECISION
RUNWAY SAFETY AREA	500' x 863'	500' x 863'
RUNWAY OBJECT FREE AREA	800' x 8510'	800' x 8510'
RUNWAY OBSTACLE FREE ZONE	NO OBST. PENETRATIONS	NO OBST. PENETRATIONS
INSTRUMENT RUNWAY	YES	YES
NAVIGATIONAL AIDS	ILS/LOC/MDVR	PR/LS/LOC/MDVR
LANDING AIDS	VAS/MALS/R	VAS/MALS/R/PAPI
APPROACH SURFACES	50:1/50:1	50:1/50:1
APPROACH VISIBILITY MINIMUMS	1 MILE/1 MILE	1/4 MILE/1/4 MILE
THRESHOLD STOPPING CRITERIA	NO OBST. PENETRATIONS	NO OBST. PENETRATIONS
PAVEMENT STRENGTH (IN 1000 LBS.)	R02, 100S, 100T	R02, 100S, 100T
PAVEMENT TYPE	ASPHALT	ASPHALT
EFFECTIVE RUNWAY GRADE (%)	0.03	0.03
± ALL WEATHER WIND COVERAGE (16/103 INCHES)	98.8/95.6	98.8/95.6
FAR PART 77 CATEGORY	P/PI	P/PI
AIRCRAFT REFERENCE CODE (ARC)	0	0
RUNWAY LINE-OF-SIGHT	CRITERIA MET	CRITERIA MET
CRITICAL AIRCRAFT	CRITERIA MET	CRITERIA MET
TOUCHDOWN ZONE ELEVATION	645'/644'	645'/644'

**AIRPORT DATA**

ITEM	EXISTING	FUTURE
AIRPORT ELEVATION (AMSL)	644'	644'
AIRPORT REFERENCE POINT (ARP)	LAT. 32° 56' 08.81" N LONG. 96° 50' 11.21" W	LAT. 32° 56' 08.81" N LONG. 96° 50' 11.21" W
MEAN MAX. TEMP. HOTTEST MONTH	96.1°F	96.1°F
AIRPORT PROPERTY (ACRES)	368	445.3
UNICOM (MHz)	122.950	122.950
NPIAS CATEGORY	RELEVER	RELEVER
CONTROL TOWER (MHz)	126.0	126.0

**LAYOUT PLAN LEGEND**

ITEM	EXISTING	FUTURE
BUILDING RESTRICTION LINE	---	---
AIRPORT PROPERTY LINE	---	---
FENCE	---	---
AVIGATION EASEMENT	---	---
RUNWAY PROTECTION ZONE	---	---
BUILDINGS	---	---
AIRFIELD PAVEMENT	---	---
FUEL STORAGE	---	---
ROTATING BEACON	---	---
LIGHTED WIND CONE & SEGMENTED CIRCLE	---	---
PRECISION APPROACH PATH INDICATOR (PAPI)	---	---
RUNWAY END IDENTIFIER LIGHTS (REILS)	---	---
VISUAL APPROACH SLOPE INDICATOR (VASI)	---	---
THRESHOLD LIGHTS (DISPLACED THRESHOLD LIGHTS)	---	---
HELICOPTER TOUCHDOWN AND LIFT-OFF AREA (TLOF)	---	---
WINDCONE	---	---

NOTE: 1. THIS DRAWING SHOULD NOT BE USED AS A STANDARD FOR PLANNING OR DESIGN.  
 2. BASE MAP PROVIDED BY AERIAL DATA SERVICE, TULSA, OKLAHOMA (SEPT. 1995).  
 3. MAGNETIC DECLINATION TAKEN FROM 1993 AIRPORT LAYOUT PLAN BY GREINER, INC., FORT WORTH, TEXAS.  
 4. HORIZONTAL COORDINATE DATUM IS BASED ON NAD83.  
 5. RUNWAY THRESHOLD LAT/LONG INFORMATION TAKEN FROM OC 768 ADDISON AIRPORT, DALLAS, TEXAS (DEC. 1993).  
 6. RUNWAY PAVEMENT END LAT/LONG INFORMATION CALCULATED USING "GEODES V2.52" COMPUTER PROGRAM.  
 7. RUNWAY PROTECTION ZONE (RPZ) PLAN & PROFILE DRAWINGS FOR ROADWAY/RAILROAD CLEARANCE INFORMATION.

**ADDISON AIRPORT**  
 ADDISON, TEXAS

**AIRPORT LAYOUT PLAN**

Barnard Dunkelberg & Company  
 Tulsa, Oklahoma

FIGURE NUMBER: \_\_\_\_\_  
 METRIC SCALE: \_\_\_\_\_  
 SCALE: 1" = 400'  
 DATE: MARCH, 1997  
 DRAWING NUMBER: \_\_\_\_\_

FF-16  
BD 3/97