

LAT. 32°57'40.56"
LON. 96°49'59.74"
EL. 638.47'

Future RW 15
LDA & ASDA Stop
End Identifier Lights

164" DISPLACED DEPARTURE THRESHOLD

771' DISPLACED APPROACH THRESHOLD

PERIMETER ROAD

Addison Road

Future "Jet Court" Hangar Reuse Development Area

20' STRUCTURE HEIGHT BUILDING RESTRICTION LINE

Future Executive Hangar Redevelopment Area

TAXIWAY DIMENSIONAL STANDARDS

ITEM	AIRPLANE DESIGN GROUP	
	I	II
TAXIWAY WIDTH	25' [7.5m]	35' [10.5m]
TAXIWAY EDGE SAFETY MARGIN	5' [1.5m]	7.5' [2.25m]
TAXIWAY SHOULDER WIDTH	10' [3m]	10' [3m]
TAXIWAY SAFETY AREA WIDTH	49' [15m]	79' [24m]
TAXIWAY OBJECT FREE AREA WIDTH	89' [27m]	131' [40m]
TAXILANE OBJECT FREE AREA WIDTH	79' [24m]	115' [35m]

REVISIONS

No.	Date

BUILDING LEGEND

#	TENANT OR OWNER	TOP ELEVATION	#	TENANT OR OWNER	TOP ELEVATION
1.	T-HANGAR (200)	848.5'	16A.	AIRPORT FLYING SCHOOL/OWENS AVIATION	855.2'
2.	T-HANGAR (400)	848.1'	16B.	POST-OFFICES (2)	857.9'
3.	T-HANGAR (200)	850.9'	17.	PATIO HANGAR (1500)	857.9'
4.	CRON AVIATION SERVICES	668.9'	18.	PATIO HANGAR (1400)	857.9'
5A.	SKYTECH AVIATION, INC.	704.9'	26.	FIRE DEPARTMENT	678.9'
5B.	AGGROUP	704.9'	27.	POLICE DEPARTMENT	681.8'
6.	T-HANGAR (200) (TO BE REMOVED)	855.4'	20.	WALTER FULLER AIRCRAFT SALES/AIRCRAFT WELDING & SHEET METAL CO./GRUBBS AVIATION/CHARTER AVIATION	858.8'
7.	T-HANGAR (200) (TO BE REMOVED)	853.8'	21.	JET 10 HANGAR	868.2'
8.	ONEFLIGHT HELICOPTERS, INC.	687.4'	22.	JET 1 & 2 HANGAR	867.2'
9.	ONEFLIGHT HELICOPTERS, INC.	687.5'			
10.	PATIO HANGAR	857.2'			
11.	CHUCK WAGLEY (200)	860.8'			
12.	HOLEY AIRCRAFT SERVICES	867.8'			
13A.	FLUTE ELECTRONICS	867.8'			
13B.	HOLEY AIRCRAFT SERVICES	867.8'			
14.	ARI BEN AVIATOR	852.4'			
15.	CENTRALINE AVIATION	868.2'			

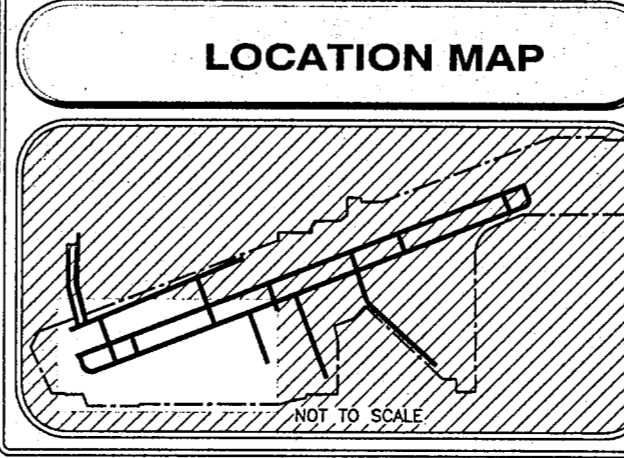
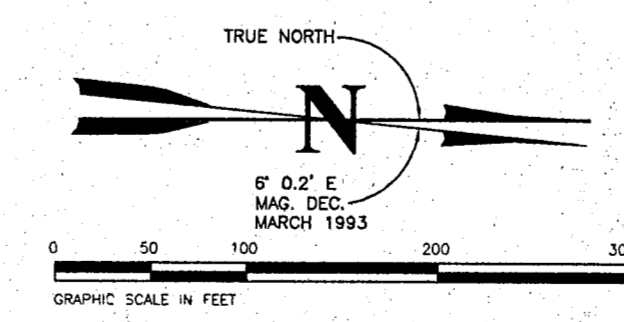

LAYOUT PLAN LEGEND

ITEM	EXISTING	FUTURE
BUILDING RESTRICTION LINE	---	---
AIRPORT PROPERTY LINE	---	---
FENCE	---	---
AVIGATION EASEMENT	---	---
RUNWAY PROTECTION ZONE	---	---
BUILDINGS	---	---
AIRFIELD PAVEMENT	---	---
FUEL STORAGE	---	---
BEACON	+	+
LIGHTED WIND CONE & SEGMENTED CIRCLE	+	+
PRECISION APPROACH PATH INDICATOR(PAPI)	+	+
RUNWAY END IDENTIFIER LIGHTS(REILS)	•	•

NOTE: THIS DRAWING SHOULD NOT BE USED AS A STANDARD FOR PLANNING OR DESIGN.

ADDISON AIRPORT
ADDISON, TEXAS

SOUTHEAST AREA PLAN

Barnard Dunkelberg & Company
Tulsa, Oklahoma

FIGURE NUMBER: 5 OF 12
METRIC SCALE: 1" = 100'
DATE: JUNE, 1997
DRAWING NUMBER: 5 OF 12