

BUILDING LEGEND

#	TENANT OR OWNER	TOP ELEVATION	#	TENANT OR OWNER	TOP ELEVATION	#	TENANT OR OWNER	TOP ELEVATION	#	TENANT OR OWNER	TOP ELEVATION
1.	T-HANGER "D" (000)	688.2	18A.	AMPHIBIOUS SCHOOL/OWNERS HANGAR	688.2	31.	PHOTO HANGAR (1800)	696.2	47.	CREW/ART AREA SERVICE	687.2
2.	T-HANGER "D" (000)	688.2	18B.	PORT-O-PORTS (3)	688.2	32.	H&L & HAVES (1800)	696.2	48.	FRIENDLY AVIATION	687.2
3.	T-HANGER "D" (000)	688.2	17.	PHOTO HANGAR (1500)	687.2	33.	FLAPS/LONG SHOTS/LIMITZ	686.0	49.	FRIENDLY AVIATION	688.4
4.	CRASH AVIATION SERVICES	688.2	18.	PHOTO HANGAR (1400)	687.2	34.	AMERICAN FLYERS	685.4	50.	FRIENDLY AVIATION	687.2
5A.	SEITECH AMAROK, INC.	708.2	19.	T-HANGER "D" (000)	681.2	35.	TOY SHOP	685.0	51.	FRIENDLY AVIATION	687.2
6A.	AMPHIBIOUS	708.2	20.	WALTER FULLER AIRCRAFT SALES/AVIATION WELDING & SHEET METAL CO./ORANGE AVIATION/DYNAMIC AVIATION	686.5	36.	LEONARD HANGAR	683.2	52.	CREW/ART AREA SERVICE	684.4
7.	T-HANGER "D" (TO BE REMOVED)	683.2	21.	JET 10 HANGAR	686.2	37.	CARTER CROWLEY	683.2	53.	WELDON AIR/UNITED STATES CUSTOMS OFFICE	688.2
8.	OMNIFLIGHT HELICOPTERS, INC.	687.4	22.	JET 1 & 2 HANGAR	687.4	38.	AM-O SPECIALISTS	687.2	54.	FRIENDLY AVIATION	687.2
9.	PHOTO HANGAR	687.2	23.	STEIN AIR	687.4	39.	JET 1 "D" CITY	686.1	55.	PRATT & WHITNEY	678.2
10.	CRASH RECOVERY (000)	688.2	24.	PHOTO HANGAR (1800)	687.2	40.	ROCK PROOF	687.2	56.	CO-OP HANGAR B	684.4
11.	HEBELY AIRCRAFT SERVICE	687.2	25.	REMOVED	686.2	41.	325 PROPERTIES	684.8	57.	CO-OP HANGAR A	680.2
12A.	FUELELECTRONICS	687.2	26.	REMOVED	684.4	42.	WIREFIELD	686.1	58.	WELDON AIR/AVIATION	687.2
13A.	FUELELECTRONICS	687.2	27.	REMOVED	686.2	43.	CANAWAUGH FLIGHT MUSEUM	686.2	59.	EXCLUSIVE WEST/DELANO JOHNSON	677.2
14A.	AVIATION SERVICES	687.2	28.	REMOVED	686.2	44.	MERCURY AIR SERVICES/AMERSTAR	672.2	60.	BELTWAY CONSTRUCTION	686.4
15.	GENERAL AVIATION	688.2	29.	T-HANGER "D" (1100)	688.4	45.	MERCURY AIR SERVICES 3/INSTRUMENT SERVICES	673.2	61.	BERRY, REYNOLDS, WILLIAMS HANGAR	682.8
			30.	T-HANGER "D" (1100)	688.4	46.	FOSTER EDWARDS AIRCRAFT COMPANY	674.2	62.	CONCOURSE PLAZA	682.8
						47.	CREW/ART AREA SERVICE	687.2	63.	EXCLUSIVE WEST/DELANO JOHNSON	677.2
						48.	FRIENDLY AVIATION	687.2	64.	ADDITION LOCKER	684.2
						49.	FRIENDLY AVIATION	688.4	65.	TEX-AR PARTS	683.2
						50.	FRIENDLY AVIATION	687.2	66.	ADDITION CAR CARE CENTER	681.2
						51.	FRIENDLY AVIATION	685.4	67.	ARTEX TOOL	684.2
						52.	CREW/ART AREA SERVICE	684.4	68.	ADDITION AVIATION	687.2
						53.	LEONARD HANGAR	683.2	69.	WELDON AIR/UNITED STATES CUSTOMS OFFICE	688.2
						54.	FRIENDLY AVIATION	687.2	70.	MELJON AIR/AVIATION	677.2
						55.	PRATT & WHITNEY	678.2	71.	ITALX	683.2
						56.	CO-OP HANGAR B	684.4	72.	CO-OP HANGAR C	649.2
						57.	CO-OP HANGAR A	680.2	73.	CO-OP HANGAR B	684.4
						58.	WELDON AIR/AVIATION	687.2	74.	CO-OP HANGAR A	680.2
						59.	EXCLUSIVE WEST/DELANO JOHNSON	677.2	75.	AIR TRAFFIC CONTROL TOWER	687.2
						60.	BELTWAY CONSTRUCTION	686.4	76.	FIRE DEPARTMENT	678.2
						61.	BERRY, REYNOLDS, WILLIAMS HANGAR	682.8	77.	POLICE DEPARTMENT	681.2
						62.	CONCOURSE PLAZA	682.8	78.	ADDITION TOWER/OFFICE BUILDING	775.2
						63.	EXCLUSIVE WEST/DELANO JOHNSON	677.2	79.	PARKING GARAGE	686.1

SPONSOR APPROVAL

TOWN OF ADDISON _____ DATE _____

FEDERAL AVIATION ADMINISTRATION _____ DATE _____

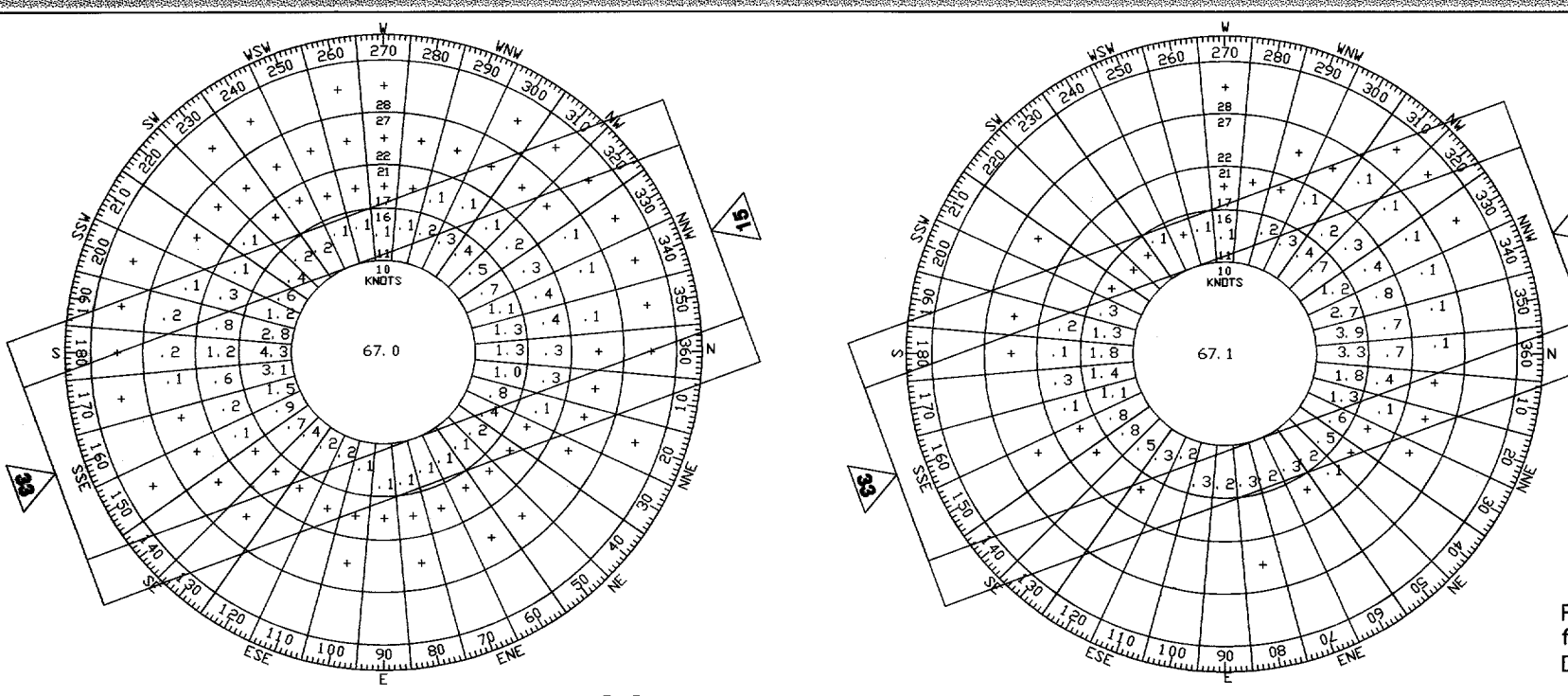

ALL WEATHER WINDROSE
 10.5-KNOT CROSSWIND 16-KNOT CROSSWIND
 R/W 15/33 95.6% 99.6%

IFR WINDROSE
 10.5-KNOT CROSSWIND 16-KNOT CROSSWIND
 R/W 15/33 95.6% 99.6%

SOURCE: NATIONAL OCEANIC AND ATMOSPHERIC ADMINISTRATION, NATIONAL CLIMATIC DATA CENTER, STATION: DALLAS, TEXAS, PERIOD OF RECORD: 1986-1995

IFR WIND COVERAGE SUMMARY

WIND COVERAGE PROVIDED UNDER IFR CONDITIONS 10-16 KNOT MAXIMUM CROSSWIND, 15-30 KNOT TAILWIND TO MAXIMUM HEADWIND	WIND COVERAGE PROVIDED UNDER IFR CONDITIONS 16-19 KNOT MAXIMUM CROSSWIND, 15-30 KNOT TAILWIND TO MAXIMUM HEADWIND
R/W 15/33 95.6%	79.9%
R/W 33/3 66.3%	90.1%
R/W 15 & 33 99.6%	96.1%

SOURCE: NATIONAL OCEANIC AND ATMOSPHERIC ADMINISTRATION, NATIONAL CLIMATIC DATA CENTER, STATION: DALLAS, TEXAS, PERIOD OF RECORD: 1986-1995

¹ CROSSWIND OF LESS THAN 1,000 FEET, BUT EQUAL TO OR GREATER THAN 250 FEET AND/OR VISIBILITY LESS THAN THREE MILES, BUT EQUAL TO OR GREATER THAN ONE MILE.

² RUNWAY IS EQUIPPED WITH INSTRUMENTS.

³ 15-30-KNOT TAILWIND IS CONSIDERED MAXIMUM FOR GENERAL AVIATION AIRCRAFT IN APPROACH CATEGORIES A AND B WHEN LANDING UNDER IFR CONDITIONS.

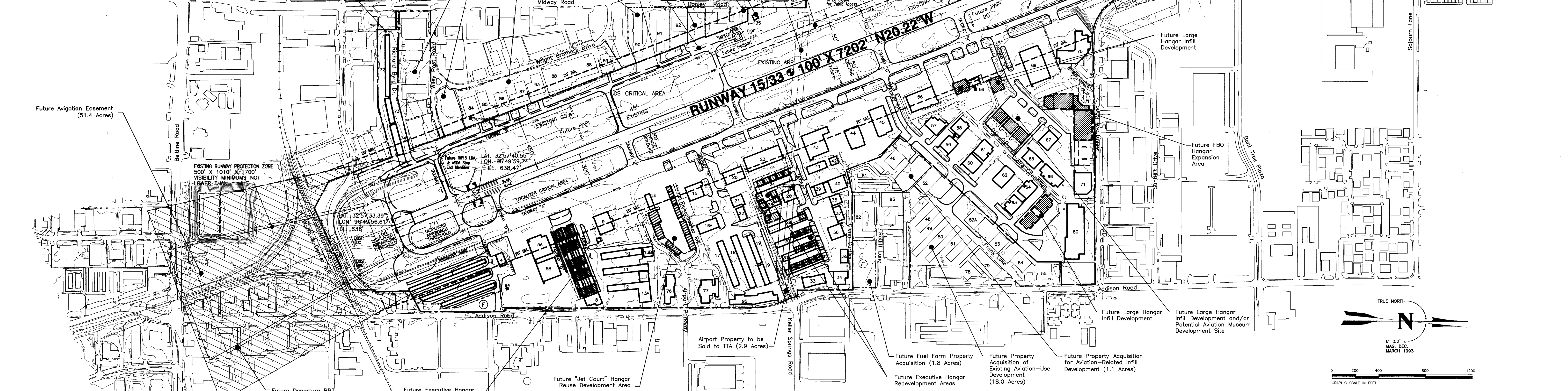

DECLARED DISTANCES

ITEM	RUNWAY 15	RUNWAY 33
TAKEOFF RUN AVAILABLE (TORA)	7038'	7100'
TAKEOFF DISTANCE AVAILABLE (TODA)	7038'	7100'
ACCELERATE-STOP DISTANCE AVAILABLE (ASDA)	6507'	7202'
LANDING DISTANCE AVAILABLE (LDA)	5528'	6431'

REVISIONS

No.	Date

RUNWAY DATA

	EXISTING	FUTURE
RUNWAY WIDTH AND LENGTH	100' X ()	100' X ()
RUNWAY LIGHTING	MIRL	MIRL
RUNWAY MARKING	PRECISION	PRECISION
RUNWAY SAFETY AREA	500' X 8637'	500' X 8637'
RUNWAY OBJECT FREE AREA	800' X 8510'	800' X 8510'
RUNWAY OBSTACLE FREE ZONE	NO OBJECT PENETRATIONS	NO OBJECT PENETRATIONS
INSTRUMENT RUNWAY	YES	YES
MANUAL/NOISY	US/MALS/MSR	US/MALS/MSR/PAPI
LANDING AIDS	501/501	501/501
APPROACH SURFACES	1 MILE/1 MILE	1 MILE/1/4 MILE
THRESHOLD SITING CRITERIA	NO OBJECT PENETRATIONS	NO OBJECT PENETRATIONS
PAVEMENT STRENGTH (IN 1000 LBS.)	805, 1000, 160T	805, 1000, 160T
PAVEMENT TYPE	ASPHALT	ASPHALT
EFFECTIVE RUNWAY GRADIENT %	0.03	0.03
% ALL WINDS WIND DENSITY (14/103 KNOTS)	99.6/95.6	99.6/95.6
FAR PART 77 CATEGORY	P1/P1	P1/P1
AIRPORT REFERENCE CODE (ARC)	D-II	D-II
RUNWAY LINE-OF-SIGHT CRITERIA	CRITERIA MET	CRITERIA MET
CRITICAL AIRCRAFT	GRANAM 043/644	GRANAM 043/644
TOUCHDOWN ZONE ELEVATION	643/644	643/644

(*) Refer to Declared Distances table.

AIRPORT DATA

ITEM	EXISTING	FUTURE
AIRPORT ELEVATION (AMSL)	644'	644'
AIRPORT REFERENCE POINT (ARP)	LAT. 32° 58' 06.81" N, LONG. 96° 50' 11.11" W	LAT. 32° 58' 04.81" N, LONG. 96° 50' 11.11" W
MEAN MAX. TEMP. HOTTEST MONTH	96.1°F	96.1°F
AIRPORT PROPERTY (ACRES)	368	424
UNICOM (MHz)	122.950	122.950
NPIAS CATEGORY	RELEVER	RELEVER
CONTROL TOWER (MHz)	126.0	126.0

LAYOUT PLAN LEGEND

ITEM	EXISTING	FUTURE
BUILDING RESTRICTION LINE	BR	BR
AIRPORT PROPERTY LINE	P	P
FENCE	X	X
AVIGATION EASEMENT	E	E
RUNWAY PROTECTION ZONE	R	R
BUILDINGS	B	B
AIRFIELD PAVEMENT	PA	PA
FUEL STORAGE	F	F
ROTATING BEACON	★	★
LIGHTED WIND CONE & SEGMENTED CIRCLE	WC	WC
PRECISION APPROACH PATH INDICATOR (PAPI)	P	P
RUNWAY END IDENTIFIER LIGHTS (REILS)	R	R
VISUAL APPROACH SLOPE INDICATOR (VASI)	V	V
THRESHOLD LIGHTS (DISPLACED THRESHOLD LIGHTS)	T	T
HELICOPTER TOUCHDOWN AND LIFT-OFF AREA (TLOF)	TLOF	TLOF
WINDCONE	W	W

NOTE: 1. THIS DRAWING SHOULD NOT BE USED AS A STANDARD FOR PLANNING OR DESIGN.
 2. BASE MAP PROVIDED BY AERIAL DATA SERVICE, TULSA, OKLAHOMA (EXPT. 1995).
 3. MAGNETIC DECLINATION TAKEN FROM 1993 AIRPORT LAYOUT PLAN BY GREINER, INC., FORT WORTH, TEXAS.
 4. HORIZONTAL COORDINATE DATUM IS BASED ON NAD83.
 5. RUNWAY THRESHOLD LAT/LONG INFORMATION TAKEN FROM DC 768 ADDISON AIRPORT, DALLAS, TEXAS (DEC. 1993).
 6. REFER TO RUNWAY PROTECTION ZONE (RPZ) PLAN & PROFILE DRAWINGS FOR ROADWAY/RAILROAD CLEARANCE INFORMATION.

NON-STANDARD CONDITIONS

ITEM	APPLANE DESIGN GROUP	STANDARD	NON-STANDARD COND.	REMARKS	APPROVAL DATE
RUNWAY 33 SAFETY AREA LENGTH	D-II	1000'	450'	IMPLEMENT DECLARED DIST. STDS.	
RUNWAY 15 SAFETY AREA LENGTH	D-II	1000'	335'	IMPLEMENT DECLARED DIST. STDS.	
RUNWAY 15 SAFETY AREA LENGTH	D-II	1000'	120'	IMPLEMENT SURFACE DRAINAGE/GRADING PROJECT	
RUNWAY CENTERLINE TO HOLDLINE	D-II	250'	200'	RELOCATED EXISTING MARKINGS	

ADDISON AIRPORT
 ADDISON, TEXAS

AIRPORT LAYOUT PLAN

Barnard Dunkelberg & Company
 Tulsa, Oklahoma

FIGURE NUMBER: _____
 METRIC SCALE: _____
 SCALE: 1" = 400'
 DATE: NOVEMBER, 1997
 DRAWING NUMBER: 1 OF 12