

TAXIWAY DIMENSIONAL STANDARDS

| ITEM | AIRPLANE DESIGN GROUP | |
|--------------------------------|-----------------------|--------------|
| | I | II |
| TAXIWAY WIDTH | 25' [7.5m] | 35' [10.5m] |
| TAXIWAY EDGE SAFETY MARGIN | 5' [1.5m] | 7.5' [2.25m] |
| TAXIWAY SHOULDER WIDTH | 10' [3m] | 10' [3m] |
| TAXIWAY SAFETY AREA WIDTH | 49' [15m] | 79' [24m] |
| TAXIWAY OBJECT FREE AREA WIDTH | 89' [27m] | 131' [40m] |
| TAXIWAY OBJECT FREE AREA WIDTH | 79' [24m] | 115' [35m] |

REVISIONS

| No. | Date |
|-----|------|
| | |
| | |

BUILDING LEGEND

| # | TENANT OR OWNER | TOP ELEVATION | # | TENANT OR OWNER | TOP ELEVATION | # | TENANT OR OWNER | TOP ELEVATION | # | TENANT OR OWNER | TOP ELEVATION |
|-----|-----------------------------------|---------------|-----|--|---------------|------|------------------------|---------------|-----|-------------------------------|---------------|
| 19. | T-HANGAR '01' (000) | 691.7 | 38. | J&O SPECIALISTS | 672.8 | 52A. | CARTER CROWLEY | 675.4 | 71. | BLAK | 663.7 |
| 22. | JET 1 & 2 HANGAR | 697.2 | 39. | JET 1 '01'Y' | 666.1 | 53. | CARTER CROWLEY | 672.9 | 71. | BLAK | 663.7 |
| 23. | STEIN AIR | 697.4 | 40. | INDIAN PROP. | 697.1 | 54. | FRENCHLY AVIATION | 675.2 | 76. | ADDISON TOWER/OFFICE BUILDING | 776.7 |
| 24. | PAVO HANGAR (1800) | 697.8 | 41. | SLZ PROPERTIES | 664.9 | 55. | PROBY & WHITNEY | 675.8 | 76. | PARKING GARAGE | 665.1 |
| 25. | REMOVED | 685.2 | 42. | WHEELS | 686.1 | 57. | KITH PRODUCTS | 666.7 | 80. | WESTGROVE AIR PLAZA | 653.3 |
| 26. | REMOVED | 664.6 | 43. | MERCURY AIR SERVICES | 682.9 | 58. | ADDISON LOCKER | 667.7 | 81. | ADDISON LOCKER | 654.2 |
| 27. | REMOVED | 666.3 | 44. | MERCURY AIR SERVICES/INSTRUMENT | 672.2 | 59. | CANAWASH FLIGHT MUSEUM | 666.7 | 82. | TEX-AIR PARTS | 663.7 |
| 28. | REMOVED | 666.9 | 45. | MERCURY AIR SERVICES/INSTRUMENT SERVICES | 673.8 | 60. | CANAWASH FLIGHT MUSEUM | 666.7 | 83. | ADDISON CAR CARE CENTER | 661.7 |
| 29. | T-HANGAR '01' (000) | 654.4 | 46. | FOSTER EDWARDS AIRCRAFT COMPANY | 674.8 | 61. | CANAWASH FLIGHT MUSEUM | 670.2 | 85. | CONCOURSE PLAZA | 662.6 |
| 30. | T-HANGAR '01' (180) | 666.4 | 47. | CRESCENT REAL ESTATE | 667.8 | 62. | MONROCH AIR | 675.8 | | | |
| 31. | PAVO HANGAR (1200) | 656.2 | 48. | FRENCHLY AVIATION | 682.7 | 63. | CHERRY AIR, INC | 672.2 | | | |
| 32. | HELZ & HAYES (1300) | 666.2 | 49. | FRENCHLY AVIATION | 656.4 | 64. | DOYLE HARTMAN | 672.2 | | | |
| 33. | FLAPS/LONG SHOTS/LEADS | 686.0 | 50. | FRENCHLY AVIATION | 666.5 | 65. | METTE VASQUEZ | 672.7 | | | |
| 34. | AMERICAN FLIERS | 685.4 | 51. | FRENCHLY AVIATION | 682.9 | 66. | WESTERN INDUSTRIES | 662.9 | | | |
| 35. | TOY BOX | 683.9 | 52. | CRESCENT REAL ESTATE | 664.9 | 67. | INTERMET | 676.4 | | | |
| 36. | LONGER HANGAR | 682.2 | | | | | | | | | |
| 37. | NORTH TEXAS AIRWAY SERVICES, INC. | 663.8 | | | | | | | | | |

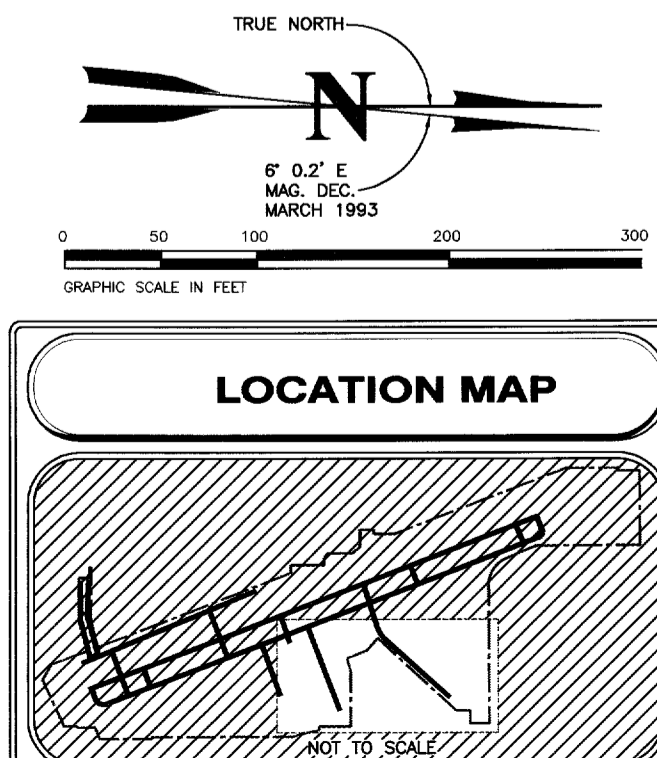

LAYOUT PLAN LEGEND

| ITEM | EXISTING | FUTURE |
|---|----------|--------|
| BUILDING RESTRICTION LINE | BR | BR |
| AIRPORT PROPERTY LINE | AP | AP |
| FENCE | F | F |
| AVIGATION EASEMENT | AE | AE |
| RUNWAY PROTECTION ZONE | RZ | RZ |
| BUILDINGS | B | B |
| AIRFIELD PAVEMENT | AP | AP |
| FUEL STORAGE | FS | FS |
| BEACON | BE | BE |
| LIGHTED WIND CONE & SEGMENTED CIRCLE | WC | WC |
| PRECISION APPROACH PATH INDICATOR(PAPI) | PAPI | PAPI |
| RUNWAY END IDENTIFIER LIGHTS(REILS) | REIL | REIL |

NOTE: THIS DRAWING SHOULD NOT BE USED AS A STANDARD FOR PLANNING OR DESIGN.

ADDISON AIRPORT
ADDISON, TEXAS

EAST AREA PLAN

Barnard Dunkelberg & Company
Tulsa, Oklahoma

FIGURE NUMBER
METRIC SCALE
SCALE 1" = 100'
DATE JUNE, 1997
DRAWING NUMBER 6 OF 12