

LEGEND

- PROPOSED RECYCLED PAVEMENT WITH 3" TYPE "D" HMAC (PG-22) OVERLAY (SEE DETAIL THIS SHEET)
- 4" HMAC PAVEMENT OVER COMPACTED SUBGRADE
- PROPOSED RECYCLED PAVEMENT WITH 2" TYPE "D" HMAC (PG-22) OVERLAY (SEE DETAIL THIS SHEET)
- ASPHALT TRANSITION (SEE DETAIL THIS SHEET)
- TAXIWAY CENTERLINE MARKING
- CONTINUOUS TAXIWAY EDGE LINE MARKING
- NON-MOVEMENT AREA
- DASHED TAXIWAY EDGE LINE

NOTES:

1. CONTRACTOR TO TAKE PRECAUTIONS TO PROTECT EXISTING POWER POLES AND HANGARS. POWER TO REMAIN IN SERVICE THROUGHOUT CONSTRUCTION.
2. THE CONTRACTOR IS RESPONSIBLE FOR COORDINATING RELOCATION OF ANY OVERHEAD UTILITIES AND GUY WIRES WITH THE APPLICABLE FRANCHISE UTILITY OWNER.
3. ALL MARKINGS SHALL BE PLACED PER FAA AC 150/5340-1J.
4. REFER TO SHEET 35 FOR STRIPING DETAILS AND REFLECTIVE MEDIA NOTES.
5. HOT MIX ASPHALT PAVEMENT SHALL BE PLACED IN ACCORDANCE WITH ITEM SP-001 IN THE TECHNICAL SPECIFICATIONS.
6. ROAD MIXED CEMENT TREATED BASE MATERIAL SHALL BE PLACED IN ACCORDANCE WITH SP-004 IN THE TECHNICAL SPECIFICATIONS.
7. DISPOSAL OF EXCESS MATERIAL DUE TO GRADING AND TRANSITIONS SHALL BE SUBSIDIARY TO 10" ROAD MIXED CEMENT TREATED BASE MATERIAL.
8. ALL GRASSED AREAS AFFECTED BY CONSTRUCTION SHALL BE RESTORED TO THEIR ORIGINAL CONDITION INCLUDING RE-SEEDING AT NO SEPARATE PAY.
9. ALL EXISTING DRAIN PIPES UNDER HANGAR DRIVEWAYS SHALL BE REMOVED AND REPLACED WITH 4-INCH SCHEDULE 80 PVC OR APPROVED EQUAL. THE FLOW LINE OF THE PIPES SHALL MATCH THE EXISTING FLOW LINE OF THE DRAINAGE SWALE. IN THE EVENT THAT THE FLOW LINE OF THE SWALE IS TOO SHALLOW TO ALLOW A MINIMUM OF TWO-INCHES OF HMAC OVER THE PIPE, THE PIPE MAY BE BURIED TO WHERE THE SPRING LINE OF THE PIPE MATCHES THE FLOW LINE OF THE SWALE. THIS ITEM SHALL BE SUBSIDIARY TO OTHER PAY ITEMS.

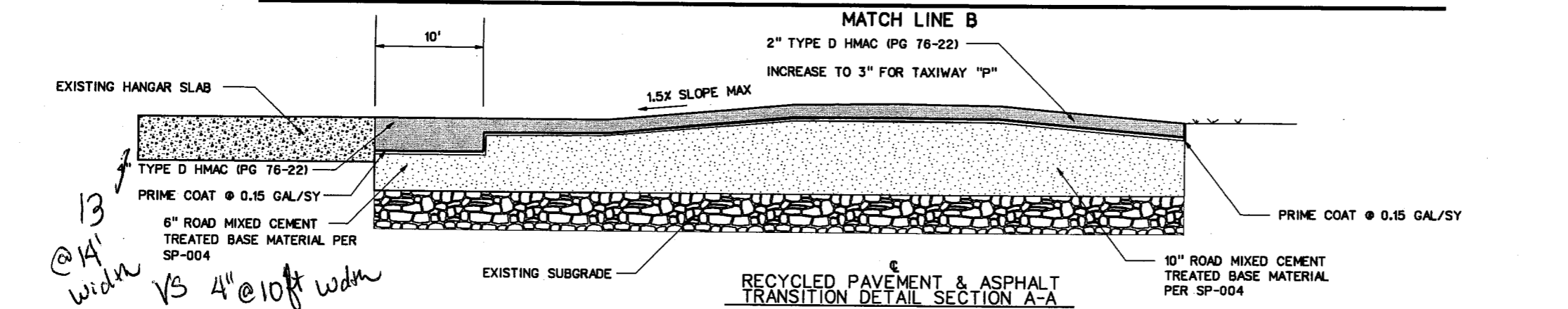
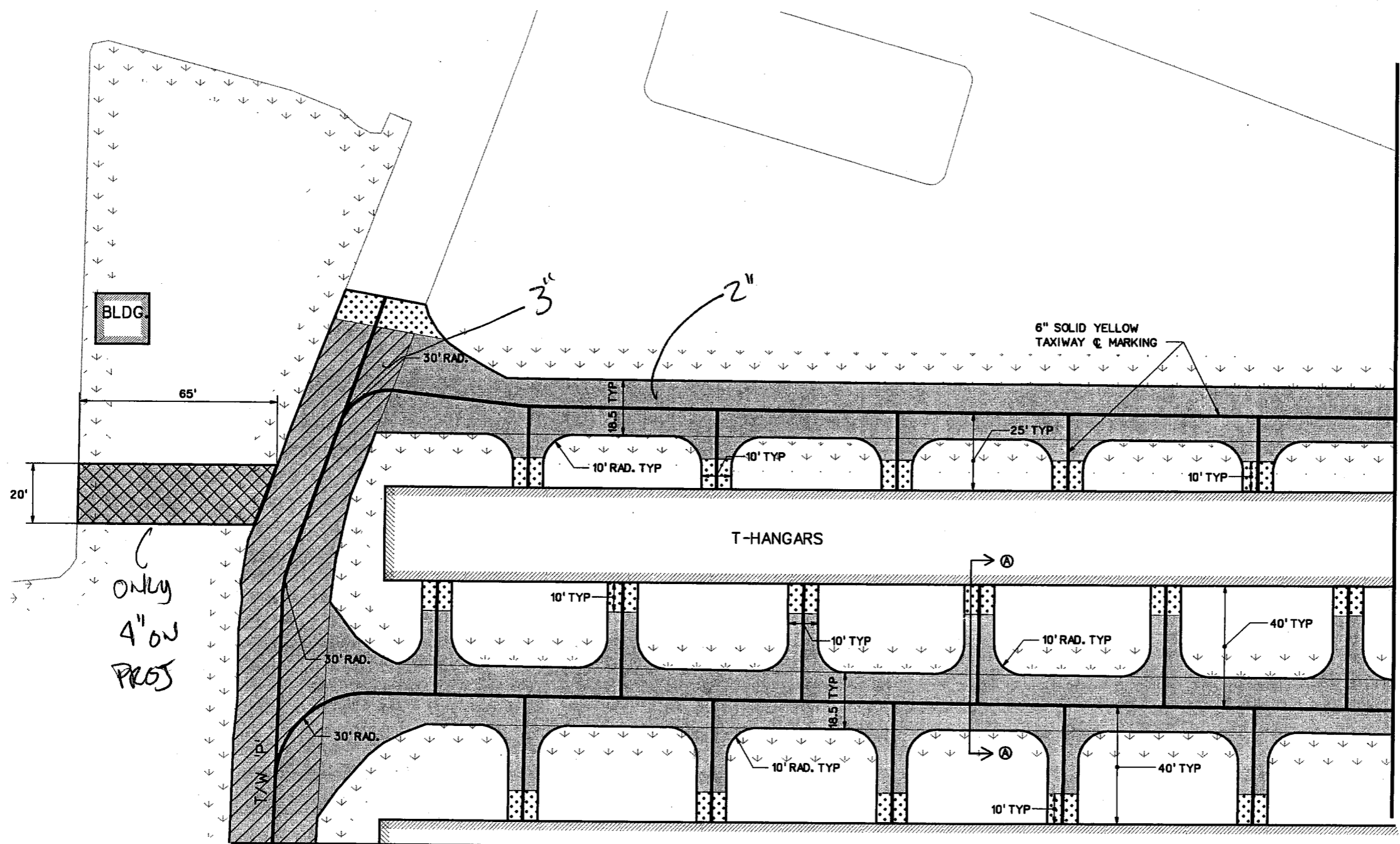

ONLY
4" ON
PROJ

13
@ 14' width VS 4" @ 10' width

27-DEC-2005 15:45 G:\41308\Cad\Sheets\rbnp08.dgn

NO.	DATE	REVISION	APPROV.	NO.	DATE	REVISION	APPROV.

NTS

Michael A. Hutchison
12/27/05

HNTB

HNTB Corporation
The HNTB Companies
Engineers Architects Planners

DESIGN CHECK DEC MAH
DRAWN CHECK CCH DEC
DATE DEC. 2005

PROJECT NO. 41308

TOWN OF ADDISON

TOWN OF ADDISON	SHEET
ADDISON AIRPORT ASPHALT PAVEMENT IMPROVEMENTS	29 OF 36
PAVING PLANS TAXIWAY "P" / T HANGAR OVERLAY	TAXIWAY "P"
TOWN OF ADDISON, TEXAS	29