

MATCH LINE SHEET E4

MATCH LINE SHEET E6

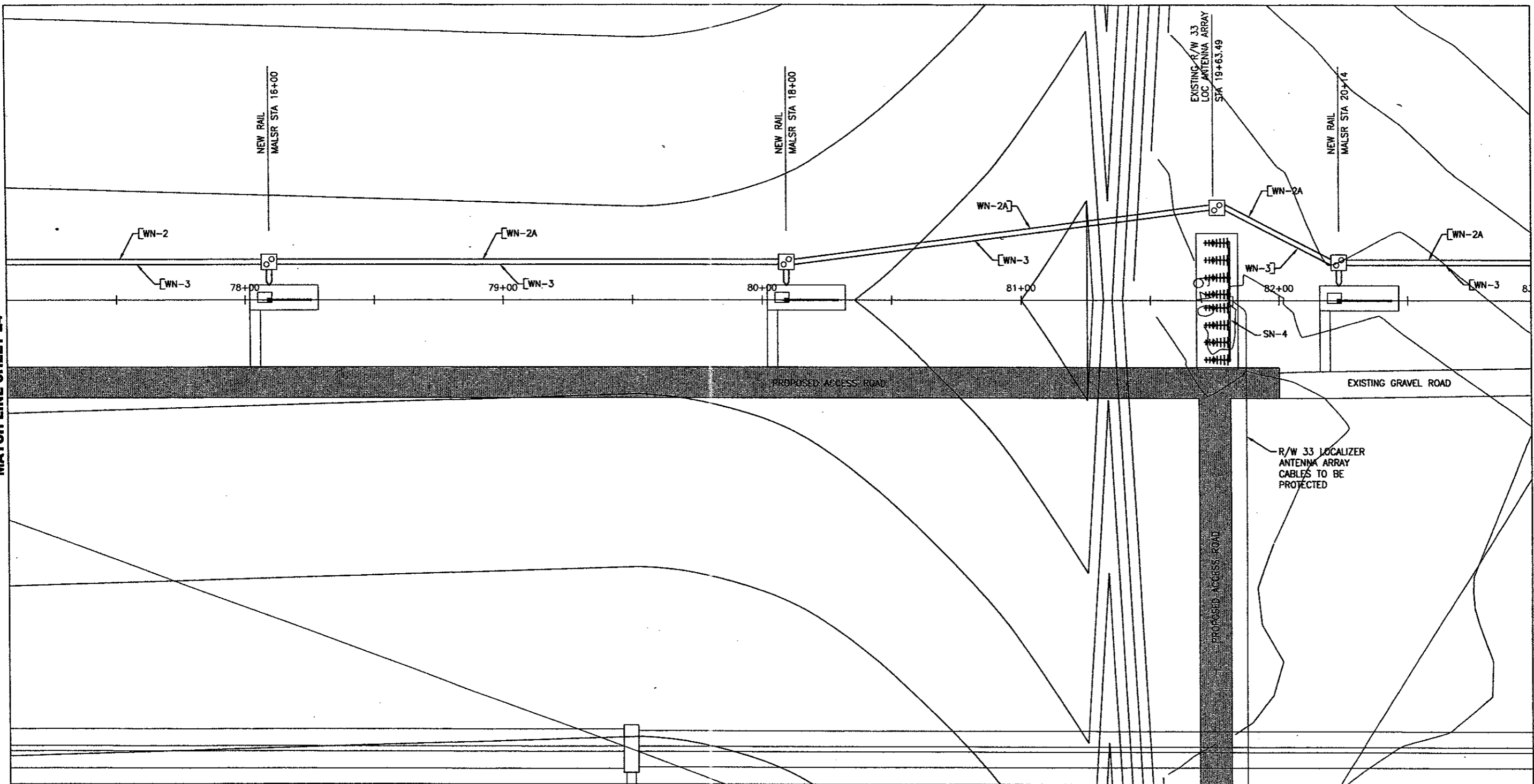

SHEET NOTES (SN-#):

1. CONTROL CABLE AND POWER CABLE SHALL NOT BE INSTALLED IN THE SAME CONDUIT.
2. SEE DETAIL SHEETS FOR CONDUIT DETAILS AT EACH STATION.
3. SEE MALSR ELECTRICAL DETAILS SHEET 1 OF 2.
4. EXISTING R/W 33 LOCALIZER ANTENNA ARRAY.

LEGEND	
	JUNCTION CAN
	2" SCH 40 PVC CONDUIT (DEB)
	JUNCTION CAN PLAZA
	CONCRETE ENCASED DUCT

WIRE NOTES (WN-#):

1. RESERVED.
2. 3-1/C #2 AWG 600V (RAIL POWER).
- 2A. 3-1/C #4 AWG 600V (RAIL POWER).
3. 6 PAIR #19 AWG 600V (RAIL CONTROL). SEE SN-1.

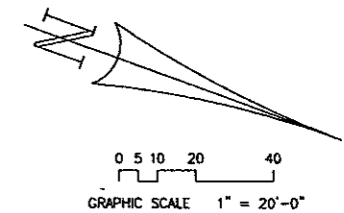

PROJECT NAME RUNWAY 15 ESA GRADING	DRAWING TITLE R/W 15 PROPOSED MALSR LAYOUT - SHEET 2 OF 4	PROJECT NO. TRACT NO. BID NO. URS NO.	REVISIONS DATE DESIGN DRAWN CHECKED SCALE:	AUTH. DATE
ADDISON AIRPORT		PRELIMINARY NOT FOR CONSTRUCTION AND NOT TO BE USED FOR ANY OTHER PROJECTS WITHOUT THE WRITTEN APPROVAL OF THE ENGINEER		
URS Greiner Woodward Clyde 4100 Armon Carter Boulevard, Suite 108 Fort Worth, TX 76165 www.urscorp.com		AVATON ALLIANCE, INC. Consulting Engineers 10000 Katy Road, Suite 100 Houston, TX 77024 www.avaton.com		
E5		DATE: 2/8/01		