

MATCH LINE SHEET E5

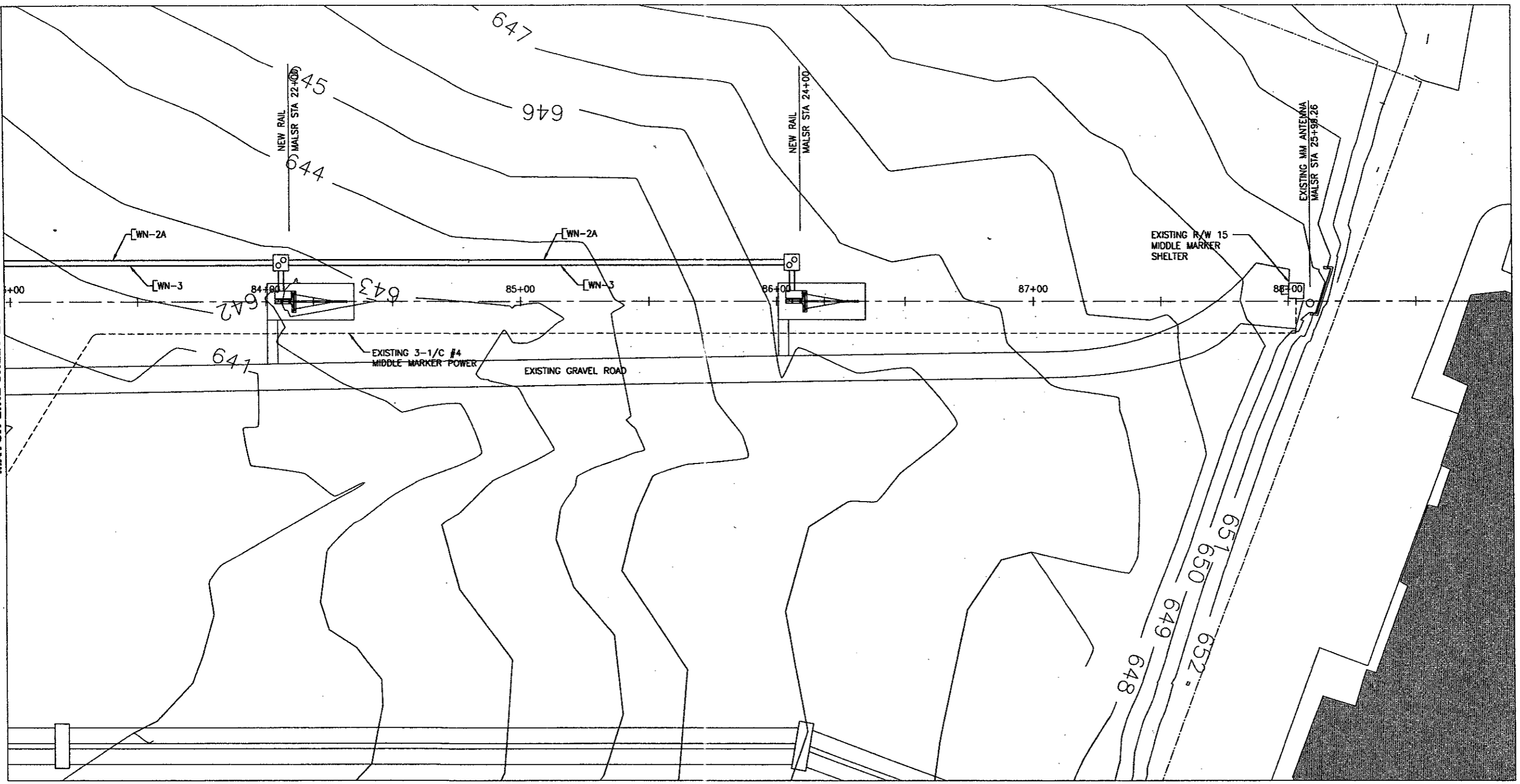

**SHEET NOTES (SN-#):**

1. CONTROL CABLE AND POWER CABLE SHALL NOT BE INSTALLED IN THE SAME CONDUIT.
2. SEE DETAIL SHEETS FOR CONDUIT DETAILS AT EACH STATION.
3. SEE MALSRS ELECTRICAL DETAILS SHEET 1 OF 2.

LEGEND	
	JUNCTION CAN
	2" SCH 40 PVC CONDUIT (DEB)
	JUNCTION CAN PLAZA
	CONCRETE ENCASED DUCT

**WIRE NOTES (WN-#):**

1. RESERVED.
2. 3-1/C #2 AWG 600V (RAIL POWER).
- 2A. 3-1/C #4 AWG 600V (RAIL POWER).
3. 6 PAIR #19 AWG 600V (RAIL CONTROL). SEE SN-1.

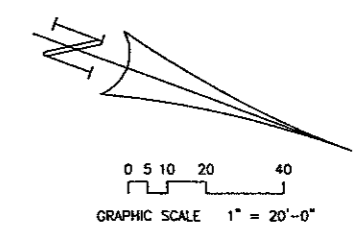

<b>PROJECT NAME</b>	<b>RUNWAY 15 ESA GRADING</b>		
<b>DRAWING TITLE</b>	<b>R/W 15 PROPOSED MALSRS LAYOUT - SHEET 3 OF 4</b>		
<b>DRAWING NO.</b>	<b>E6</b>	<b>DATE</b>	2/8/01
<b>BY</b>		<b>REVISIONS</b>	
<b>DATE</b>		<b>TBDOT NO.</b>	
		<b>BID NO.</b>	E701044.00
		<b>URRG NO.</b>	
		<b>DESIGN</b>	CHECKED
		<b>DRAWN</b>	APPROVED
		<b>SCALE</b>	
<p><b>PRELIMINARY</b> NOT FOR CONSTRUCTION WORKING DRAWING</p> <p>AVATON ALLIANCE, INC. S. S. SAYS, P.E. REGISTERED PROFESSIONAL ENGINEER AVATON ALLIANCE, INC. 4100 Arvon Carter Boulevard, Suite 108 Fort Worth, TX 76155 www.utsrscorp.com</p>			
<p><b>ADDISON AIRPORT</b></p> <p>URS Greiner Woodward Clyde Consulting Engineers AVATON ALLIANCE, INC. CONSULTING ENGINEERS</p>			