



REGISTRATION NO. F-5713

RECORD DRAWINGS
03/10/2015

REV.	DATE	DESCRIPTION	BY



ADDISON AIRPORT
ADDISON, TEXAS

RUNWAY 33 RSA IMPROVEMENTS

EMAS PAVEMENT MARKING PLAN

JOB NO.: 13081100
DATE: NOV., 2013
DESIGNED BY: BCB
DRAWN BY: BCB

BAR IS ONE INCH ON ORIGINAL DRAWING
IF NOT ONE INCH ON THIS SHEET, ADJUST SCALES ACCORDINGLY.

DRAWING NUMBER
C-106

SHEET NUMBER
23

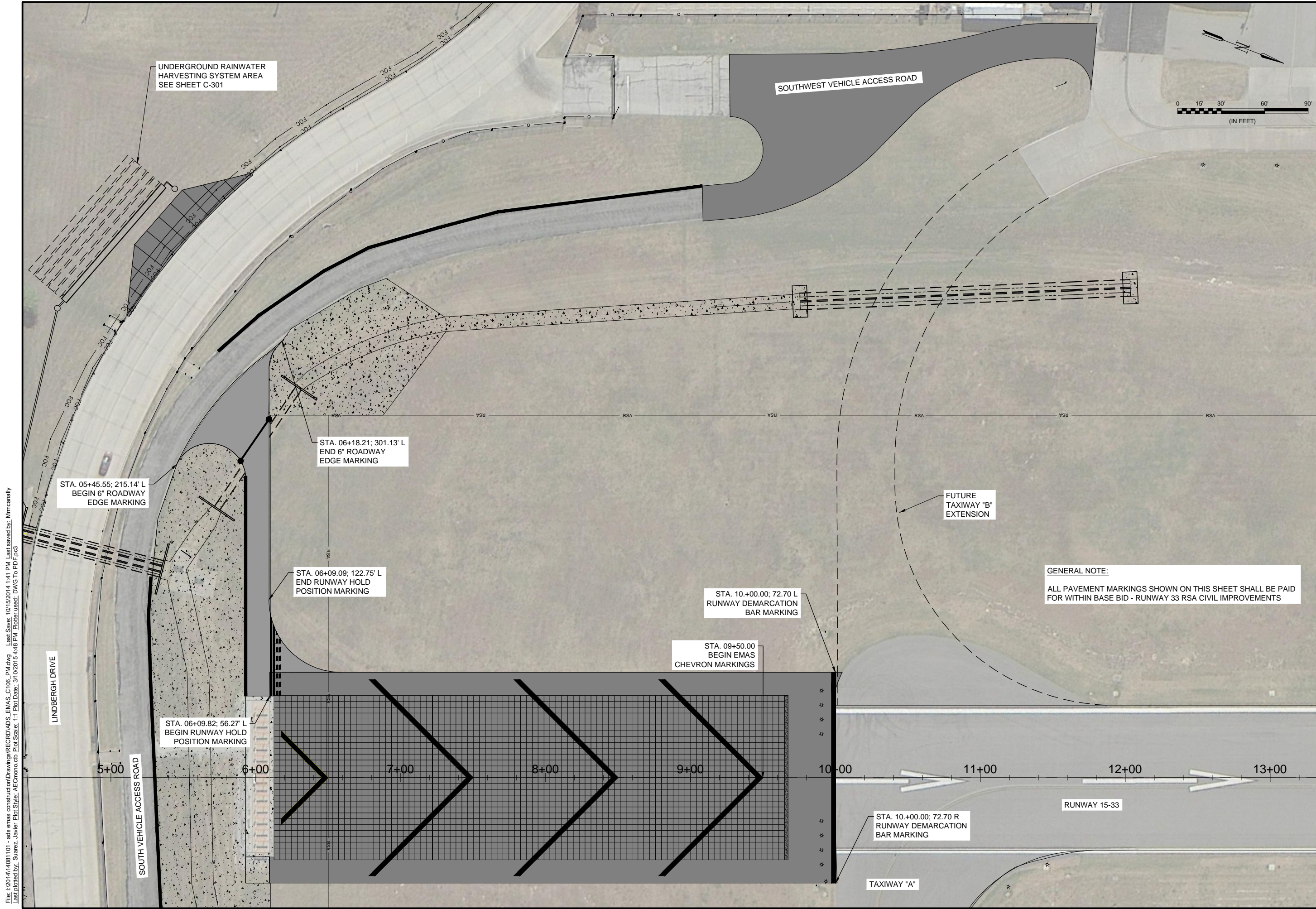

UNDERGROUND RAINWATER HARVESTING SYSTEM AREA SEE SHEET C-301

SOUTHWEST VEHICLE ACCESS ROAD

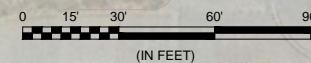

STA. 05+45.55; 215.14' L
BEGIN 6" ROADWAY
EDGE MARKING

STA. 06+18.21; 301.13' L
END 6" ROADWAY
EDGE MARKING

STA. 06+09.09; 122.75' L
END RUNWAY HOLD
POSITION MARKING

STA. 06+09.82; 56.27' L
BEGIN RUNWAY HOLD
POSITION MARKING

STA. 09+50.00
BEGIN EMAS
CHEVRON MARKINGS

STA. 10+00.00; 72.70 L
RUNWAY DEMARCATION
BAR MARKING

FUTURE
TAXIWAY "B"
EXTENSION

GENERAL NOTE:
ALL PAVEMENT MARKINGS SHOWN ON THIS SHEET SHALL BE PAID FOR WITHIN BASE BID - RUNWAY 33 RSA CIVIL IMPROVEMENTS

STA. 10+00.00; 72.70 R
RUNWAY DEMARCATION
BAR MARKING

TAXIWAY "A"

RUNWAY 15-33

File: I:\2014\14081101 - ads emas construction\Drawings\RECORD\ADS_EMAS_C106_PMD.dwg Last Save: 10/15/2014 1:41 PM Last saved by: Mmiccally
Last plotted by: Suarez, Javier Plot Style: AEC.ctb Plot Date: 3/10/2015 4:48 PM Plotter used: DWG To PDF.pc3

LINDBERGH DRIVE

SOUTH VEHICLE ACCESS ROAD

5+00

6+00

7+00

8+00

9+00

10+00

11+00

12+00

13+00