

REV.	DATE	DESCRIPTION	BY

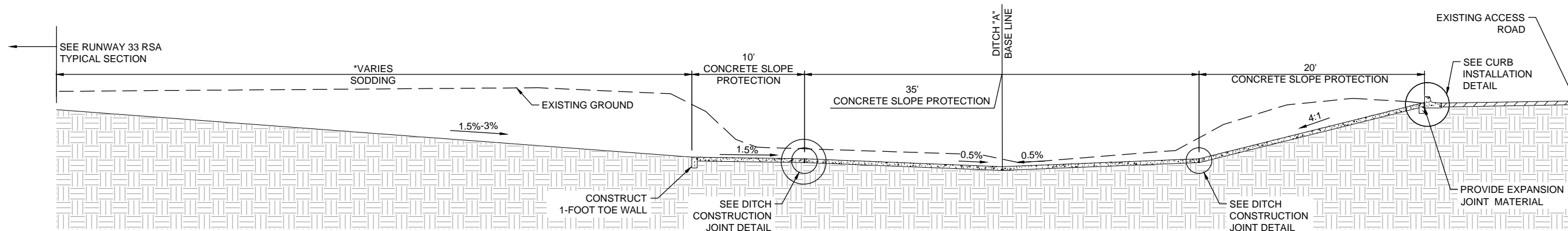

C-200  
A1  
DITCH "A" SECTION "A1"  
SCALE: NONE

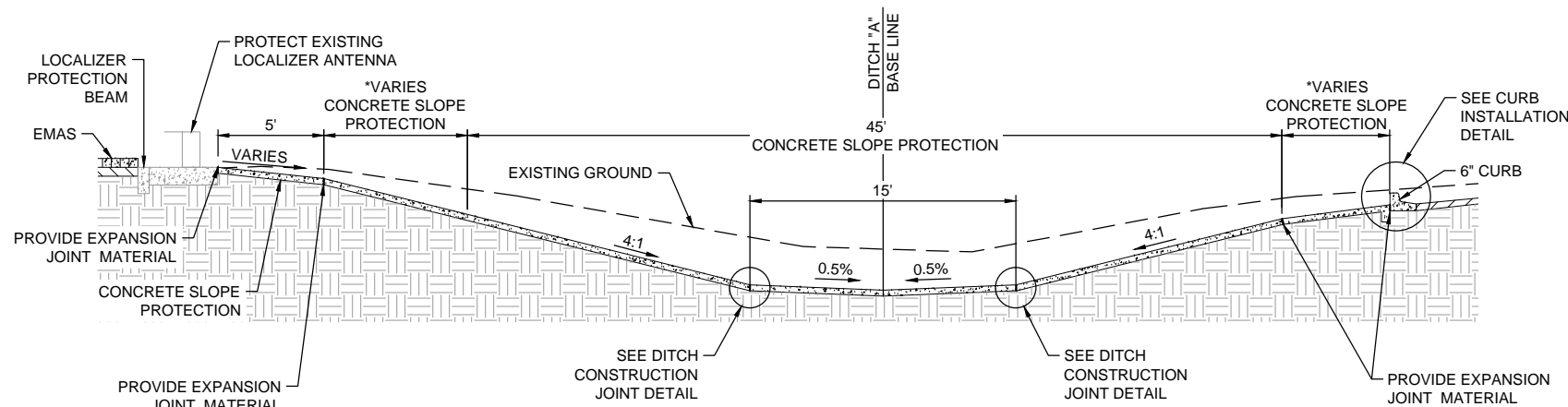

C-200  
A2  
DITCH "A" SECTION "A2"  
SCALE: NONE

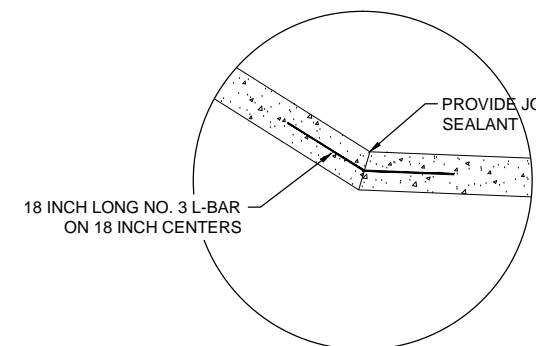

C-200  
4  
DITCH CONSTRUCTION JOINT  
SCALE: NONE

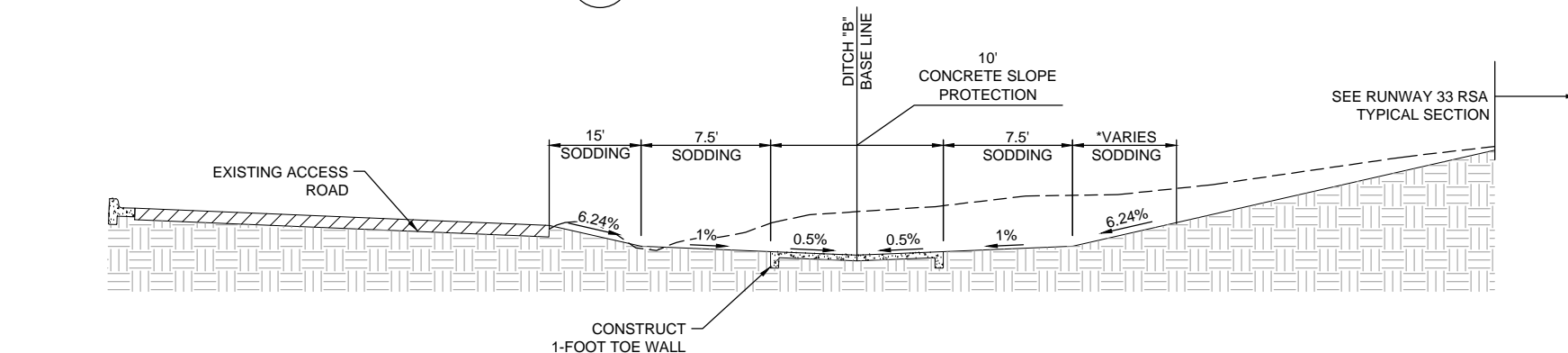

C-200  
B1  
DITCH "B" SECTION "B1"  
SCALE: NONE

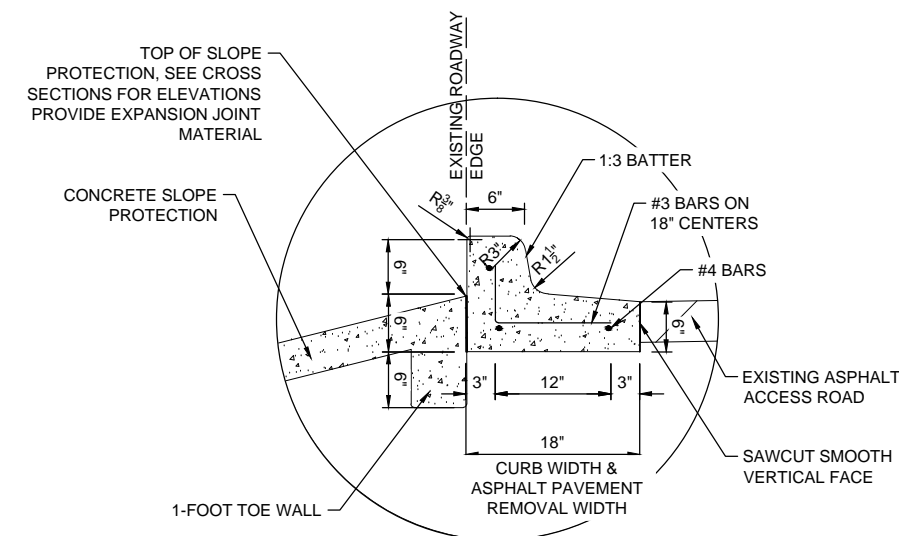

C-200  
5  
CURB INSTALLATION DETAIL  
SCALE: NONE

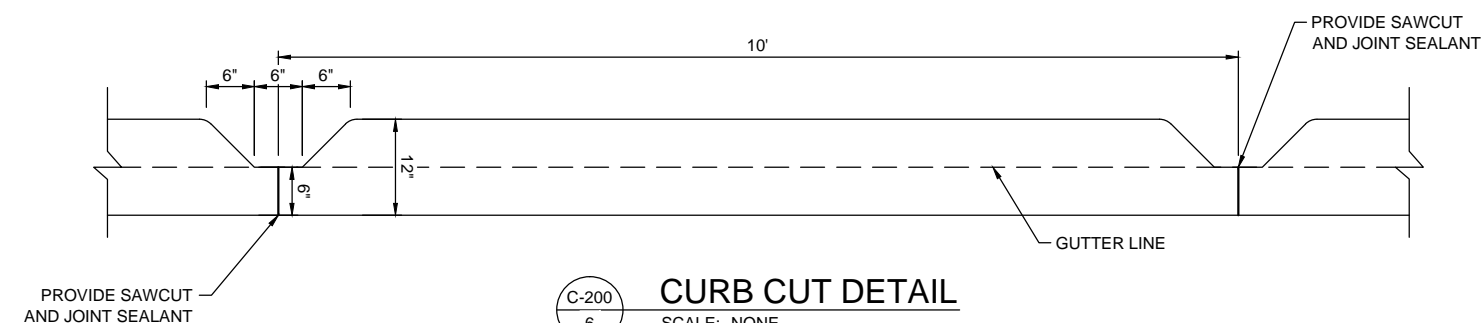

C-200  
6  
CURB CUT DETAIL  
SCALE: NONE

GENERAL NOTES:

1. ALL CONCRETE SLOPE PROTECTION SHALL BE EITHER NO. 3 REINFORCING STEEL ON 18 INCH CENTERS OR WELDED WIRE FABRIC.
2. ALL CONCRETE SLOPE PROTECTION SHALL HAVE A 3/4" MINIMUM DEPTH TOOLED JOINT EVERY 10 FEET.
3. ROCK EXCAVATION WILL BE PERFORMED FOR ALL AREAS OUTSIDE OF THE PROPOSED PAVEMENT SECTIONS. THE AVERAGE END AREA METHOD SHALL BE USED TO CALCULATE THE VOLUME OF ROCK EXCAVATION FROM THE TOP OF THE ROCK LAYER TO THE PROPOSED SURFACE. THE 4 INCHES OF UNDERCUTTING FOR TOPSOILING WILL NOT BE PAID FOR SEPARATELY BUT CONSIDERED SUBSIDIARY TO ROCK EXCAVATION.
4. TOPSOIL WILL ONLY BE PAID FOR IN AREAS THAT CONTAIN ROCK.