

File: L:\2011\11081100 - ADS Taxiway Alpha Improvements\Drawings\ADS_SAHB_C406_WL.dwg, Last Saved: 11/26/2012 2:07 PM, Last Saved by: Mmcconally
 Last Plotted by: McAnally, Mitchell, R, Plot Style: Garver Standard, Plot Date: 11/26/2012 2:07 PM, Plotter used: \\g1vdc02\Canon IR C4080.PS

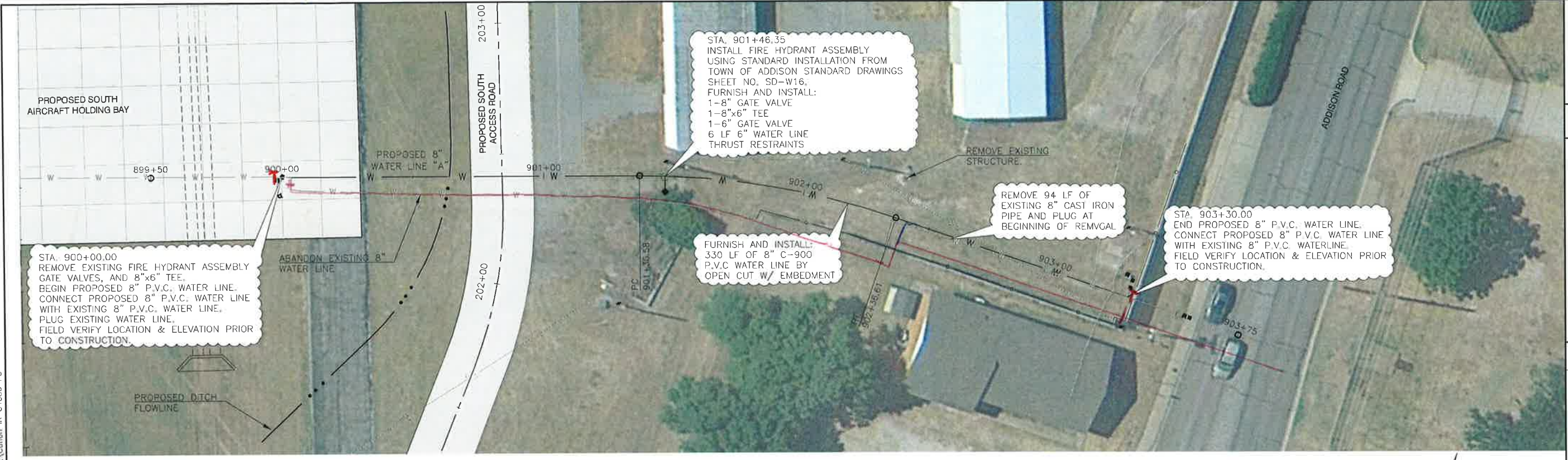

WATER LINE CURVE DATA

DESCRIPTION	STA.	NORTHING	EASTING
WATER LINE "A"			
POB	899+50.00	7036984.05	2480644.62
PC	901+36.58	7037048.30	2480819.79
PI	901+87.06	7037065.68	2480867.18
PT	902+36.61	7037066.59	2480917.66
POE	903+75.00	7037069.10	2481056.03

AIRPORT

GENERAL NOTES:
 SEE TOWN OF ADDISON WATER SYSTEM REQUIREMENTS FOR MATERIAL AND CONSTRUCTION REQUIREMENTS.
 SEE NCTCOG SPECIFICATIONS FOR METHOD OF MEASUREMENT AND PAYMENT.

CAUTION: UNDERGROUND UTILITIES EXIST WITHIN AND ADJACENT TO THE LIMITS OF CONSTRUCTION. AN ATTEMPT HAS BEEN MADE TO LOCATE THESE UTILITIES ON THE PLANS. HOWEVER, ALL EXISTING UTILITIES MAY NOT BE SHOWN AND THE ACTUAL LOCATIONS OF THE UTILITIES MAY VARY FROM THE LOCATIONS SHOWN. PRIOR TO BEGINNING ANY TYPE OF EXCAVATION, THE CONTRACTOR SHALL CONTACT THE UTILITIES INVOLVED AND MAKE ARRANGEMENTS FOR THE LOCATION OF THE UTILITIES ON THE GROUND. THE CONTRACTOR SHALL MAINTAIN THE UTILITY LOCATION MARKINGS UNTIL THEY ARE NO LONGER NECESSARY.

TEXAS STATE LAW, THE UNDERGROUND FACILITIES DAMAGE PREVENTION ACT, REQUIRES TWO WORKING DAYS ADVANCE NOTIFICATION THROUGH THE TEXAS ONE-CALL SYSTEM CENTER BEFORE EXCAVATING USING MECHANIZED EQUIPMENT OR EXPLOSIVES (EXCEPT IN THE CASE OF AN EMERGENCY). THE ONE-CALL SYSTEM PHONE NUMBER IS 1-800-245-4545. THE CONTRACTOR IS ADVISED THAT THERE IS A SEVERE PENALTY FOR NOT MAKING THIS CALL. NOT ALL UTILITY COMPANIES ARE MEMBERS OF THE TEXAS ONE-CALL SYSTEM; THEREFORE, THE CONTRACTOR IS ADVISED TO CONTACT ALL NON-MEMBER UTILITIES AS WELL AS THE ONE-CALL SYSTEM.

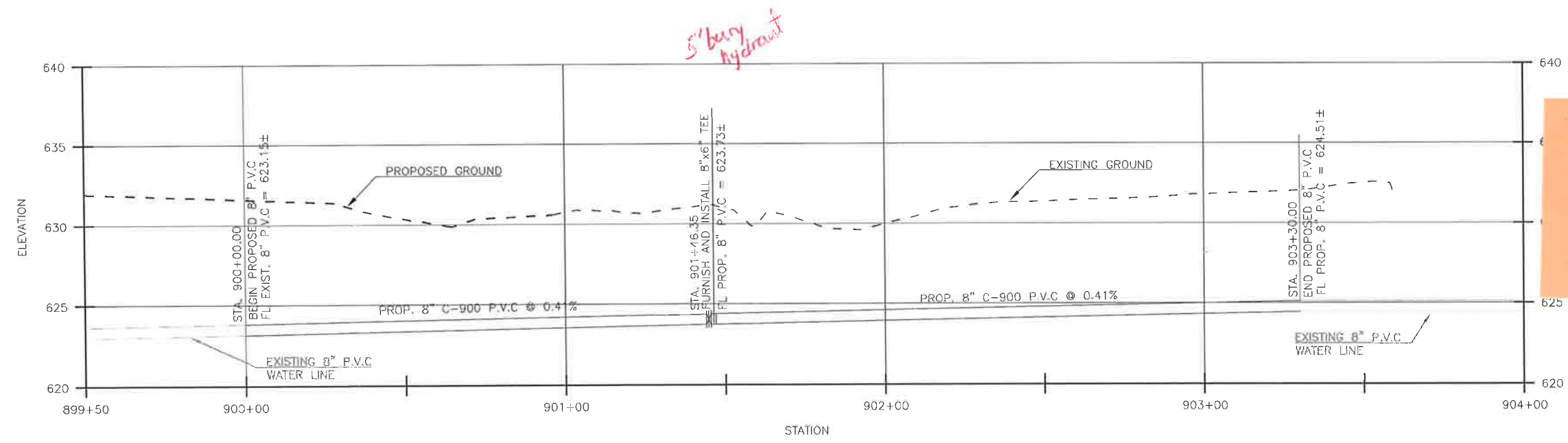
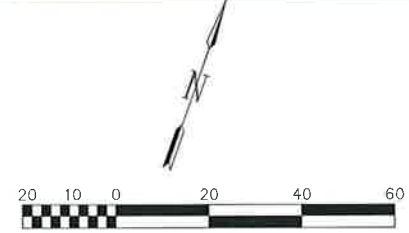

REGISTRATION NO. F-5713

THIS DOCUMENT IS RELEASED FOR THE PURPOSE OF INTERIM REVIEW UNDER THE AUTHORITY OF FRANK O. MULLWAIN, P.E. 93229 ON 11/26/2012. IT IS NOT TO BE USED FOR CONSTRUCTION, BIDDING, OR PERMIT PURPOSES.

REV.	DATE	DESCRIPTION	BY
1	8/6/12	ADDENDUM NO. 1	FOM
2	11/16/12	CHANGE ORDER NO. 1	FOM
3	11/20/12	WALL PLAN REVISION	FOM
4	11/29/12	CHANGE ORDER NO. 2	FOM

ADDISON AIRPORT
ADDISON, TX

TAXIWAY ALPHA IMPROVEMENTS

SOUTH AIRCRAFT HOLDING BAY - SOUTH WATER LINE PLAN & PROFILE

JOB NO.: 11081100
DATE: FEB, 2012
DESIGNED BY: MRM
DRAWN BY: BMN

BAR IS ONE INCH ON ORIGINAL DRAWING
IF NOT ONE INCH ON THIS SHEET, ADJUST SCALES ACCORDINGLY.

SHEET NUMBER

C-406



REGISTRATION NO.
F-5713

THIS DOCUMENT IS RELEASED FOR THE PURPOSE OF INTERIM REVIEW UNDER THE AUTHORITY OF FRANK O. MILLWAIN, P.E. 93229 ON 11/26/2012. IT IS NOT TO BE USED FOR CONSTRUCTION, BIDDING, OR PERMIT PURPOSES.

REV.	DATE	DESCRIPTION	BY
1	8/6/12	ADDENDUM NO. 1	FOM
2	11/6/12	CHANGE ORDER NO. 1	FOM
3	11/20/12	WALL PLAN REVISION	FOM
4	11/29/12	CHANGE ORDER NO. 2	FOM

ADDISON AIRPORT
ADDISON, TX

TAXIWAY ALPHA IMPROVEMENTS

SOUTH AIRCRAFT HOLDING BAY - SOUTH WATER LINE PLAN & PROFILE

JOB NO.: 11081100
DATE: FEB, 2012
DESIGNED BY: MRM
DRAWN BY: BMN

BAR IS ONE INCH ON ORIGINAL DRAWING
IF NOT ONE INCH ON THIS SHEET, ADJUST SCALES ACCORDINGLY.

SHEET NUMBER

C-406



WATER LINE CURVE DATA

DESCRIPTION	STA.	NORTHING	EASTING	RADIUS	LENGTH	DELTA
WATER LINE "A"						
POB	899+50.00	7036984.05	2480644.62			
PC	901+36.58	7037048.30	2480819.79			
PI	901+87.06	7037065.68	2480867.18	300.00	100.03	19°06'17" R
PT	902+36.61	7037066.59	2480917.66			
POE	903+75.00	7037069.10	2481056.03			

GENERAL NOTES:
SEE TOWN OF ADDISON WATER SYSTEM REQUIREMENTS FOR MATERIAL AND CONSTRUCTION REQUIREMENTS.
SEE NCTCOG SPECIFICATIONS FOR METHOD OF MEASUREMENT AND PAYMENT.

CAUTION: UNDERGROUND UTILITIES EXIST WITHIN AND ADJACENT TO THE LIMITS OF CONSTRUCTION. AN ATTEMPT HAS BEEN MADE TO LOCATE THESE UTILITIES ON THE PLANS, HOWEVER, ALL EXISTING UTILITIES MAY NOT BE SHOWN AND THE ACTUAL LOCATIONS OF THE UTILITIES MAY VARY FROM THE LOCATIONS SHOWN. PRIOR TO BEGINNING ANY TYPE OF EXCAVATION, THE CONTRACTOR SHALL CONTACT THE UTILITIES INVOLVED AND MAKE ARRANGEMENTS FOR THE LOCATION OF THE UTILITIES ON THE GROUND. THE CONTRACTOR SHALL MAINTAIN THE UTILITY LOCATION MARKINGS UNTIL THEY ARE NO LONGER NECESSARY.

TEXAS STATE LAW, THE UNDERGROUND FACILITIES DAMAGE PREVENTION ACT, REQUIRES TWO WORKING DAYS ADVANCE NOTIFICATION THROUGH THE TEXAS ONE-CALL SYSTEM CENTER BEFORE EXCAVATING USING MECHANIZED EQUIPMENT OR EXPLOSIVES (EXCEPT IN THE CASE OF AN EMERGENCY). THE ONE-CALL SYSTEM PHONE NUMBER IS 1-800-245-4545. THE CONTRACTOR IS ADVISED THAT THERE IS A SEVERE PENALTY FOR NOT MAKING THIS CALL. NOT ALL UTILITY COMPANIES ARE MEMBERS OF THE TEXAS ONE-CALL SYSTEM; THEREFORE, THE CONTRACTOR IS ADVISED TO CONTACT ALL NON-MEMBER UTILITIES AS WELL AS THE ONE-CALL SYSTEM.

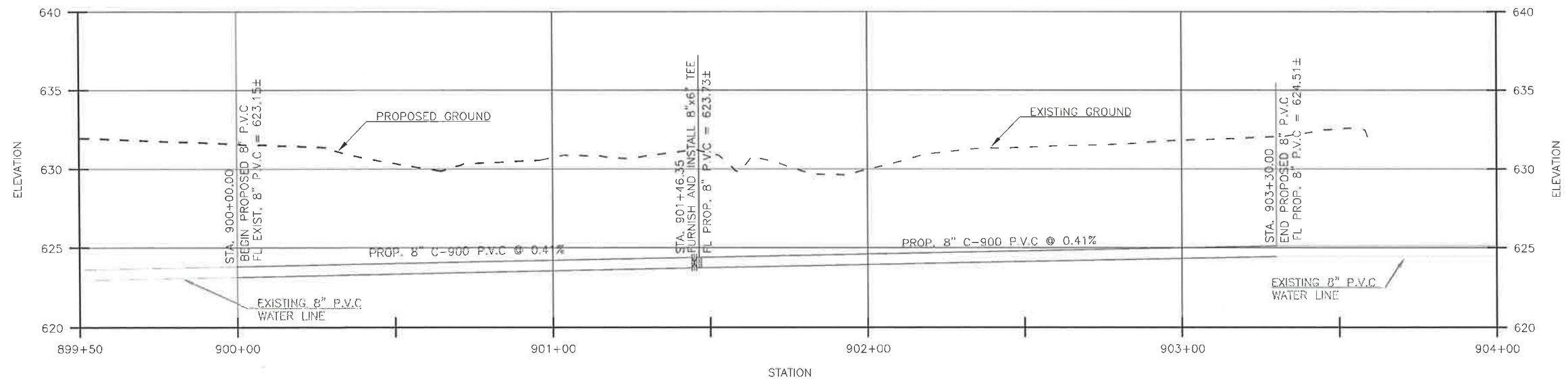
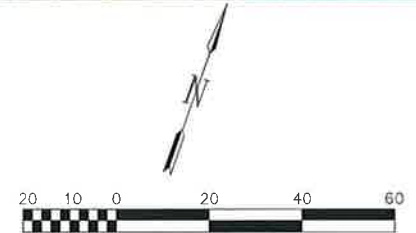

File: L:\2011\11081100 - ADS Taxiway Alpha Improvements\Drawings\ADS_SAHB_C406_WL.dwg Last Save: 11/26/2012 2:07 PM Last saved by: Mirmconally
 Last plotted by: Mirmconally, Mitchell, R Plot Style: Garver Standard Help.rtb Plot Scale: 1:2 Plot Date: 11/26/2012 2:07 PM Plotter used: \\gfyvdc02\Canon_IR_C4080_PS

TAXIWAY ALPHA '12



REGISTRATION NO. F-5713

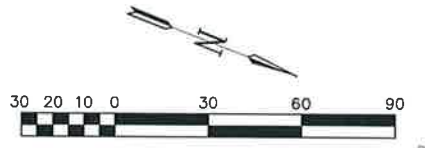
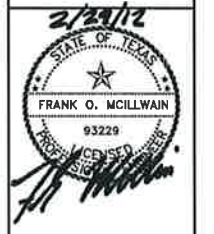

LEGEND	
	PAVEMENT REMOVAL
	ACCESS ROAD REMOVAL

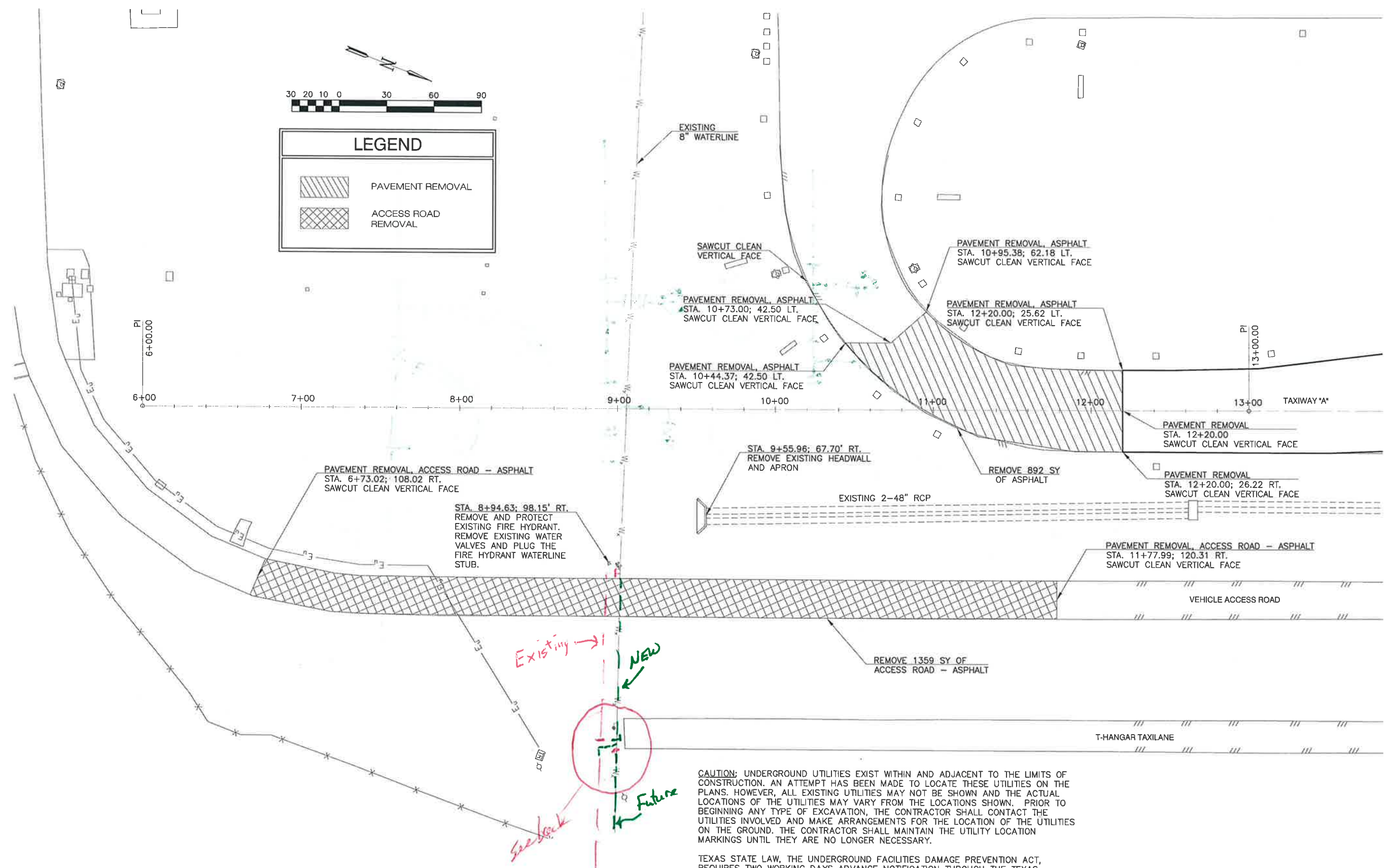

REV.	DATE	DESCRIPTION	BY

ADDITION AIRPORT
ADDISON, TX

CAVILLO HELIPAD IMPROVEMENTS

SOUTH AIRCRAFT HOLDING BAY - DEMOLITION PLAN (ALTERNATE D)

JOB NO.: 11081100
DATE: FEB., 2012
DESIGNED BY: MRM
DRAWN BY: BMN

BAR IS ONE INCH ON ORIGINAL DRAWING
IF NOT ONE INCH ON THIS SHEET, ADJUST SCALES ACCORDINGLY.

SHEET NUMBER
C-401

CAUTION: UNDERGROUND UTILITIES EXIST WITHIN AND ADJACENT TO THE LIMITS OF CONSTRUCTION. AN ATTEMPT HAS BEEN MADE TO LOCATE THESE UTILITIES ON THE PLANS. HOWEVER, ALL EXISTING UTILITIES MAY NOT BE SHOWN AND THE ACTUAL LOCATIONS OF THE UTILITIES MAY VARY FROM THE LOCATIONS SHOWN. PRIOR TO BEGINNING ANY TYPE OF EXCAVATION, THE CONTRACTOR SHALL CONTACT THE UTILITIES INVOLVED AND MAKE ARRANGEMENTS FOR THE LOCATION OF THE UTILITIES ON THE GROUND. THE CONTRACTOR SHALL MAINTAIN THE UTILITY LOCATION MARKINGS UNTIL THEY ARE NO LONGER NECESSARY.

TEXAS STATE LAW, THE UNDERGROUND FACILITIES DAMAGE PREVENTION ACT, REQUIRES TWO WORKING DAYS ADVANCE NOTIFICATION THROUGH THE TEXAS ONE-CALL SYSTEM CENTER BEFORE EXCAVATING USING MECHANIZED EQUIPMENT OR EXPLOSIVES (EXCEPT IN THE CASE OF AN EMERGENCY). THE ONE-CALL SYSTEM PHONE NUMBER IS 1-800-245-4545. THE CONTRACTOR IS ADVISED THAT THERE IS A SEVERE PENALTY FOR NOT MAKING THIS CALL. NOT ALL UTILITY COMPANIES ARE MEMBERS OF THE TEXAS ONE-CALL SYSTEM; THEREFORE, THE CONTRACTOR IS ADVISED TO CONTACT ALL NON-MEMBER UTILITIES AS WELL AS THE ONE-CALL SYSTEM.

THIS DOCUMENT IS RELEASED FOR THE PURPOSE OF INTERIM REVIEW UNDER THE AUTHORITY OF FRANK O. MCILWAIN, P.E. 93229 ON 09/29/2011. IT IS NOT TO BE USED FOR CONSTRUCTION, BIDDING, OR PERMIT PURPOSES.

File: L:\2011\11081100 - ADS Taxiway Alpha Improvements\Drawings\ADS_South_C-401_DT.dwg
 Last saved by: MRM
 Date: 2/17/2012 2:47 PM
 Last plot by: MRM
 Date: 2/29/2012 10:55 AM
 Plotter: HPGL-RT
 Plot Scale: 1:2
 Plot Date: 2/29/2012 10:55 AM
 Plotter: HPGL-RT
 User: MRM
 IR C4080 PS

File: L:\2011\11081100 - ADS Taxiway Alpha Improvements\Drawings\ADS_SAHB_C405_AR.dwg Plot Date: 2/29/2012 11:10 AM Plotter used: \\p1ydc02\Canon_IR C4080 PS
 Last saved by: MRMconolly
 Last plotted by: MRMconolly, Mitchell, R Plot Style: Garver Standard Help.ctb Plot Scale: 1:2 Plot Date: 2/29/2012 11:10 AM Plotter used: \\p1ydc02\Canon_IR C4080 PS

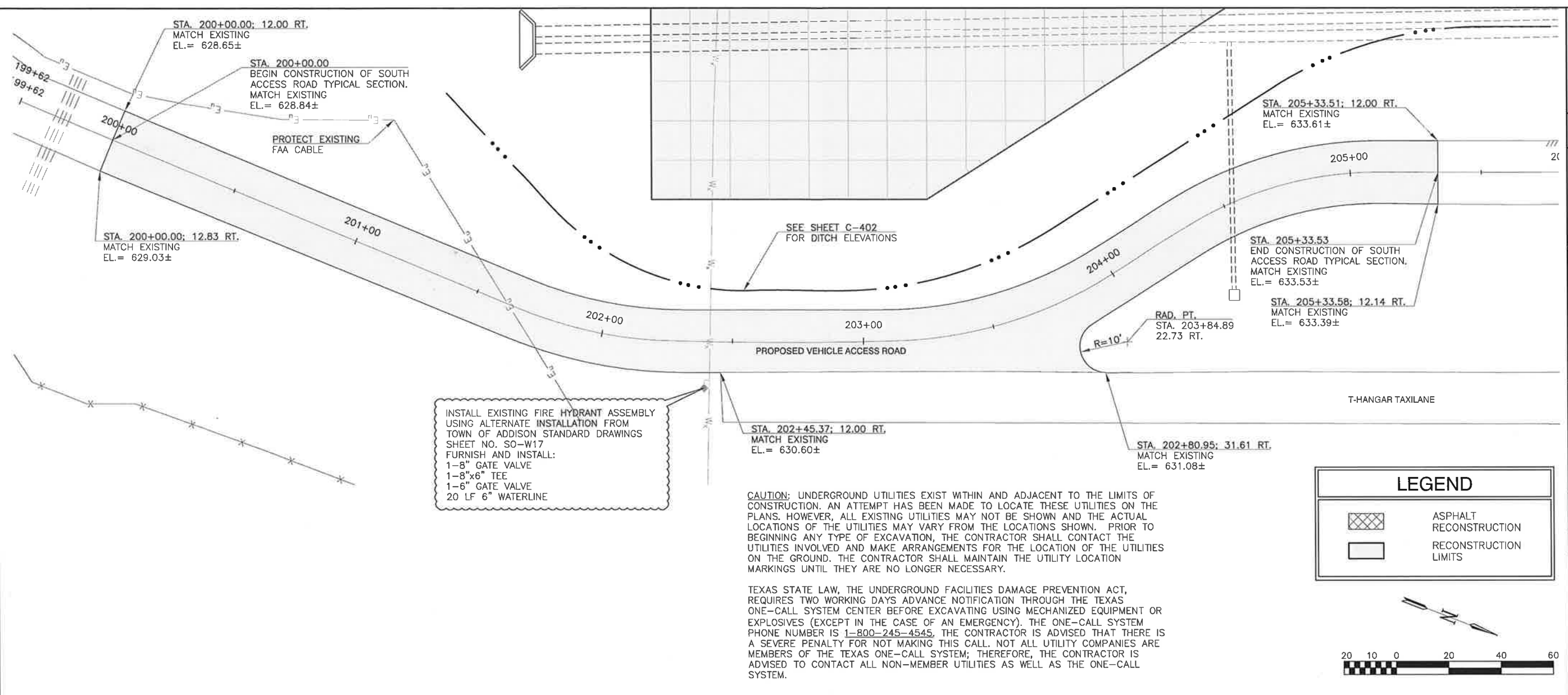

INSTALL EXISTING FIRE HYDRANT ASSEMBLY
 USING ALTERNATE INSTALLATION FROM
 TOWN OF ADDISON STANDARD DRAWINGS
 SHEET NO. SO-W17
 FURNISH AND INSTALL:
 1-8" GATE VALVE
 1-8"x6" TEE
 1-6" GATE VALVE
 20 LF 6" WATERLINE

CAUTION: UNDERGROUND UTILITIES EXIST WITHIN AND ADJACENT TO THE LIMITS OF CONSTRUCTION. AN ATTEMPT HAS BEEN MADE TO LOCATE THESE UTILITIES ON THE PLANS. HOWEVER, ALL EXISTING UTILITIES MAY NOT BE SHOWN AND THE ACTUAL LOCATIONS OF THE UTILITIES MAY VARY FROM THE LOCATIONS SHOWN. PRIOR TO BEGINNING ANY TYPE OF EXCAVATION, THE CONTRACTOR SHALL CONTACT THE UTILITIES INVOLVED AND MAKE ARRANGEMENTS FOR THE LOCATION OF THE UTILITIES ON THE GROUND. THE CONTRACTOR SHALL MAINTAIN THE UTILITY LOCATION MARKINGS UNTIL THEY ARE NO LONGER NECESSARY.

TEXAS STATE LAW, THE UNDERGROUND FACILITIES DAMAGE PREVENTION ACT, REQUIRES TWO WORKING DAYS ADVANCE NOTIFICATION THROUGH THE TEXAS ONE-CALL SYSTEM CENTER BEFORE EXCAVATING USING MECHANIZED EQUIPMENT OR EXPLOSIVES (EXCEPT IN THE CASE OF AN EMERGENCY). THE ONE-CALL SYSTEM PHONE NUMBER IS 1-800-245-4545, THE CONTRACTOR IS ADVISED THAT THERE IS A SEVERE PENALTY FOR NOT MAKING THIS CALL. NOT ALL UTILITY COMPANIES ARE MEMBERS OF THE TEXAS ONE-CALL SYSTEM; THEREFORE, THE CONTRACTOR IS ADVISED TO CONTACT ALL NON-MEMBER UTILITIES AS WELL AS THE ONE-CALL SYSTEM.

LEGEND

	ASPHALT RECONSTRUCTION
	RECONSTRUCTION LIMITS

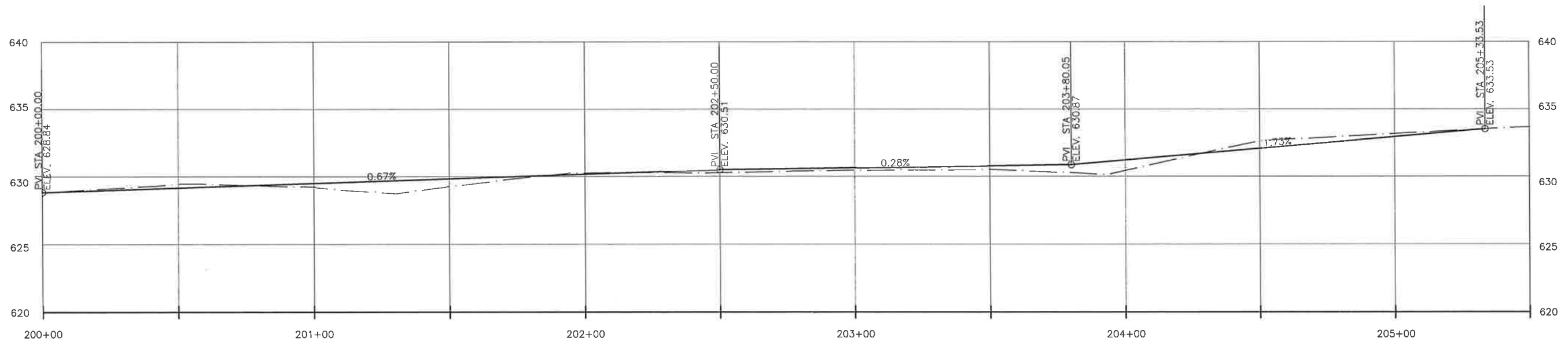
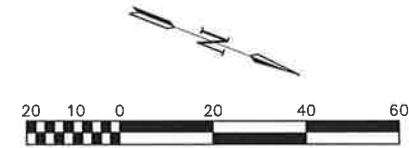

REGISTRATION NO. F-5713

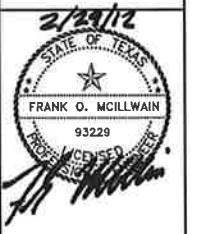

REV.	DATE	DESCRIPTION	BY

ADDISON AIRPORT
 ADDISON, TX
 TAXIWAY ALPHA IMPROVEMENTS

SOUTH AIRCRAFT HOLDING BAY - SOUTH ACCESS ROAD
 PLAN & PROFILE (ALTERNATE D)

JOB NO.: 11081100
 DATE: FEB., 2012
 DESIGNED BY: MRM
 DRAWN BY: BMN

BAR IS ONE INCH ON ORIGINAL DRAWING
 IF NOT ONE INCH ON THIS SHEET, ADJUST SCALES ACCORDINGLY.

SHEET NUMBER **C-405**

File: L:\2011\11081100 - ADS Taxiway Alpha Improvements\Drawings\ADS_SAHB_C406_WD.dwg Last Saved by: Mirreanonly
 Last Printed by: McAnelly, Mitchell, R Date: 2/29/2012 11:17 AM Plot Date: 2/29/2012 11:17 AM Plotter: \\garver\cpl\Ganon IR C4080.PS

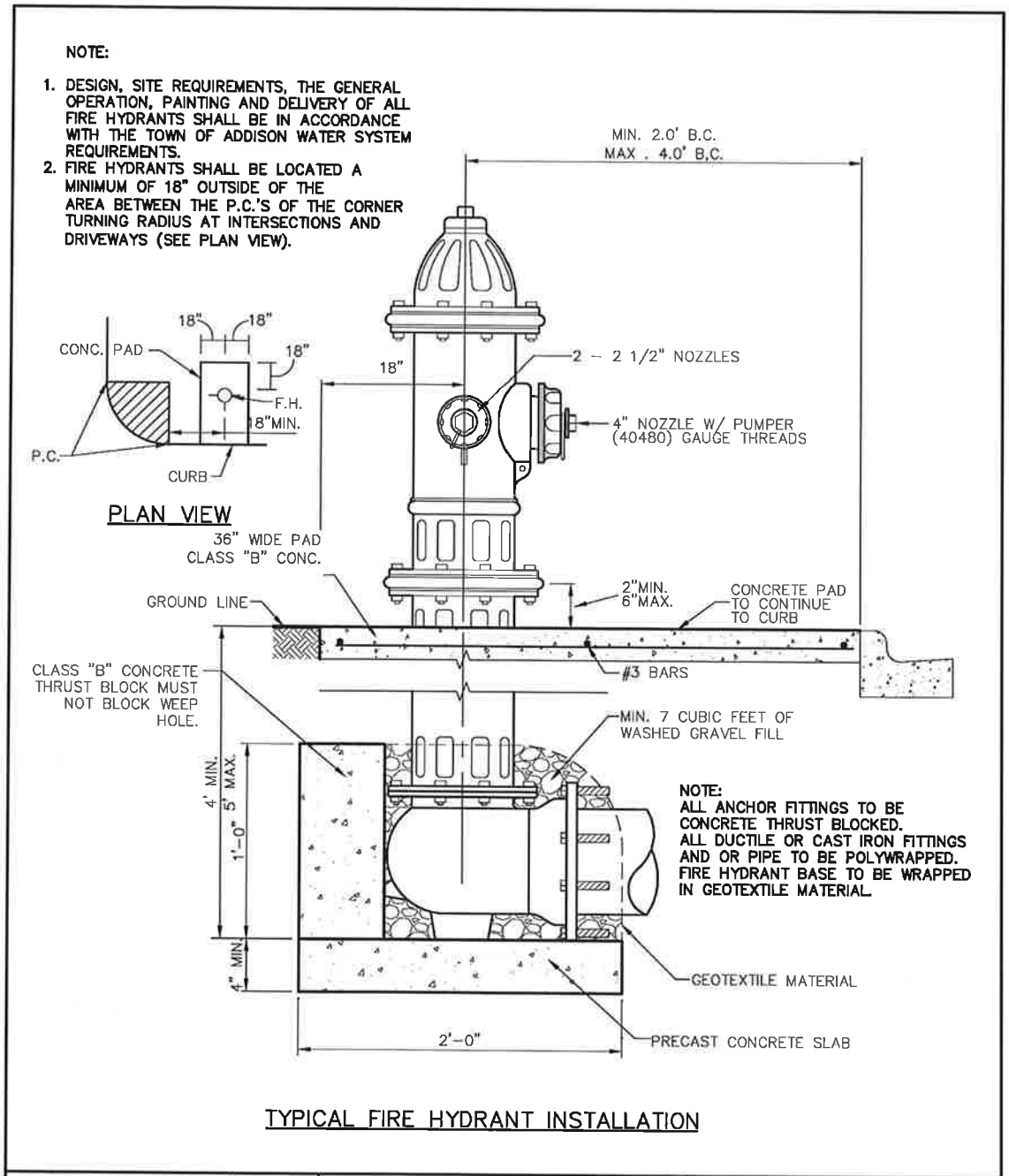

Addison! PUBLIC WORKS DEPARTMENT	TYPICAL FIRE HYDRANT INSTALLATION	STANDARD CONSTRUCTION DETAILS WATER		
		DATE: AUGUST, 2010	REV DATE: -	SHEET : SD-W16

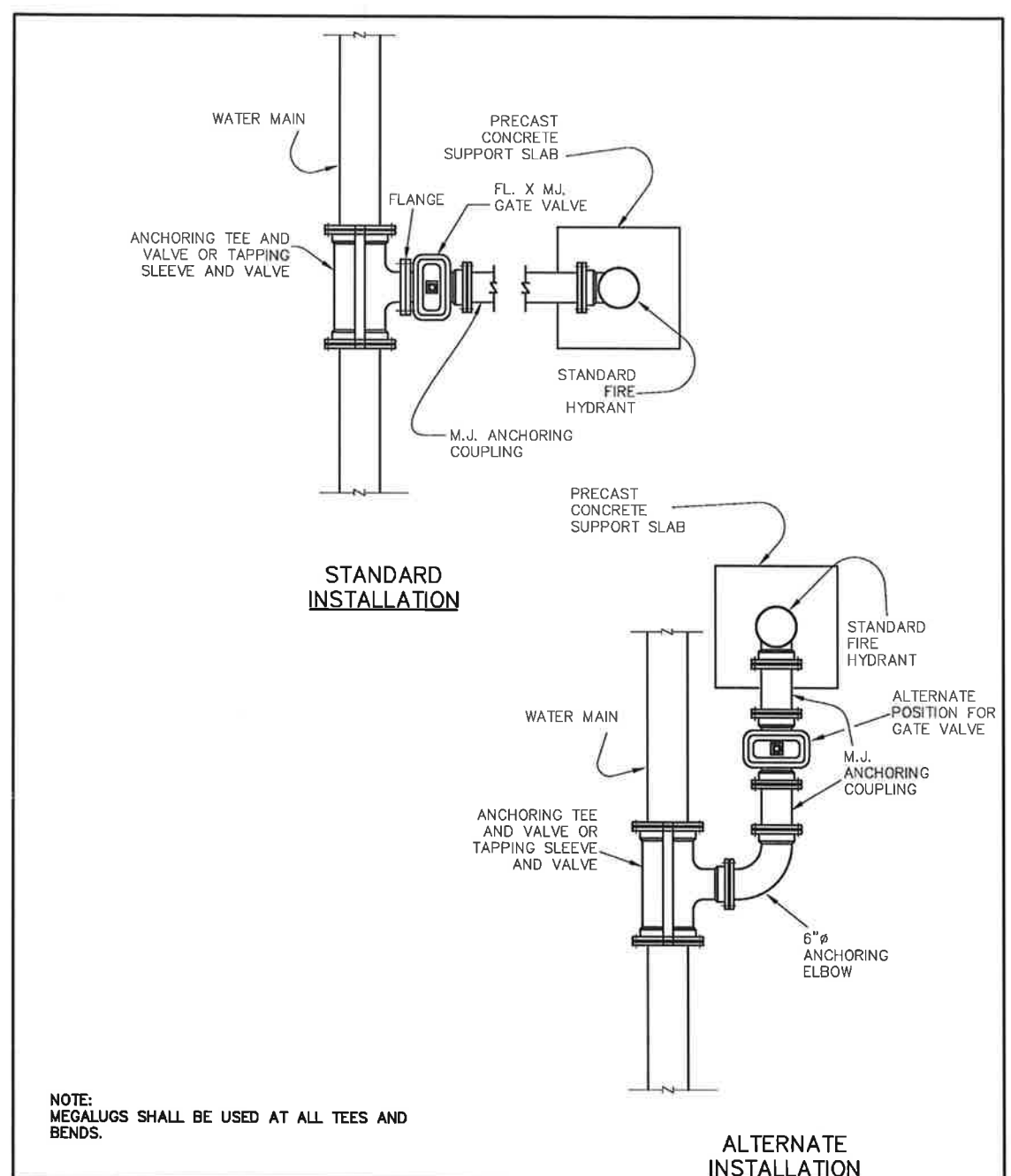

Addison! PUBLIC WORKS DEPARTMENT	TYPICAL FIRE HYDRANT INSTALLATION	STANDARD CONSTRUCTION DETAILS WATER		
		DATE: AUGUST, 2010	REV DATE: -	SHEET : SD-W17



REGISTRATION NO.
F-5713

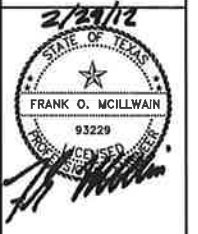

REV.	DATE	DESCRIPTION	BY

ADDISON AIRPORT
 ADDISON, TX
 TAXIWAY ALPHA IMPROVEMENTS

SOUTH AIRCRAFT
 HOLDING BAY -
 WATER DETAILS
 (ALTERNATE D)

JOB NO.: 11081100
 DATE: FEB., 2012
 DESIGNED BY: MRM
 DRAWN BY: BMN

BAR IS ONE INCH ON
 ORIGINAL DRAWING
 IF NOT ONE INCH ON
 THIS SHEET, ADJUST
 SCALES ACCORDINGLY.

SHEET NUMBER
C-406