

# TAXIWAY ALPHA '12

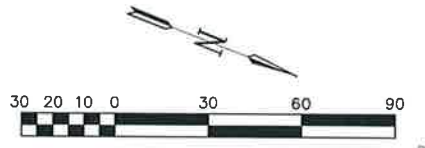

REGISTRATION NO. F-5713

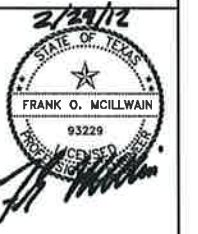

LEGEND	
	PAVEMENT REMOVAL
	ACCESS ROAD REMOVAL

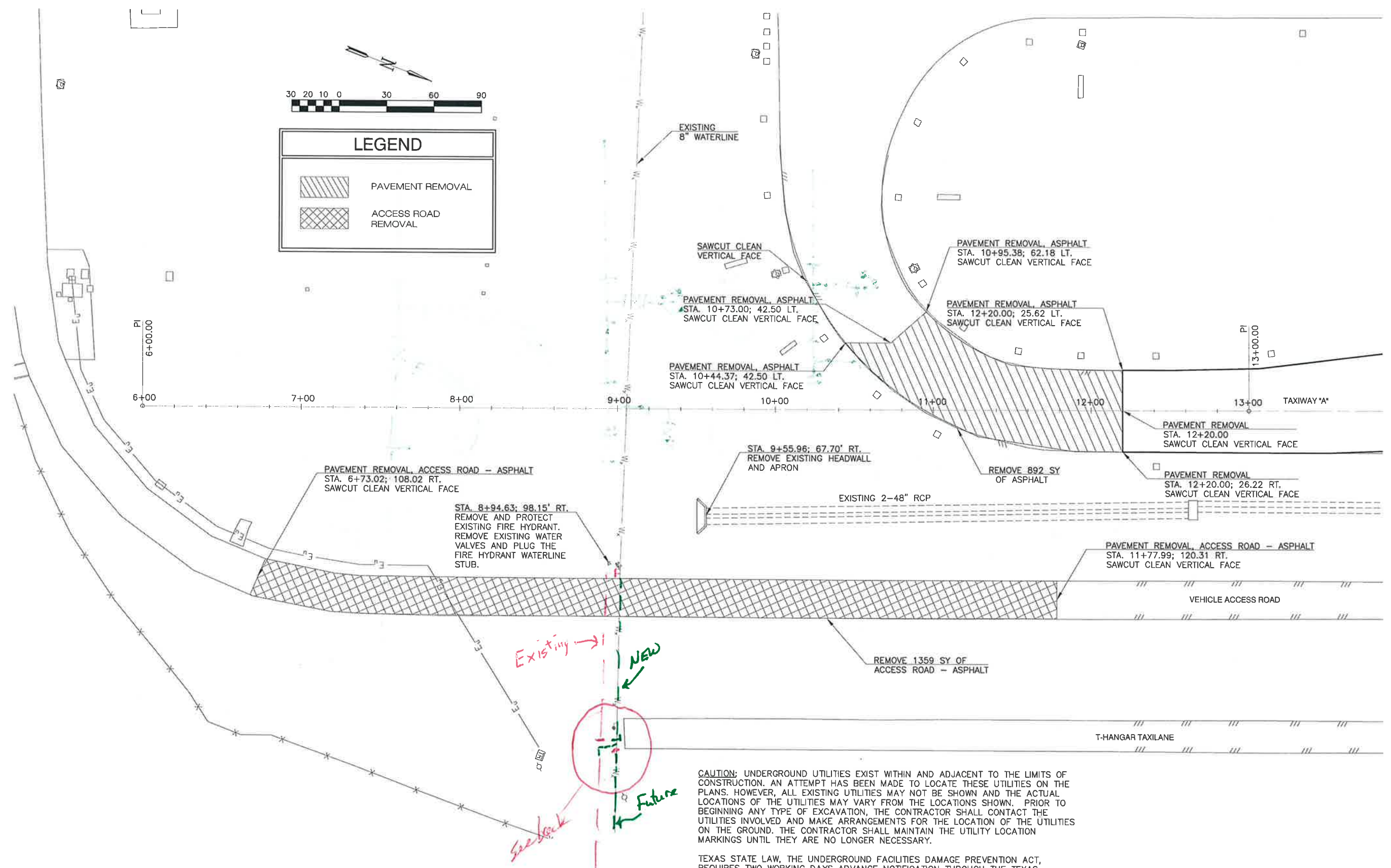

REV.	DATE	DESCRIPTION	BY

ADDITION AIRPORT  
ADDISON, TX

TAXIWAY HELIPAD IMPROVEMENTS

SOUTH AIRCRAFT HOLDING BAY - DEMOLITION PLAN (ALTERNATE D)

JOB NO.: 11081100  
DATE: FEB., 2012  
DESIGNED BY: MRM  
DRAWN BY: BMN

BAR IS ONE INCH ON ORIGINAL DRAWING  
IF NOT ONE INCH ON THIS SHEET, ADJUST SCALES ACCORDINGLY.

SHEET NUMBER  
**C-401**

**CAUTION:** UNDERGROUND UTILITIES EXIST WITHIN AND ADJACENT TO THE LIMITS OF CONSTRUCTION. AN ATTEMPT HAS BEEN MADE TO LOCATE THESE UTILITIES ON THE PLANS. HOWEVER, ALL EXISTING UTILITIES MAY NOT BE SHOWN AND THE ACTUAL LOCATIONS OF THE UTILITIES MAY VARY FROM THE LOCATIONS SHOWN. PRIOR TO BEGINNING ANY TYPE OF EXCAVATION, THE CONTRACTOR SHALL CONTACT THE UTILITIES INVOLVED AND MAKE ARRANGEMENTS FOR THE LOCATION OF THE UTILITIES ON THE GROUND. THE CONTRACTOR SHALL MAINTAIN THE UTILITY LOCATION MARKINGS UNTIL THEY ARE NO LONGER NECESSARY.

TEXAS STATE LAW, THE UNDERGROUND FACILITIES DAMAGE PREVENTION ACT, REQUIRES TWO WORKING DAYS ADVANCE NOTIFICATION THROUGH THE TEXAS ONE-CALL SYSTEM CENTER BEFORE EXCAVATING USING MECHANIZED EQUIPMENT OR EXPLOSIVES (EXCEPT IN THE CASE OF AN EMERGENCY). THE ONE-CALL SYSTEM PHONE NUMBER IS 1-800-245-4545. THE CONTRACTOR IS ADVISED THAT THERE IS A SEVERE PENALTY FOR NOT MAKING THIS CALL. NOT ALL UTILITY COMPANIES ARE MEMBERS OF THE TEXAS ONE-CALL SYSTEM; THEREFORE, THE CONTRACTOR IS ADVISED TO CONTACT ALL NON-MEMBER UTILITIES AS WELL AS THE ONE-CALL SYSTEM.

THIS DOCUMENT IS RELEASED FOR THE PURPOSE OF INTERIM REVIEW UNDER THE AUTHORITY OF FRANK O. MCILWAIN, P.E. 93229 ON 09/29/2011. IT IS NOT TO BE USED FOR CONSTRUCTION, BIDDING, OR PERMIT PURPOSES.

File: L:\2011\11081100 - ADS Taxiway Alpha Improvements\Drawings\ADS\_South\_C-401\_DT.dwg  
 Last saved by: MRM  
 Last saved date: 2/17/2012 2:47 PM  
 Plot date: 2/29/2012 10:55 AM  
 Plotter: autocad.ctb  
 Plot scale: 1:2  
 Plot offset: 0.00  
 Plot origin: 0,0  
 Plot units: Feet  
 Plot color: Black  
 Plot lineweight: 0.20  
 Plot style: Standard  
 Plot weight: 1.00  
 Plot resolution: 1200  
 Plot scale: 1:2  
 Plot offset: 0.00  
 Plot origin: 0,0  
 Plot units: Feet  
 Plot color: Black  
 Plot lineweight: 0.20  
 Plot style: Standard  
 Plot weight: 1.00  
 Plot resolution: 1200