

ELEVATION

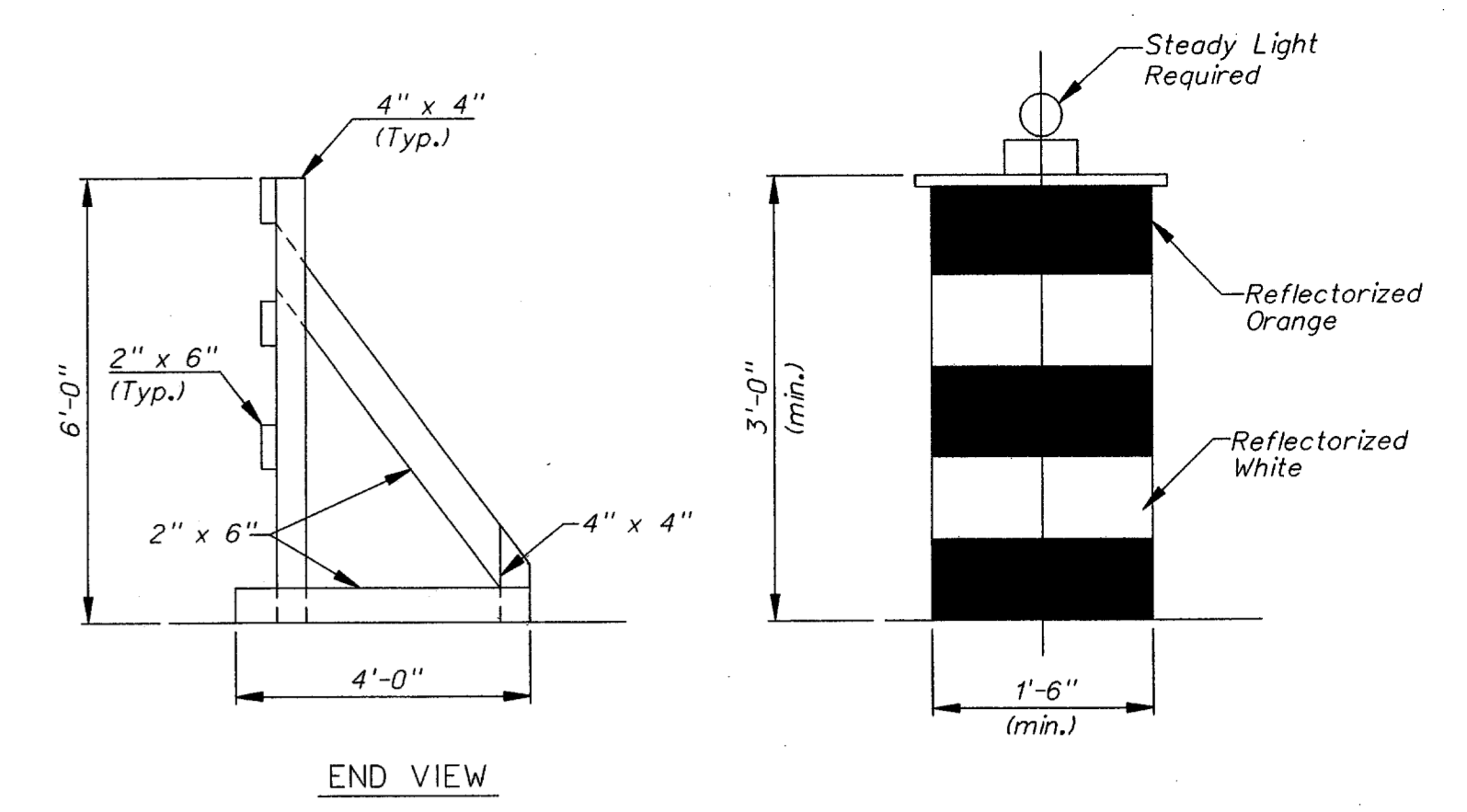

END VIEW

TYPICAL DRUM
N.T.S.

TYPICAL TYPE III BARRICADE
N.T.S.

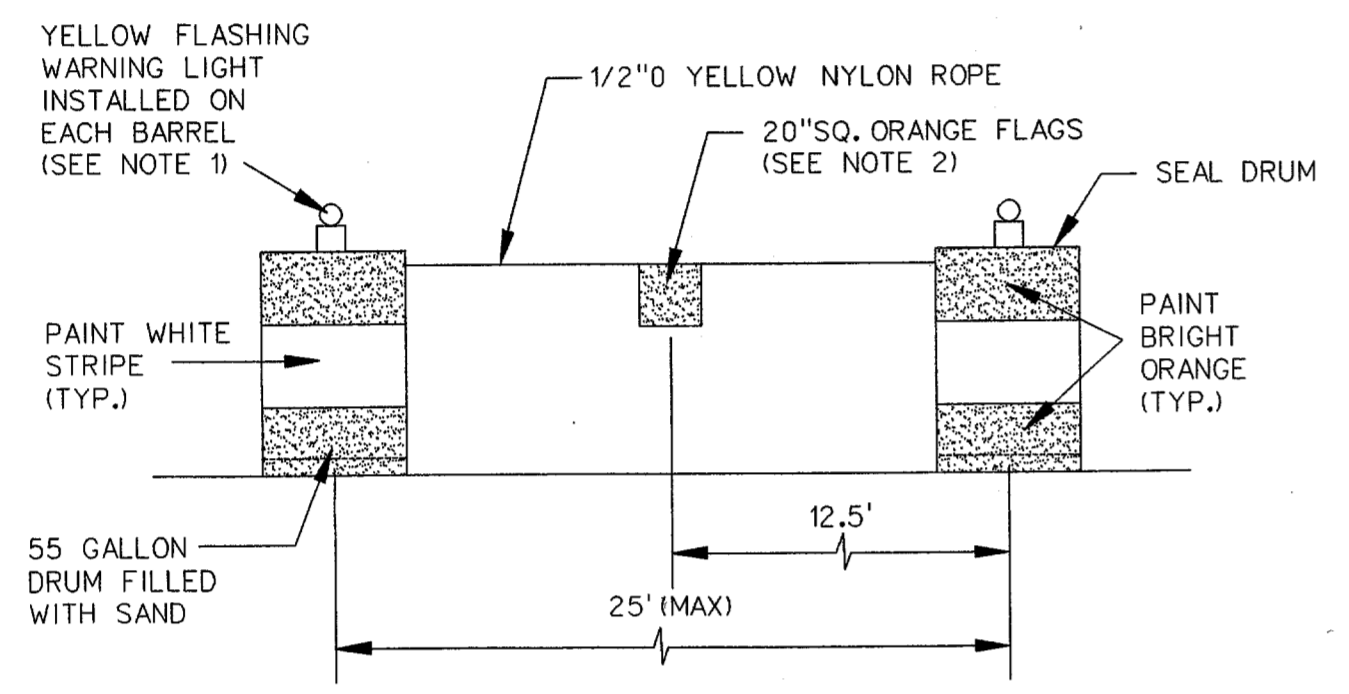

BARREL BARRICADE
N.T.S.

TYPICALLY USED FOR TAXIWAYS, TAXILANES AND RUNWAYS TO DEFINE THE CONSTRUCTION AREA.

NOTES:

- 1.- FLASHING YELLOW LIGHTS SHALL BE BATTERY POWERED AND SHALL OPERATE INDEPENDENTLY OF EACH OTHER.
- 2.- 20" x 20" SQUARE ORANGE FLAGS SHALL BE INSTALLED SO THAT THE FLAG IS ALWAYS IN THE EXTENDED POSITION.

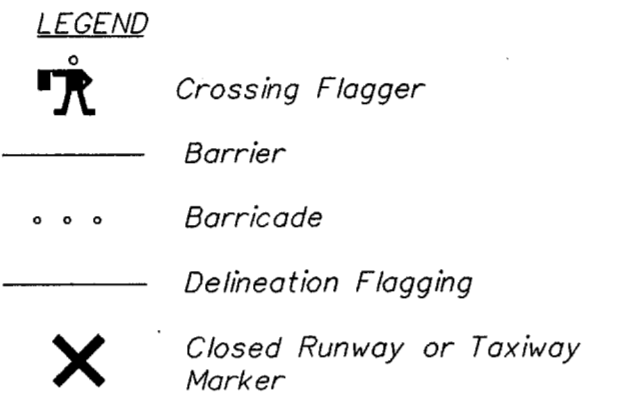

LEGEND

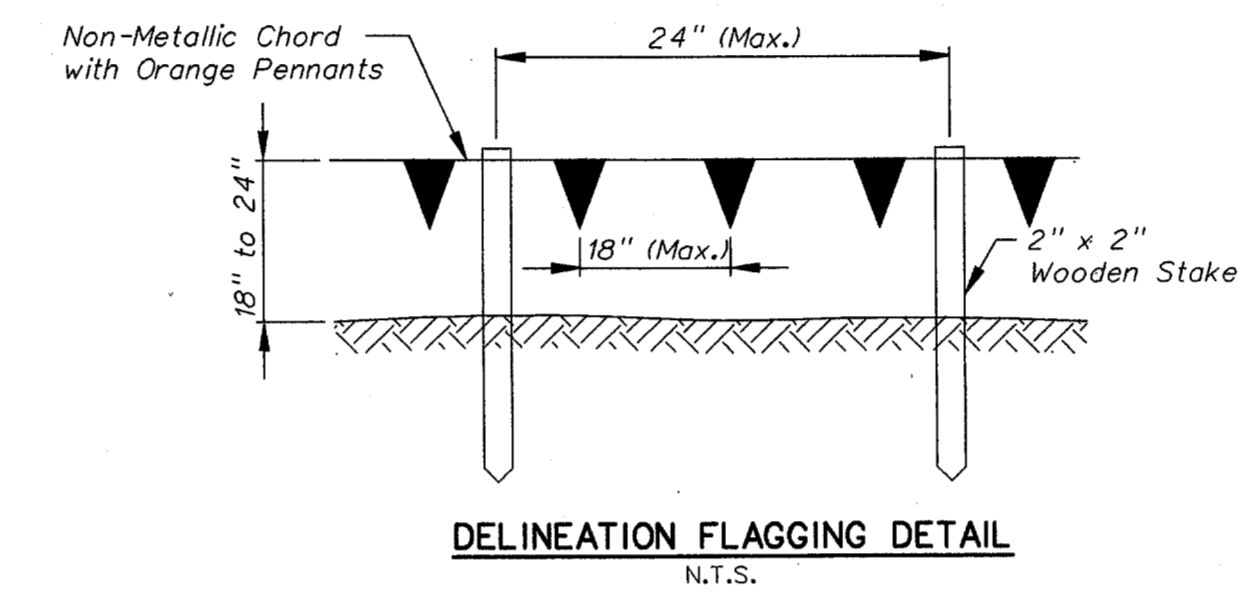

DELINEATION FLAGGING DETAIL
N.T.S.

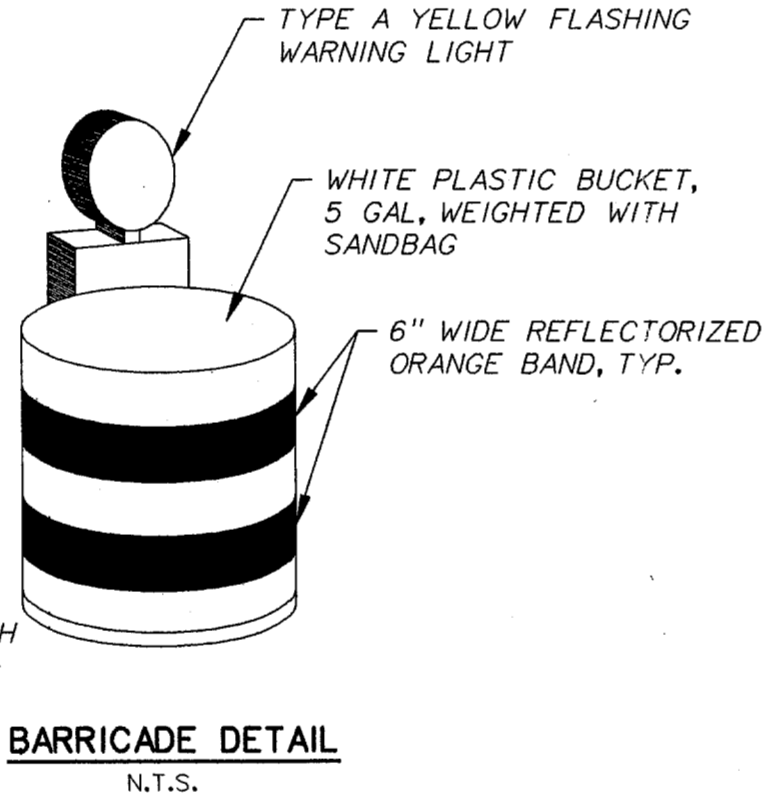

BARRICADE DETAIL
N.T.S.

NOTE: BARRICADES TO BE SPACED 5' ON CENTER MAXIMUM ACROSS WIDTH OF ALL CLOSED T/W - R/W ACCESS POINTS.

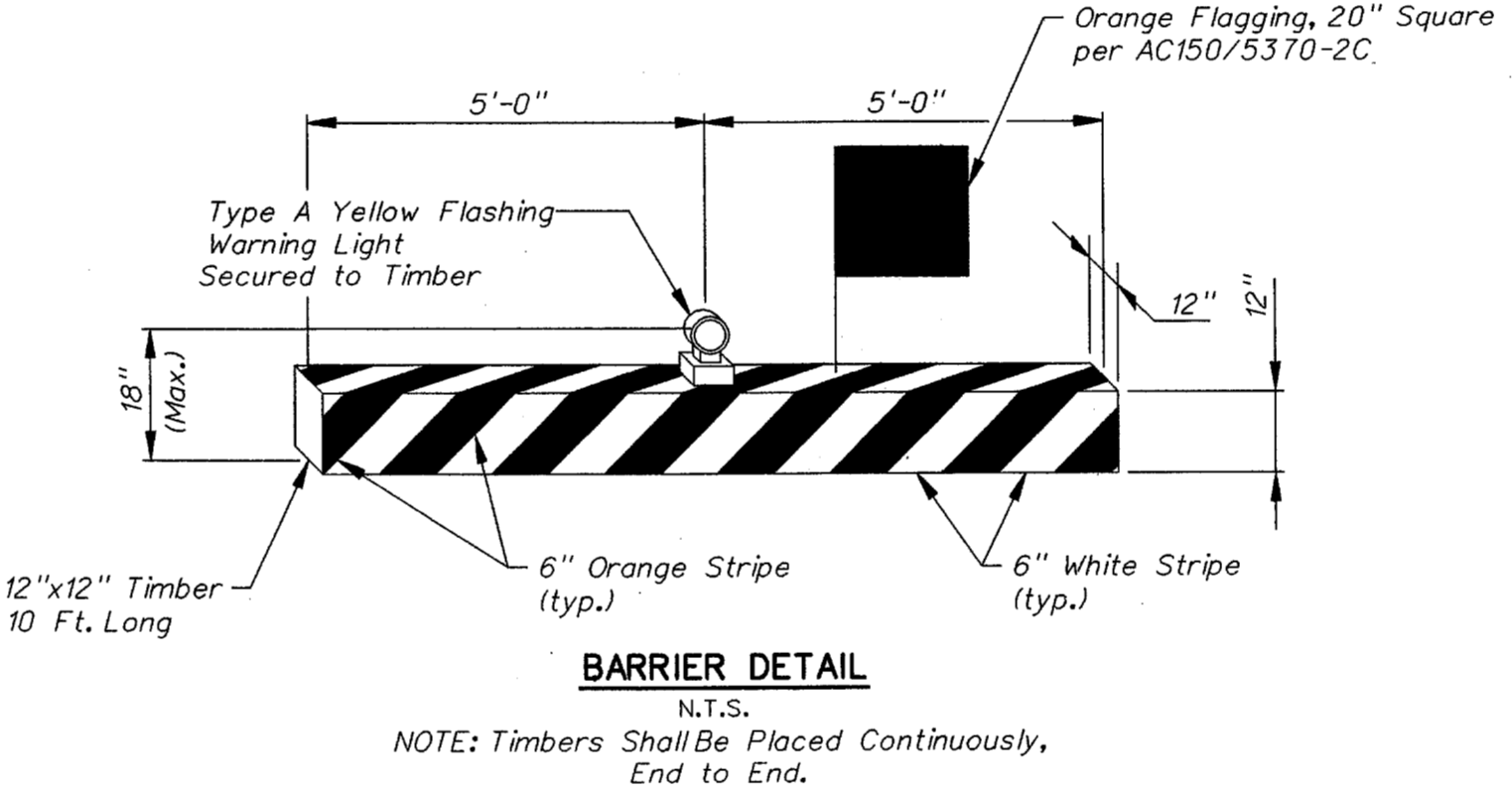

BARRIER DETAIL
N.T.S.

NOTE: Timbers Shall Be Placed Continuously, End to End.

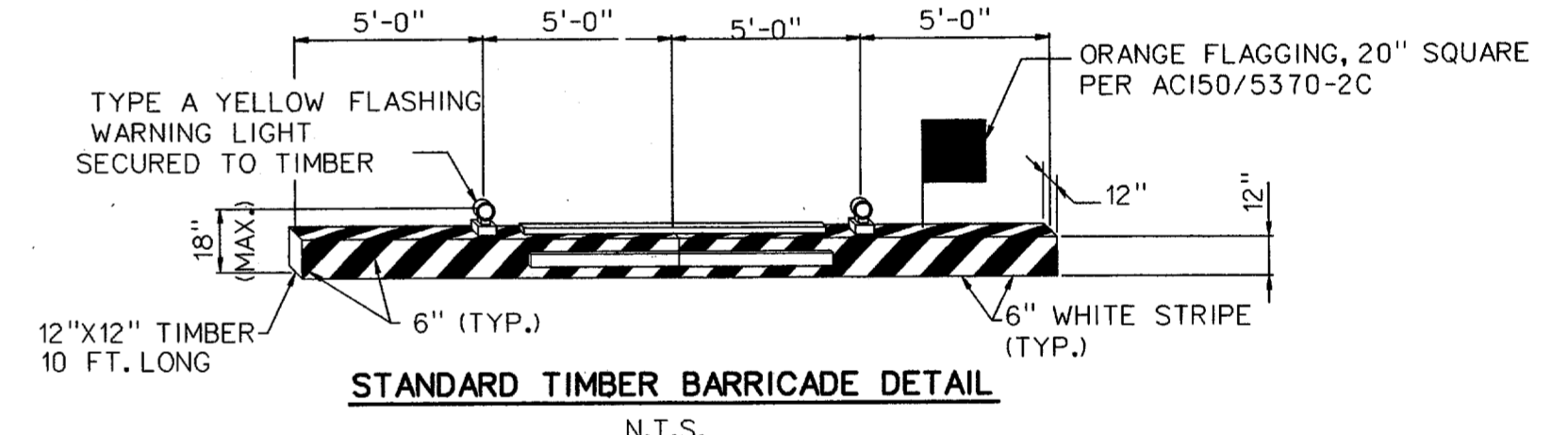

STANDARD TIMBER BARRICADE DETAIL
N.T.S.

NOTE: TIMBER SHALL BE PLACED CONTINUOUSLY, END TO END AND CONNECTED WITH "2x4" STRAPS ON THE TOP AND BOTH SIDES.

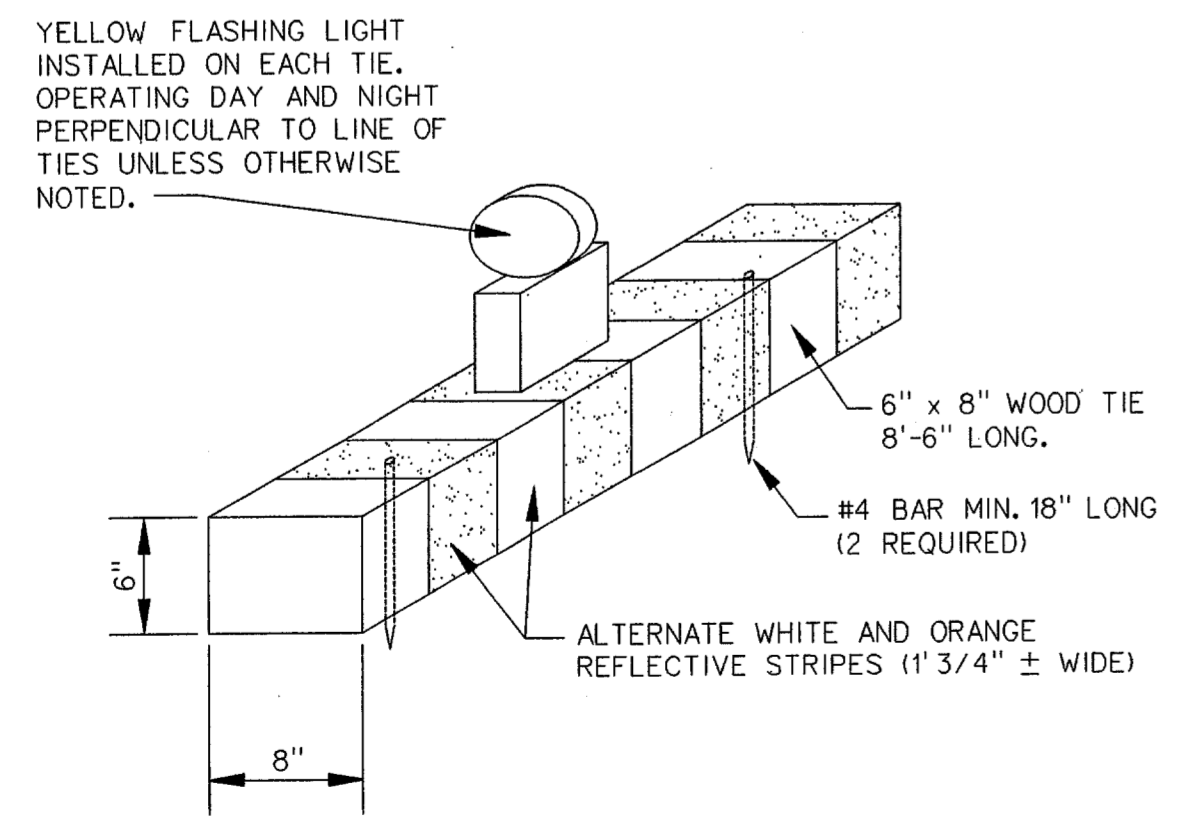

RAILROAD TIES BARRICADE
N.T.S.

TYPICALLY USED WHERE THE LIMIT OF CONSTRUCTION IS ADJACENT TO THE EDGE OF PAVEMENT OF AN ACTIVE TAXIWAY OR TAXILANE.

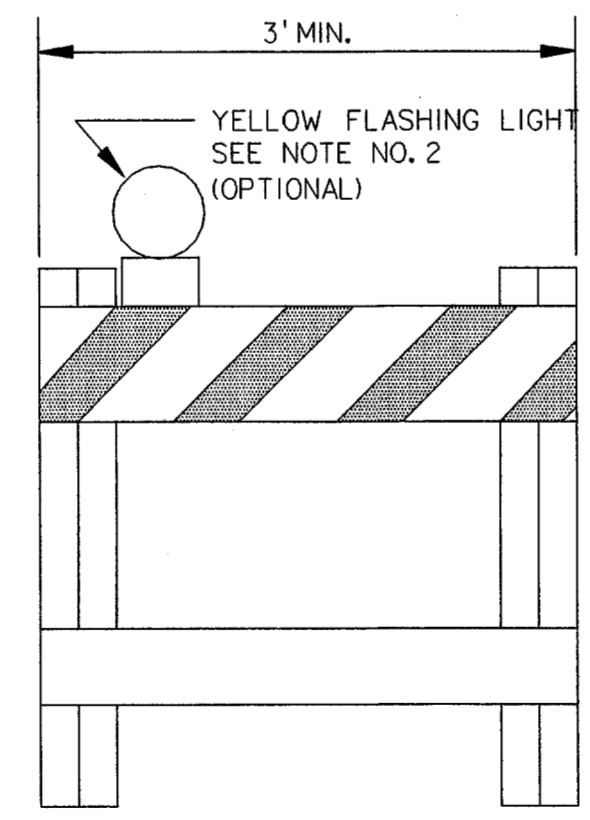

TYPE-I BARRICADE
N.T.S.

- NOTES:
- 1) THIS APPROVED CONTROL DEVICE MAY BE USED ON PUBLIC HIGHWAYS, ROADS AND STREETS.
 - 2) FLASHING YELLOW LIGHTS SHALL BE BATTERY OPERATED AND OPERATE INDEPENDENTLY OF EACH OTHER

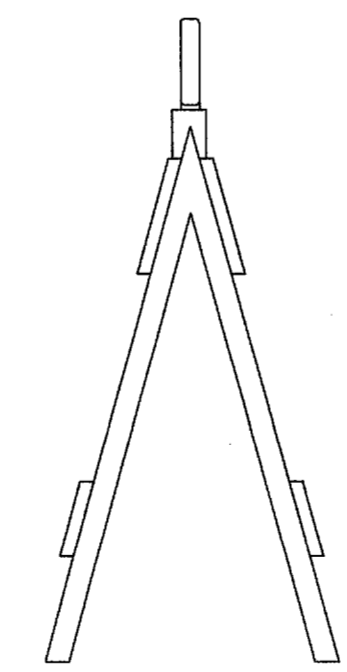

JERSEY CURB BARRICADE
N.T.S.

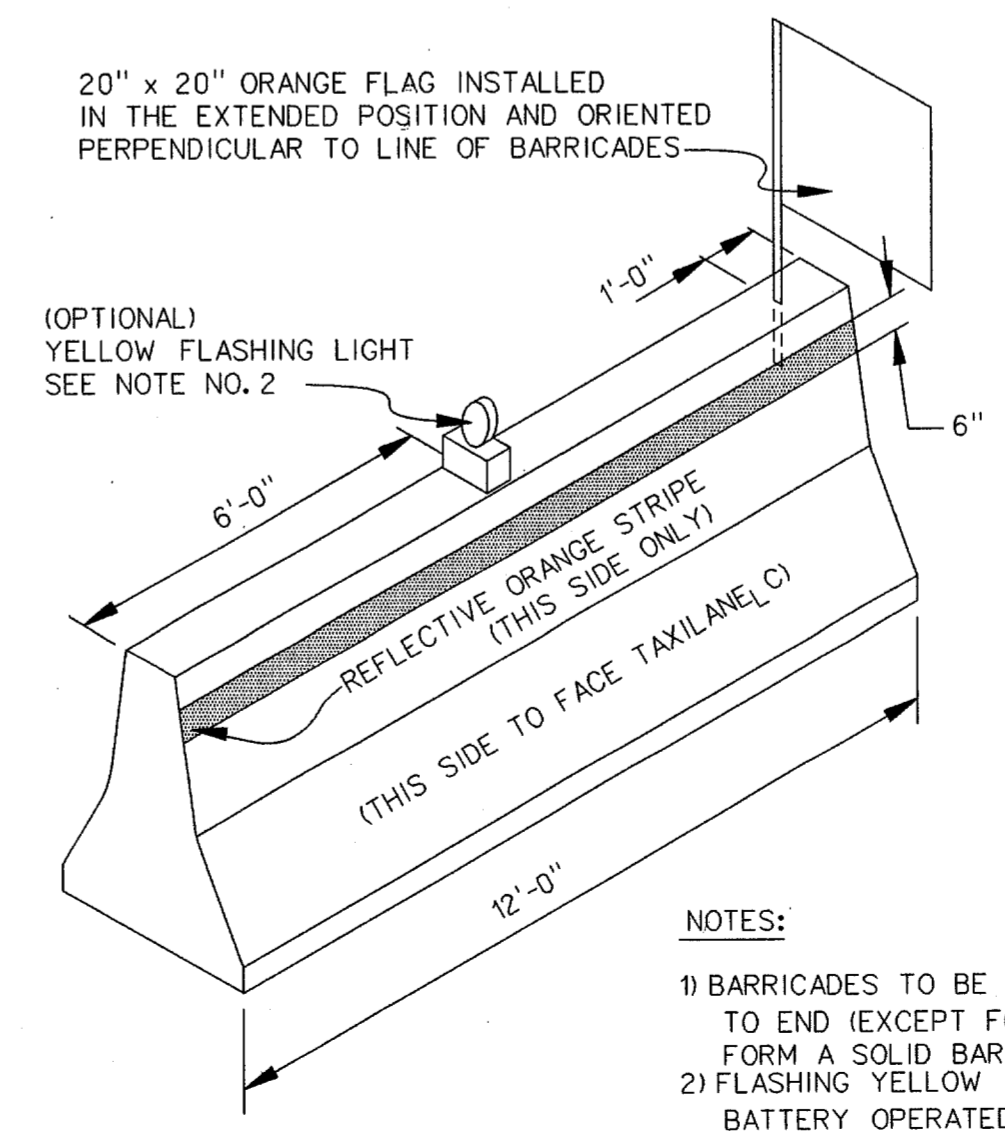

NOTES:

- 1) BARRICADES TO BE PLACED END TO END (EXCEPT FOR OPENINGS) TO FORM A SOLID BARRIER WALL.
- 2) FLASHING YELLOW LIGHTS SHALL BE BATTERY OPERATED AND OPERATE INDEPENDENTLY OF EACH OTHER

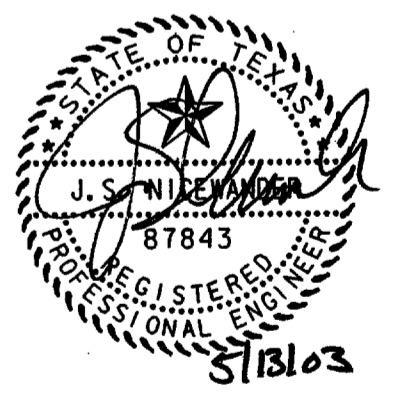
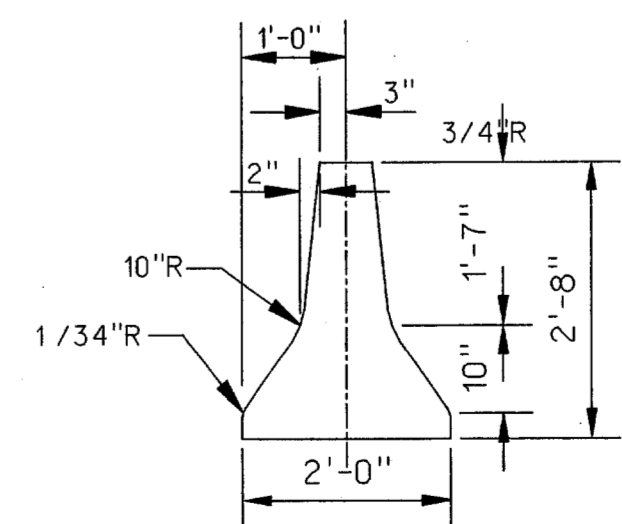

NO.	DATE	REVISION	APPROV.
HNTB ARCHITECTS ENGINEERS PLANNERS <i>The HNTB Companies</i>			
TOWN OF ADDISON			
ADDISON AIRPORT PAVEMENT RECONSTRUCTION OF APRON 'A' AND HANGARS 'A', 'B' AND 'C'			
BARRICADE DETAILS			
TOWN OF ADDISON, TEXAS			
Design JSN	Drawn GFS	DATE	PROJECT NO.
Check JDH	Check JSN	MAY 2003	37365
SHEET			25