

MATCH LINE STA. 212+00 SEE SHEET NO. 12

MATCH LINE STA. 212+00

BEGIN CONSTRUCTION TAXIWAY B PAVEMENT
STA: 201+26.84

LEGEND	
○	POWER POLE
⊕	FIRE HYDRANT
★	STROBE LIGHT
■	WATER METER
—	OVERHEAD ELECTRIC
△	WATER VALVE
—	GUY WIRE
□	ELECTRIC BOX
⊞	ELECTRIC VAULT
+	SIGN
▲	SURVEY POINT
•	UNDER GROUND CABLE MARKER
+	BORING HOLE LOCATION
+	TAXIWAY/RUNWAY SIGN
+	CONC PAD
▨	CONCRETE PAVEMENT
▨	EXIST. RUNWAY LIGHT
▨	ACP OVERLAY
▨	LIMITS OF MILLING

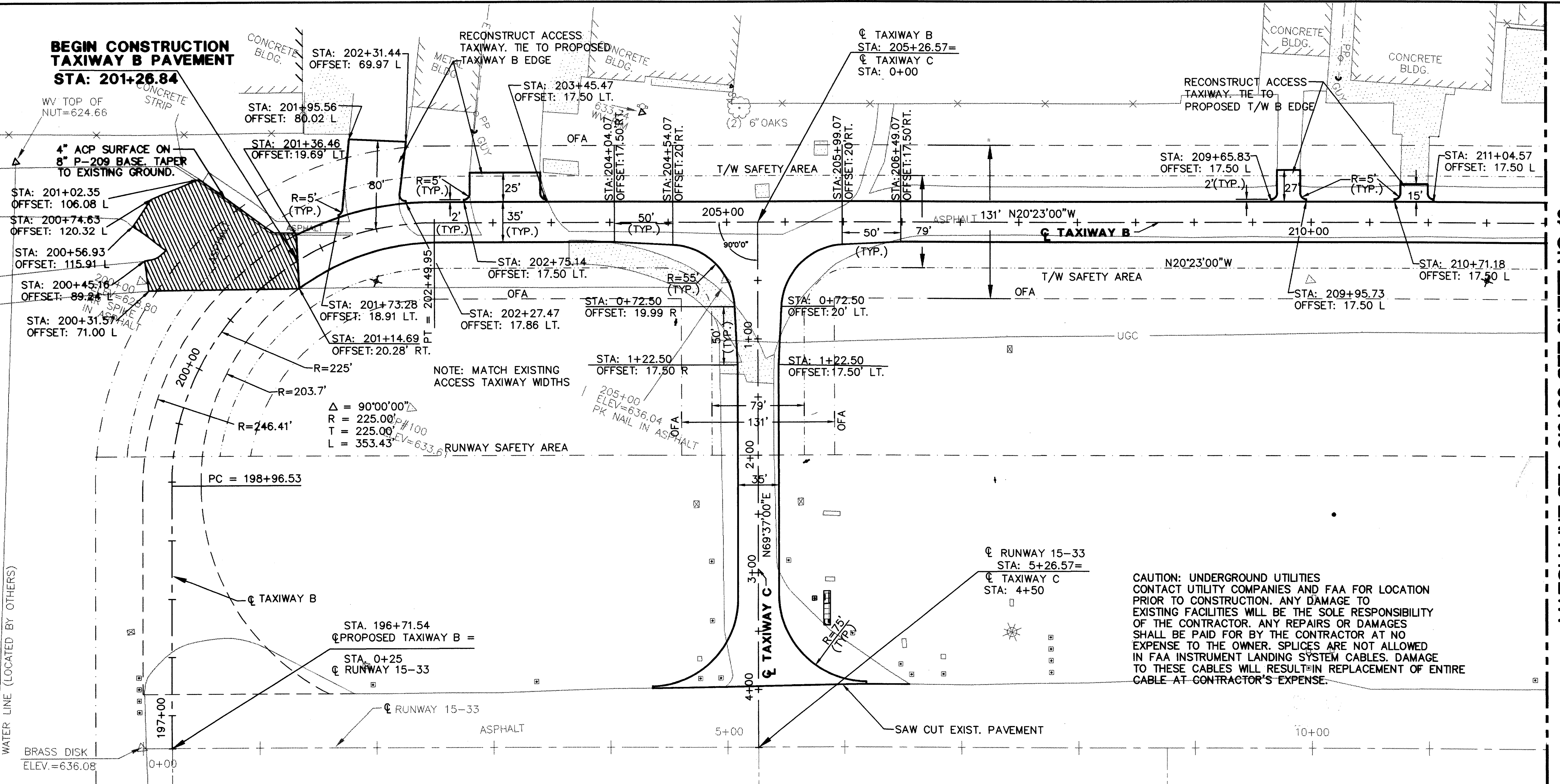
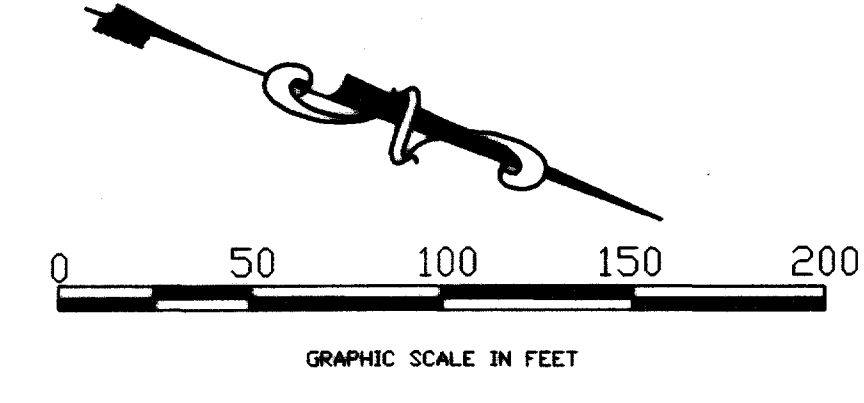

CAUTION: UNDERGROUND UTILITIES CONTACT UTILITY COMPANIES AND FAA FOR LOCATION PRIOR TO CONSTRUCTION. ANY DAMAGE TO EXISTING FACILITIES WILL BE THE SOLE RESPONSIBILITY OF THE CONTRACTOR. ANY REPAIRS OR DAMAGES SHALL BE PAID FOR BY THE CONTRACTOR AT NO EXPENSE TO THE OWNER. SPLICES ARE NOT ALLOWED IN FAA INSTRUMENT LANDING SYSTEM CABLES. DAMAGE TO THESE CABLES WILL RESULT IN REPLACEMENT OF ENTIRE CABLE AT CONTRACTOR'S EXPENSE.

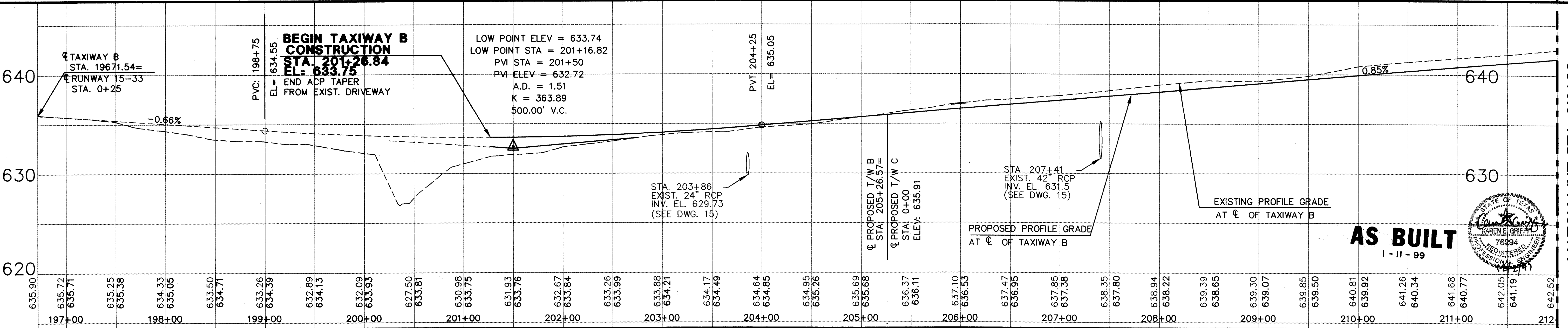

AS BUILT
 1 - 11 - 99

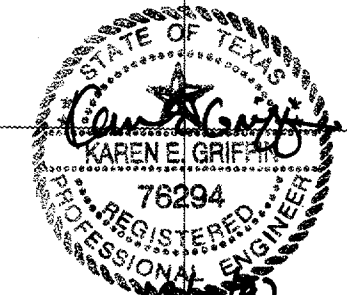

DESIGN: T.L.T.	PROJECT NO: 9842 ADDSN
DRAWN: M.J.G.	REV NO: 04
CHECKED: R.B.	JOB NO: E708024.80
SCALE: HORIZ. 1"=50'	
VERT. 1"=5'	

Date	Revisions	By

URS Greiner
 4100 Aron Center Blvd., Suite 108
 Fort Worth, TX 76155
 (817) 545-0891
 Engineers, Architects and Planners



ADDISON AIRPORT

WEST TAXIWAY "B" PLAN AND PROFILE
 STA. 196+71.54 TO STA. 212+00

SHEET 11
 DATE: DEC. 1997