

MATCH LINE - SEE SHEET 42

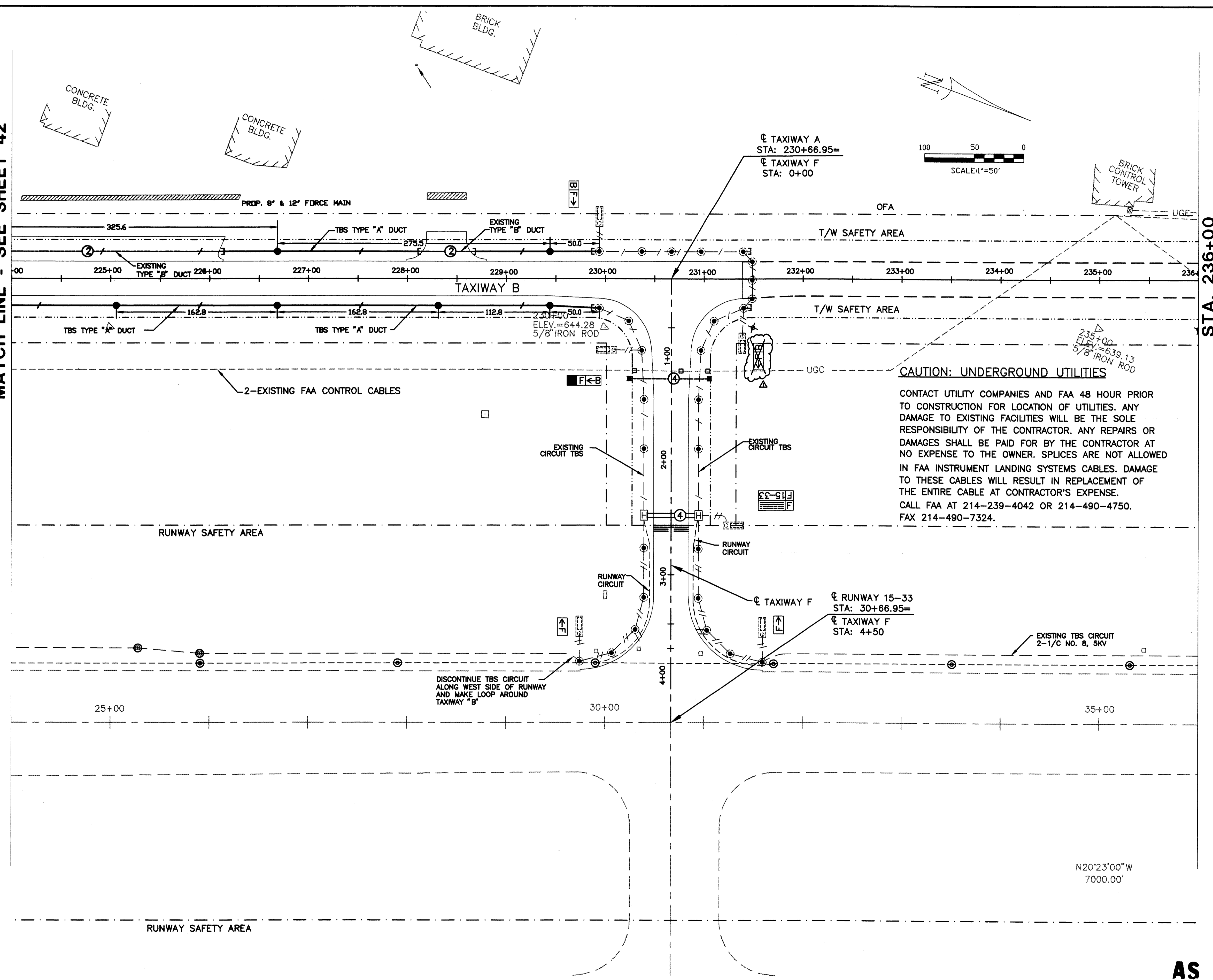

CAUTION: UNDERGROUND UTILITIES

CONTACT UTILITY COMPANIES AND FAA 48 HOUR PRIOR TO CONSTRUCTION FOR LOCATION OF UTILITIES. ANY DAMAGE TO EXISTING FACILITIES WILL BE THE SOLE RESPONSIBILITY OF THE CONTRACTOR. ANY REPAIRS OR DAMAGES SHALL BE PAID FOR BY THE CONTRACTOR AT NO EXPENSE TO THE OWNER. SPLICES ARE NOT ALLOWED IN FAA INSTRUMENT LANDING SYSTEMS CABLES. DAMAGE TO THESE CABLES WILL RESULT IN REPLACEMENT OF THE ENTIRE CABLE AT CONTRACTOR'S EXPENSE. CALL FAA AT 214-239-4042 OR 214-490-4750. FAX 214-490-7324.

LEGEND	
•	POWER POLE
⊕	FIRE HYDRANT
*	STROBE LIGHT
—E—	OVERHEAD ELECTRIC
△	WATER VALVE
—G—	GUY WIRE
⊞	ELECTRIC BOX
+	SIGN
□	UNDER GRD CABLE MRKR
+	BORING HOLE LOCATION
—D—	DISTANCE TO GO SIGN
□	CONC PAD
□	CONCRETE PAVEMENT
—G—	EXIST GUIDANCE SIGN
—	NEW T/W CIRCUIT
---	EXISTING R/W CIRCUIT
---	EXISTING T/W CIRCUIT
⊙	EXISTING T/W LIGHT
⊙	EXISTING RUNWAY LIGHT
○	EXISTING MANHOLE
●	L-861T MTL (BLUE/TAXIWAY LIGHT BASE MOUNTED (NEW))
⊞	NEW HANDHOLE
⊞	L-850C R/W IMPAV LY (WHITE/WHITE/WHITE-YELLOW)
⊞	EXISTING HANDHOLE
②	EXISTING DUCT BANK
④	2-4" PVC DUCTS *
②	1-2" PVC DUCT *
■	DUCT MARKER
—	5' STUBOUT & CAP

* NUMBER IN CIRCLE INDICATES SIZE OF CONDUIT. LINES INDICATE NUMBER OF DUCTS.

ALTERNATE NO. 4

● L-853 ELEVATED RETROREFLECTIVE EDGE MARKER

NOTE: ALTERNATE NO. 4 CONSISTS OF PLACING REFLECTIVE MARKERS IN LIEU OF L-861T EDGE LIGHTS



AS BUILT
1-11-99

DESIGN: R.W.C.	TXDOT NO. 9842 ADDSN	1-11-99 as built Δ	MG
DRAWN: MIR	APP. NO. 8-10-0000-07		
CHECKED: P.S.A.	BID NO. 98-18 98-04		
SCALE: 1" = 50'	JOB NO. F708024.70	Date	Revisions

Greiner, Inc.
Greiner, Inc.
Fort Worth, Texas



ADDISON AIRPORT

ADDITIVE BID NO. 3/4- TAXIWAY "B"
LIGHTING LAYOUT - STA. 224+00 TO 236+00