

- Notes:
1. Water Mains shall have minimum cover of 4'-0"
 2. City of Addison Standard Specifications apply to this project.
 3. Connection to existing system shall be made after 11:00PM.
 4. Performance bond shall cover one (1) year maintenance guarantee period.

**ADDISON AIR INDUSTRIAL
WATER SYSTEM IMPROVEMENTS**

HOMER A. HUNTER ASSOCIATES CONSULTING ENGINEERS DALLAS, TEXAS		
DESIGNED: E.M.R.	APPROVED:	
October, 1961		

2

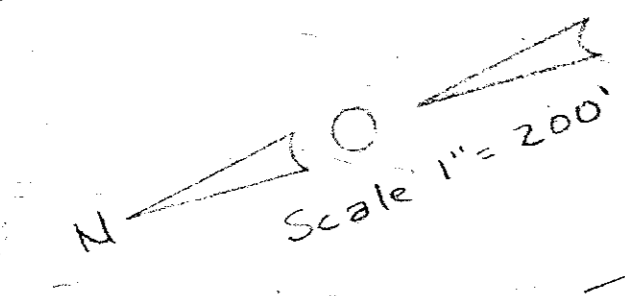
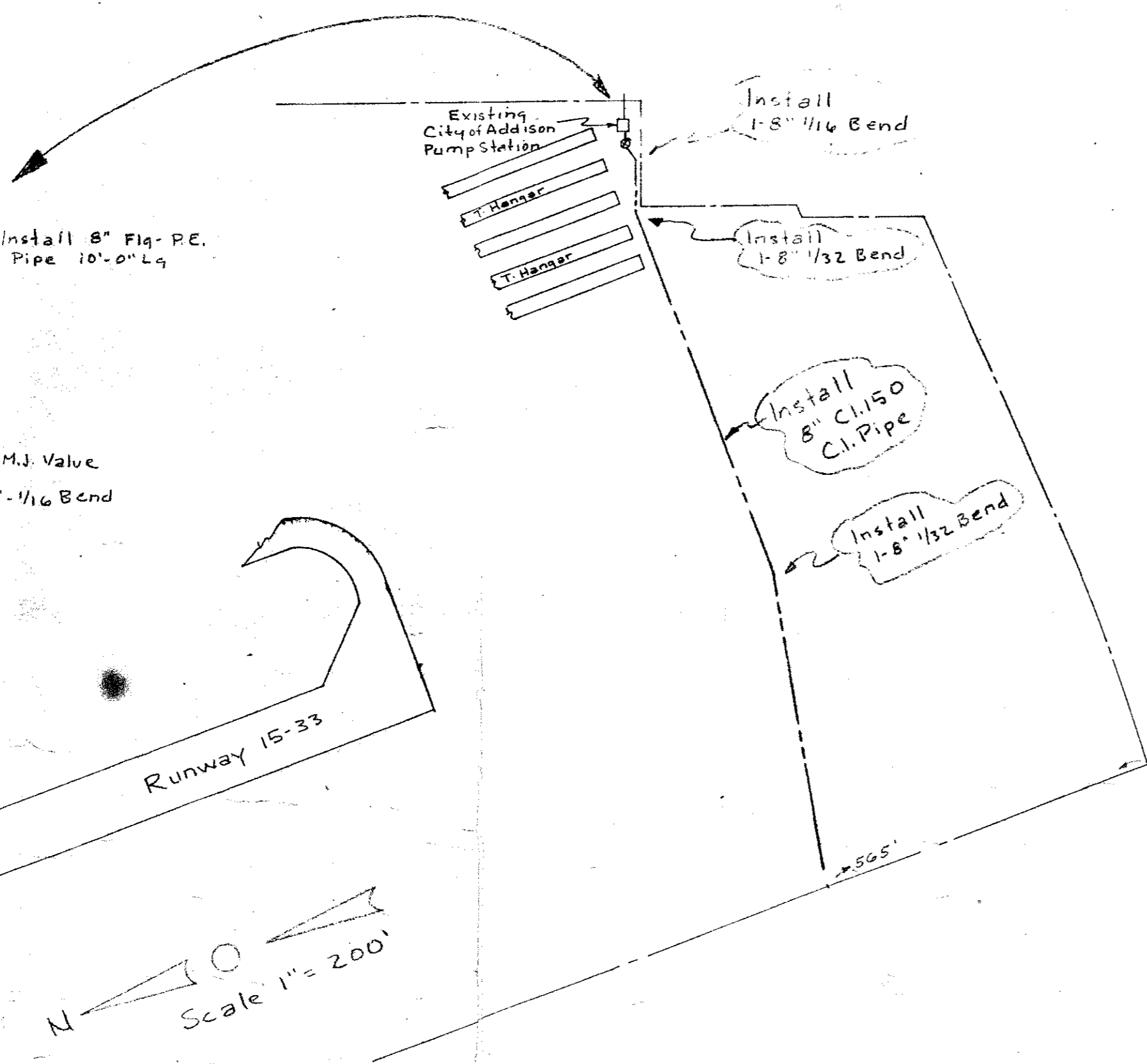
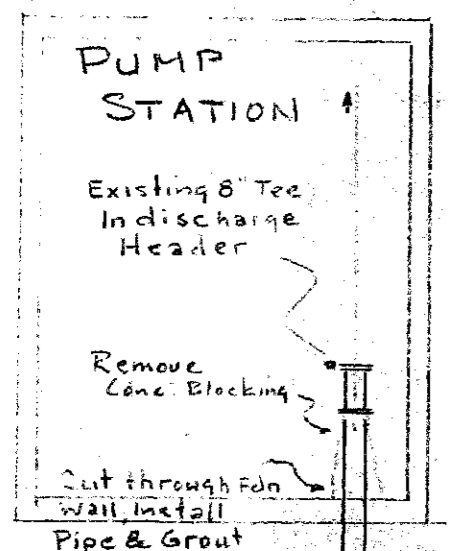

CONNECTION
ADDISON PUMP STATION TO ADDISON AIR
INDUSTRIAL

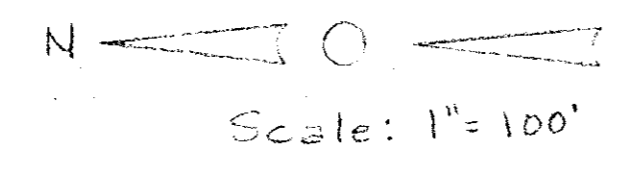
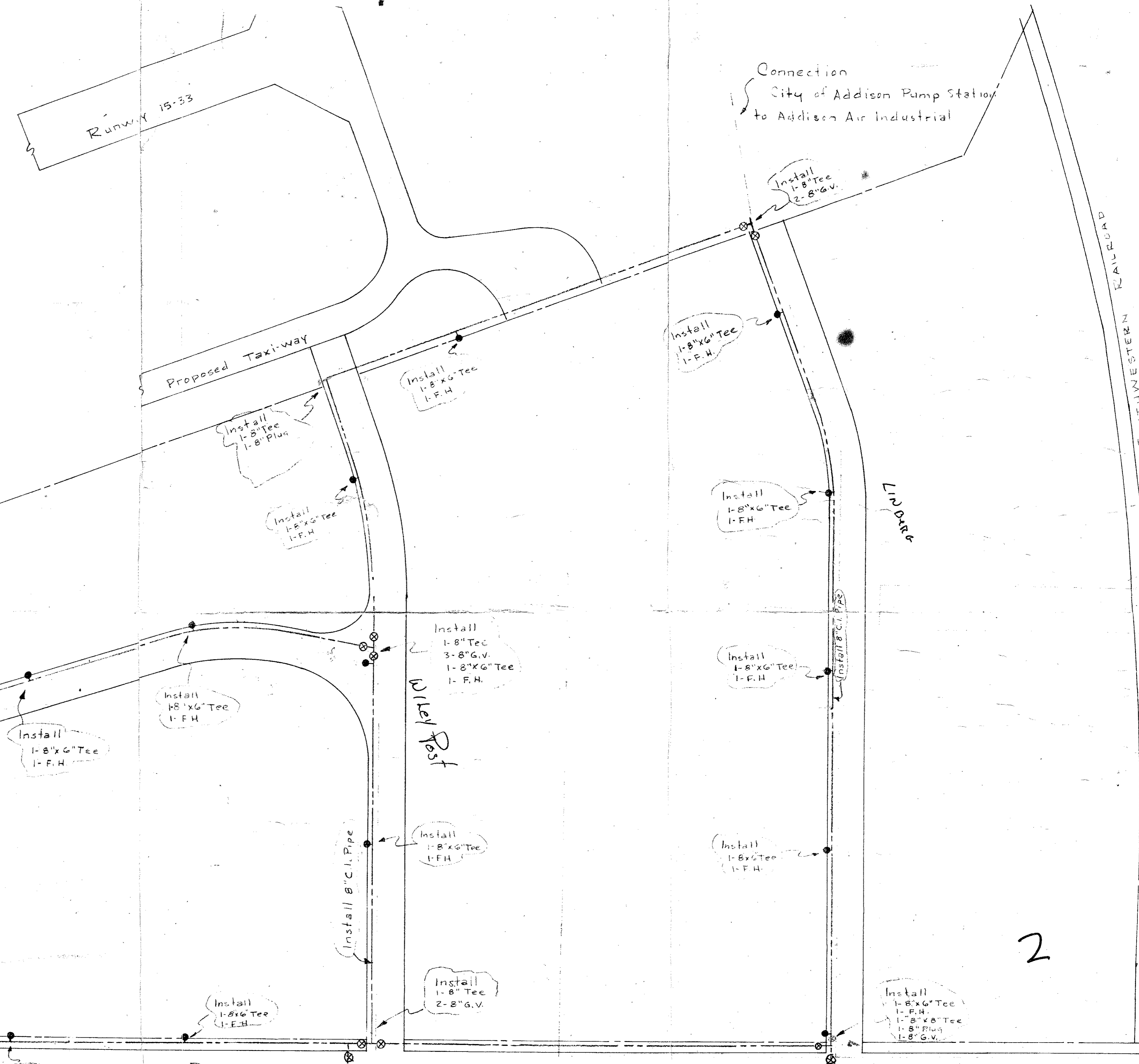

- Notes:
1. Water Mains shall have minimum cover of 4'-0"
 2. City of Addison Standard Specifications apply to this project.
 3. Connection to existing system shall be made after 11:00 P.M.
 4. Performance bond shall cover one (1) year maintenance guarantee period.

ADDISON AIR INDUSTRIAL
WATER SYSTEM IMPROVEMENTS

HOMER A. HUNTER ASSOCIATES
CONSULTING ENGINEERS
DALLAS, TEXAS

DESIGNED: E.M.R. APPROVED: [Signature]
October 1961

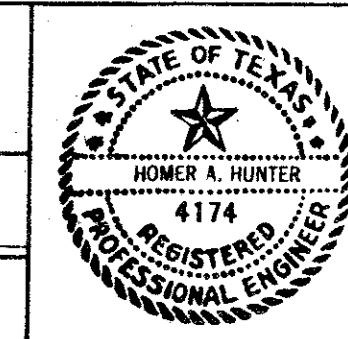

2

