

ADDISON AIRPORT

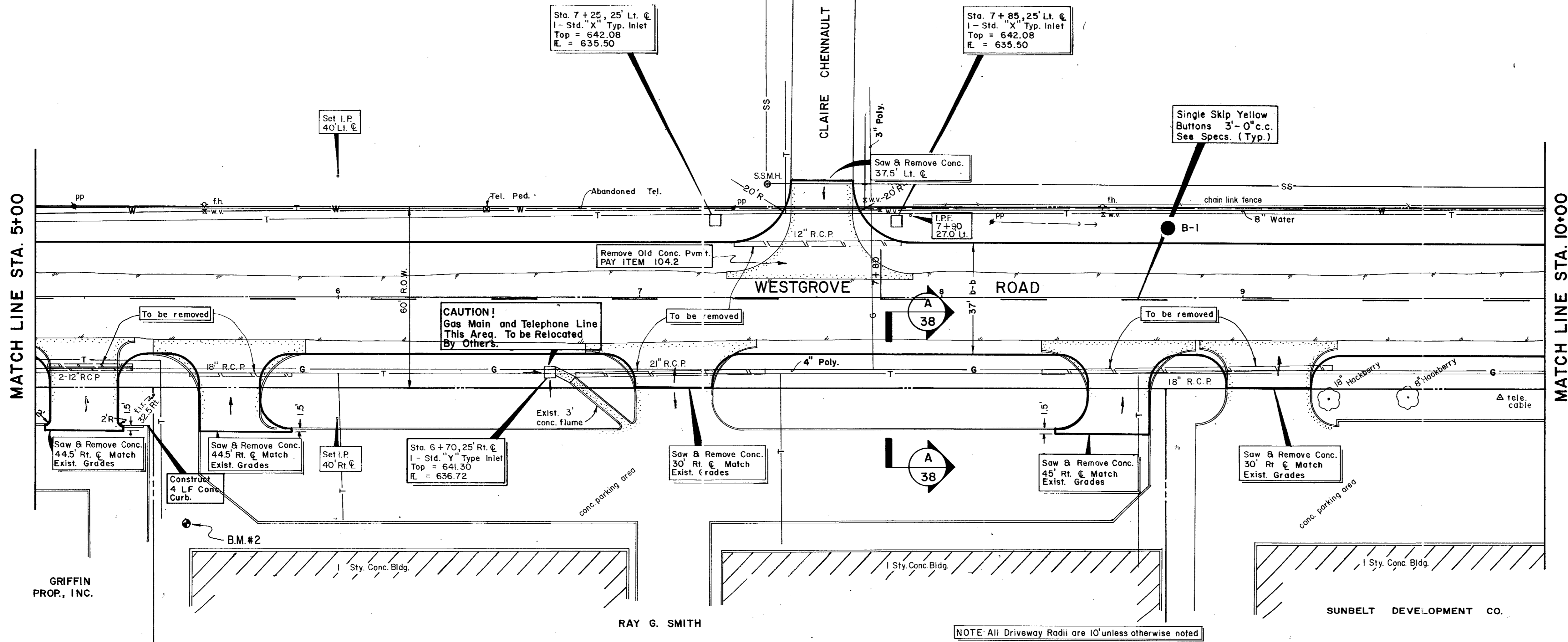

B.M. #2 - 2' cut on first step East corner. 4559 Westgrove Sta. 5+50± ELEV. 644.46

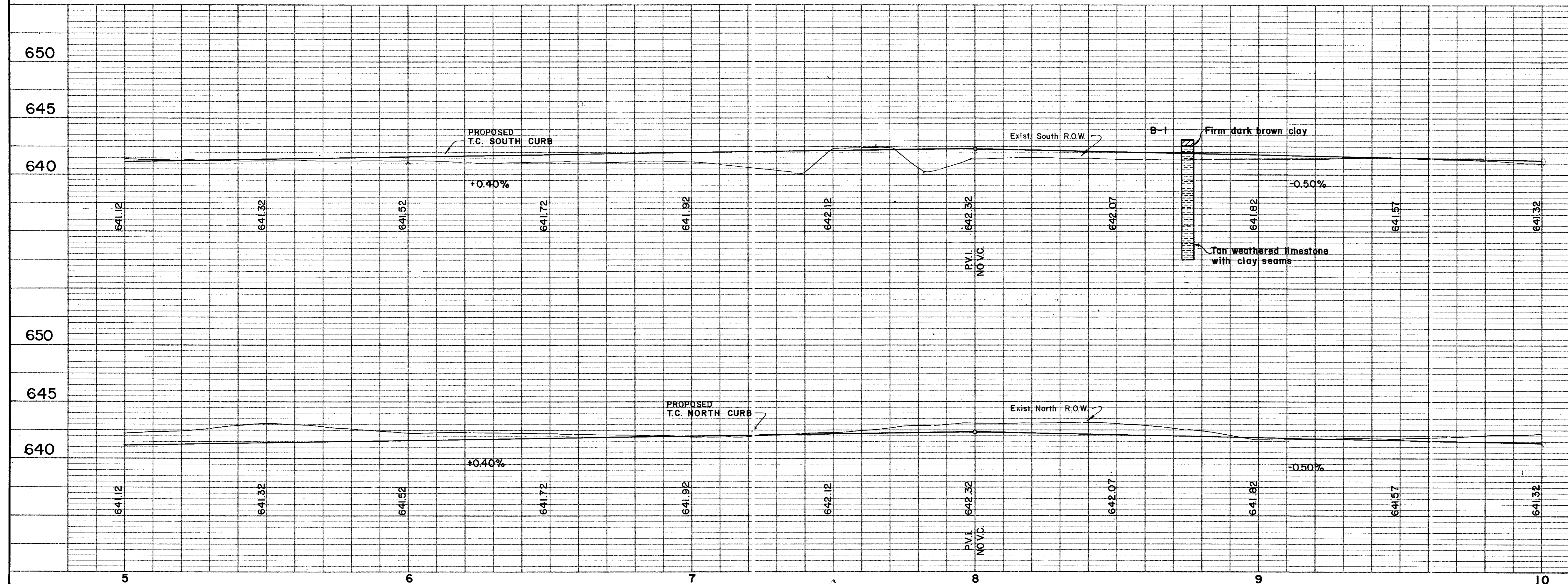

Record Set 5/9/85

NO.	REVISION	BY	DATE
CITY OF ADDISON DALLAS COUNTY, TEXAS			
WESTGROVE/VOSS ROAD IMPROVEMENTS			
PAVING Sta. 5+00 to 10+00			
GINN, INC. Consulting Engineers - Dallas, Texas			
DESIGNED-H.J.	DRAWN-RB/LA	DATE-SEPT., 1982	FILE J-192
APPROVED-H.W.G.	CHECKED-HBJ	SCALE-H-1"=20'/V-1"=5'	SHEET 5 OF 5