

ADDISON AIRPORT

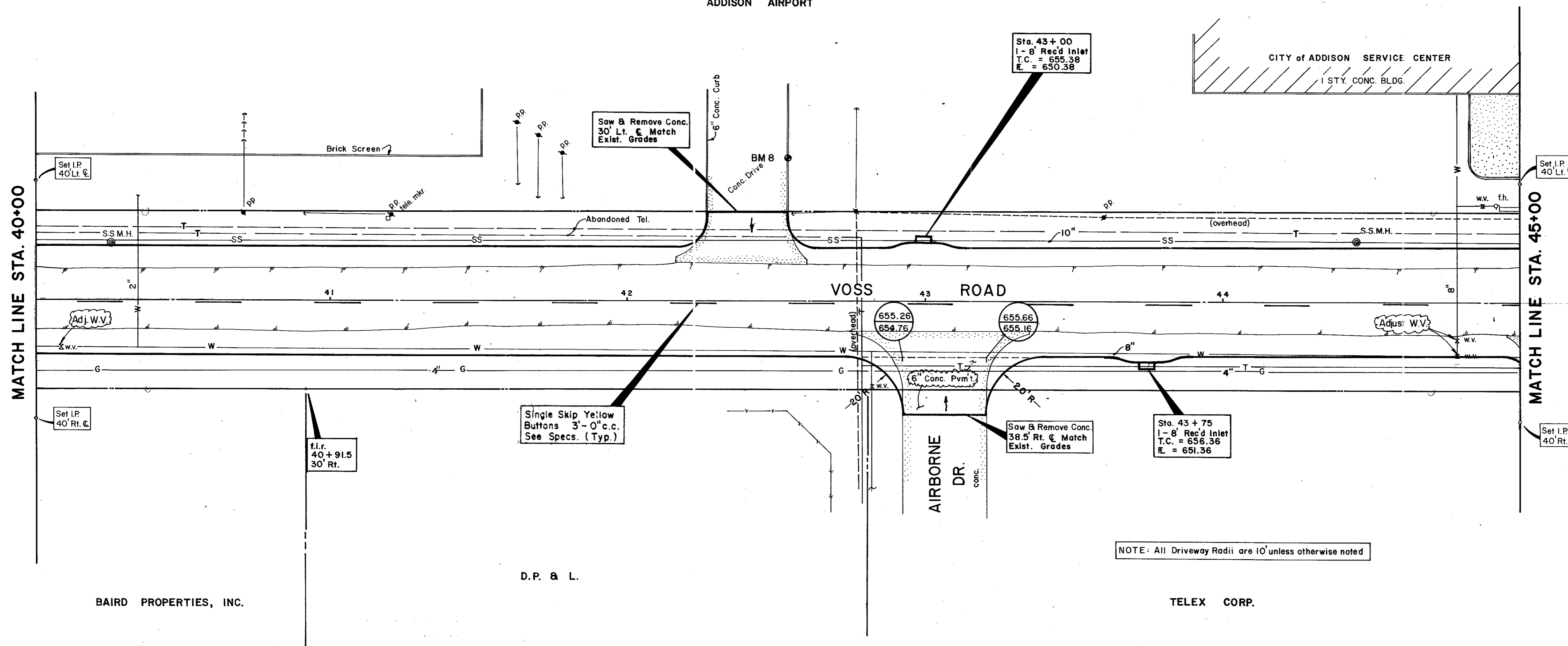

Sta. 43+00
1-8' Rec'd Inlet
T.C. = 655.38
E. = 650.38

Saw & Remove Conc.
30' Lt. & Match
Exist. Grades

Single Skip Yellow
Buttons 3'-0" c.c.
See Specs. (Typ.)

Saw & Remove Conc.
38.5' Rt. & Match
Exist. Grades

Sta. 43+75
1-8' Rec'd Inlet
T.C. = 656.36
E. = 651.36

NOTE: All Driveway Radii are 10' unless otherwise noted

B.M.#8 - "□" cut on T.C. No. side of Drive
50' Lt. Sta. 42+55
ELEV. 654.92

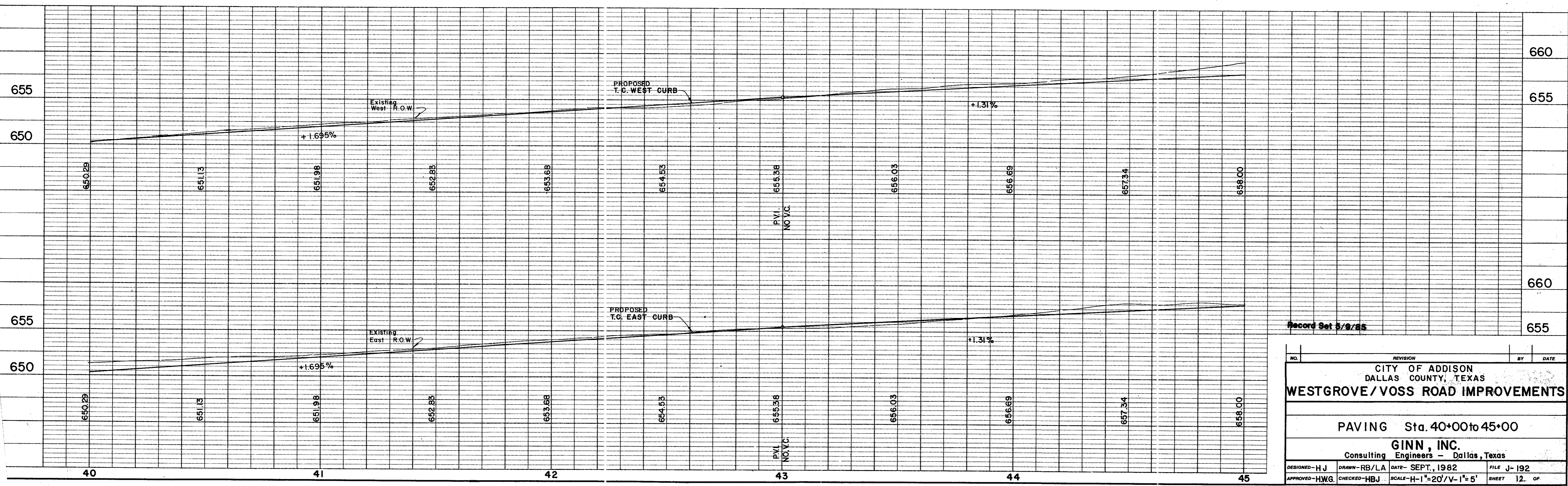

NO.	REVISION	BY	DATE
CITY OF ADDISON DALLAS COUNTY, TEXAS			
WESTGROVE/VOSS ROAD IMPROVEMENTS			
PAVING Sta. 40+00 to 45+00			
GINN, INC. Consulting Engineers - Dallas, Texas			
DESIGNED - HJ	DRAWN - RB/LA	DATE - SEPT., 1982	FILE - J-192
APPROVED - HWG	CHECKED - HBJ	SCALE - H-1"=20'/V-1"=5'	SHEET 12 OF