

CONNELL DEVELOPMENT CO.

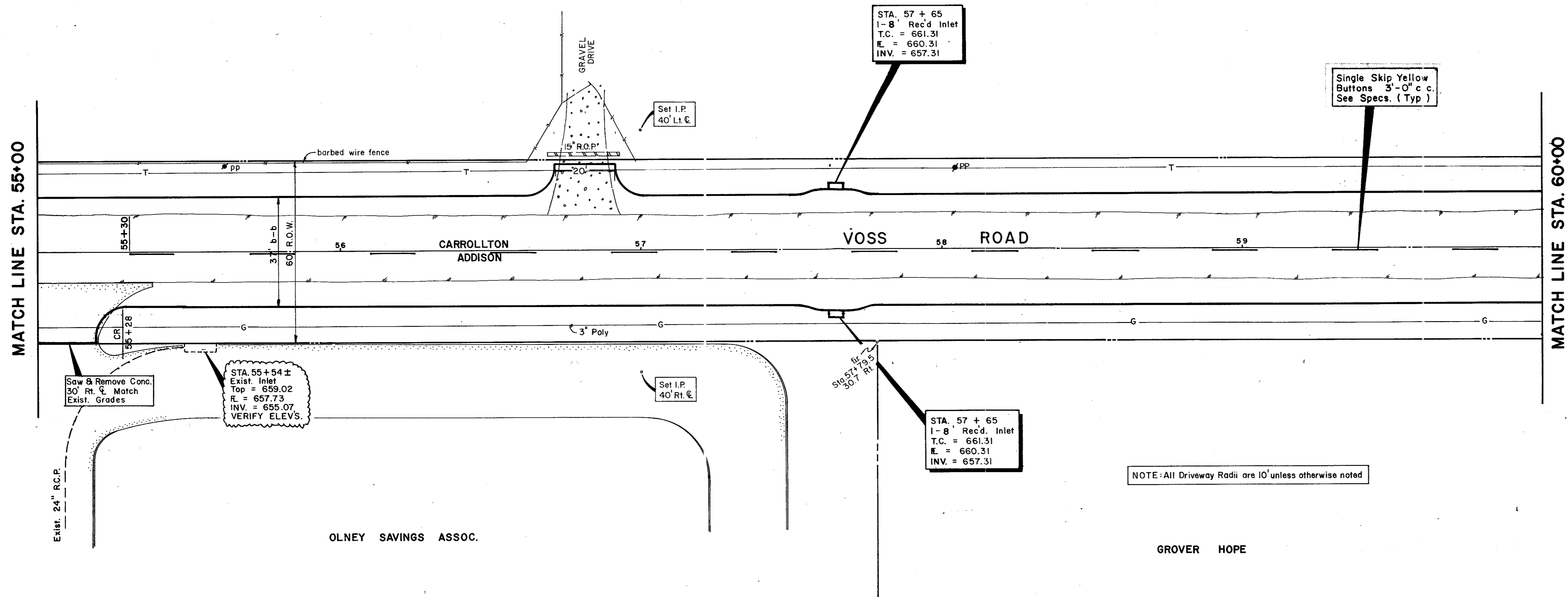

OLNEY SAVINGS ASSOC.

GROVER HOPE

NOTE: All Driveway Radii are 10' unless otherwise noted

B.M. #9-10 cut on T.C. No. side Sojourn Ln.
55' Rt. Sta. 51+25
ELEV. 660.49

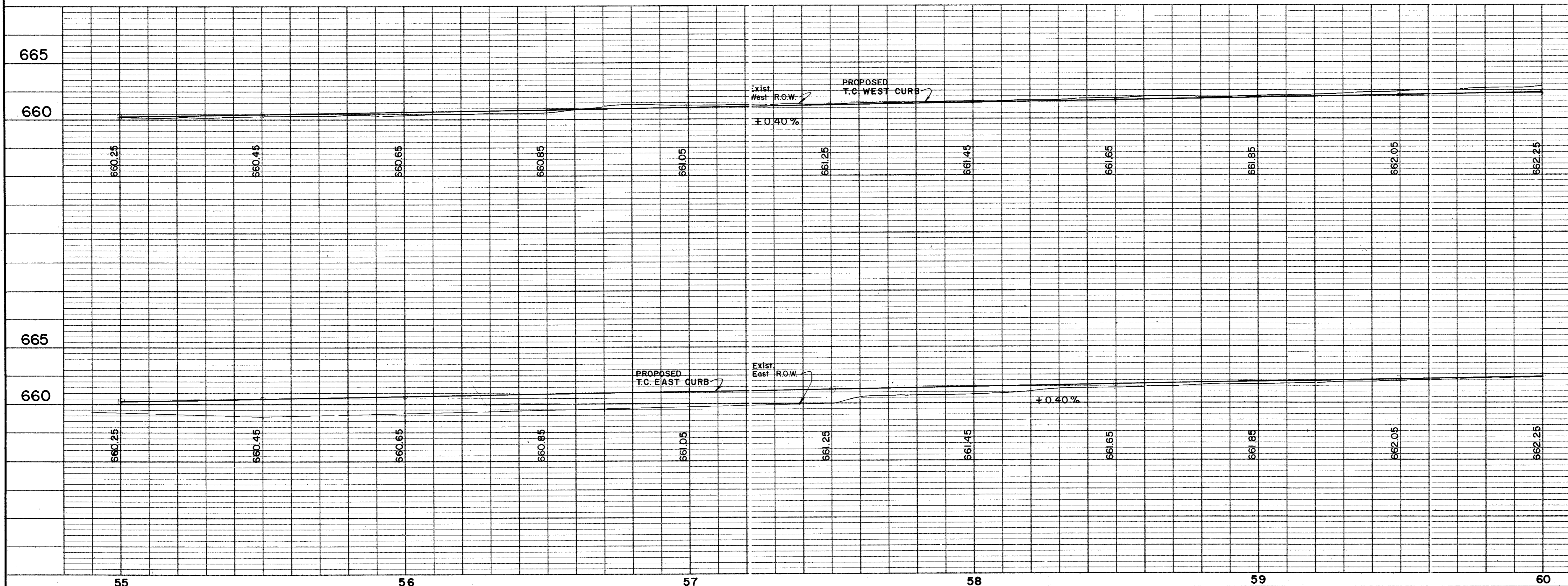

Record Set 5/9/85

NO.	REVISION	BY	DATE
CITY OF ADDISON DALLAS COUNTY, TEXAS			
WESTGROVE/VOSS ROAD IMPROVEMENTS			
PAVING Sta. 55+00 to 60+00			
GINN, INC. Consulting Engineers - Dallas, Texas			
DESIGNED-HJ	DRAWN-RB/LA	DATE- SEPT., 1982	FILE J-192
APPROVED-HWG	CHECKED-HBJ	SCALE-H-1"=20'/V-1"=5'	SHEET 15 OF

15