

- NOTES:**
- PLANS FOR THE EXISTING STORM SEWER SYSTEM IN DALLAS PARKWAY WERE REVIEWED AT THE TOWN WITH STAFF TO CONFIRM THAT THE CAPACITY SIGNIFICANTLY EXCEEDS THE FLOW FROM SNK'S MIXED USE DEVELOPMENT. SPECTRUM DRIVE INTERCEPTED A LARGE PORTION OF THE DRAINAGE AREA ORIGINALLY DESIGNED FOR THE TWO 27" STUBOUTS FROM DALLAS PARKWAY AT SNK'S SOUTHEAST CORNER.
 - OFF-SITE DRAINAGE AREAS TAKEN FROM DALLAS PARKWAY, SPECTRUM DRIVE AND THE MADISON DEVELOPMENT PLANS.

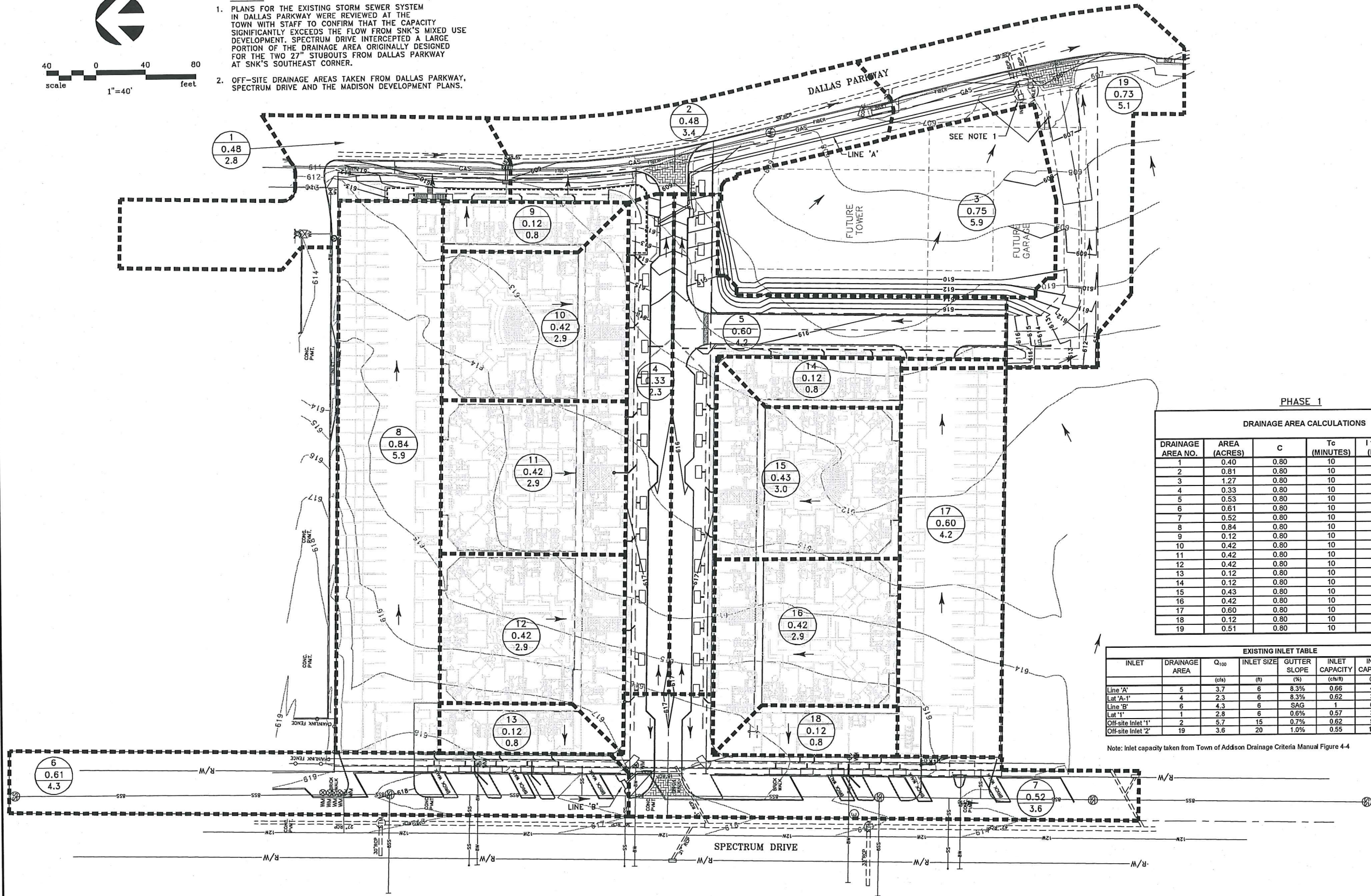

PHASE 1

DRAINAGE AREA CALCULATIONS

DRAINAGE AREA NO.	AREA (ACRES)	C	Tc (MINUTES)	1 100 YR (IN/HR)	Q (cfs) (100-YR)
1	0.40	0.80	10	8.74	2.8
2	0.81	0.80	10	8.74	5.7
3	1.27	0.80	10	8.74	8.9
4	0.33	0.80	10	8.74	2.3
5	0.53	0.80	10	8.74	3.7
6	0.61	0.80	10	8.74	4.3
7	0.52	0.80	10	8.74	3.6
8	0.84	0.80	10	8.74	5.9
9	0.12	0.80	10	8.74	0.8
10	0.42	0.80	10	8.74	2.9
11	0.42	0.80	10	8.74	2.9
12	0.42	0.80	10	8.74	2.9
13	0.12	0.80	10	8.74	0.8
14	0.12	0.80	10	8.74	0.8
15	0.43	0.80	10	8.74	3.0
16	0.42	0.80	10	8.74	2.9
17	0.60	0.80	10	8.74	4.2
18	0.12	0.80	10	8.74	0.8
19	0.51	0.80	10	8.74	3.6

EXISTING INLET TABLE							
INLET	DRAINAGE AREA	Q ₁₀₀	INLET SIZE	GUTTER SLOPE	INLET CAPACITY	INLET CAPACITY	BYPASS FLOW
		(cfs)	(in)	(%)	(cfs)	(cfs)	(cfs)
Line 'A'	5	3.7	6	8.3%	0.66	4.0	0
Lat 'A-1'	4	2.3	6	8.3%	0.62	3.7	0
Line 'B'	6	4.3	6	SAG	1	6.0	0
Lat '1'	1	2.8	6	0.6%	0.57	3.4	0
Off-site Inlet '1'	2	5.7	15	0.7%	0.62	9.3	0
Off-site Inlet '2'	19	3.6	20	1.0%	0.55	11.0	0

Note: Inlet capacity taken from Town of Addison Drainage Criteria Manual Figure 4-4

DRAINAGE AREA CALCULATIONS
REVISED FROM PHASE 1

DRAINAGE AREA NO.	AREA (ACRES)	C	Tc (MINUTES)	1 100 YR (IN/HR)	Q (cfs) (100-YR)
2	0.48	0.80	10	8.74	3.4
3	0.75	0.90	10	8.74	5.9
5	0.60	0.80	10	8.74	4.2
19	0.73	0.80	10	8.74	5.1

LEGEND:

- DRAINAGE AREAS
- ==== PROPOSED STORM
- ==== EXISTING STORM
- 1.66 → DRAINAGE AREA
- 8.0 → ACRES
- 8.0 → Q₁₀₀
- FLOW ARROW

NO.	DATE	REVISION	APPROV.

GRANTHAM & ASSOCIATES
F-005438

STATE OF TEXAS
P. CHRISTOPHER ROBINSON
101252
REGISTERED PROFESSIONAL ENGINEER

THE SEAL APPEARING ON THIS DOCUMENT WAS AUTHORIZED BY:
P. CHRISTOPHER ROBINSON
ON 12/1/11
ALTERATION OF A SEALED DOCUMENT WITHOUT PROPER NOTIFICATION TO THE RESPONSIBLE ENGINEER IS AN OFFENSE UNDER THE TEXAS ENGINEERING PRACTICE ACT.