

TYPICAL 5" PAVEMENT SECTION  
N.T.S.

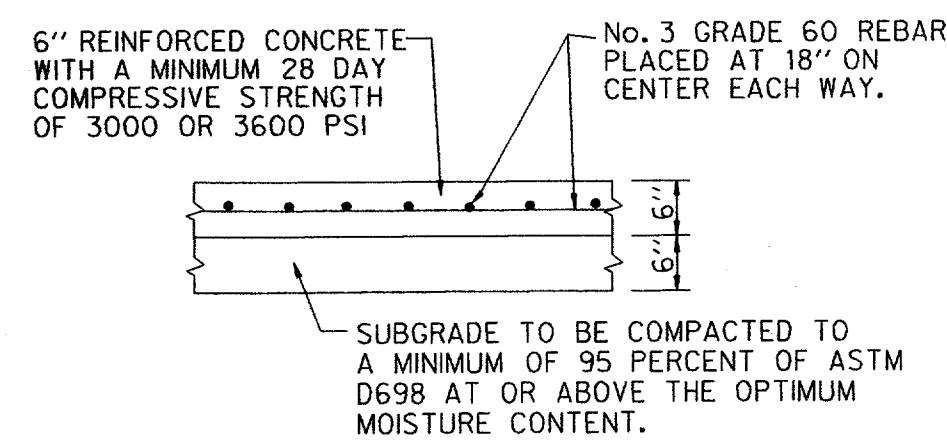

TYPICAL 6" PAVEMENT SECTION  
N.T.S.

REINFORCED CONCRETE SIDEWALK

1/2" Dowel Expansion Joint with Expansion Joint Filler Every 117' (MAX.) AND AT ALL RADIUS POINTS

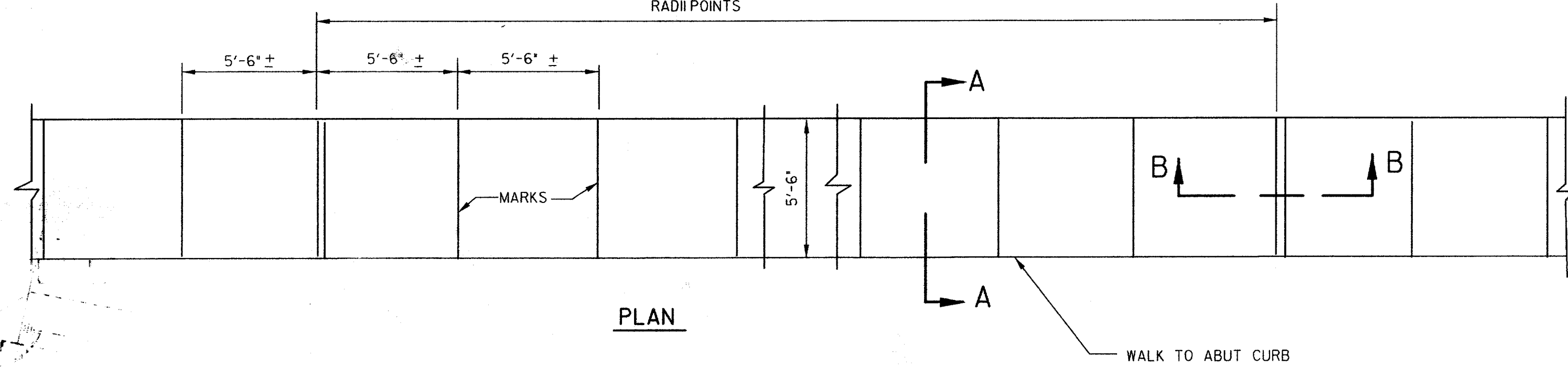

PLAN

THIS SIDEWALK DESIGN IS APPROVED BY THE PARK DEPARTMENT FOR USE ALONG CITY PARK PROPERTY.

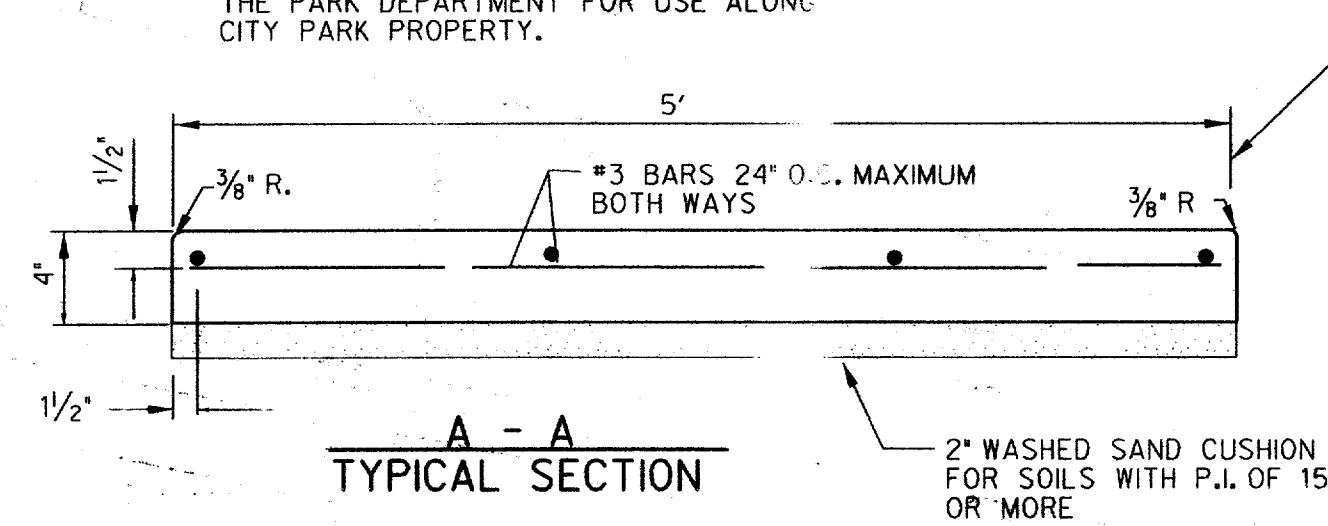

A - A  
TYPICAL SECTION

FINISH TO BE LIGHT BRUSH OR SWEAT FINISH

# 3 BARS 24" O.C. MAXIMUM BOTH WAYS

1/2" NON-EXTRUDED PRE-FORMED EXPANSION MATERIAL  
THIS HALF OF DOWEL TO BE COATED WITH ASPHALT

4 1/2" METAL SLEEVE  
WADDLED PAPER OR OTHER DRY COMPRESSIBLE SUBSTANCE

#6 X 24" SMOOTH ROUND BAR 24" O.C. MAXIMUM

B-B  
EXPANSION JOINT DETAIL

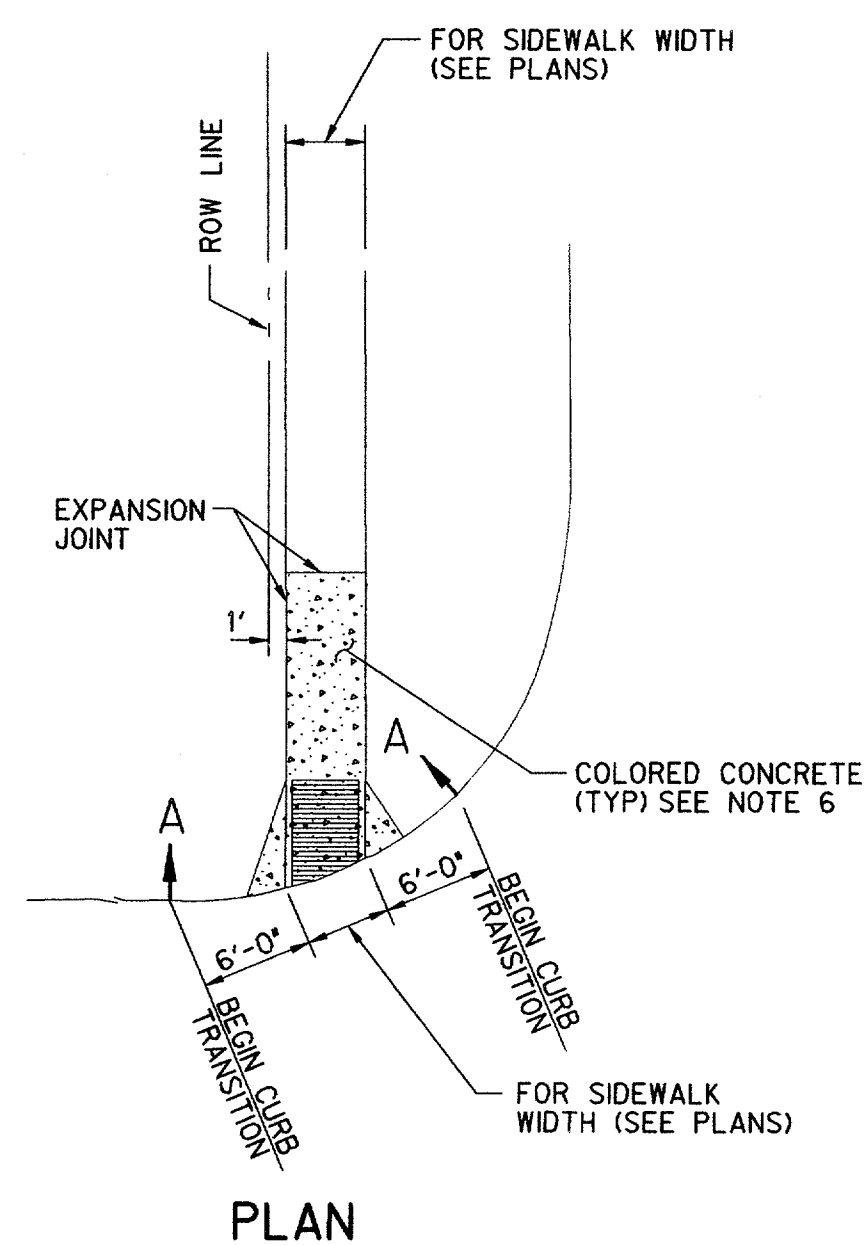

PLAN

CURB RAMP NOTES:

- 1. DETAILS ON THIS PLAN APPLY TO ALL CONSTRUCTION OR RECONSTRUCTION OF CURBS & SIDEWALKS.
- 2. RAMPS SHALL BE PROVIDED AT ALL CORNERS OF STREET INTERSECTIONS OR WHERE THERE IS PROPOSED SIDEWALK AND CURB. RAMPS MAY ALSO BE PLACED AS SHOWN ON THE PLANS OR AS DIRECTED BY THE ENGINEER.
- 3. GROOVES SHALL BE PROVIDED ON ALL RAMPS.
- 4. A 48" LANDING SHALL BE PROVIDED AT THE TOP OF CURB RAMPS WITH A MAXIMUM SLOPE OF 2% IN ALL DIRECTIONS.
- 5. CURB RAMPS SHALL BE LOCATED ENTIRELY WITHIN ANY CROSSWALK MARKINGS.
- 6. THE FULL WIDTH AND DEPTH OF THE CURB RAMP CONCRETE SHALL BE COLORED WITH LAMBERT COLOR HARDENER, COLOR 219-1096 SUPER IRON BLACK, OR EQUAL. THE CONTRACTOR SHALL FOLLOW THE MANUFACTURER'S RECOMMENDED INSTALLATION PROCEDURE'S AND AN APPLICATION RATE OF 1.35 POUNDS OF COLOR HARDENER PER SQUARE YARD OF CONCRETE

- 1. ALL HOUSING IN BACK OF CURB TO BE TROWEL- PLASTERED BEFORE POURING SIDEWALK
- 2. LUG MAY BE FORMED BY SHAPING SUBGRADE TO APPROXIMATE DIMENSIONS SHOWN.
- 3. FOR SIDEWALKS AGAINST EXISTING CURB, KEYWAY SHALL BE REPLACED WITH 6" LONG #3 BARS DRILLED 4" INTO EXISTING BACK CURB AND EPOXY GROUTED ON 24" CENTERS.
- 4. PAYMENT FOR KEYWAY SUBSIDIARY TO SIDEWALK LUG PAY ITEM.
- 5. PAYMENT FOR EXCAVATION, BORROW, SUBGRADE STABILIZATION, AND COMPACTION IS SUBSIDIARY TO CONCRETE SIDEWALK PAY ITEM.
- 6. LIME STABILIZATION OR SELECT BORROW MATERIAL FOR SUBGRADE IS REQUIRED WHEN SOIL P.I. IS GREATER THAN 18. LIMITS OF SUBGRADE STABILIZATION ARE MINIMUM REQUIRED.
- 7. BACKFILL FOR SIDEWALK SUBGRADE SHALL BE LIME STABILIZED SOIL OR SELECT BORROW MATERIAL HAVING A P.I. NOT LESS THAN 10 NOR GREATER THAN 18.
- 8. SIDEWALK BACKFILL AND SUBGRADE SHALL BE COMPACTED IN LIFTS NOT TO EXCEED 6 INCHES TO 95% OF ASTM D698 DENSITY WITH A MOISTURE WITHIN -2% TO -4% OF OPTIMUM MOISTURE.
- 9. 1/2" EXPANSION JOINTS SHALL BE PROVIDED AT STREET EXPANSION JOINTS AND AT A MAXIMUM 40 FOOT SPACING IN LINE WITH STREET SAW JOINTS; A TOOL MARKED GROOVE SHALL BE PROVIDED IN LINE WITH INTERMEDIATE STREET SAW JOINTS.

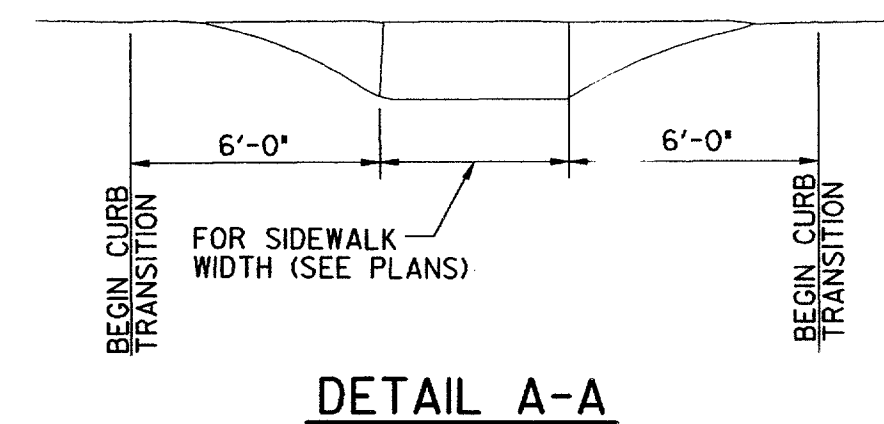

DETAIL A-A

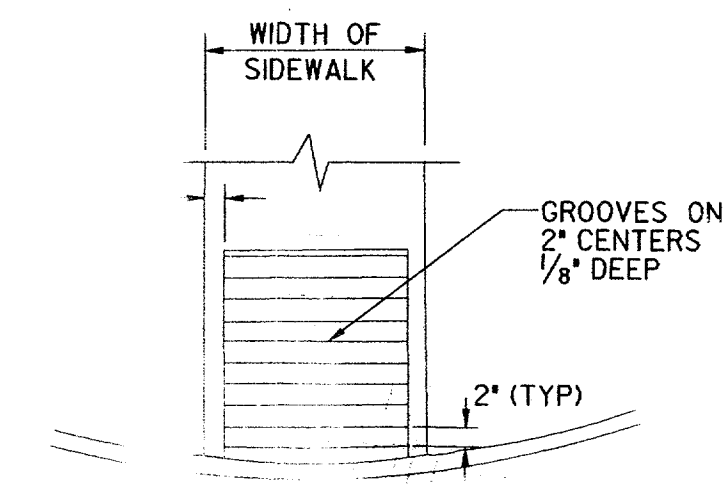

GROOVE DETAIL

AS-BUILT PLAN BASED ON CONTRACTOR'S RECORD DRAWINGS

OSTEOMED CORPORATION FACILITY  
ADDISON, TEXAS

THE S.E. ENGINEER ON THIS DOCUMENT WAS AUTHORIZED AT THE TIME OF DESIGN AND CONSTRUCTION BY THE STATE OF TEXAS UNDER A PROFESSIONAL ENGINEERING PRACTICE ACT. THE ENGINEER'S OFFICE IS REGISTERED AT THE OFFICE OF HOLF ASSOCIATES, INC. 816 NORTHWEST PLAZA DRIVE, DALLAS, TEXAS 75225

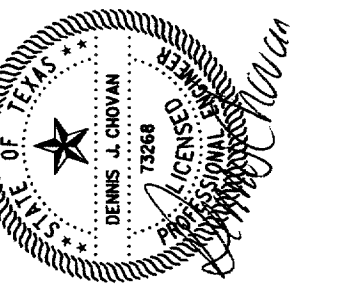

Half Associates, Inc.  
ENGINEERS • ARCHITECTS • SCIENTISTS • PLANNERS • SURVEYORS  
8616 NORTHWEST PLAZA DRIVE  
DALLAS, TEXAS 75225  
TEL (214) 346-0200  
FAX (214) 759-0095

Project No: AVO # 20079	
Issued: 05/13/02	
Revisions:	
No.	Date Description
Drawn by: DD	
Checked by: DJC	
Sheet Title	
PAVING & DIMENSION CONTROL DETAILS	
C4.2	
Sheet Number	