

SOUTHERN PACIFIC RAILROAD
(100' R.O.W.)

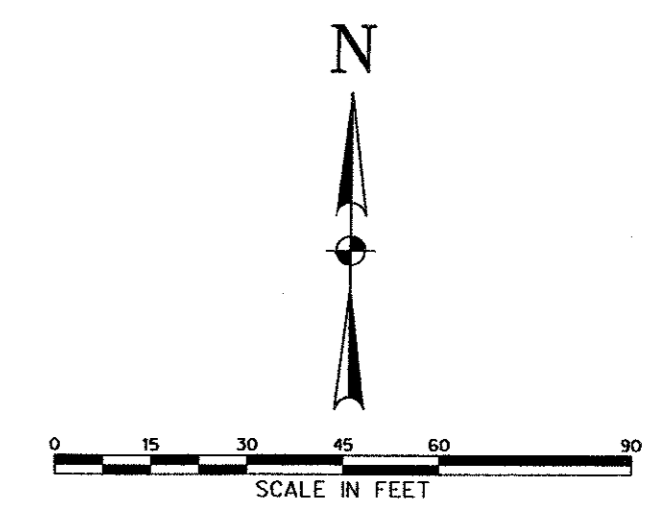

- LEGEND**
- 8" SS EXIST. SANITARY SEWER
 - 12" W EXIST. WATER
 - RCP EXIST. STORM SEWER
 - OVERHEAD ELECTRIC
 - PROPOSED SANITARY SEWER
 - 6" W PROPOSED WATER
 - 12" RCP PROPOSED STORM SEWER
 - PROPERTY LINE
 - EASEMENT LINE
 - PROPOSED DRAINAGE DIVIDE

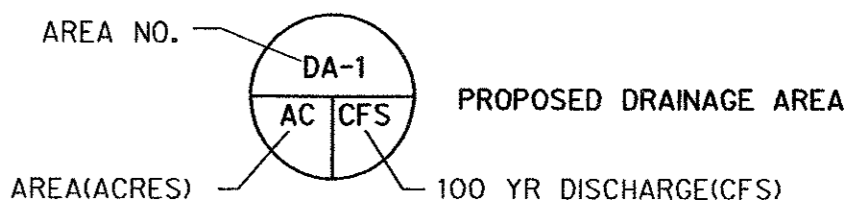

$Q_{100} = C \cdot I \cdot A$
 Q_{100} (100 YR DISCHARGE) = CFS
 C = (RUNOFF COEFFICIENT) = 0.9
 I = (RAINFALL INTENSITY) = 8.74 IN/HR
 A = (AREA) = ACRES
 T_c = (TIME OF CONCENTRATION) = 10 MIN.

BELT LINE - MARSH BUSINESS PARK
LOT 1, BLOCK 1
VOL. 83042, PG. 425
D.R.D.C.T.

TEXAS POWER & LIGHT CO.
VOL. 80006, PG. 489
D.R.D.C.T.

THE SEAL APPEARING ON THIS DOCUMENT WAS AUTHORIZED BY DENNIS J. CHOWAN, P.E., LICENSE NO. 03-21-02. PROPER NOTIFICATION TO THE RESPONSIBLE ENGINEER IS AN OFFENSE UNDER THE TEXAS ENGINEERING PRACTICE ACT. THIS DOCUMENT IS THE PROPERTY OF HALFF ASSOCIATES, INC. IT IS TO BE USED ONLY FOR THE PROJECT AND AT THE OFFICE OF HALFF ASSOCIATES, INC., 806 NORTHWEST PLAZA DRIVE, DALLAS, TEXAS 75225.

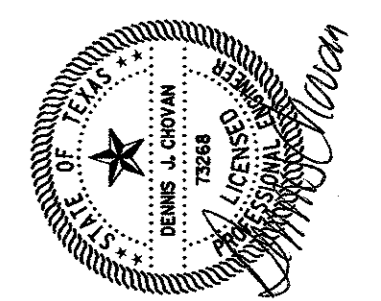

Half Associates, Inc.
 ENGINEERS • ARCHITECTS • SCIENTISTS • PLANNERS • SURVEYORS
 806 NORTHWEST PLAZA DRIVE
 DALLAS, TEXAS 75225
 TEL (214) 346-6200
 FAX (214) 739-0065

Project No: AVO # 20079
 Issued: 08/13/02

Rev.	Date	Description
1	06/02/02	GRADE CHANGE AT NORTH SIDE OF BLDG.
2	6/20/2002	AS PER SITE CHANGES

Drawn by: DD
 Checked by: DJC
 Sheet Title: DRAINAGE AREA MAP
 Sheet Number: C3.1

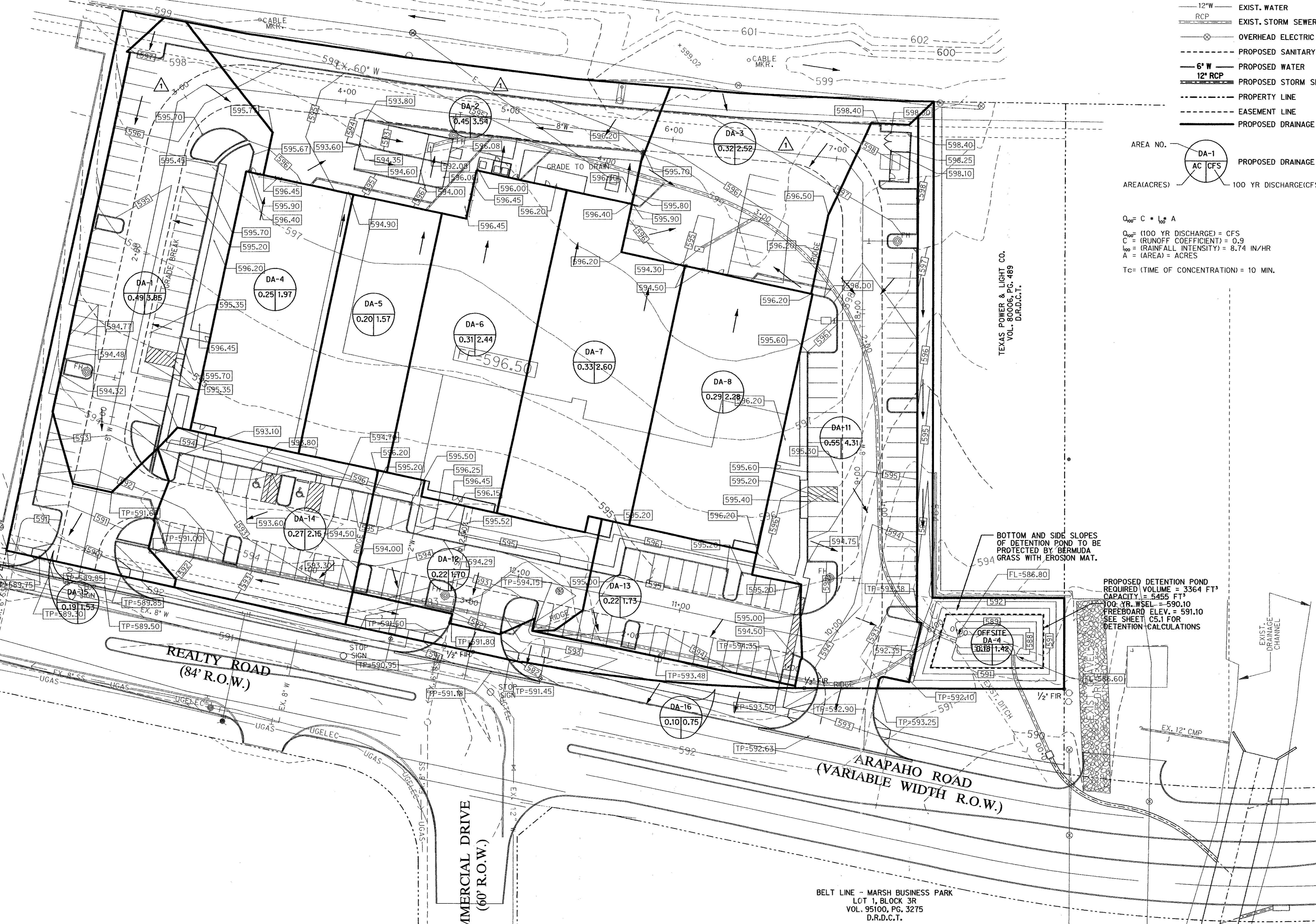

BOTTOM AND SIDE SLOPES OF DETENTION POND TO BE PROTECTED BY BERMUDA GRASS WITH EROSION MAT.

PROPOSED DETENTION POND
 REQUIRED VOLUME = 3364 FT³
 CAPACITY = 5455 FT³
 100 YR. WSEL = 590.10
 FREEBOARD ELEV. = 591.10
 SEE SHEET C5.1 FOR DETENTION CALCULATIONS

BELT LINE - MARSH BUSINESS PARK
LOT 1, BLOCK 3R
VOL. 95100, PG. 3275
D.R.D.C.T.

"AS-BUILT PLAN BASED ON CONTRACTOR'S RECORD DRAWINGS"