

① P.C. STA.  
N. = 10998.05  
E. = 12207.93

② P.T. STA.  
N. = 11019.86  
E. = 12236.52  
R. = 73.81'

③ P.C. STA.  
N. = 11066.44  
E. = 12343.27

④ P.T. STA.  
N. = 11066.69  
E. = 12343.99  
R. = 5'

⑤ P.C. STA.  
N. = 11071.43  
E. = 12362.09

⑥ P.T. STA.  
N. = 11071.68  
E. = 12362.80  
R. = 5'

⑦ P.C. STA.  
N. = 11176.39  
E. = 12602.82

⑧ P.T. STA.  
N. = 11177.60  
E. = 12631.36  
R. = 38.38'

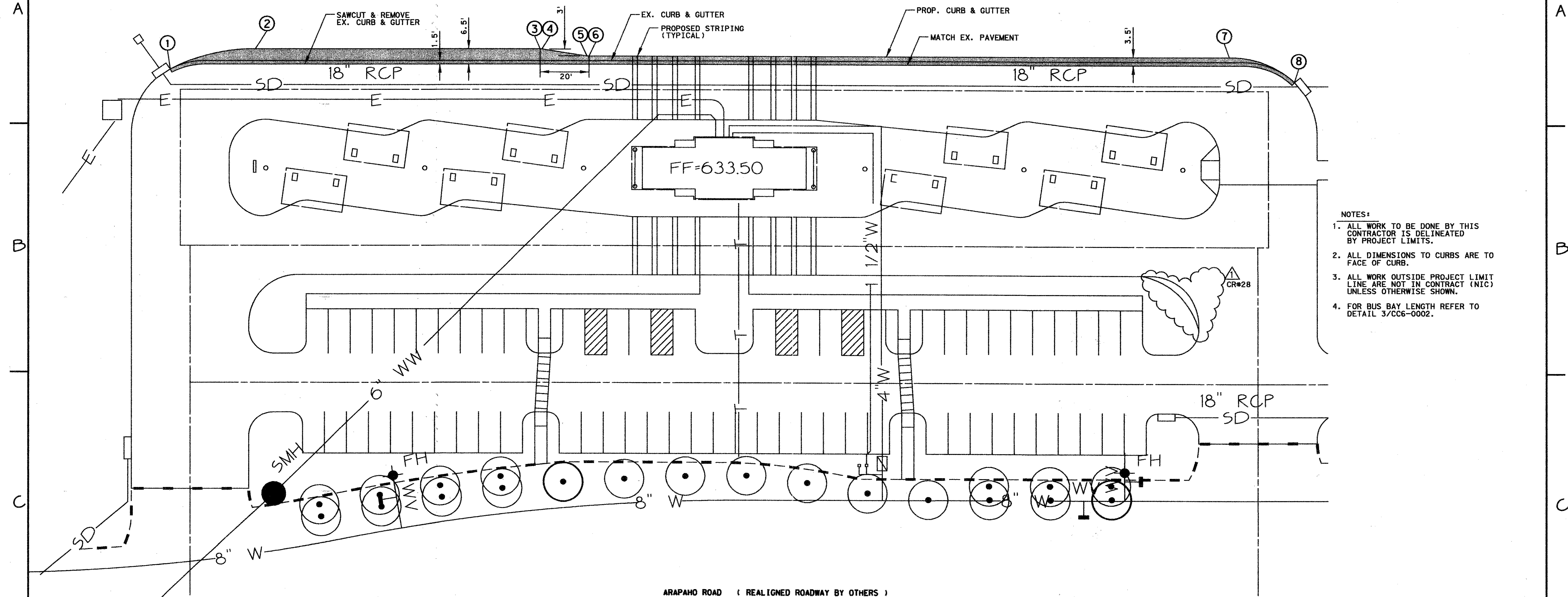
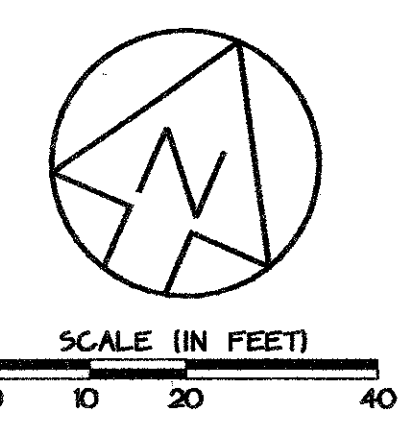

- NOTES:
1. ALL WORK TO BE DONE BY THIS CONTRACTOR IS DELINEATED BY PROJECT LIMITS.
  2. ALL DIMENSIONS TO CURBS ARE TO FACE OF CURB.
  3. ALL WORK OUTSIDE PROJECT LIMIT LINE ARE NOT IN CONTRACT (NIC) UNLESS OTHERWISE SHOWN.
  4. FOR BUS BAY LENGTH REFER TO DETAIL 3/CC6-0002.

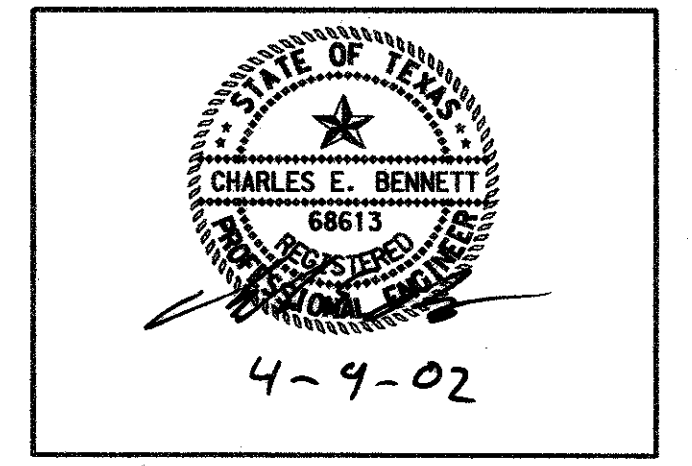

CONTRACT SHEET NO. 4 OF 13

**ADDISON  
TRANSIT CENTER  
EXISTING BUS LANE  
EXPANSION**

CONTRACT C-96000124-28 DWG NO. REV 0

REV	DATE	DESCRIPTION	BY	ENG	CHK	APP	REV	DATE	DESCRIPTION	BY	ENG	CHK	APP

TURNER COLLIE & BRADEN INC.  
LINDA TYCHER & ASSOCIATES  
ARS ENGINEERS INC.

**DART PROJECT**

SCALE: 1"=20'

DRAWN: J. RATCLIFF  
DESIGNED: J. RATCLIFF  
CHECKED: C. BENNETT  
IN CHARGE: G. SHIPPY  
DATE: APRIL 2002