

REFERENCE POINTS		
#	NORTHING	EASTING
1	10920.8449	12110.6895
2	10905.0626	12117.8474
3	10905.6479	12120.7131
4	10912.8135	12120.8772
5	10917.3908	12119.9424
6	10937.3969	12110.9698
7	10942.3534	12121.7973
8	10930.0588	12127.3734
9	10929.3123	12129.3591
10	10929.8905	12130.6340
11	10937.1296	12133.3898
12	10948.5979	12128.3025
13	10970.9031	12177.4826
14	10954.4702	12184.7721
15	10951.6671	12192.0168
16	10958.1260	12206.6798
17	10960.1066	12207.4465
18	10951.8788	12211.0939
19	10952.6436	12209.1179
20	10946.1940	12194.4759
21	10939.5041	12191.4484
22	10938.5847	12193.4870
23	10945.2652	12208.5469
24	10887.6770	12234.0928
25	10881.1048	12219.2770
26	10878.6556	12218.8422
27	10877.5808	12224.8968
28	10882.4467	12235.8659
29	10889.7044	12238.6633
30	10891.7587	12243.2218
31	10859.0988	12257.9190
32	10857.0519	12253.3571
33	10859.7308	12246.0548
34	10853.3260	12232.2278
35	10849.3943	12234.0075
36	10855.8037	12248.5027
37	10822.8787	12263.0611
38	10817.8237	12251.6291
39	10810.5693	12248.8231
40	10799.1371	12253.8781
41	10766.3804	12179.7971
42	10782.8428	12172.5178
43	10786.0777	12168.1569
44	10807.3467	12168.5880
45	10808.5927	12171.4059
46	10815.8471	12174.2118
47	10827.2793	12169.1568
48	10841.8379	12202.0817
49	10826.7473	12208.7544
50	10826.0257	12210.8116
51	10832.7996	12212.7518
52	10842.0197	12208.6749
53	10844.8257	12201.4205
54	10839.6661	12189.7518
55	10889.0275	12167.8553
56	10894.0799	12179.2816
57	10901.3403	12182.0850
58	10917.5269	12174.9047
59	10920.3056	12167.6054
60	10911.4867	12148.1609
61	10908.6210	12148.7461
62	10908.2243	12166.0712

NOTE:
ALL REFERENCE POINTS ARE
TAKEN AT FACE OF CURB.

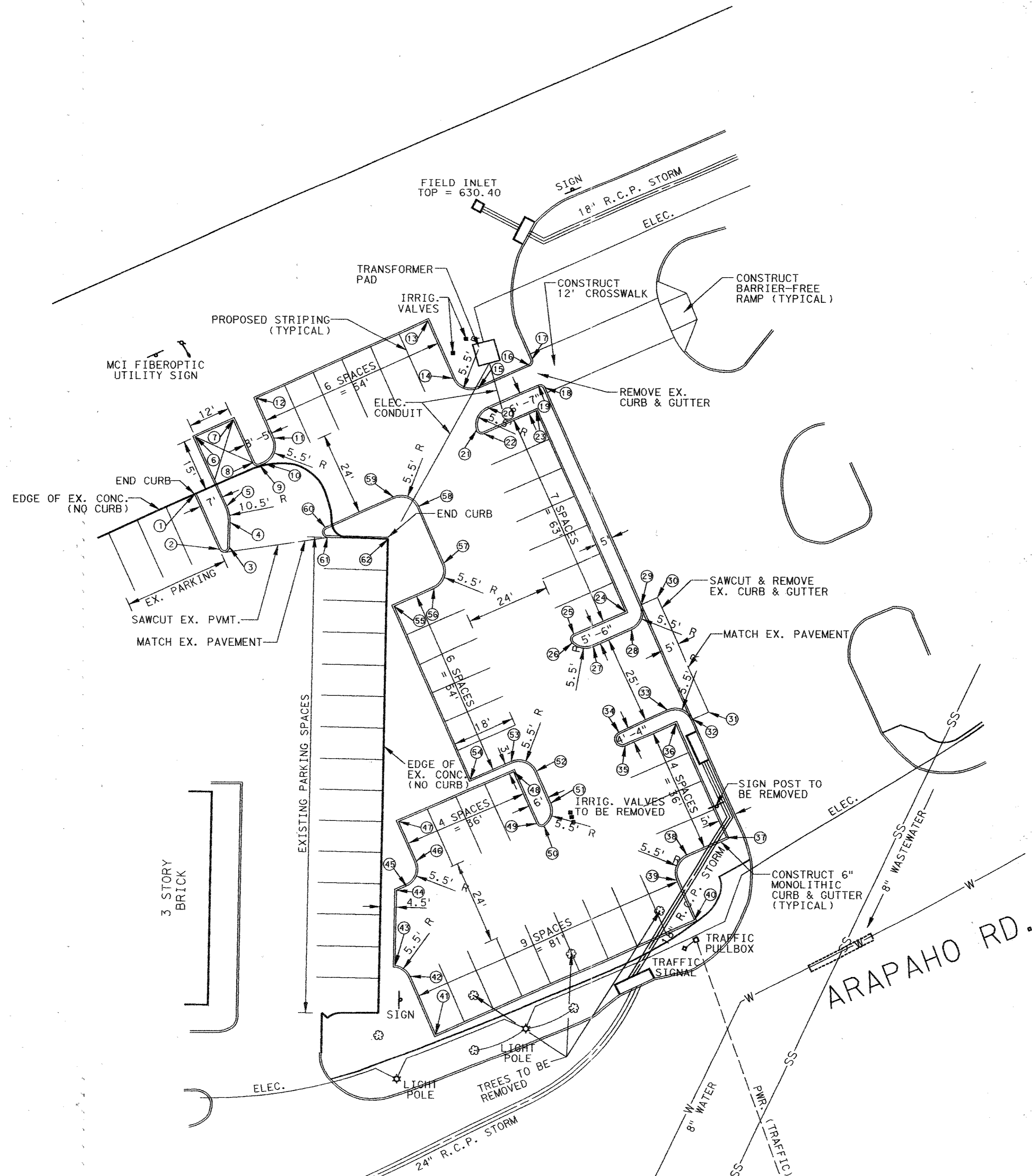

NOTE: SEE SHEET 4 FOR INFORMATION
IN THIS AREA.

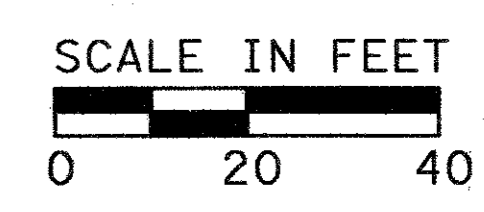
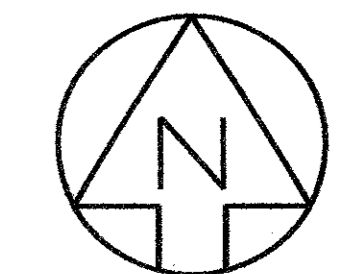
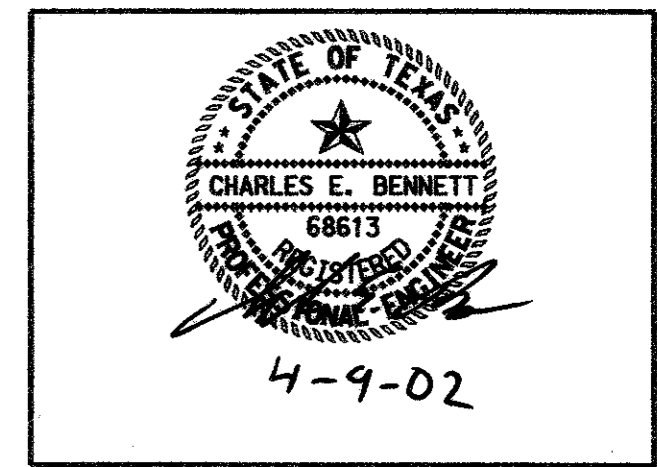

CONTRACT SHEET NO. 3 OF 13

ADDISON
TRANSIT CENTER
SITE PLAN

REV	DATE	DESCRIPTION	BY	ENG	CHK	APP	REV	DATE	DESCRIPTION	BY	ENG	CHK	APP

TURNER COLLIE & BRADEN INC.
LINDA TYCHER & ASSOCIATES
ARS ENGINEERS INC.

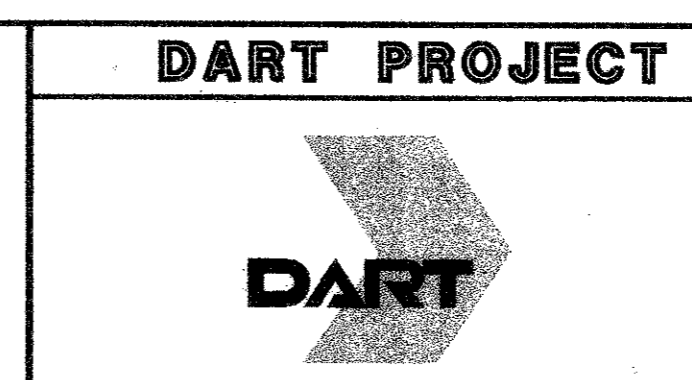

SCALE	1"=20'
DRAWN	J. RATCLIFF
DESIGNED	J. RATCLIFF
CHECKED	C. BENNETT
IN CHARGE	G. SHIPPY
DATE	APRIL 2002

CONTRACT C-96000124-28 DWG NO. REV 0