

c:\cadd\94010.212\shf\abtcsp01  
02 MAR 98  
DART.TBL  
\$(USER)

1000-000  
DWG No.

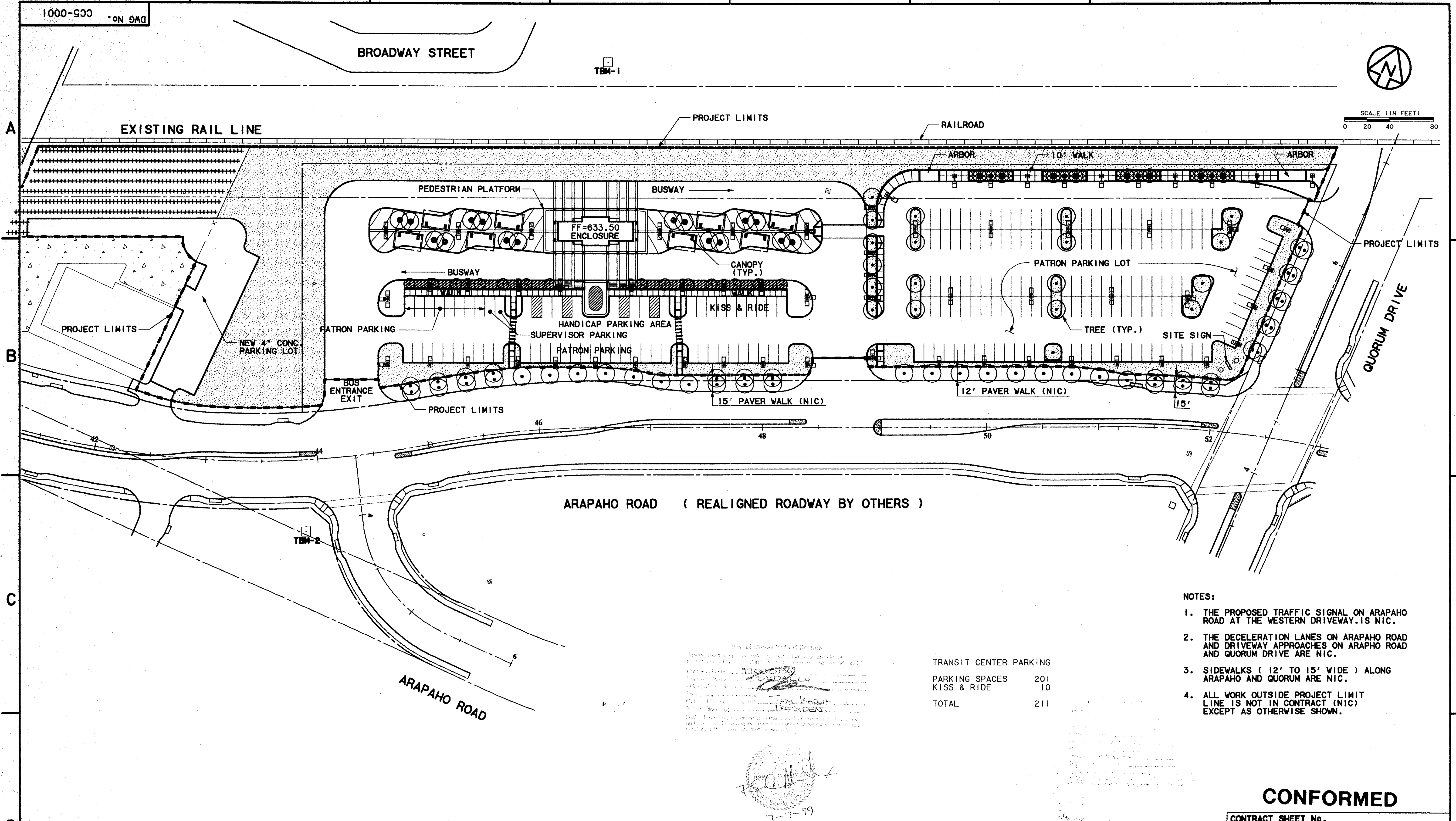

SCALE (IN FEET)  
0 20 40 80

- NOTES:
1. THE PROPOSED TRAFFIC SIGNAL ON ARAPAHO ROAD AT THE WESTERN DRIVEWAY IS NIC.
  2. THE DECELERATION LANES ON ARAPAHO ROAD AND DRIVEWAY APPROACHES ON ARAPHO ROAD AND QUORUM DRIVE ARE NIC.
  3. SIDEWALKS ( 12' TO 15' WIDE ) ALONG ARAPAHO AND QUORUM ARE NIC.
  4. ALL WORK OUTSIDE PROJECT LIMIT LINE IS NOT IN CONTRACT (NIC) EXCEPT AS OTHERWISE SHOWN.

TRANSIT CENTER PARKING

PARKING SPACES	201
KISS & RIDE	10
TOTAL	211

7-7-99

*Tom Kader*  
RESIDENT

**CONFORMED**

CONTRACT SHEET No. 11 OF 95

**ADDISON  
TRANSIT CENTER  
SITE PLAN**

REV	DATE	DESCRIPTION	BY	ENG	CHK	APP	REV	DATE	DESCRIPTION	BY	ENG	CHK	APP



WENDY LOPEZ & ASSOC.  
LOCKWOOD, ANDREWS & NEWNAM  
THE SWA GROUP  
GERARD & ASSOCIATES  
ZAXON

**WLA**  
WENDY LOPEZ & ASSOCIATES, INC.  
ENGINEERING • SURVEYING • CONSTRUCTION SERVICES  
802 MARKET CENTER BLVD - SUITE 20  
DALLAS, TEXAS 75207  
(214) 76-7777

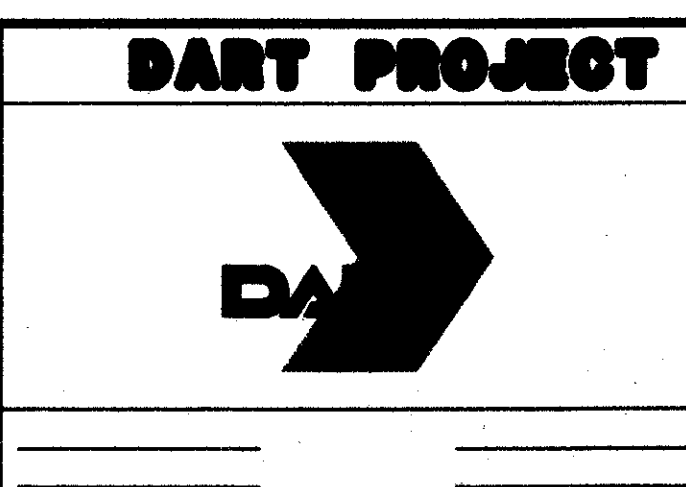

SCALE 1"=40'  
DRAWN D. KRUCIAK  
DESIGNED P. ZHAO  
CHECKED V. STEVENS  
IN CHARGE V. STEVENS  
DATE AUG. 14, 1997



CONTRACT C-97000136  
DWG No. CC5-0001  
REV 0